

Runda Suspension - Installation Instructions

Models RUN-XX-S-XX

Please read all instructions prior to installation and keep for future reference!

1. PRODUCT TO BE INSTALLED BY A QUALIFIED ELECTRICIAN.
2. USE ONLY WITH CLASS 2 POWER UNIT.
3. 24 VOLTS DC.
4. SUITABLE FOR DAMP LOCATIONS.
5. MORE THAN ONE PERSON IS RECOMMENDED FOR THIS INSTALLATION
6. FIXTURE SHOULD BE INSTALLED BY TWO PEOPLE.



REVO.2
12312024

1 / 4



7777 Merrimac Ave
Niles, IL 60714
T 224.333.6033
F 224.757.7557
info@luminii.com
www.luminii.com

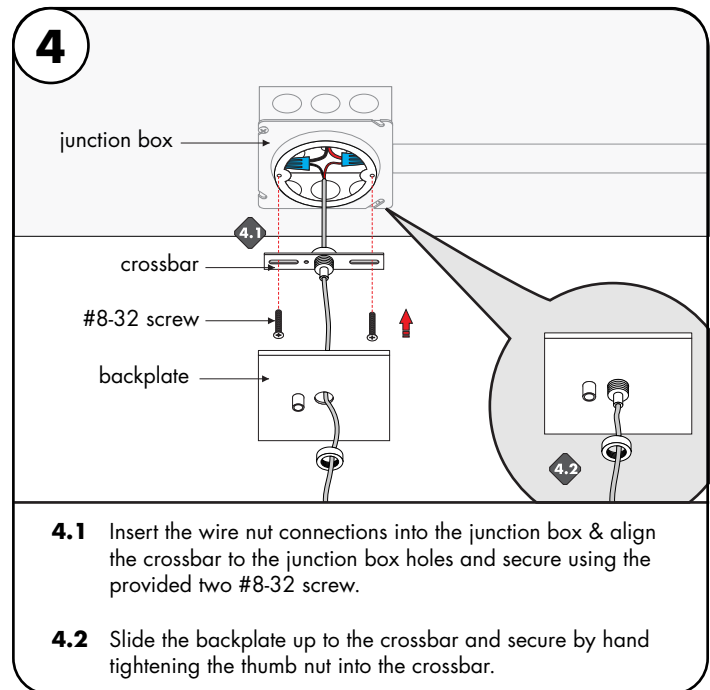
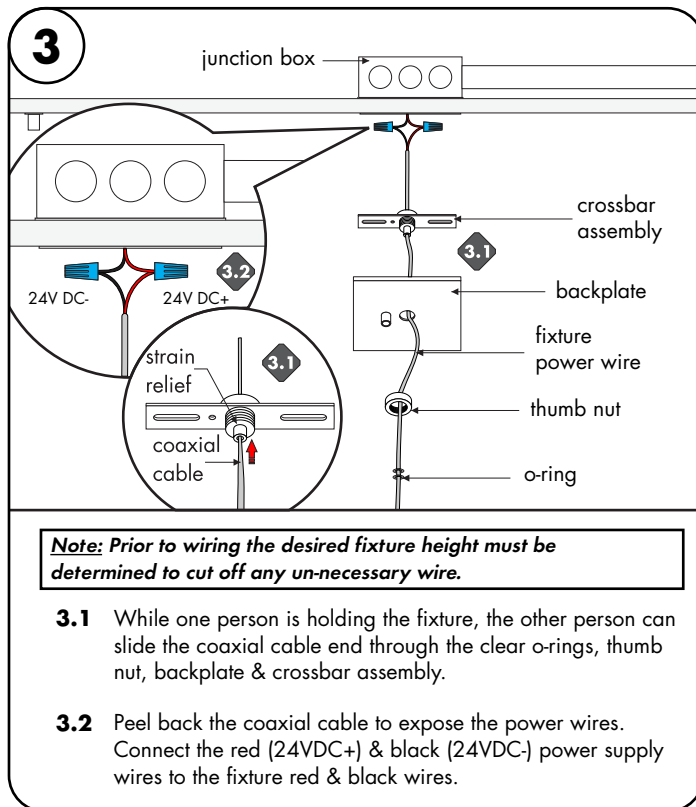
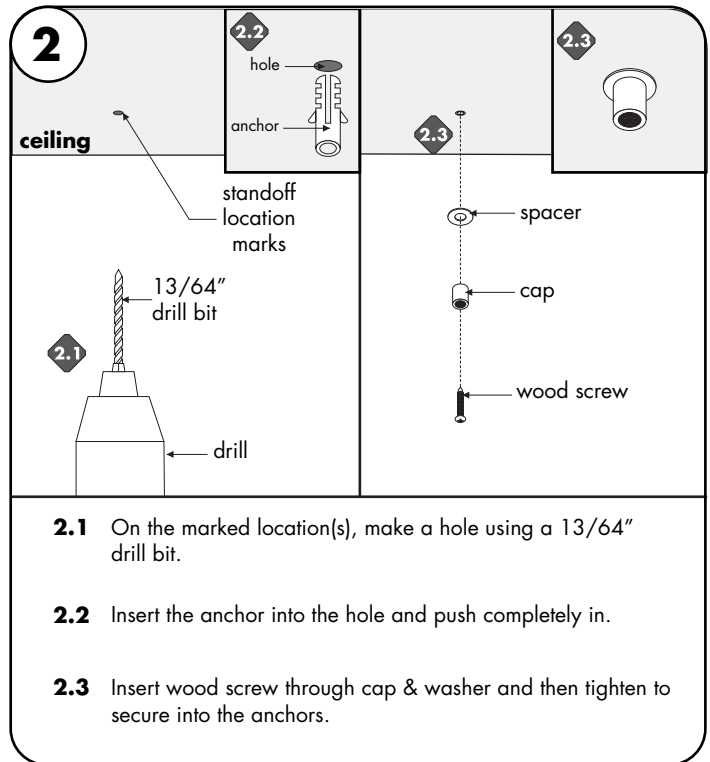
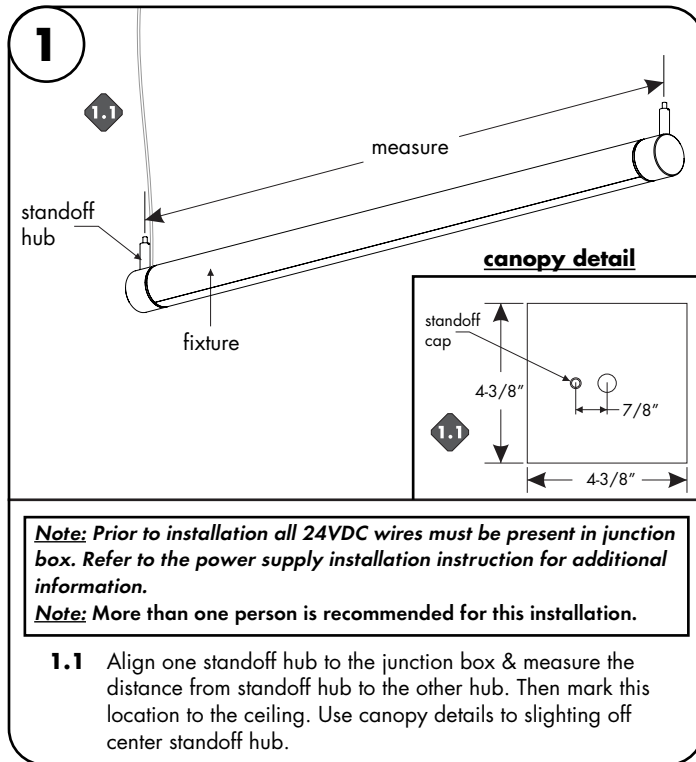

Runda Suspension - Installation Instructions

Models RUN-XX-S-XX

Please read all instructions prior to installation and keep for future reference!

1. PRODUCT TO BE INSTALLED BY A QUALIFIED ELECTRICIAN.
2. USE ONLY WITH CLASS 2 POWER UNIT.
3. 24 VOLTS DC.
4. SUITABLE FOR DAMP LOCATIONS.
5. MORE THAN ONE PERSON IS RECOMMENDED FOR THIS INSTALLATION
6. FIXTURE SHOULD BE INSTALLED BY TWO PEOPLE.



REVO.2
12312024

2 / 4



7777 Merrimac Ave
Niles, IL 60714
T 224.333.6033
F 224.757.7557
info@luminii.com
www.luminii.com

5

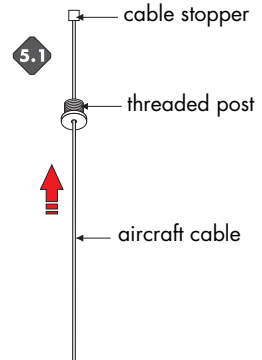

5.1 Untangle each aircraft cable and insert into the threaded post until the cable stopper.

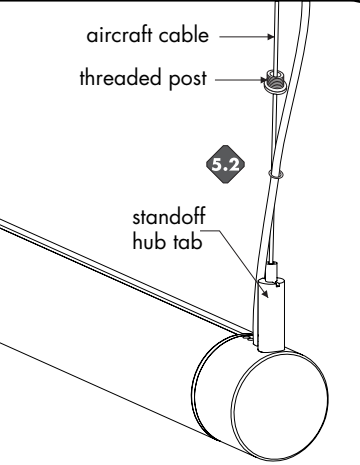

5.2 Push on the standoff hub tab and feed the aircraft cable into the standoff hub until necessary. Release tab to secure in place. For the aircraft cable closest to the coaxial cable slide through the o-rings on the coaxial cable first.

5.3 Remove the clear protective film from the face of the lens.

6

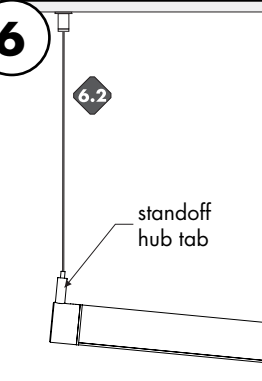

6.1 Tighten each threaded post into a cap, one will be on the backplate and other(s) on the ceiling. If fixture not leveled, adjustments can be made by pushing on the standoff hub tab. Then either feed more cable into the standoff hub or pull out cable from the standoff hub and release to secure.

6.2 Cut off any extra aircraft cable from the standoff hub hole.

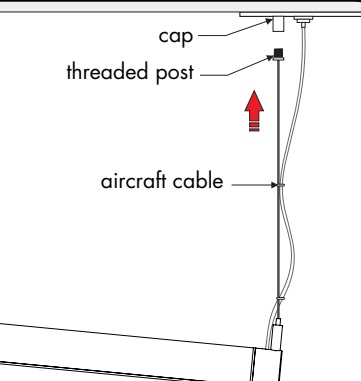

7

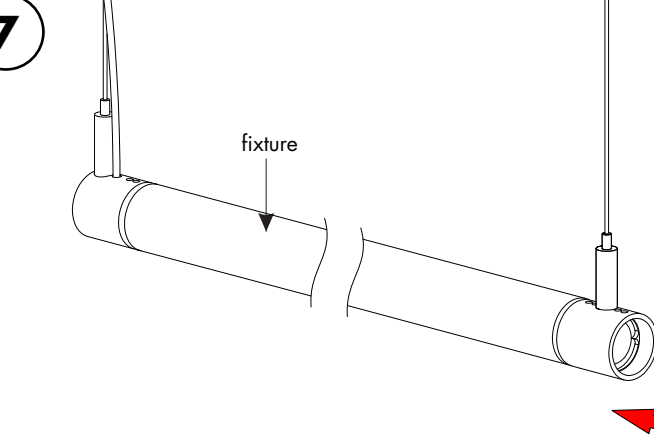

7.1 If joining fixtures together, insert the fixture end into the corresponding fixture. Secure by tightening the two set screw that is the closest to the fixture. Reference drawing above as reference, to join correctly.

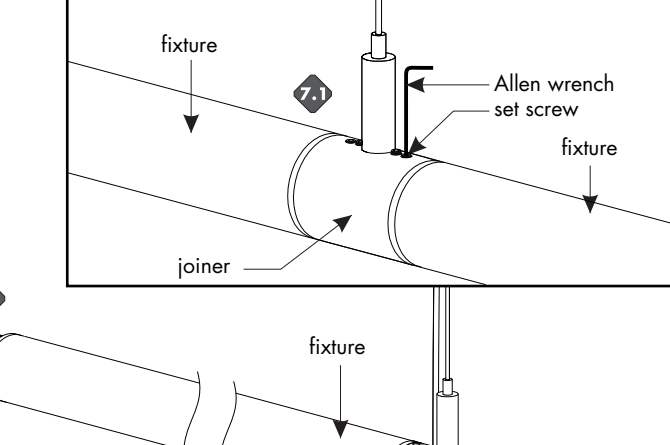

7.1 If joining fixtures together, insert the fixture end into the corresponding fixture. Secure by tightening the two set screw that is the closest to the fixture. Reference drawing above as reference, to join correctly.

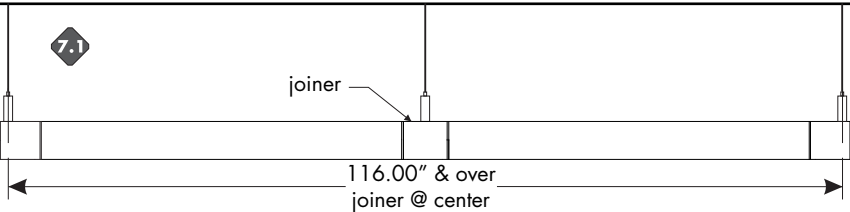

7.1 If joining fixtures together, insert the fixture end into the corresponding fixture. Secure by tightening the two set screw that is the closest to the fixture. Reference drawing above as reference, to join correctly.

Runda Suspension - Installation Instructions

Models RUN-XX-S-XX

Please read all instructions prior to installation and keep for future reference!

1. PRODUCT TO BE INSTALLED BY A QUALIFIED ELECTRICIAN.
2. USE ONLY WITH CLASS 2 POWER UNIT.
3. 24 VOLTS DC.
4. SUITABLE FOR DAMP LOCATIONS.
5. MORE THAN ONE PERSON IS RECOMMENDED FOR THIS INSTALLATION
6. FIXTURE SHOULD BE INSTALLED BY TWO PEOPLE.



REVO.2
12312024

3 / 4



7777 Merrimac Ave
Niles, IL 60714
T 224.333.6033
F 224.757.7557
info@luminii.com
www.luminii.com

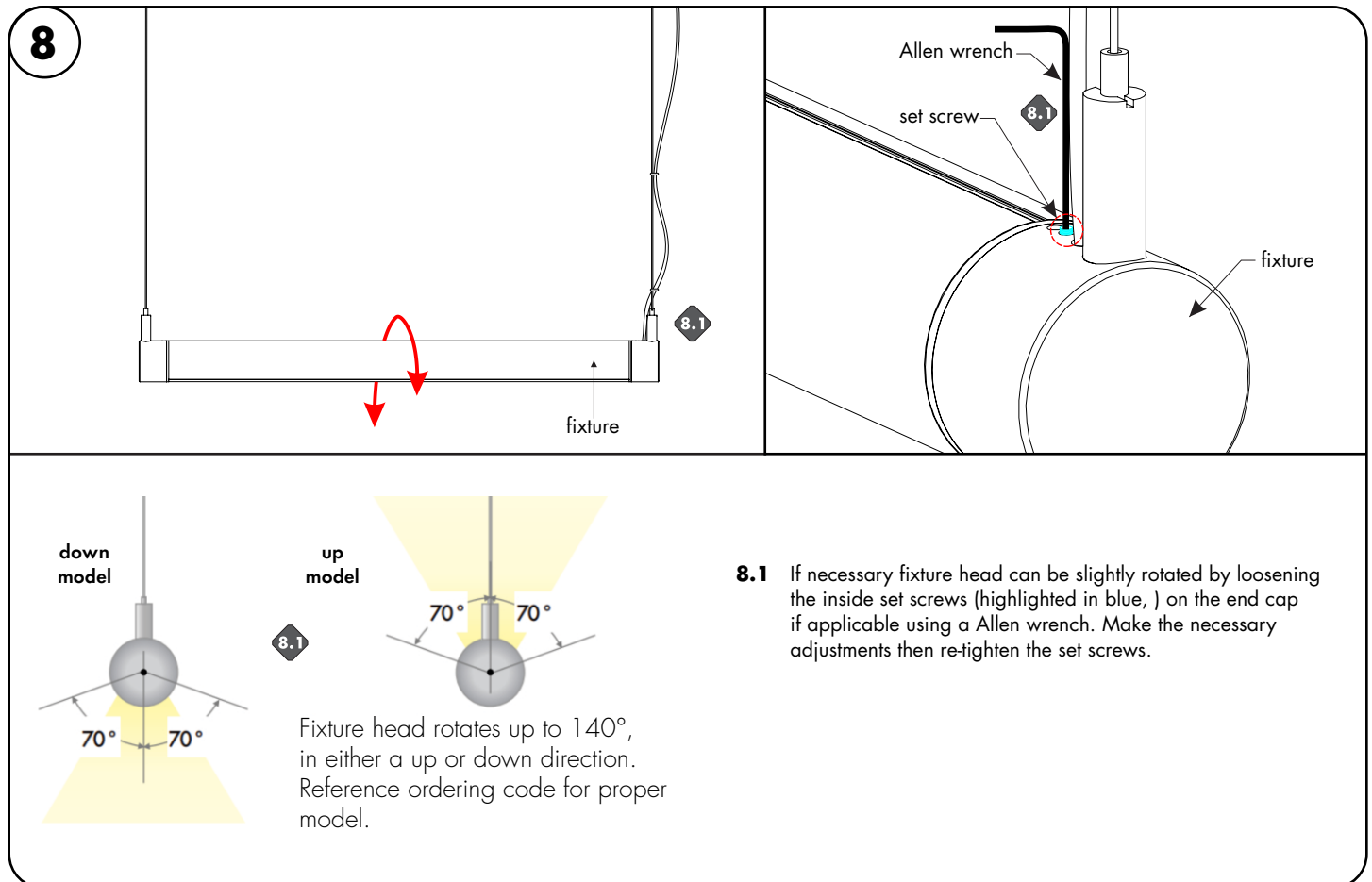

Runda Suspension - Installation Instructions

Models RUN-XX-S-XX

Please read all instructions prior to installation and keep for future reference!

1. PRODUCT TO BE INSTALLED BY A QUALIFIED ELECTRICIAN.
2. USE ONLY WITH CLASS 2 POWER UNIT.
3. 24 VOLTS DC.
4. SUITABLE FOR DAMP LOCATIONS.
5. MORE THAN ONE PERSON IS RECOMMENDED FOR THIS INSTALLATION
6. FIXTURE SHOULD BE INSTALLED BY TWO PEOPLE.



REVO.2
12312024

4 / 4



7777 Merrimac Ave
Niles, IL 60714
T 224.333.6033
F 224.757.7557
info@luminii.com
www.luminii.com

Power Supply Wiring Diagram

Note: Prior to installation all 24VDC wires must be present near fixture. Refer to the power supply installation instructions for additional information.



Static White
Wiring Diagram PDF

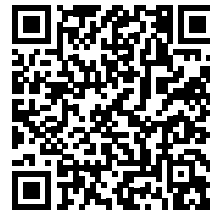

RGB/RGBW
Wiring Diagram PDF



Warm Dim
Wiring Diagram PDF

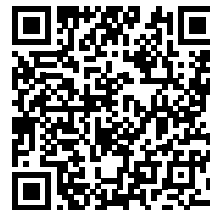

Pixel
Wiring Diagram PDF



Tunable White
Wiring Diagram PDF