

Plexineon Surface Mount

RGB, RGBW and RGBW Pixel

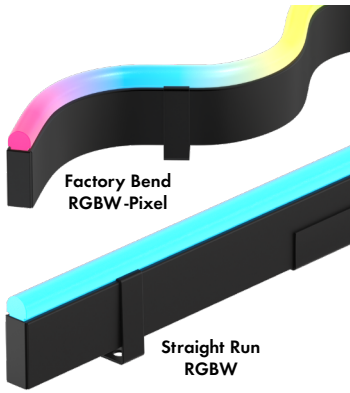

- Easy to install, for interior and exterior accent lighting
- Neon look providing a crisp, clear line of light visible for miles
- Creative freedom to make stunning designs, rigid construction maintains factory formed shape
- Mounting clips are included in the appropriate quantities
- Operating temperature: -40° F to 140° F (-40° C to 60° C)
- 24VDC Class 2
- IK10 and 3G rated
- IP67 rated.
- 5 year warranty indoor, 3 year warranty outdoor

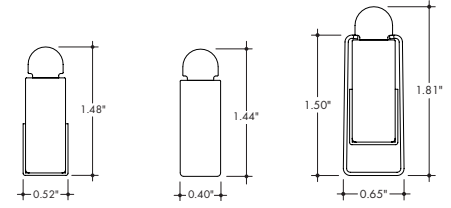

Straight Run Field/Factory Bend In Mounting Clip



Technical Information

MODEL	Plexineon RGB	Plexineon RGBW	Plexineon Pixel RGBW
OUTPUT OPTIONS	SO		
Lumens Output <small>(all channels full on)</small>	72 lm/ft	110 lm/ft	84 lm/ft
Average Power Consumption <small>(for a 4" section)</small>	4.1 W/ft	5.4 W/ft	5.7 W/ft
Efficacy	17.5 lm/W	20.3 lm/W	14.7 lm/W
Order Increment	1.97"	3.94"	3.94"
Max Run Length <small>(in series)</small>	32 ft	17 ft	16 ft
SPI Protocol	N/A	N/A	UCS 2904
DMX Addresses Occupied	N/A	N/A	4-channels per pixel

RGBW (3000K)				
Model	CRI	TM-30		
		R _f	R _g	R _g
RGBW	85	84	98	22
RGBW-PXSPI	85	84	98	22

Dominant Wavelength	
Color	RGB
Red	622nm
Green	525nm
Blue	468nm

Ordering Code

MODEL	RUN LENGTH ¹	BEND	CCT	OUTPUT	LENS	MOUNTING ⁴	FINISH	POWERFEED POSITION/TYPE	QUOTE NUMBER ⁷
PX -Plexineon	____ -Run length in inches, 6" min, no max run length	SR -Straight Run FB -Field Bendable ² EB -Factory Bend, Side/Easy Bend ³ HB -Factory Bend, Top/Hard Bend ³	RGB -RGB RGBW -RGBW (3000K) RGBW-PXSPI -RGBW Pixel Control (3000K)	SO -Standard	F -Frosted	SM -Surface Mount, Standard Clips SML -Surface Mount, L-Tab Clips SMS -Surface Mount, S-Tab Clips SMV -Surface Mount, Vertical Clips ⁵ SMD -Surface Mount Decorative Clips ⁶	GG -Gloss Grey BK -Matte Black GY -Matte Grey WH -Matte White	B-4 -Male Quick Connect One End, Female Quick Connect Other End	(leave Blank) -For SR or FB ____ -Quote Number entered by Inside Sales used for Factory Bends and Custom Drawings

1. RGB is available in 2" (1.97") order increments. RGBW and Pixel RGBW are available in 4" (3.94"), +/- 1/2" tolerance. Run Lengths over 96" (8ft) will be made of equal sections no longer than 96".
 2. Field Bendable ships as straight sections which can be bent down to 72" radius min. Field Bendable sections do not include rigid channel and may not maintain straightness without appropriately placed mounting clips.
 3. Factory Bends require an Image or Drawing input at time of Quote to calculate total linear/arc length. Factory Bends require a Custom Drawing submittal at time of Order. Allow 2 weeks (typical) for Custom Drawing generation/confirmation process.

4. Standard mounting clip included approximately every 30" of linear/arc length.
 5. Two Vertical Clips for vertical support. Standard mounting clip included approximately every 30" of linear/arc length.
 6. All mounting clips come with stainless steel finish, except Decorative Clips. Decorative Clips match the fixture finish, and are included approximately every 18" of linear/arc length.
 7. Quote Number correlates the Quote to the Custom Drawing. If a single Quote includes different designs having the same length, add -1, -2, -3, etc. to the end of the Quote Number for each unique configuration.

Plexineon Surface Mount

RGB, RGBW and RGBW Pixel



Corner Dimensions

IC-SR
Inside Corner

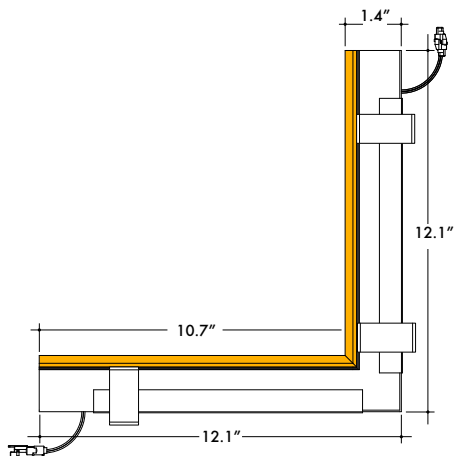

OC-SR
Outside Corner

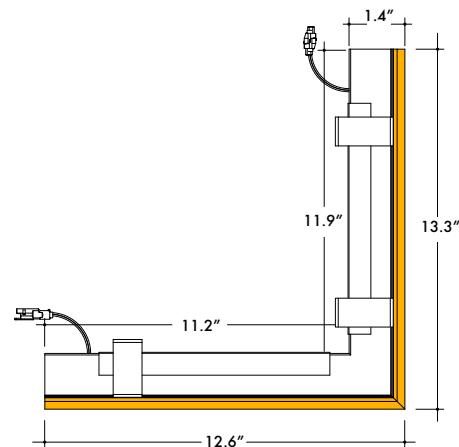

Note: Outside Corner legs are asymmetric, male connector is on the longer end, female connector is on the shorter end.

HC-SR
Horizontal Corner

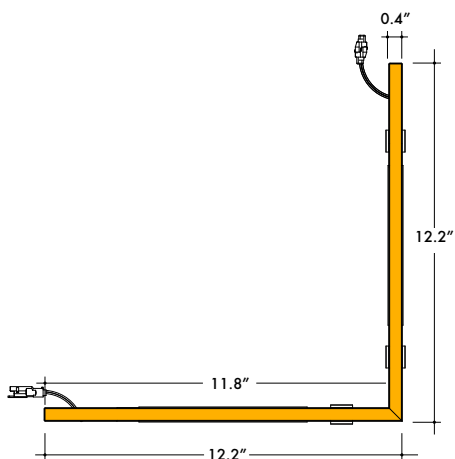

Ordering Code

MODEL	CORNER ¹	CCT	OUTPUT	LENS	MOUNTING ¹	FINISH	POWERFEED POSITION/TYPE
PX - Plexineon	IC-SR - Inside Corner OC-SR - Outside Corner HC-SR - Horizontal Corner	RGB - RGB RGBW - RGBW (3000K) RGBW-PXSPI - RGBW Pixel Control (3000K)	SO - Standard	F - Frosted	SM - Surface Mount, Standard Clips SML - Surface Mount, L-Tab Clips SMS - Surface Mount, S-Tab Clips SMV - Surface Mount, Vertical Clips SMD - Surface Mount Decorative Clips ²	GG - Gloss Grey BK - Matte Black GY - Matte Grey WH - Matte White	B-4 - Male Quick Connect One End, Female Quick Connect Other End

1. Corners include 3 mounting clips.
2. All mounting clips come with stainless steel finish, except Decorative Clips. Decorative Clips match the fixture finish.

Plexineon Surface Mount

RGB, RGBW and RGBW Pixel



Finish Options

BK
Matte Black Finish

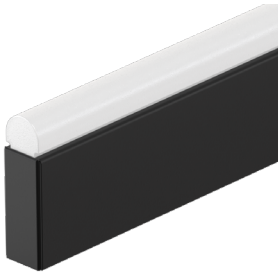

WH
Matte White Finish



GY
Matte Grey Finish

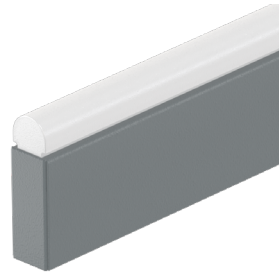

GG
Gloss Grey Finish

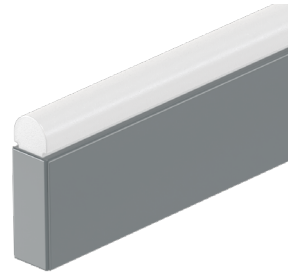

Mounting Clips

- Mounting Clips are included with Plexineon runs in the appropriate quantity, every 30" of linear/arc length for Standard Clips and every 18" of linear/arc length for Decorative Clips.
- Standard Clips have a stainless steel finish, Decorative Clip finishes match the fixture finishes.
- Standard Clip mounting hole is $\varnothing 0.2"$, Decorative Clip mounting hole is $\varnothing 0.16"$.

SM
75-CLP16-001-00
Surface Mount, Standard Clip

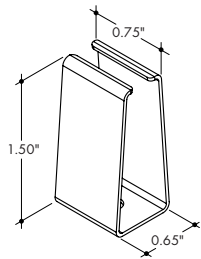

Used for mounting direct to surface. Stainless Steel Finish

SML
75-CLP15-001-00
Surface Mount, L-Tab Clip

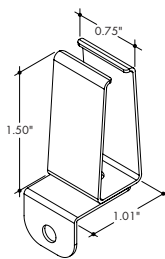

Used for mounting to adjacent surfaces. Stainless Steel Finish

SMS
75-CLP17-001-00
Surface Mount, S-Tab Clip

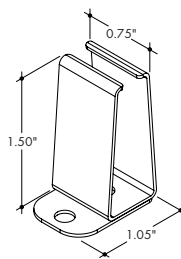

Used for to reduce install time and mounting direct to surfaces with fixture pre-assembled to clips. Stainless Steel Finish

SMV
75-CLP20-001-00
Surface Mount, Vertical Clip

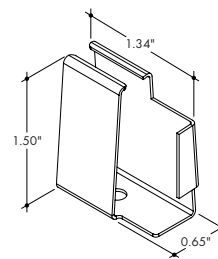

Used to hold fixtures in a vertical orientation. Stainless Steel Finish

75-CLP19-001-00
Surface Mount, Standard Joiner Clip

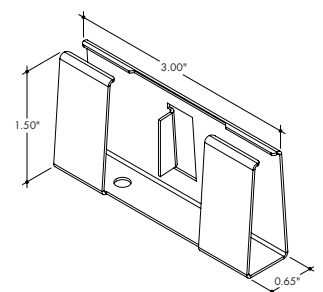

Used to join two fixtures together. Stainless Steel Finish

SMD
75-CLP36-001-0X
Surface Mount, Decorative Clip

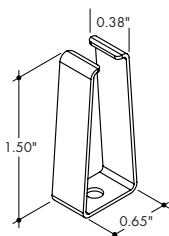

Thinner clip with finish options to match fixtures

75-CLP37-001-0X
Surface Mount, Decorative Joiner Clip

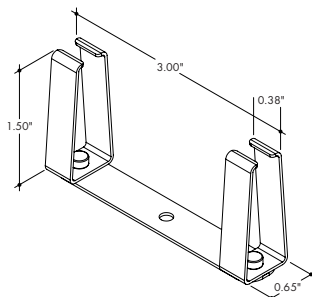

Thinner clip used to join two fixtures together. Finish matches fixture finish

70-TOL02-001-01
Mounting Clip Installation Tool

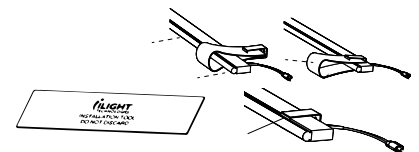

Use for installation of Plexineon into Mounting Clips

OX	Clip Finish
00	Stainless Steel
01	Matte Black
02	Matte Grey
03	Matte White

Plexineon Surface Mount

RGB, RGBW and RGBW Pixel

Powerfeed and Connectors

For use with RGB

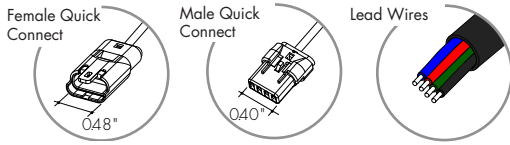

60-SJ-C4-0002-01

Female RGB Quick Connect with 6" flying leads

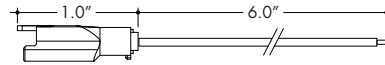

Female Quick Connect with flying leads can be connected to the Power Supply at the start of a run. Can also be used with the Male Quick Connect to make wire jumpers.

Also available with longer Flying Leads

60-SJ-C4-0004-01

Female RGB Quick Connect with 120" flying leads

60-SJ-C4-0001-01

Male RGB Quick Connect with 6" flying leads

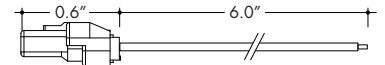

Male Quick Connect with flying leads can be used to make wire jumpers.

Also available with longer Flying Leads

60-SJ-C4-0003-01

Male RGB Quick Connect with 120" flying leads

For use with RGBW

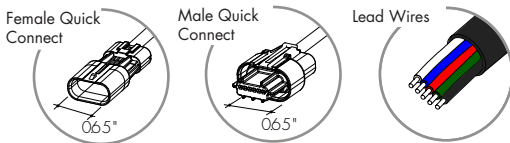

60-SJ-C5-0002-01

Female RGBW Quick Connect with 6" flying leads

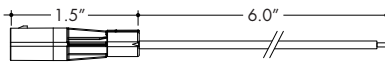

Female Quick Connect with flying leads can be connected to the Power Supply at the start of a run. Can also be used with the Male Quick Connect to make wire jumpers.

Also available with longer Flying Leads

60-SJ-C5-0004-01

Female RGBW Quick Connect with 120" flying leads

60-SJ-C5-0001-01

Male RGBW Quick Connect with 6" flying leads

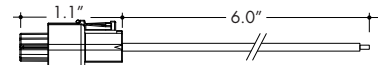

Male Quick Connect with flying leads can be used to make wire jumpers.

Also available with longer Flying Leads

60-SJ-C5-0003-01

Male RGBW Quick Connect with 120" flying leads

For use with Pixel

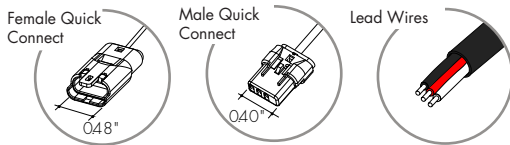

60-SJ-C3-0002-01

Female Pixel Quick Connect with 6" flying leads

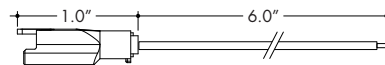

Female Quick Connect with flying leads can be connected to the Power Supply at the start of a run. Can also be used with the Male Quick Connect to make wire jumpers.

Also available with longer Flying Leads

60-SJ-C3-0006-01

Female Pixel Quick Connect with 384" flying leads

60-SJ-C3-0008-01

Female Pixel Quick Connect with 120" flying leads

60-SJ-C3-0001-01

Male Pixel Quick Connect with 6" flying leads



Male Quick Connect with flying leads can be used to make wire jumpers.

Also available with longer Flying Leads

60-SJ-C3-0005-01

Male Pixel Quick Connect with 384" flying leads

60-SJ-C3-0007-01

Male Pixel Quick Connect with 120" flying leads

Sample Layout

- Note (Pixel Only): Pixel direction will be shown with a label on the side of the fixture.



PX-120-EB-RGBW-PXSPI-SO-F-5M-GG-B-4-QXXXXX
Plexineon Factory Bend, Standard Mounting Clips

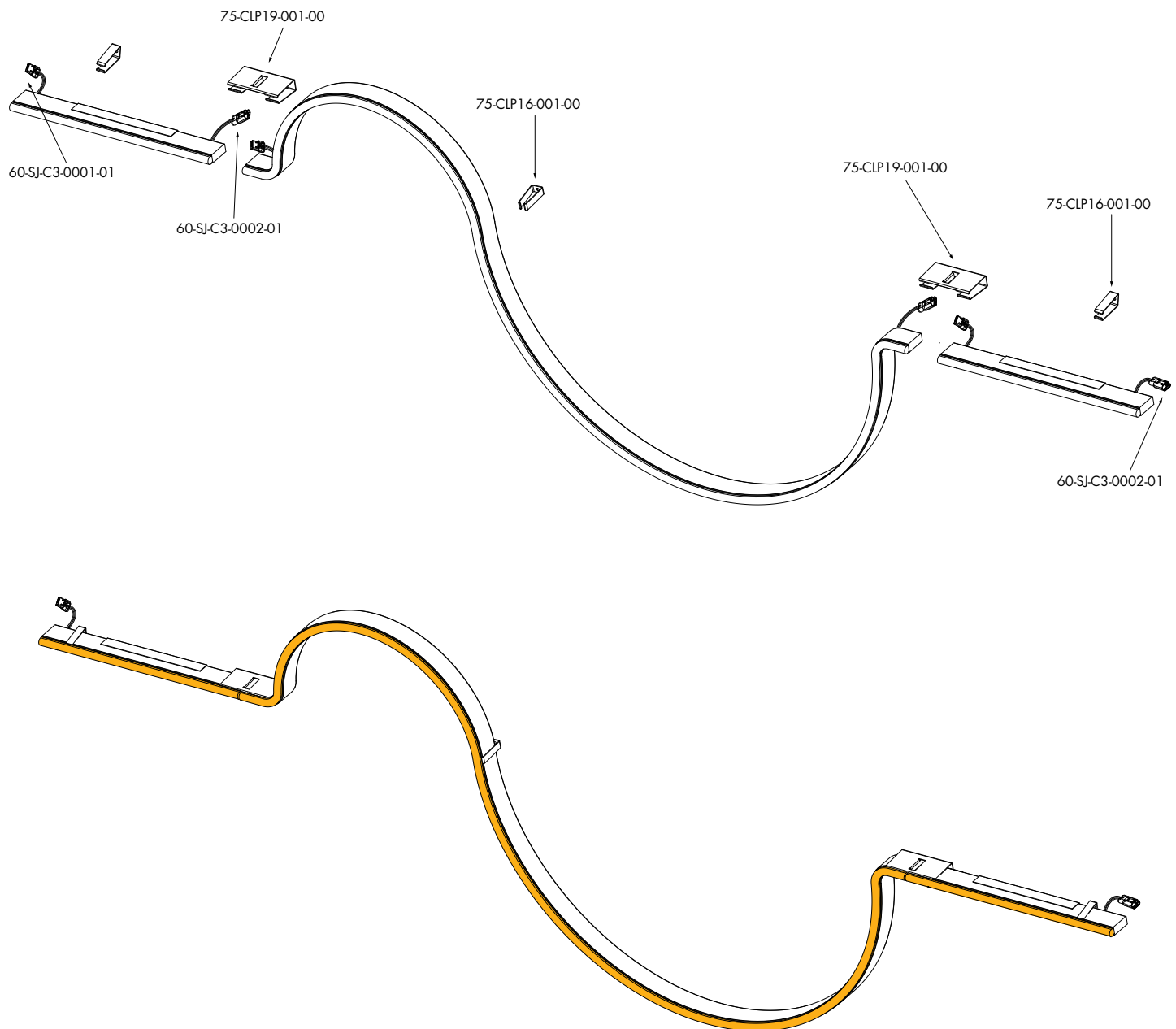

Plexineon Surface Mount

RGB, RGBW and RGBW Pixel



Field Bends

- Field Bends available with Surface Mount installations only.
- Field Bends can be made only in a direction perpendicular to the light output, Horizontal/Easy Bend.
- Field Bendable ship as straight sections which can be bent down to 72" radius min.
- Field Bendable sections do not include rigid c-channel and may not maintain straightness without appropriately placed mounting clips.

FB
Field Bend, Side/Easy Bend

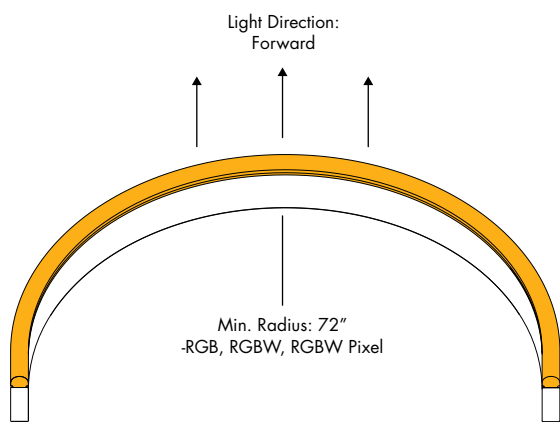

Factory Bends

- Require Custom Drawing submittal and approval.

EB
Factory Bend, Side/Easy Bend

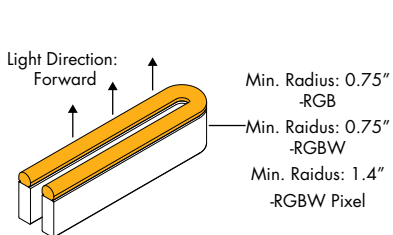

HB
Factory Bend, Top/Hard Bend

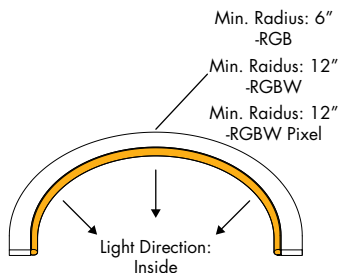

HB
Factory Bend, Top/Hard Bend

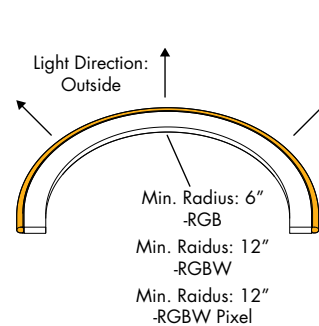

Plexineon Surface Mount

RGB, RGBW and RGBW Pixel



Power Consumption

Tested at Full Power with PDC Series power supplies.

Standard Nominal Lengths offered provide minimal shadowing. For alternate lengths, please consult Inside Sales with specific request.

RGB

Nominal Length (in)	Actual Length	Watts	Nominal Length (in)	Actual Length	Watts
7	6 6/16	1.9	54	53 10/16	19
9	8 6/16	2.9	56	55 10/16	19.5
11	10 5/16	3.6	58	57 9/16	20.2
13	12 5/16	4.1	60	59 9/16	21.2
15	14 4/16	4.9	62	61 8/16	21.7
17	16 4/16	5.5	64	63 8/16	22.4
19	18 3/16	6.5	66	65 7/16	23.1
20	20 3/16	7.2	68	67 7/16	23.6
22	22 2/16	7.7	70	69 6/16	24.3
24	24 2/16	8.4	72	71 6/16	25.1
26	26 1/16	9.2	74	73 5/16	25.5
28	28 1/16	10.1	76	75 5/16	26.2
30	30	10.6	78	77 4/16	27
32	32	11.6	80	79 4/16	27.7
34	33 15/16	12.1	82	81 3/16	28.4
36	35 15/16	12.8	83	83 3/16	28.9
38	37 14/16	13.5	85	85 2/16	29.6
40	39 14/16	14.2	87	87 2/16	30.3
42	41 13/16	15.2	89	89 1/16	30.8
44	43 13/16	15.7	91	91 1/16	31.6
46	45 12/16	16.2	93	93	32.2
48	47 12/16	17.1	95	95	32.2
50	49 11/16	17.8			
52	51 11/16	18.3			

RGBW

Nominal Length (in)	Actual Length	Watts
9	8 6/16	3.8
13	12 5/16	5.5
17	16 4/16	7.7
20	20 3/16	9.4
24	24 2/16	11.5
28	28 1/16	13.5
32	32	15.4
36	35 15/16	17.1
40	39 14/16	18.9
44	43 13/16	20.6
48	47 12/16	22.5
52	51 11/16	24.2
56	55 10/16	25.9
60	59 9/16	27.7
64	63 8/16	29.4
68	67 7/16	31.1
72	71 6/16	32.9
76	75 5/16	34.6
80	79 4/16	35.8
83	83 3/16	37.4
87	87 2/16	38.7
91	91 1/16	40.4
95	95	42.2

PIXEL

Nominal Length (in)	Actual Length	Watts	Pixel Qty
9	8 6/16	3.6	2
13	12 5/16	5.6	3
17	16 4/16	7.7	4
21	20 3/16	9.6	5
25	24 2/16	11.5	6
29	28 1/16	13.7	7
32	32	15.6	8
36	35 15/16	17.5	9
40	39 14/16	19.1	10
44	43 13/16	21.3	11
48	47 12/16	22.9	12
52	51 11/16	25	13
56	55 10/16	26.9	14
60	59 9/16	28.5	15
64	63 8/16	30.4	16
68	67 7/16	32.3	17
72	71 6/16	34.3	18
76	75 5/16	36.2	19
80	79 4/16	38.1	20
84	83 3/16	40	21
88	87 2/16	41.7	22
92	91 1/16	43.6	23
95	95	45.2	24



Voltage Drop Calculator

The below chart assumes nominal voltage of 24 Volts and a Voltage Drop Allowance of 3% through the wire

Wattage [W]	Maximum Wire Length From Power Supply to Start of Run [ft]						
	12 AWG	14 AWG	16 AWG	18 AWG	20 AWG	22 AWG	24 AWG
5	1088.2	684.4	430.3	270.6	170.2	107.1	67.3
10	544.1	342.2	215.1	135.3	85.1	53.5	33.7
15	362.7	228.1	143.4	90.2	56.7	35.7	22.4
20	272.0	171.1	107.6	67.7	42.6	26.8	16.8
25	217.6	136.9	86.1	54.1	34.0	21.4	13.5
30	181.4	114.1	71.7	45.1	28.4	17.8	11.2
35	155.5	97.8	61.5	38.7	24.3	15.3	9.6
40	136.0	85.5	53.8	33.8	21.3	13.4	8.4
45	120.9	76.0	47.8	30.1	18.9	11.9	7.5
50	108.8	68.4	43.0	27.1	17.0	10.7	6.7
55	98.9	62.2	39.1	24.6	15.5	9.7	6.1
60	90.7	57.0	35.9	22.6	14.2	8.9	5.6
65	83.7	52.6	33.1	20.8	13.1	8.2	5.2
70	77.7	48.9	30.7	19.3	12.2	7.6	4.8
75	72.5	45.6	28.7	18.0	11.3	7.1	4.5
80	68.0	42.8	26.9	16.9	10.6	6.7	4.2
85	64.0	40.3	25.3	15.9	10.0	6.3	4.0
90	60.5	38.0	23.9	15.0	9.5	5.9	3.7
96	56.7	35.6	22.4	14.1	8.9	5.6	3.5

Plexineon Surface Mount

RGB, RGBW and RGBW Pixel



Common Applications

Custom Indoor Designs | Coves | Signs | Building Facades | Lobbies | Hallways | Statement Pieces | Restaurants
Corporate Offices | Schools | Residential Towers | Parking Garages | Hotels | Bridges | Benches | Airports



Plexineon Surface Mount

RGB, RGBW and RGBW Pixel



Power Supplies

See fixture and power supply instructions & spec sheet for wiring information. Dimming possible in select models - view Luminii website for list of compatible dimmers.

Ordering Code DMX Dimming Power Supplies 0.1% 120VAC - 277VAC Requires Controller

MODEL	INPUT CONTROL	ENVIRONMENT	WATTAGE	OUTPUT
PS-Power Supply, 120-277VAC	DMX-DMX (0.1%)	D-Dry	96-96 Watts 3X96-3X96 Watts	24-24 VDC

MODELS	96W	3X96
Length	14.40"	15.00"
Width	5.20"	6.62"
Depth	2.60"	4.56"

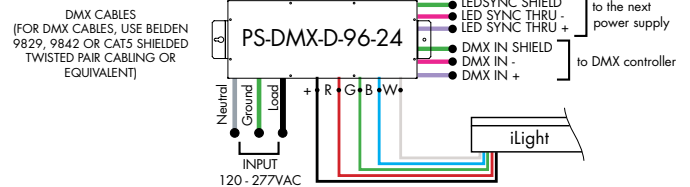
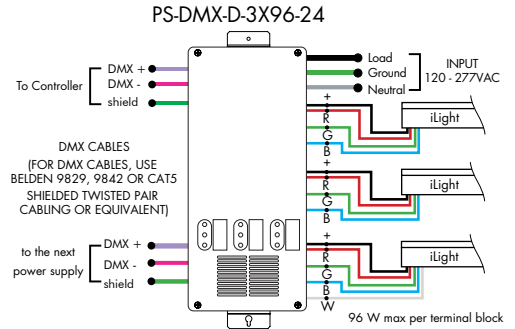

Ordering Code Non-Dimming Power Supply 120VAC - 277VAC Requires Controller and Decoder

MODEL	INPUT CONTROL	ENVIRONMENT	WATTAGE	OUTPUT
PS-Power Supply, 120-277VAC	ND-Non Dimming	D-Dry	96-96 Watts	24-24 VDC

MODELS	96W
Length	14.40"
Width	5.20"
Depth	2.60"

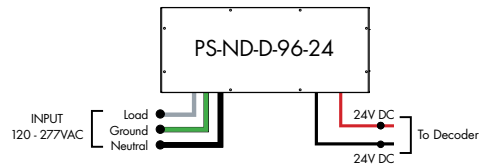

Ordering Code Universal Dimming Power Supplies 1% 120VAC - 277VAC Requires Controller and Decoder

MODEL	INPUT CONTROL	ENVIRONMENT	WATTAGE	OUTPUT
PS-Power Supply, 120-277VAC	UNI-0-10V Dimming, Phase Dimming	D-Dry W-Wet	30-30 Watts 60-60 Watts 96-96 Watts 3x96-3x96 Watts	24-24 VDC

Compatibility: View a complete list of compatible dimmers on product page [\(Link\)](#)

0-10V - 1% dimming
MLV/ELV/TRIAC - 1% dimming, consult dimming compatibility chart

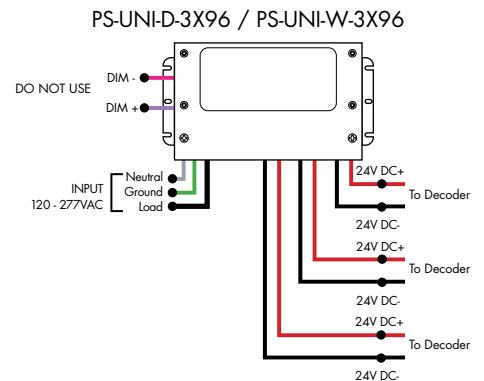
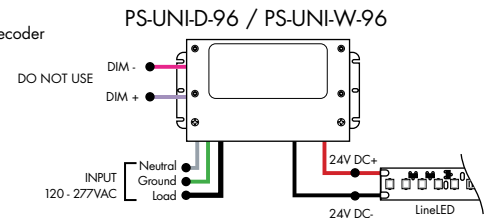

MODELS	PS-UNI-W-30W	PS-UNI-W-60W	PS-UNI-W-96W	PS-UNI-W-3X96W
Length	6.50"	7.40"	8.66"	11.85"
Width	3.73"	3.73"	3.73"	4.32"
Depth	1.61"	1.61"	1.61"	1.81"

MODELS	PS-UNI-D-30W	PS-UNI-D-60W	PS-UNI-D-96W	PS-UNI-D-3X96W
Length	8.77"	8.77"	8.11"	9.94"
Width	4.27"	4.27"	5.60"	7.61"
Depth	1.83"	1.83"	1.83"	2.02"



Controllers and Decoders



MODEL

RGBW-RC-R

RGBW-RC-R - RGBW receiver

The RGBW receiver is easily paired with controller by the click of a button. Receiver can be reset to factory settings at any time.

Each receiver can store one static RGB color, one color sequence, and one brightness setting for the white LED strip. Receivers assigned to the same scene within the same zone will have the same LED static color and color sequence.

Operating Voltage
12-36 VDC

Power Capacity
up to 96W at 24V

Operating Temperature Range
from -4°F to +122°F in case



MODEL

RGBW-SR

RGBW-SR - RGBW signal repeater

Extends identical signal when connected in series to an RGBW LED control system. The RGBW signal repeater works with Luminii RGB and RGBW controllers, receivers, and decoders.

RGBW signal can be extended indefinitely when adequate power supply (not included) is connected to the system.

Operating Voltage
12-36 VDC

Power Capacity
up to 96W at 24V

Operating Temperature Range
from -4°F to +122°F in case



MODEL

DDMX-RGBW

DDMX-RGBW - DMX decoder

Translates controller DMX512 programs for RGB and white LED strips.

Unique DMX address for the decoder can be set easily and displayed by the numeric display on the case. Changing and resetting the DMX address requires manual input.

Use power repeater to expand output.

Operating Voltage
12-36 VDC

Power Capacity
up to 96W at 24V

Operating Temperature Range
from -4°F to +122°F in case

Plexineon Surface Mount

RGB, RGBW and RGBW Pixel



Controllers and Decoders

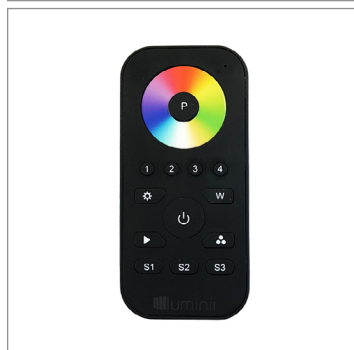

MODEL

RGBW-MC3

RGBW-MC3-4-zone RGBW controller

Easy to operate wireless interface suitable for static or color changing scenes. Control 4 different color zones separately or at the same time. RGBW receiver (RGBW-RC-R) required for operation. Assign multiple receivers per zone to cover a large area.

Color wheel enables highly stable and sensitive color control functionality. Create your own color changing sequences with ease and flexibility.

Power

qty 3 AAA batteries

Scenes

up to 4 unique zones

Signal

Wireless (RF)

Energy Saving

Deactivates after 10 seconds of inactivity

Color Parameters

- Brightness
- Saturation
- Primary colors
- Speed of color changing sequence
- Fading

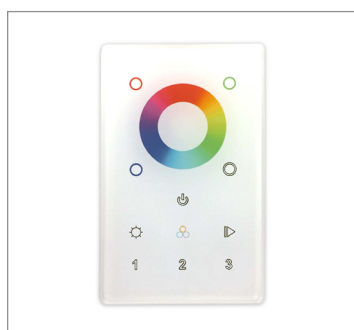

MODEL

ZONES

COLOR

DMX - DMX Controller

3Z - Three Zone
1Z - One Zone

RGBW - Red, Green, Blue, & White

DMX /Wireless RGB-W wall-mount controller controls DMX lighting fixtures, wireless control of RGB-W lighting fixture or use both simultaneously. Fits in any standard US switch box. Includes all the outputs in the back of the controller.

Control brightness levels with a single touch, personalize and memorize 3 different scenes, and even create 3 variations of white.

Features

- 2 in 1 in-Wall Controller: DMX Control or Wireless RGB-W
- 65,000 Color Options, Dimming and Speed Control
- Memory Function
- 50 Foot Wireless Range
- Easily Fits Standard US Switch Boxes
- Touch Sensitive Glass Surface
- Includes 10 Built in Programs, or Create and Play Your Own

Operating Voltage

12 - 24V DC

Color Parameters

- Brightness
- Saturation
- Primary colors
- Fading
- Color changing speed

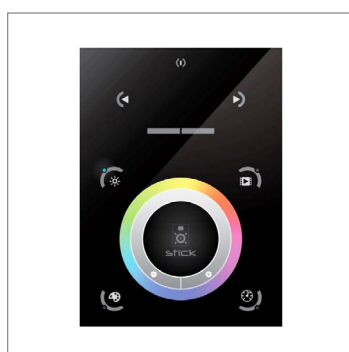

MODEL

TSDMX-E

TSDMX-E - Touchscreen DMX controller

Programmable advanced DMX512 lighting controller featuring a touch-screen interface. Operates as stand alone controller or integrated with most architectural lighting control systems. Can controller endless DMX512 enabled devices.

Mounts to standard single or dual gang wall box with the included power supply inside the junction box. Terminal block design for power and data connections.

Features

- Sleek glass design which sits 0.43" from the wall
- Graphical color display to show selected environment
- Color/dimmer/speed palette
- Color temperature mixing
- Touch sensitive buttons. No mechanical parts
- Touch sensitive wheel allows for accurate color selection
- Multi-zone microSD memory
- Multi-room control with 500 scenes, 10 zones
- 1024 DMX channels. Control 340 RGB fixtures
- USB & Ethernet connectivity for programming and control

Power Supply

7 VDC (included)

Programmability

PC, Mac, Tablet, Smartphone

Output Signal

DMX512 (1024 channels)

Color Parameters

- Brightness
- Saturation
- Speed of color changing sequence
- Fading / dimming / brightness



Controllers and Decoders



MODEL

SR-DMX-SPI

SR-DMX-SPI - Smart Pixel Decoder

The SR-DMX-SPI is a smart LED pixel decoder that controls RGB/RGBW pixel LED strips with SPI signal. Designed with an OLED backlit panel, the pixel controller allows for easy configuration of most settings. Four push buttons are available for control of the LED functions.
*For pixel only.

Features

- 2 in 1 in-Wall Controller: DMX Control or Wireless RGB-W
- SPI signal output for RGB/RGBW pixel light control
- DMX512 controllable and RF/WIFI remote controllable
- Capable of addressing up to 1020 RGB pixels & 765 RGBW pixels
- OLED panel allows for easy configuration

Operating Voltage

12 - 36V DC

Power capacity

up to 96W at 24V

Operating temperature range

from -4°F to +122°F in case



MODEL

DDMX-5CH-RDM-PRO

DDMX-5CH-RDM-PRO-DMX512 Decoder

DMX512 decoder with RDM functionality features 5 PWM output channels with common anode. High PWM output frequency range allows the product to be used in HD video conferencing spaces. All DMX products to be installed per DMX512 Standard.

Power

96 Watt

Inputs

RJ45, XLR-5Pin, Terminal Block

DMX Channels

1 to 5 settable

PWM Output Resolution Ratio

8 or 16 bit

PWM Output Frequency

500Hz - 30KHz

Output Dimming Curve Gamma Value

0.1 ~ 9.9



MODEL

RGBW-WI-R

RGBW-WI-R - WIFI generator

RGBW-WI-R creates a local network that enables any electronic device (phone, tablet, etc.) to control the RGB/W strip connected to a RGBW-RC-R receiver.

The control functions are achieved through a free application download for Android and iOS devices called REALCOLOR.

Operating Voltage

12-36 VDC

Power Supply

PI-130-24 (included)

Operating Temperature Range

from -4°F to +122°F in case