

# MINIMO PRO

WITH PRECISION INTENSE LIGHT ENGINE

STATIC WHITE

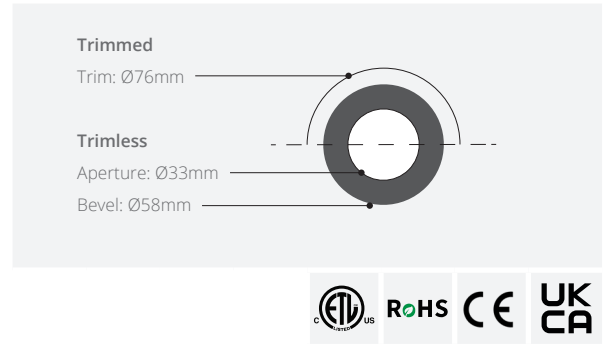

## OVERVIEW

Minimo Pro features the Precision Intense light engine: Precision Intense offers specifiers a high CRI single source beam focused on delivering high peak cd with narrow beams. This is a constant current downlight machined from aerospace grade aluminum 6063-T6 and comes with a range of standard and premium finishes. It has five tool-less site changeable optics for flexible beam distribution. Minimo Pro has up to 35° tilt whilst the integral accessory holder can accommodate a lens or louver for additional glare control.

## KEY FEATURES

- Fixed or 35° adjustable tilt
- Tool-less field changeable optics
- High peak intensity
- Ultra narrow beams
- Beveled or Pinhole aesthetic
- Trimmed or Trimless

	▸ intense ◀				
	Ultra Narrow	Narrow	Medium	Flood	Wide Flood
FWHM	11°	14°	18°	30°	50°
Lumen	661 lm	650 lm	643 lm	555 lm	546 lm
Peak cd	12512 cd	8971 cd	5754 cd	1813 cd	660 cd
CCT	2700K   3000K   3500K   4000K				
CRI Min	92 CRI   92 CRI   92 CRI   90 CRI				
LED Current	0.7 A				
LED Voltage	12V DC				
Wattage	8.4 W				
Efficacy	79 lm/W				
Driver Type	Remote DALI, 0-10V				
Location	IP20   IP54				

\* Luminous Flux @ 3000K as delivered

## LUMINAIRE ORDER CODE - BEVELED APERTURE

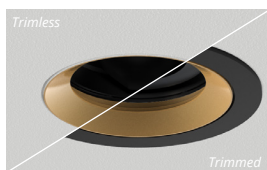

Trim Type	Function	Trim Finish	Aperture Finish	CCT	Beam Angle
RCD Trimmed	631 Fixed IP20	X Trimless	W White RAL 9010	2792 2700K	UN Ultra Narrow 11°
RCT Trimless	633 Fixed IP54	W White RAL 9010	B Black RAL 9005	3092 3000K	NA Narrow 14°
	635 Adjustable IP20	B Black RAL 9005	G Matt Gold Paint	3592 3500K	ME Medium 18°
	637 Adjustable IP54	A Brushed Aluminium		4092 4000K	FL Flood 30°
		R Rubbed Bronze <sup>1</sup>			WF Wide Flood 50°
		P Polished Brass <sup>1</sup>			
		S Brushed Brass <sup>1</sup>			
		C Polished Chrome <sup>1</sup>			

Notes  
<sup>1</sup> Premium & custom finishes are built to order, subject to an extended lead time.  
 Code example: **RCD-636-WW-3092NA**

## LUMINAIRE ORDER CODE - PINHOLE APERTURE

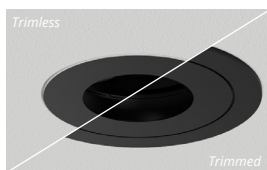

Trim Type	Function	Trim Finish	Aperture Finish	CCT	Beam Angle
RCD Trimmed	632 Fixed IP20	X Trimless	W White RAL 9010	2792 2700K	UN Ultra Narrow 11°
RCT Trimless	634 Fixed IP54	W White RAL 9010	B Black RAL 9005	3092 3000K	NA Narrow 14°
	636 Adjustable IP20	B Black RAL 9005		3592 3500K	ME Medium 18°
	638 Adjustable IP54			4092 4000K	FL Flood 30°
					WF Wide Flood 50°

## DRIVER ORDER CODE

230V Driver		120/277V Driver (North America)	
PSCC-20-700-A-EL	0-10V 0.1% dim. 1-2 lights in series	USCC-30-700-A-EL-ENC	0-10V 0.1% dim. 1-2 lights in series
PSCC-20-700-D-EL	DALI 0.1% dim. 1-2 lights in series	USCC-30-700-D-EL-ENC	DALI 0.1% dim. 1-2 lights in series
		USCC-12-700-P-HT-ENC	Phase (120V) 1% dim. 1 light only

## LIGHT ENGINE SELECTION

Select from Precision's two carefully engineered Static White light engines for Minimo to best suit your application or project needs:

### plus<sup>+</sup>

Precision's Plus light engines offer the best balance between delivered lumens, beam quality and outstanding colour rendition.

- + Increased Lumen Output
- + CRI 98 Typical
- + 2 Step Binning

### ▸ intense ◀

Precision's signature Intense light engines offer tight, surgical beams combined with the highest Peak Intensity values available.

- + Ultra-Tight Beams
- + High Peak Cd
- + 2 Step Binning

## LIFETIME & ENVIRONMENTAL

At Precision, we design and engineer our products with longevity in mind. Many of the components that make up our light fixtures are both modular and re-usable, making it possible to service and repair them throughout their life in service. Once our products reach the end of their useful life, it is possible to re-work and renew them in to a new product. We prioritise the use of recyclable materials in both our products and packaging, and encourage our customers to engage responsibly in the correct disposal of any materials we supply.

### ▸ intense ◀    plus<sup>+</sup>

#### UK PART L

Part L1A / L1B (Dwellings)	●	●
Part L2A (General)	○	○
Part L2A (Display)	●	●
<b>CIBSE TM65</b>	13.09 Kg/CO2e	
<b>CIBSE TM66</b>	2.2	
<b>Lifetime</b>	L90 50,000 hrs min	
<b>Warranty</b>	5 Years	

# MINIMO PRO

WITH PRECISION INTENSE LIGHT ENGINE

STATIC WHITE

## MECHANICAL

<b>Location</b>	IP20 or IP54	<b>Ceiling Thickness</b>	3-25mm
<b>Mounting</b>	Recessed - non-insulation-coverable	<b>Cutout</b>	ø65mm
<b>Adjustability</b>	Fixed or 35° Tilt, 360° Rotation	<b>Min Void</b>	110mm
<b>Material</b>	Aluminium 6063-T6	<b>Optics</b>	Site Changeable
<b>Weight</b>	250g		

## DIMENSIONS

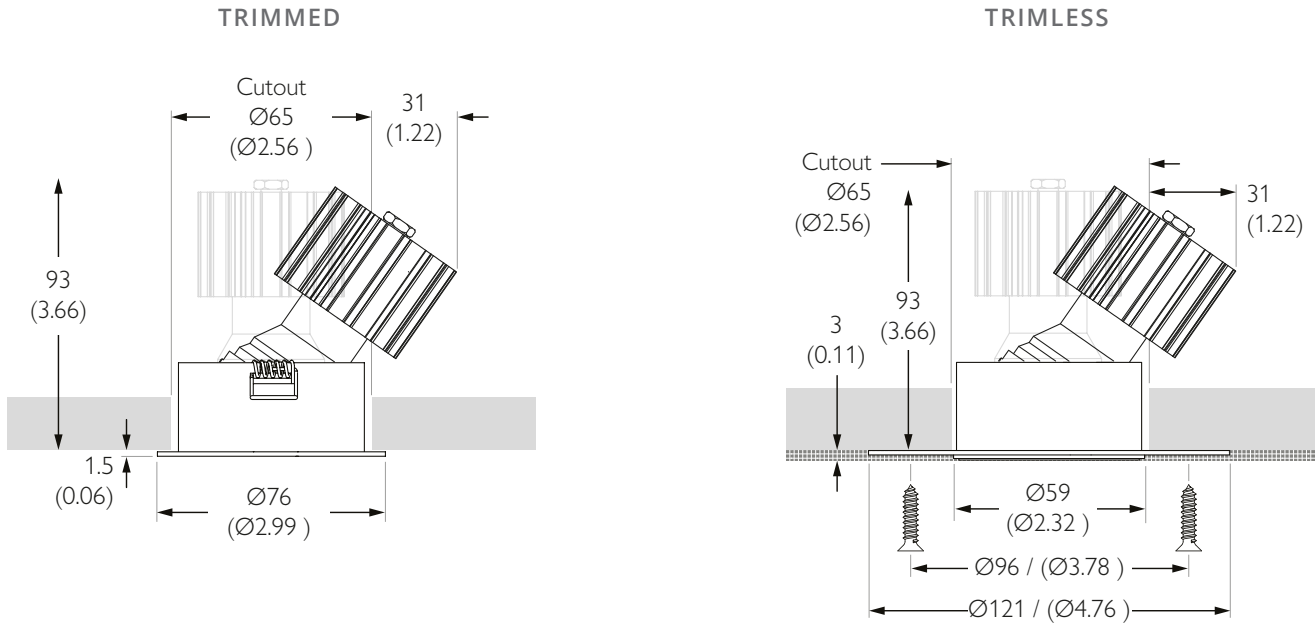

## REMOTE DRIVER DIMENSIONS

<b>Dim Type</b>	0-10V	DALI
<b>Voltage In</b>	230V AC	230V AC
<b>Min Dim %</b>	0.1%	0.1%
<b>Wiring Length</b>	36m series	36m series
<b>Code</b>	PSCC-20-700-A-EL	PSCC-20-700-D-EL

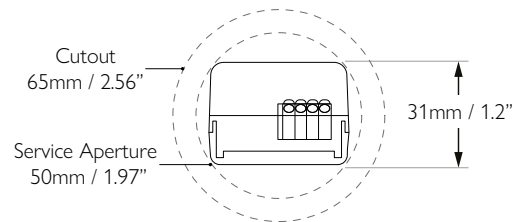
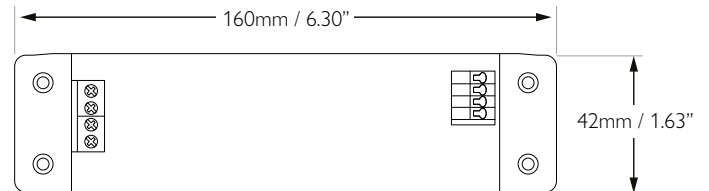

<b>Dim Type</b>	0-10V	DALI	Phase
<b>Voltage In</b>	120/277V AC	120/277V AC	120V AC
<b>Min Dim %</b>	0.1%	0.1%	1%
<b>Wiring Length</b>	36m series (118')	36m series (118')	3m (9')
<b>Length (L)</b>	348mm (13.7\")	348mm (13.7\")	247mm (9.7\")
<b>Code</b>	USCC-30-700-A-EL-ENC	USCC-30-700-D-EL-ENC	USCC-12-700-P-HT-ENC

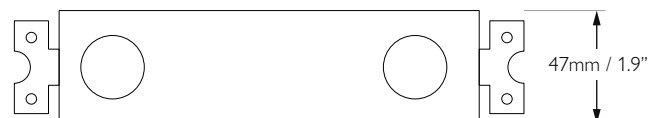
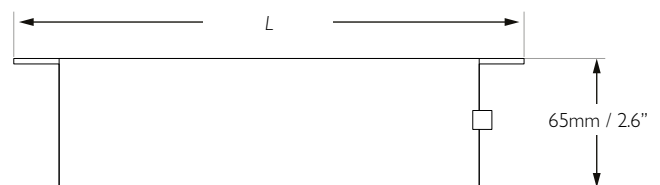

# MINIMO PRO

WITH PRECISION INTENSE LIGHT ENGINE

STATIC WHITE

## TRIM & APERTURE TYPES



TRIMMED  
PINHOLE



TRIMLESS  
PINHOLE



TRIMMED  
BEVELED



TRIMLESS  
BEVELED

## TRIM FINISHES

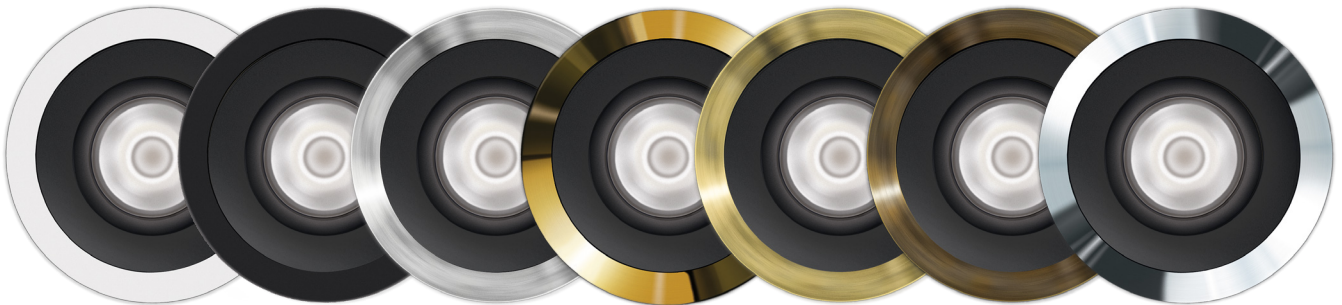

WHITE

BLACK

BRUSHED  
ALUMINUM

POLISHED  
BRASS

BRUSHED  
BRASS

RUBBED  
BRONZE

POLISHED  
CHROME

## APERTURE FINISHES



BEVELED

PINHOLE

BLACK

MATTE GOLD

WHITE

WHITE

BLACK

# MINIMO PRO

WITH PRECISION INTENSE LIGHT ENGINE

STATIC WHITE

## OUTPUT SCALING

CCT	Multiplier	CRI	R9	Rf	Rg	Max Delivered lm
2400K	-	-	-	-	-	-
2700K	0.93	92	60	90	98	615lm
<b>3000K</b>	<b>1.00</b>	<b>92</b>	<b>61</b>	<b>90</b>	<b>99</b>	<b>661lm</b>
3500K	1.00	92	60	90	99	661lm
4000K	1.08	92	60	90	99	714lm

All diagrams and data measured at 3000K.

## PHOTOMETRY

Beam Type	FWHM	Delivered Flux	Peak Intensity	UGR
<b>Ultra Narrow</b>	11°	661 lm	12512 cd	UGR 13
<b>Narrow</b>	14°	650 lm	8971 cd	UGR 13.3
<b>Medium</b>	18°	643 lm	5754 cd	UGR 13.7
<b>Flood</b>	30°	555 lm	1831 cd	UGR 15.9
<b>Wide Flood</b>	50°	546 lm	660 cd	UGR 20.5

Beam Type	Beam Diameter (m)	Beam Diameter (ft)	Peak Intensity (cd)	Footcandle (fc)
Ultra Narrow	0.19m	0.6'	12512lx	1390fc
	1m	3'	348fc	1.2'
	0.39m	1.2'	3128lx	348fc
	2m	6'	154fc	1.7'
	0.58m	1.9'	1390lx	87fc
Narrow	0.25m	0.7'	8971lx	997fc
	1m	3'	249fc	1.5'
	0.49m	1.5'	2243lx	111fc
	2m	6'	997lx	62fc
	0.74m	2.2'	997lx	40fc
Medium	0.32m	1.0'	5754lx	639fc
	1m	3'	160fc	1.9'
	0.63m	1.9'	1439lx	71fc
	2m	6'	639lx	40fc
	0.95m	2.9'	639lx	26fc
Flood	0.54m	1.6'	1831lx	201fc
	1m	3'	50fc	3.2'
	1.07m	3.2'	453lx	22fc
	2m	6'	201lx	13fc
	1.61m	6.4'	201lx	8fc
Wide Flood	0.93m	2.8'	660lx	73fc
	1m	3'	18fc	5.6'
	1.87m	5.6'	165lx	8fc
	2m	6'	73lx	5fc
	2.80m	8.4'	73lx	3fc

## OPTICS & ACCESSORIES

MicroLens optics can be changed in the field by simply unscrewing the optic cap, avoid touching the exposed LED when changing optic.

Optics				
				
<b>Ultra Narrow Microlens</b> For Minimo Intense	<b>Narrow Microlens</b> For Minimo Intense	<b>Medium Microlens</b> For Minimo Intense	<b>Flood Microlens</b> For Minimo Intense	<b>Wide Flood Microlens</b> For Minimo Intense
<b>Order Code</b> 921-01	<b>Order Code</b> 921-02	<b>Order Code</b> 921-03	<b>Order Code</b> 921-04	<b>Order Code</b> 921-05

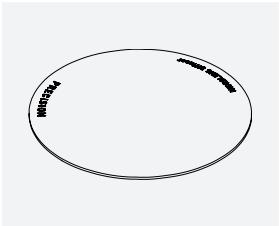
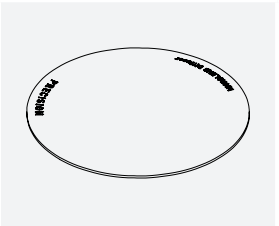
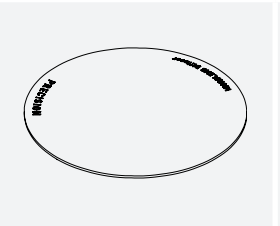
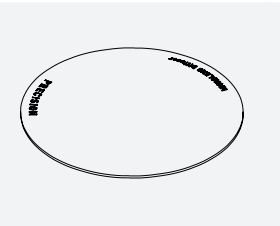
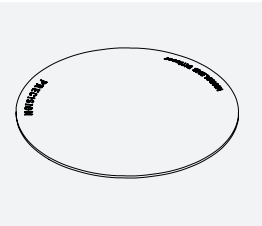
Minimo Intense can accommodate up to 1 accessory.

Glare Control	Colour Modifiers	
		
<b>Honeycomb Louvre</b> Ø32x3.2mm   Ø1.26x0.126"	<b>1/4 CTO Filter</b> Ø32 x 18mm   Ø1.26 x 0.071"	<b>Custom Colour Filter</b> Ø32 x 18mm   Ø1.26 x 0.071"
<b>Order Code</b> 995-32-BK	<b>Order Code</b> 997-1/4CTO-32	<b>Order Code</b> Contact Sales Rep

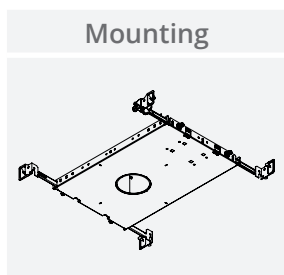

**Pan frame with hangers**  
406-610mm | 16-24" spacing  
**Order Code**  
MP-PAN-NIC



# MINIMO PRO

precision  
by luminii

WITH PRECISION INTENSE LIGHT ENGINE

STATIC WHITE

## LUMINAIRE MODULE DETAILS

