

LIN Channel - Installation Instructions

Models LINC-XX



7777 Merrimac Ave
Niles, IL 60714
T 224.333.6033
F 224.757.7557
info@luminii.com
www.luminii.com

REVO.2
02102025

1 / 5

Please read all instructions prior to installation and keep for future reference!

1. PRODUCT TO BE INSTALLED BY A QUALIFIED ELECTRICIAN.
2. USE ONLY WITH CLASS 2 POWER UNIT.
3. 24 VOLTS DC.
4. SUITABLE FOR DAMP LOCATIONS.
5. SUITABLE FOR INSTALLATION WITHIN THE CLOSET STORAGE SPACE.
6. INHERENTLY PROTECTED

Field Preparation

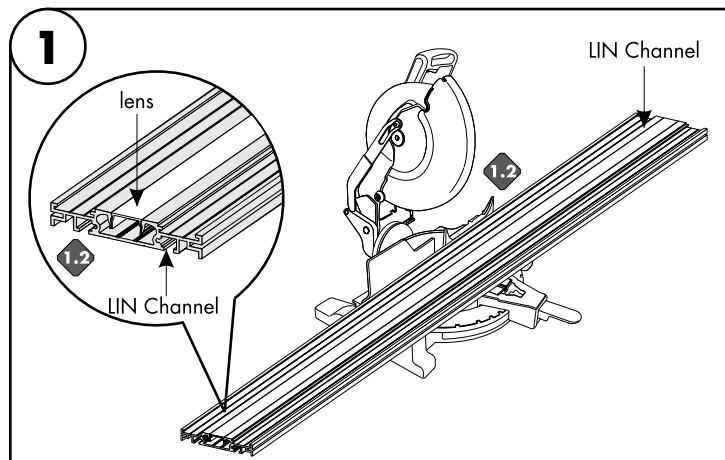
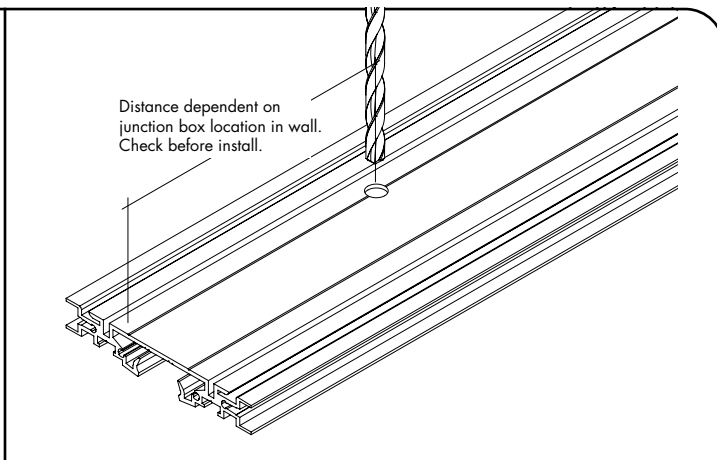
	
<p>1.1 Measure the area where the LIN Channel will installed.</p> <p>1.2 Carefully cut the LIN Channel & lens in the field. Using the proper aluminum saw blade, then cut to the desired length.</p>	<p>1.3 After locating junction box location in wall, measure distance on extruding and using a hand drill, drill a large hole, 0.375" using the groove as guidance. De-burr the opening or add a bushing/grommet to protect the power feed cable from damage.</p>

Connecting Extrusion Sections

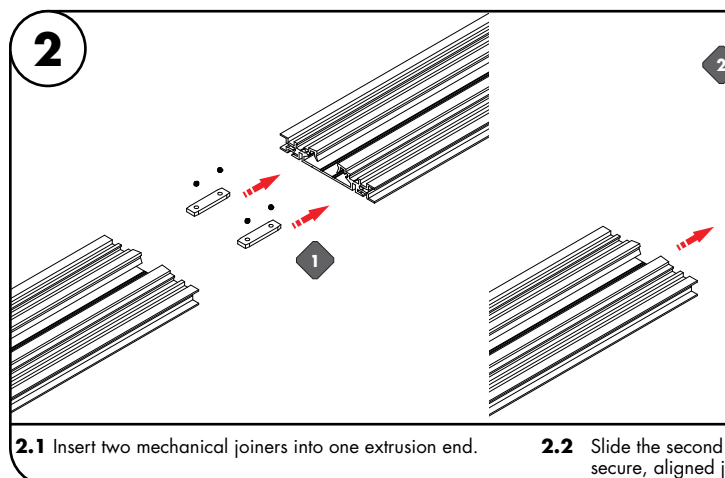
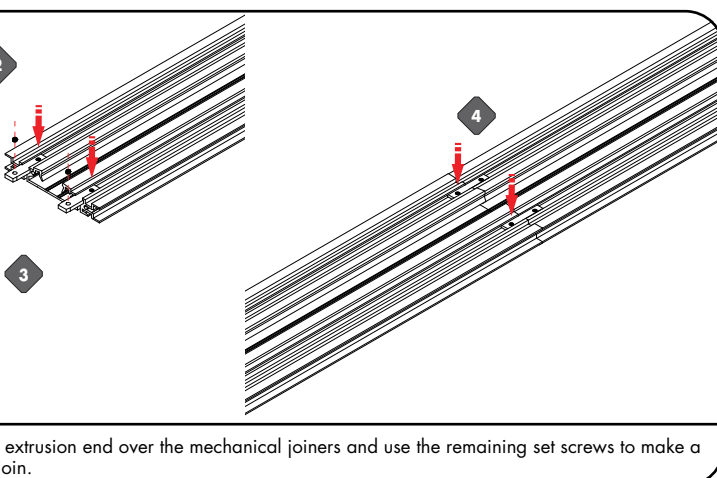
	
<p>2.1 Insert two mechanical joiners into one extrusion end.</p>	<p>2.2 Slide the second extrusion end over the mechanical joiners and use the remaining set screws to make a secure, aligned join.</p>

Tape Installation

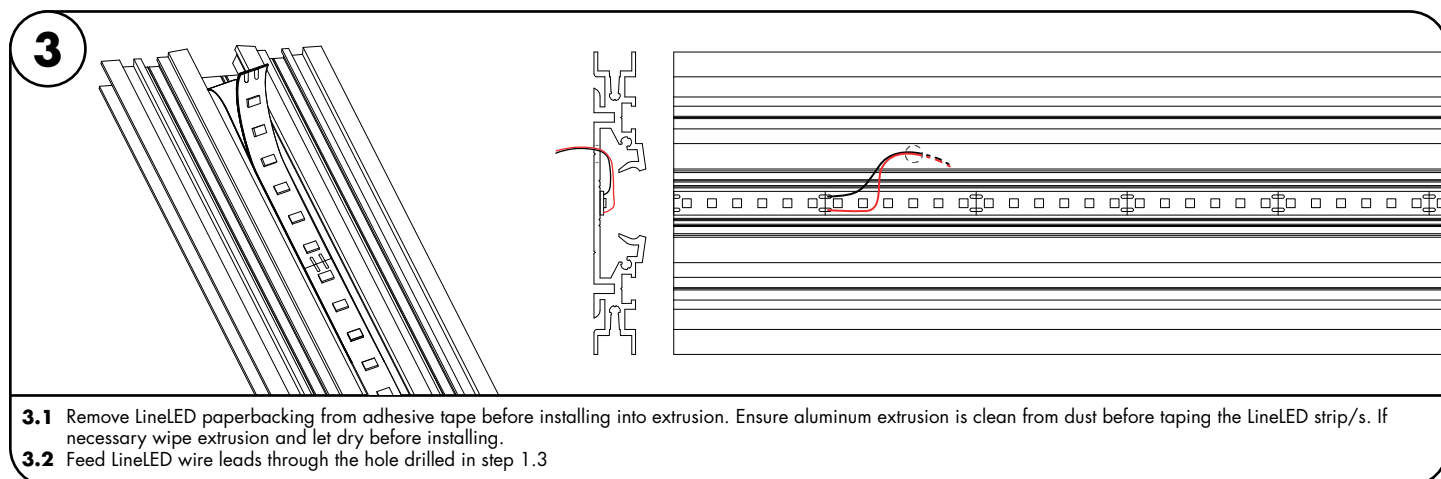
<p>3.1 Remove LineLED paperbacking from adhesive tape before installing into extrusion. Ensure aluminum extrusion is clean from dust before taping the LineLED strip/s. If necessary wipe extrusion and let dry before installing.</p> <p>3.2 Feed LineLED wire leads through the hole drilled in step 1.3</p>

LIN Channel - Installation Instructions

Models LINC-XX



7777 Merrimac Ave
Niles, IL 60714
T 224.333.6033
F 224.757.7557
info@luminii.com
www.luminii.com

REVO.2
02102025

2 / 5

Please read all instructions prior to installation and keep for future reference!

1. PRODUCT TO BE INSTALLED BY A QUALIFIED ELECTRICIAN.
2. USE ONLY WITH CLASS 2 POWER UNIT.
3. 24 VOLTS DC.
4. SUITABLE FOR DAMP LOCATIONS.
5. SUITABLE FOR INSTALLATION WITHIN THE CLOSET STORAGE SPACE.
6. INHERENTLY PROTECTED

Endcap Installation

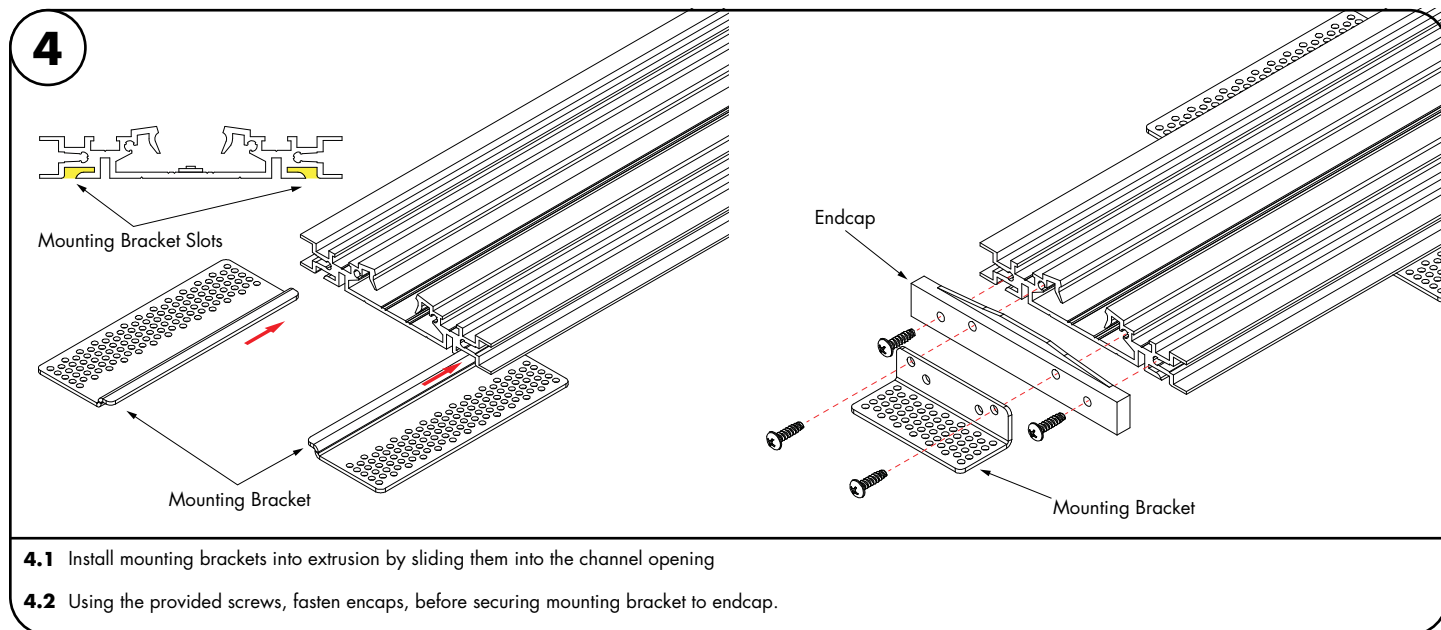

Lens Installation

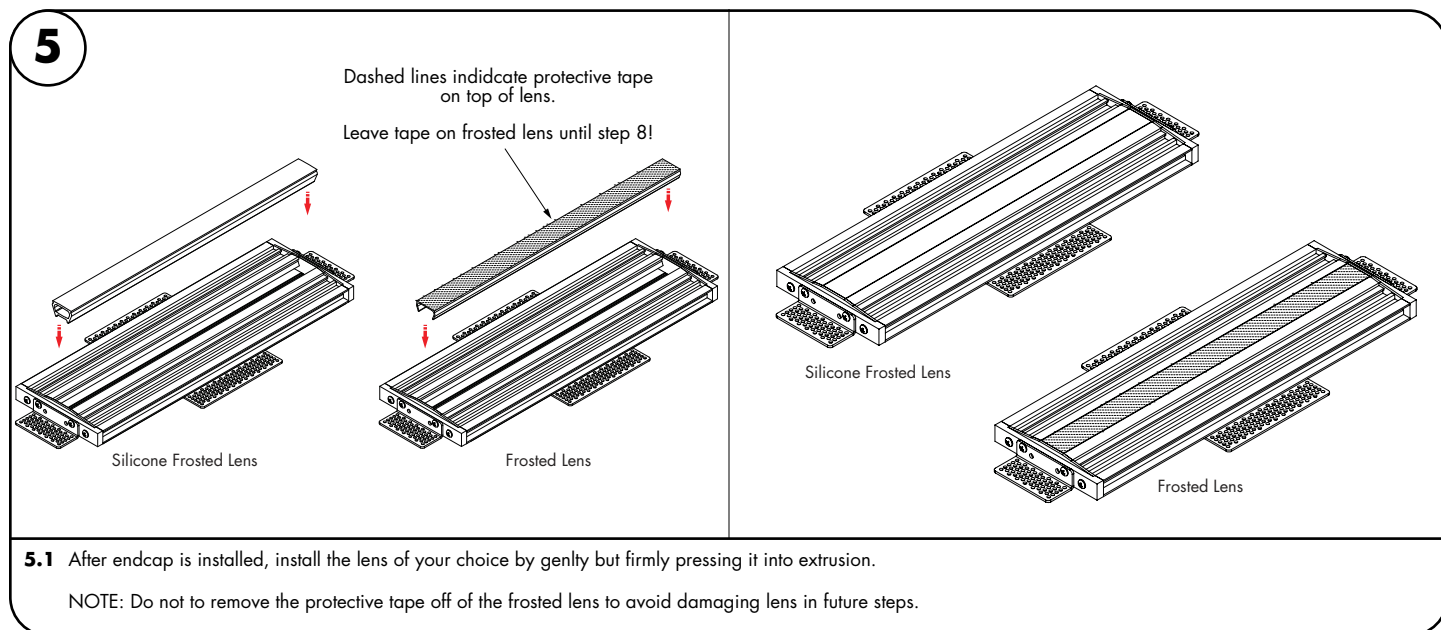

LIN Channel - Installation Instructions

Models LINC-XX



7777 Merrimac Ave
Niles, IL 60714
T 224.333.6033
F 224.757.7557
info@luminii.com
www.luminii.com

REVO.2
02102025

3 / 5

Please read all instructions prior to installation and keep for future reference!

1. PRODUCT TO BE INSTALLED BY A QUALIFIED ELECTRICIAN.
2. USE ONLY WITH CLASS 2 POWER UNIT.
3. 24 VOLTS DC.
4. SUITABLE FOR DAMP LOCATIONS.
5. SUITABLE FOR INSTALLATION WITHIN THE CLOSET STORAGE SPACE.
6. INHERENTLY PROTECTED

Powerfeed Connection

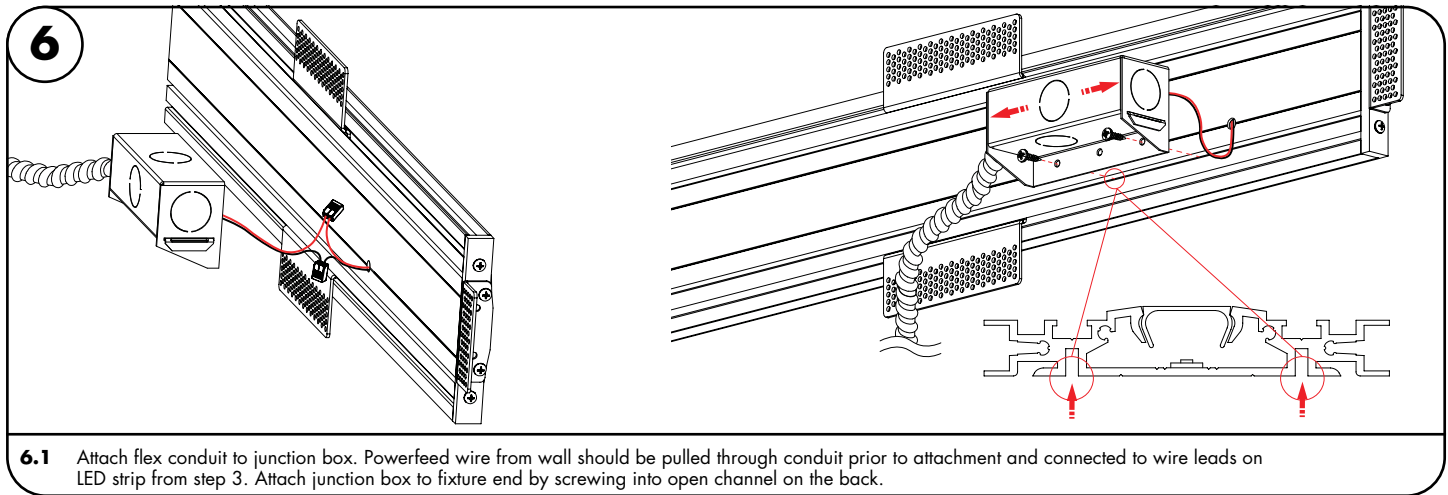

- 6.1** Attach flex conduit to junction box. Powerfeed wire from wall should be pulled through conduit prior to attachment and connected to wire leads on LED strip from step 3. Attach junction box to fixture end by screwing into open channel on the back.

Wall Install

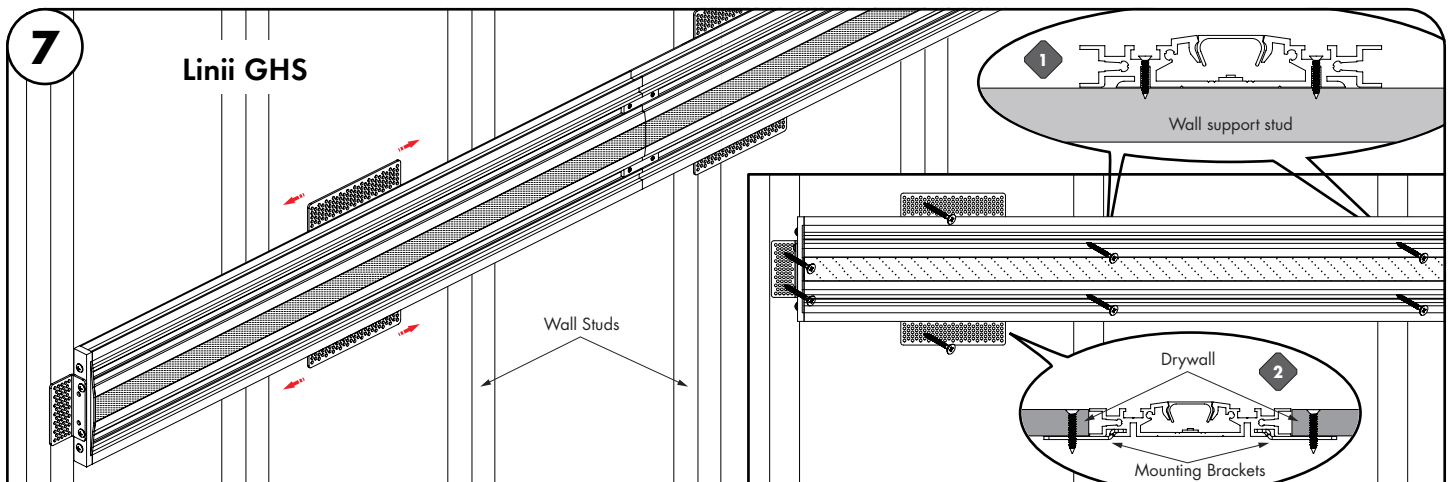

- 7.1** Before drywall is installed place Linii extrusion on wall and screw into place with drywall screws as shown in figure 1. Mounting brackets can be moved to be placed in best positions to attach fixture to drywall (as shown in figure 2) when wall studs are unavailable such as vertical installation. Makes sure to test the fixture works before installing drywall and beginning the mud-in process.

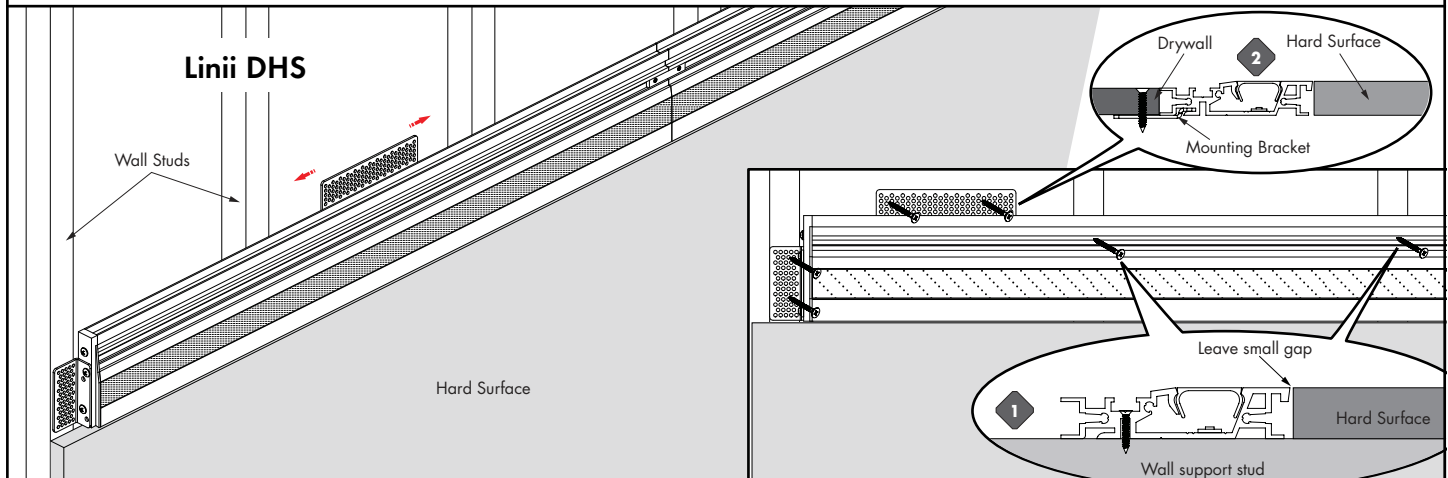

- 7.2** Before drywall is installed place Linii extrusion on wall studs, leaving a small gap to the hard surface, and screw into place with drywall screws as shown in figure 1. Mounting brackets can be moved to be placed in best positions to attach fixture to drywall (as shown in figure 2) when wall studs are unavailable such as vertical installation. Test the fixture to make sure it works before installing drywall and beginning the mud-in process.

LIN Channel - Installation Instructions

Models LINC-XX

Please read all instructions prior to installation and keep for future reference!

1. PRODUCT TO BE INSTALLED BY A QUALIFIED ELECTRICIAN.
2. USE ONLY WITH CLASS 2 POWER UNIT.
3. 24 VOLTS DC.
4. SUITABLE FOR DAMP LOCATIONS.
5. SUITABLE FOR INSTALLATION WITHIN THE CLOSET STORAGE SPACE.
6. INHERENTLY PROTECTED



REVO.2
02102025

4 / 5



7777 Merrimac Ave
Niles, IL 60714
T 224.333.6033
F 224.757.7557
info@luminii.com
www.luminii.com

Mud-In Process

8

Linii GHS

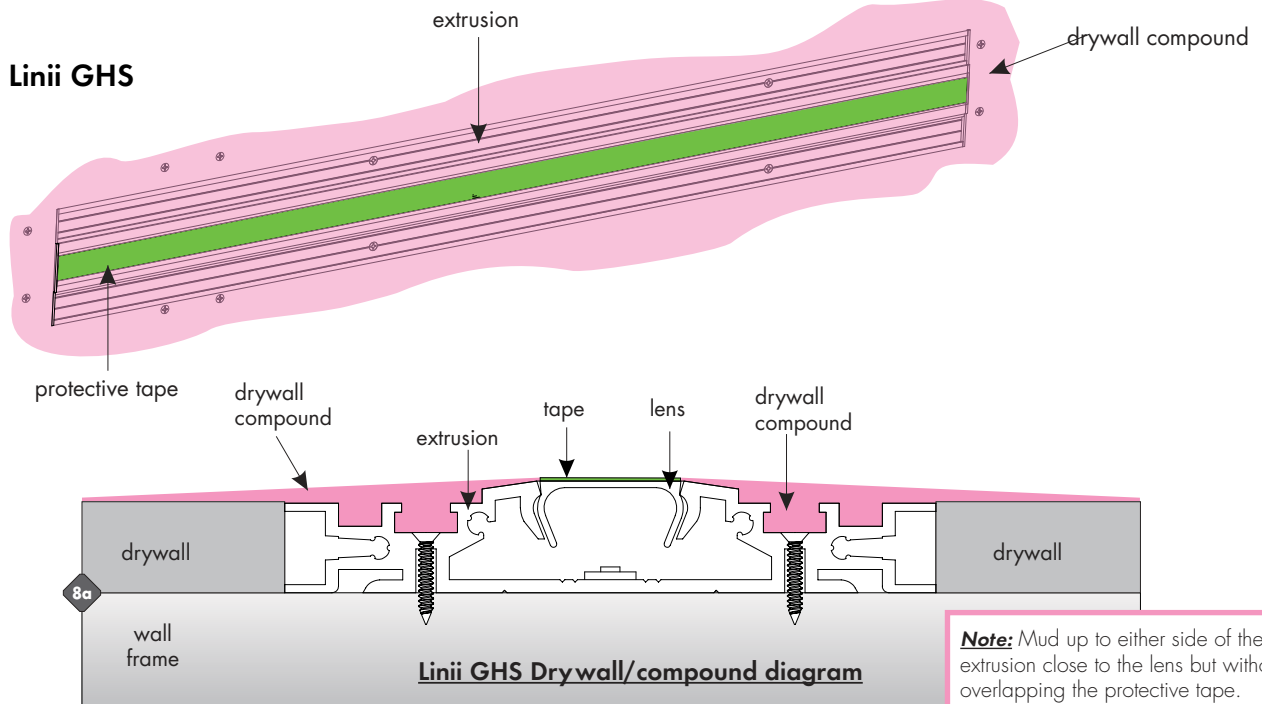

Note: Mud up to either side of the extrusion close to the lens but without overlapping the protective tape.

8.1 Place a coat of durabond on each side of the extrusion (reference diagram 8a) for a strong bond. Followed by a light sand to blend to the drywall. If necessary finish any imperfections with a light compound. Then paint to complete installation.

Linii DHS

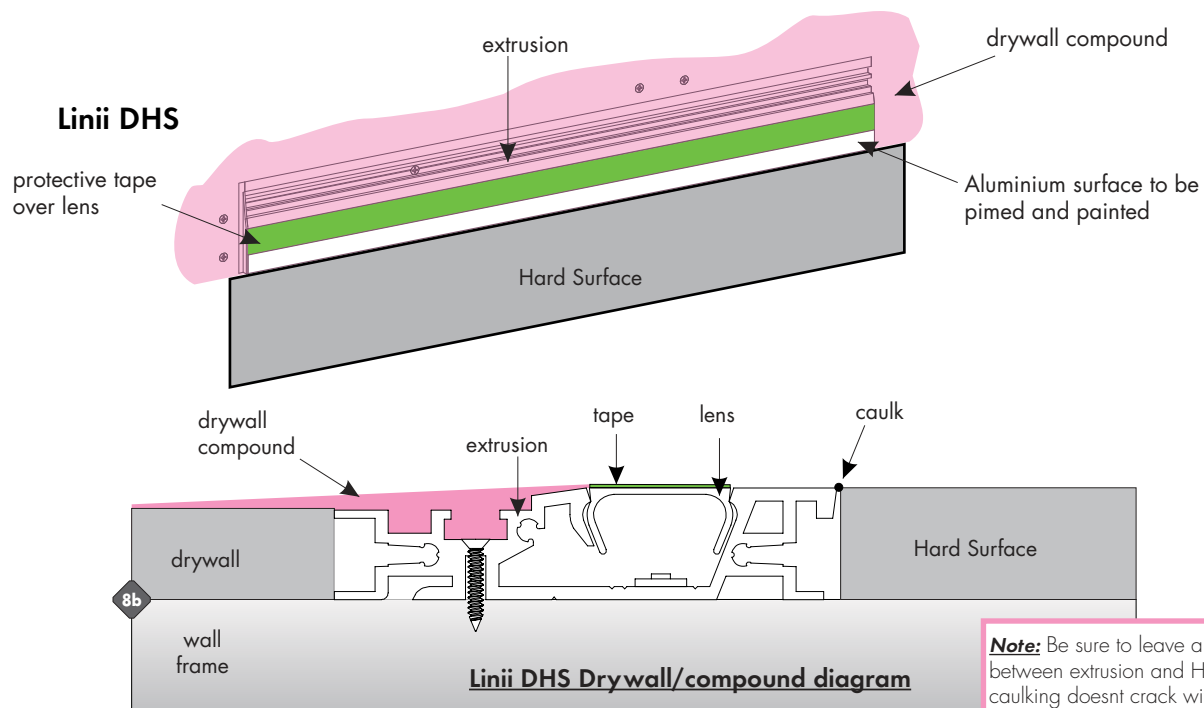

Note: Be sure to leave a small gap between extrusion and Hard Surface so caulking doesn't crack with movement

8.2 Place a coat of durabond on the drywall side (reference diagram 8a) for a strong bond. Followed by a light sand to blend to the drywall. If necessary finish any imperfections with a light compound. Place a bead of caulk between the Aluminium surface and hard surface. This surface needs to be primed and painted.

LIN Channel - Installation Instructions

Models LINC-XX

Please read all instructions prior to installation and keep for future reference!

1. PRODUCT TO BE INSTALLED BY A QUALIFIED ELECTRICIAN.
2. USE ONLY WITH CLASS 2 POWER UNIT.
3. 24 VOLTS DC.
4. SUITABLE FOR DAMP LOCATIONS.
5. SUITABLE FOR INSTALLATION WITHIN THE CLOSET STORAGE SPACE.
6. INHERENTLY PROTECTED



REVO.2
02102025

5 / 5



7777 Merrimac Ave
Niles, IL 60714
T 224.333.6033
F 224.757.7557
info@luminii.com
www.luminii.com

Mud-In Process

9

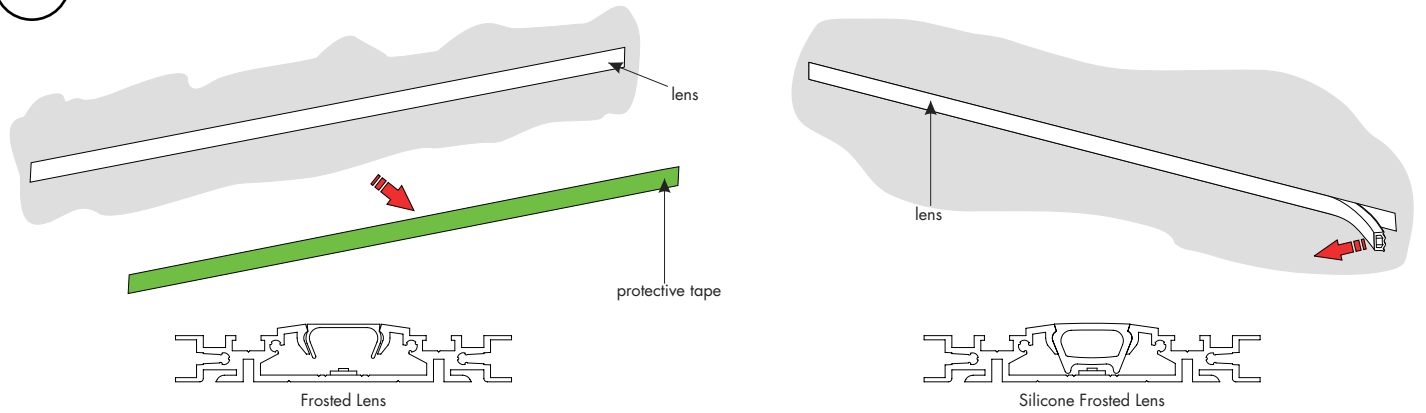

- 9.1** If using the Frosted Lens remove the protective tape after the mudin process is complete and to any final touches in making sure the lens is clean.
- 9.2** If using the Silicone Frosted Lens, remove the lens from the fixture and clean off any remaining mud-in material before re-installing it into the fixture on the wall.