

LETO 11 MINI

SURFACE MOUNT CYLINDER
TUNABLE WHITE & WARM DIM



Features

- Faceted metal reflectors provide beam spreads between 20° to 60°.
- Three output options available up to 1500 lumens.
- Nine drivers selections available to cover wide range of applications.
- Five year warranty.

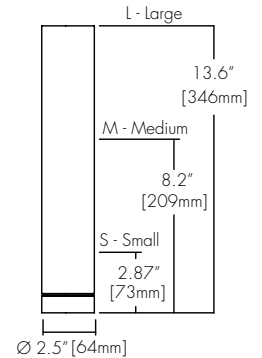
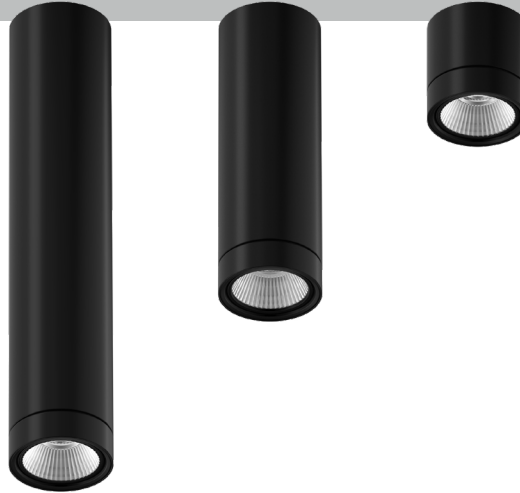

Finish Options

- White
- Silver
- Mocha
- Firebrick
- Warm Nickel
- Black
- Charcoal
- Cerulean
- Bronze
- Aged Brass

Technical Information

TYPE	WD1830		TW2765
OUTPUT OPTIONS	700 lm (S/M/L)	1000 lm (M/L)	1500 lm (M/L)
Fixture wattage	7.2 W	11.4 W	16.5 W
Delivered Lumen	819 lm	1288 lm	1617 lm
Efficacy	114 lm/W	113 lm/W	98 lm/W
Center Beam Candlepower (20° Faceted Reflector)	1689 cd	2680 cd	3464 cd

CCT	CRI	TM-30		
		R _f	R _g	R ₉
1800K	94	90	93	61
3000K	94	89	97	72
2700K	91	90	96	59
6500K	93	87	97	73

Ordering Code

Integral Driver Example: Fixture LET11M-SM-S-07-25K-WD1830-F20-NA-WH-WH-RDS-WH-PHSD-NA

Remote Driver Example: Fixture LET11M-SM-S-07-25K-WD1830-F20-NA-WH-WH-RDS-WH-PHSD-NA-HRM-LET11M-SM-07-25K-PHSD-NA

Fixture

MODEL	TYPE	SIZE	OUTPUT	CCT	OPTIC	ACCESSORY	BODY FINISH	BAFFLE FINISH
LET11M-Leto 11 Mini	SM-Surface Mount	S-Small ⁴	07-700 lumens (7.2W)	WD1830-Warm Dim, 1800K-3000K	F20-20 Degree, Faceted F30-30 Degree, Faceted F60-60 Degree, Faceted	NA-No Accessory DL-Diffusing Lens HC-Honeycomb Louver ⁴	Standard WH-White BK-Black S-Silver	Standard WH-White BK-Black S-Silver
		M-Medium L-Large	07-700 lumens (7.2W) 10-1000 lumens (11.4W)	WD1830-Warm Dim, 1800K-3000K		Premium ³ MA-Mocha CC-Charcoal CR-Cerulean FB-Firebrick BZ-Bronze WN-Warm Nickel AB-Aged Brass	Premium ³ MA-Mocha CC-Charcoal CR-Cerulean FB-Firebrick BZ-Bronze WN-Warm Nickel AB-Aged Brass	
		M-Medium L-Large	15-1500 lumens (16.5W)	TW2765-Tunable White, 2700K-6500K ^{1,2}				

CANOPY/ HOUSING	CANOPY FINISH	DRIVER	DRIVER OPTIONS ⁸
RDS-Round Slim RDR-Round Semi-Recessed	Standard WH-White BK-Black S-Silver Premium ³ MA-Mocha CC-Charcoal CR-Cerulean FB-Firebrick BZ-Bronze WN-Warm Nickel AB-Aged Brass	PHSD-Forward/Reverse Phase, 1% Dimming, 120V Only 010S-0-10V, 1% Dimming, 120/277V 0103-0-10V, 1% Dimming, 347V Only ⁶ 010L-EldoLED, 0-10V, Linear, 0.1% Dimming, 120/277V ⁶ 010G-EldoLED, 0-10V, Log, 0.1% Dimming, 120/277V ⁶ DALI-EldoLED, DALI Protocol 2, DT-6, 0.1% Dimming, 120/277V ⁶ DALI8-EldoLED, DALI Protocol 2, DT-8, 0.1% Dimming, 120/277V ⁶ LUTE-Lutron Hilume Ecodigital, 1% Dimming, 120V/277V ^{5,6} DMX-EldoLED, DMX, 0.1% Dimming, 120V/277V ⁶	NA-None EMG-Emergency Driver ^{6,7}

1 - TW2765 only available with Drivers 010L/010G/DALI8/DMX. Not available with EMG driver option.
2 - TW2765 requires HRM - Remote Power Supply.
3 - Premium finishes may have extended lead times. Custom RALs are available, please consult Inside Sales with specific request.
4 - Size Small is not available with accessory HC Honeycomb.
5 - LUTE driver is not available at 700 lumens.

6 - Drivers 0103/010L/010G/DALI/DALI8/DMX/LUTE/EMG are only available with HRM - Remote Power Supply.
7 - Emergency option comes prewired from factory with driver in remote housing. 8WV of continuous power provided for a minimum of 90 minutes. Must be installed within 30 feet of luminaire using 18 AWG wire. Not available with 0103, DMX, DALI8 or LUTE Driver.
8 - AVNRR/CSMB available upon request.

CONTACT FACTORY FOR MORE OPTIONS.

LETO 11 MINI

SURFACE MOUNT CYLINDER
TUNABLE WHITE & WARM DIM

Canopy

RDS

Round Slim Canopy

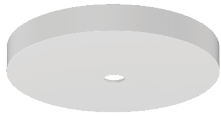
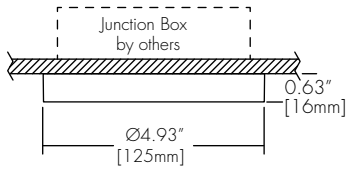

RDS	
Integral Drivers	PHSD, 010S
Remote Drivers	0103, 010L, 010G, DALI, DALI8, LUTE, DMX

RDR

Semi-Recessed

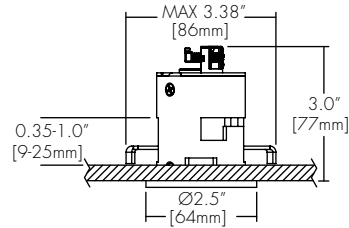

RDR	
Integral Drivers	
Remote Drivers	PHSD, 010S, 0103, 010L, 010G, DALI, DALI8, LUTE, DMX

Lens & Accessory Options

DL

Diffusing Lens



HC

Honeycomb



Optics

FXX (20°, 30°, 60°)

Faceted Reflector



LETO 11 MINI

SURFACE MOUNT CYLINDER
TUNABLE WHITE & WARM DIM

Remote Driver Housing

Depending on the options selected in the order code on page 1, a Remote Driver Housing may be required. This will automatically be generated and put on your order as necessary.

REMOTE DRIVER	MODEL	OUTPUT	CCT	DRIVER	DRIVER OPTIONS
HRM-Housing, Remote	LET11M-SM-Leto 11 Mini Surface Mount	Same as Fixture	Same as Fixture	Same as Fixture	Same as Fixture

Maximum mounting distance to luminaire using 18 AWG wire							
010S	0103	PHSD	010L	010G	DALI	DMX	LUTE
16'	16'	16'	72'	72'	72'	149'	15'

4" J-box

Minimum volume required to mount drivers in junction box: 70mm x 40mm x 30mm.

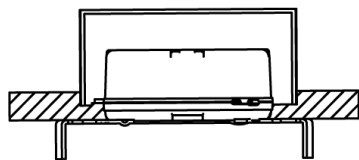

Canopy	+	Driver
RDS	+	PHSD
RDS	+	010S

HRM Single with Externally Mounted Driver

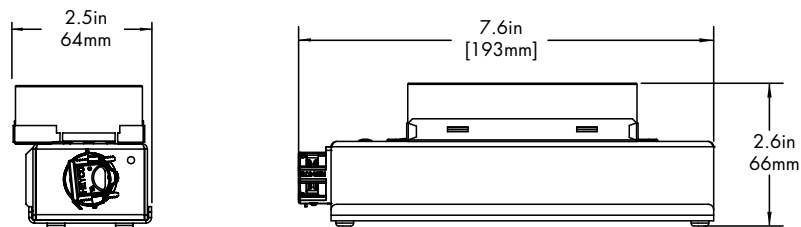

Driver
0103
010L
010G
010S
DALI
LUTE

HRM Double

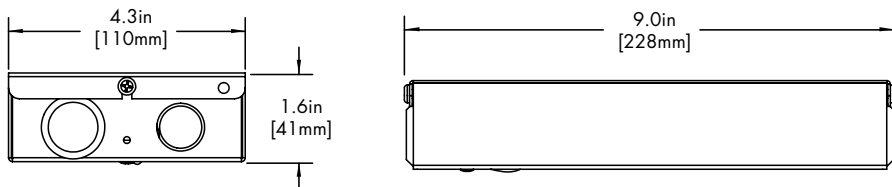

Driver
DALI8
DMX

HRM Cylinder Driver

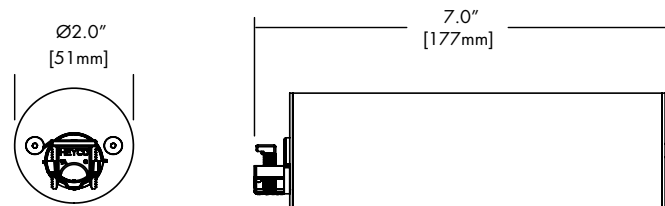

Canopy	+	Driver
RDR	+	010S
RDR	+	PHSD

EMG Emergency Driver

120 minute EMG operation time.

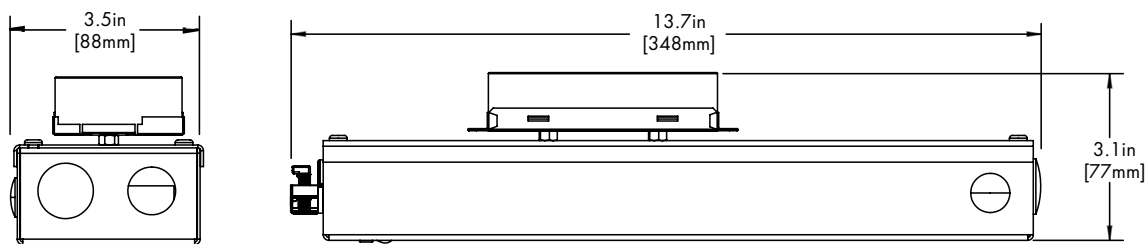

Driver
EMG

LETO 11 MINI

SURFACE MOUNT CYLINDER
TUNABLE WHITE & WARM DIM

Standard Finishes

BK
Black



WH
White



SL
Silver



Premium Finishes

MA
Mocha



CC
Charcoal



CR
Cerulean



FB
Firebrick



BZ
Bronze



WN
Warm Nickle



AB
Antique Bronze



LETO 11 MINI

SURFACE MOUNT CYLINDER
TUNABLE WHITE & WARM DIM

TM-30

Warm Dim 1800K

COLOR VECTOR GRAPHIC

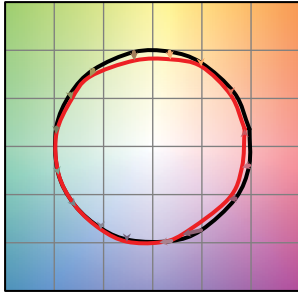

— Reference Source — Test Source

Warm Dim 3000K

COLOR VECTOR GRAPHIC

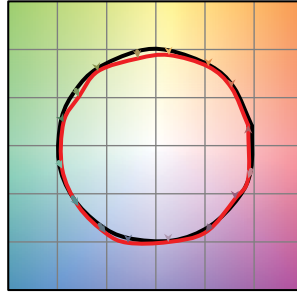

— Reference Source — Test Source

Tunable White 2700K

COLOR VECTOR GRAPHIC

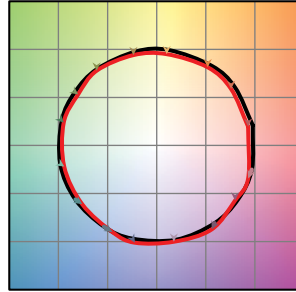

— Reference Source — Test Source

Tunable White 6500K

COLOR VECTOR GRAPHIC

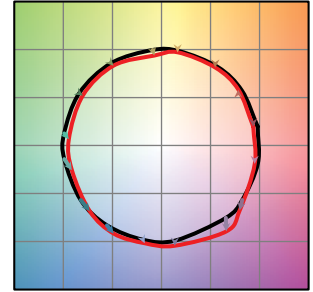

— Reference Source — Test Source

Photometry

20° Faceted Reflector

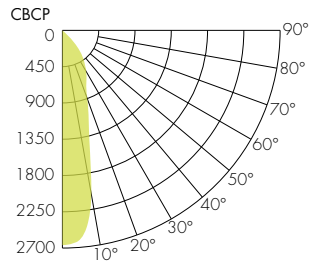
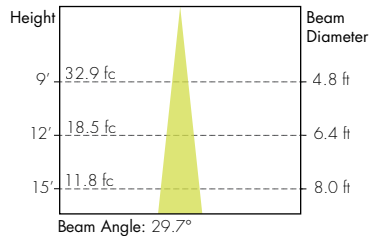

30° Faceted Reflector

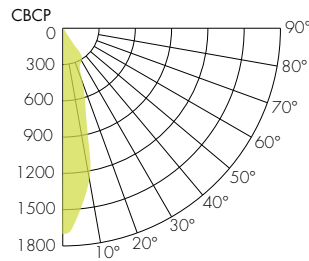
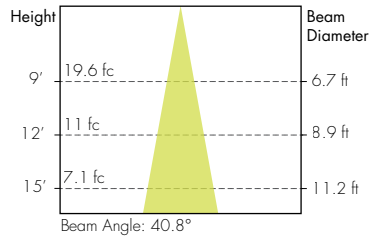

60° Faceted Reflector

