

Features

Kurba Max is a dot free direct view, highly versatile, energy efficient and flexible LED strip suitable for outdoor wet locations capable of horizontal/side bends and vertical/top bends with a 400mm bending diameter. The silicone material offers excellent heat, weather, UV, and solvent resistance and has a special coating to repel dust and dirt accumulation.

Output Options

- 2-Wire Warm Dim gradually warms the color temperature as you dim down the brightness
- Tunable White allows individual control of CCT and output

Average Life (L70)

50,000 hours

Approvals

CE, UKCA, UL676, Class 2, IP68

Warranty

5 years

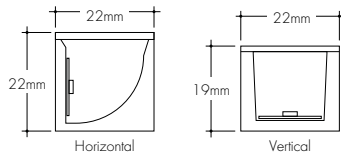

Finish Options

Base White



Technical Information

Bending Direction	Horizontal		Vertical	
	WD59SO	TW51SO	WD59SO	TW51SO
Output				
Light Output (all channels full on) 80 CRI	525 lm/m	548 lm/m	669 lm/m	682 lm/m
Average Power Consumption	12.0 W/m	12.0 W/m	12.0 W/m	12.0 W/m
Efficacy	44 lm/W	46 lm/W	56 lm/W	57 lm/W
Ordering Increment	62.5 mm	83.33 mm	62.5 mm	83.33 mm
Maximum Run Length (In Series)	8.0 m	8.0 m	8.0 m	8.0 m
Operating Temperature Range	-40°C to 55°C	-40°C to 55°C	-40°C to 55°C	-40°C to 55°C
Control/Dimming Protocol	0-10V / DALI	DALI	0-10V / DALI	DALI

TUNABLE WHITE CCT INFO / LUMEN MULTIPLIER

CRI	80 CRI	90 CRI
2200K - 5700K	1.00	0.80

Ordering Code

MODEL	BEND DIRECTION	LENGTH	OUTPUT	CCT	CRI	LENS	MOUNTING	FINISH	FEED POSITION LEFT	FEED POSITION RIGHT
KBX-W - Kurba Max Wet	HB - Horizontal Bending VB - Vertical Bending	SEE PAGE 7 - 8	WD59SO - Warm Dim, Standard Output TW51SO - Tunable White, Standard Output	18K30K - 1800K-3000K 22K57K - 2200K-5700K	R80 - 80 CRI R90 - 90 CRI	SF - Silicone Frosted	NA - See Page 6 for orderable mounting accessories	WH - White	INJECTION MOLD IME - End Feed 1 IMB - Back Feed 1 IMSA - Side A Feed IMSB - Side B Feed ¹ NPF - No Power Feed ²	INJECTION MOLD IME - End Feed 1 IMB - Back Feed 1 IMSA - Side A Feed IMSB - Side B Feed ¹ NPF - No Power Feed ²

Feeds come with 3m wire leads

1 - IMSB - Side B Feed not available with HB - Horizontal Bending

2 - NPF-NPF for Feed Position 1&2 is not a valid configuration option



Powerfeeds and Connectors

Power Feed Position Options and Orientation

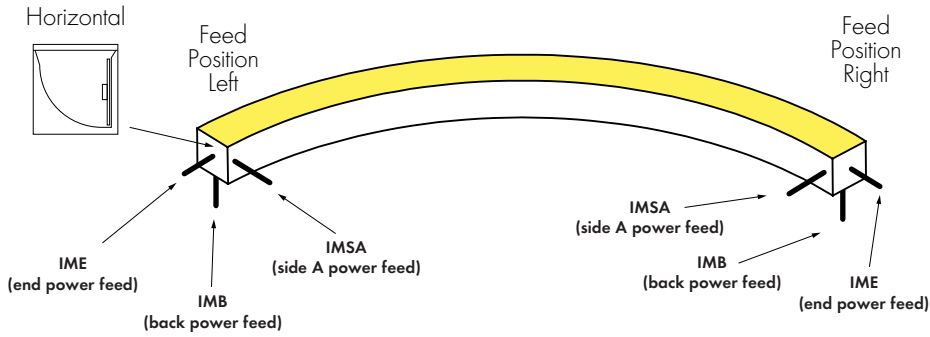

NOTE: IMSB - Side 2 Feed not available with HB - Horizontal Bending

Horizontal Bend Direction

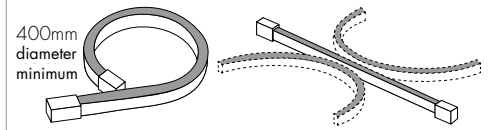

Horizontal Prohibited Bends

Twisting or bending LED in these positions will cause damage

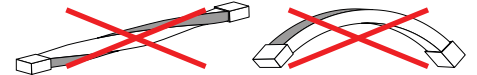

Vertical Bend Direction

Bend LED in these positions only to avoid damage

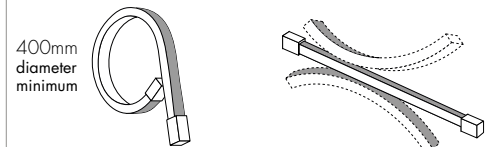

Vertical Prohibited Bends

Twisting or bending LED in these positions will cause damage

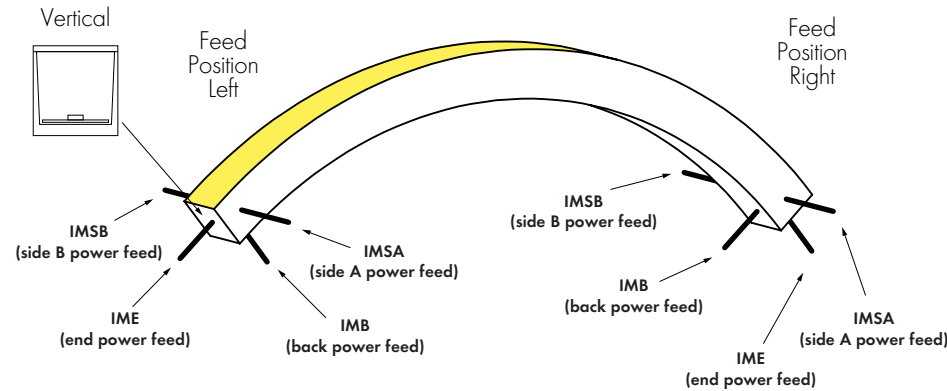
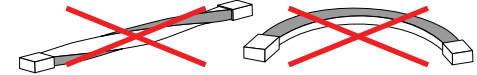

Powerfeed Options

Horizontal

END CONNECTOR

Injection-molded End Connector
-IME

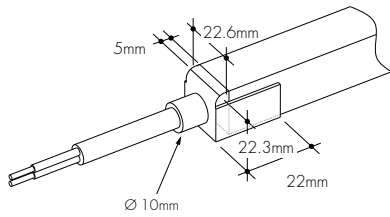

BACK CONNECTOR

Injection-molded Back Connector
-IMB

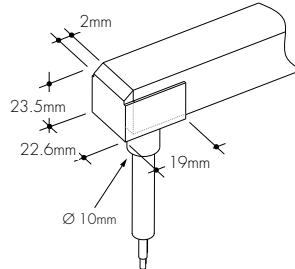

SIDE CONNECTOR

Injection-molded Side Connector
-IMSA

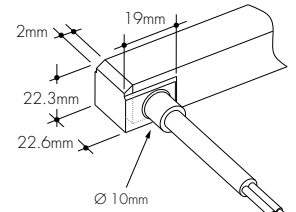

ENDCAP (NO CONNECTOR)

Injection-molded Cap (No Connector)
-NPF

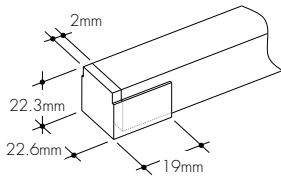

ANTI-WICKING FERRULE

Included on every power feed wire

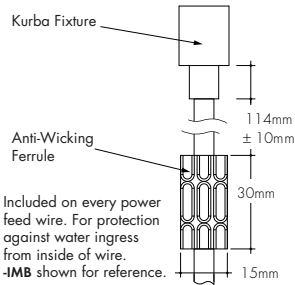

POWER FEED OPTIONS

Feeds come with 3m wire leads



Warm Dim
2 Conductor, 18 AWG

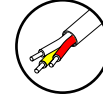

Tunable White
3 Conductor, 18 AWG

Vertical

END CONNECTOR

Injection-molded End Connector
-IME

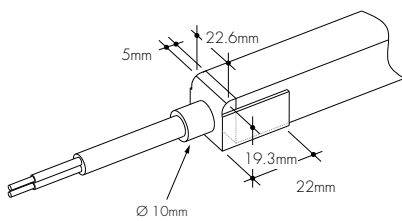

BACK CONNECTOR

Injection-molded Back Connector
-IMB

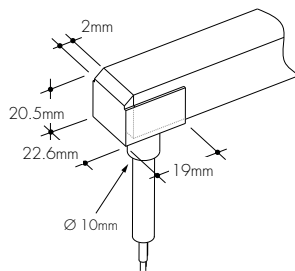

SIDE CONNECTOR

Injection-molded Side Connector
-IMSA and -IMSB

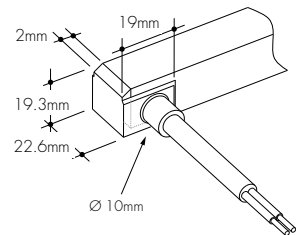

ENDCAP (NO CONNECTOR)

Injection-molded Cap (No Connector)
-NPF

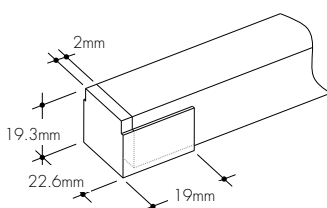

ANTI-WICKING FERRULE

Included on every power feed wire

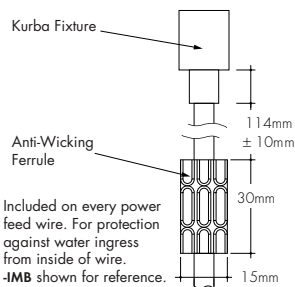

POWER FEED OPTIONS

Feeds come with 3m wire leads



Warm Dim
2 Conductor, 18 AWG

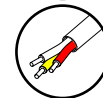

Tunable White
3 Conductor, 18 AWG



Product Dimensions

Horizontal

Kurba Max Cross Sections

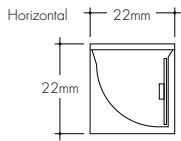

Example Feed Position
IME - NPF
End Feed 1 to
No Power Feed

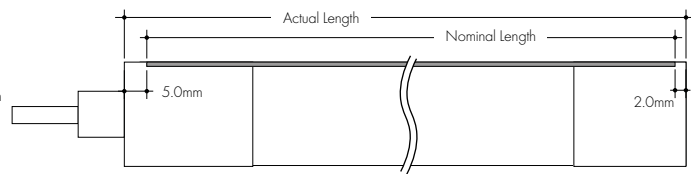
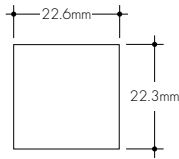

Example Feed Position
IMSA - NPF
Side A Feed to
No Power Feed

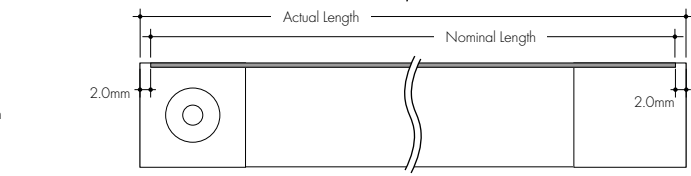
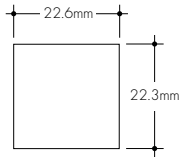

Example Feed Position
IMB - NPF
Back Feed 1 to
No Power Feed

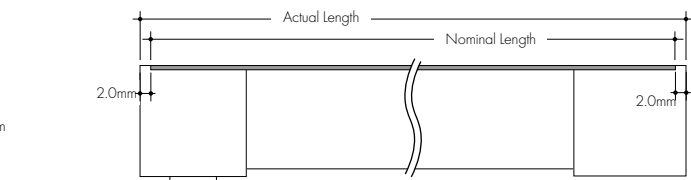
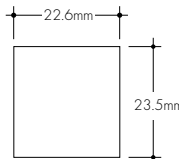

Example Feed Position
IME - IME
End Feed 1 and
End Feed 1

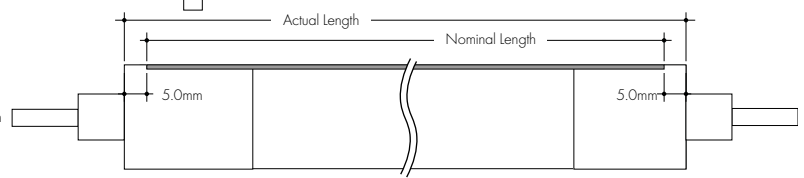
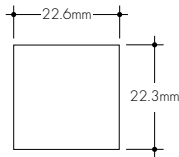

Vertical

Kurba Max Cross Sections

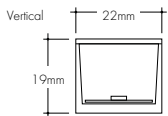

Example Feed Position
IME - NPF
End Feed 1 to
No Power Feed

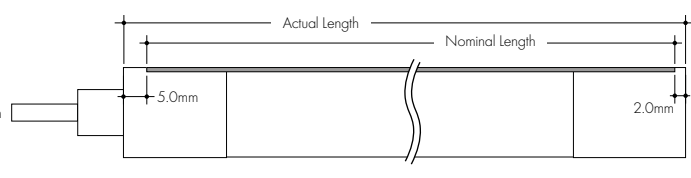
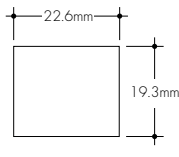

Example Feed Position
IMSA - NPF
Side A Feed to
No Power Feed

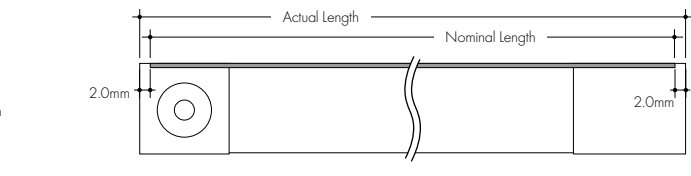
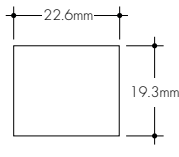

Example Feed Position
IMB - NPF
Back Feed 1 to
No Power Feed

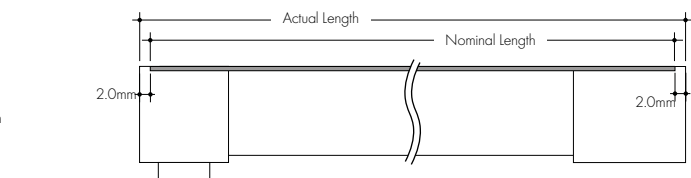
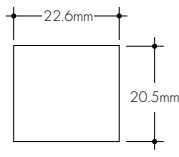

Example Feed Position
IME - IME
End Feed 1 and
End Feed 1

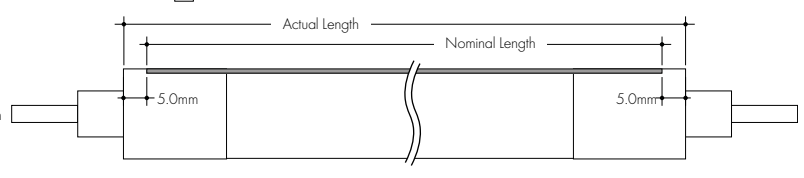
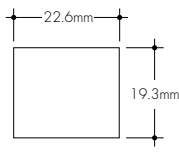

Finish Options

White
Base

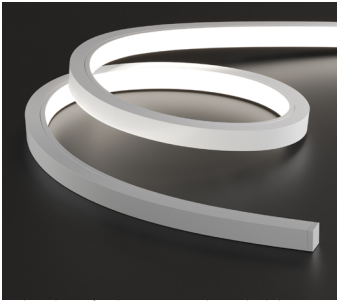

Kurba's base finish is a crisp white which brings a timeless, clean aesthetic that brightens and enhances any space

Light Transmission and Dotting

	Lens/Finish
Output Options	Silicone Frosted/ White Finish
WD59SO	ND
TW51SO	ND
Transmission Percentage	100%



CD SD ND
CD - Clear Dotting
SD - Slight Dotting
ND - No Dotting



Mounting Accessories

MC-KBX-SAP-SM-20MM-SA

KBX Mounting Clip, Serrated Aluminum Profile, Surface Mount, 20mm, Silver Anodized

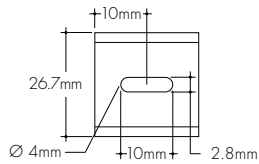
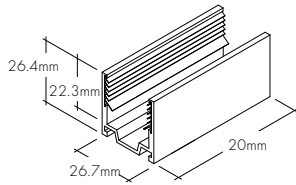

For use with light strip mounted to the ceiling. 1 recommended every 200mm. Includes 1 mounting screw

MC-KBX-SAP-SM-2M-SA

KBX Mounting Channel, Serrated Aluminum Profile, Surface Mount, 2m, Silver Anodized

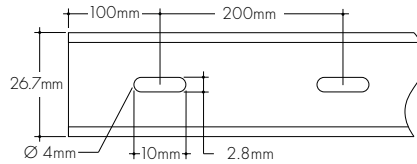
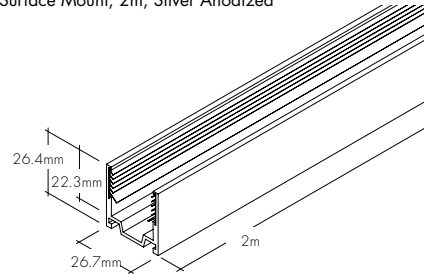

For use with light strip mounted to the ceiling. Includes 10 mounting screws

MC-KBX-FSAP-TR-2M-SA

Flanged Mounting Channel with grip, 2m

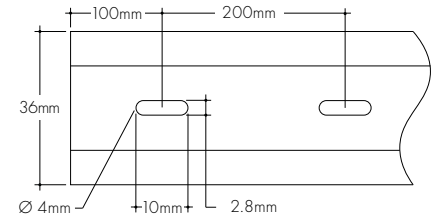
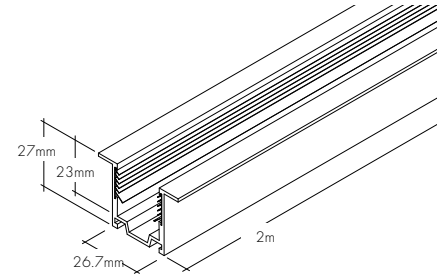

Flanged aluminum mounting channel providing grip. For use with light strip recessed into the ceiling. Includes 10 mounting screws

MC-KBX-BSAP-HB-SM-1M-SA

KBX Mounting Channel, Bendable Serrated Aluminum Profile, Horizontal Bending, Surface Mount, 1m, Silver Anodized

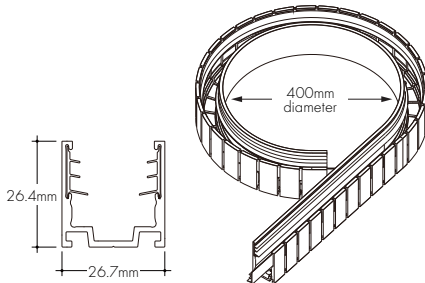

For use with light strip mounted to the ceiling. Mounting Channel Bending Diameter is 432mm opposite direction. Includes 10 mounting screws

NOTE: For use with **HB** - Horizontal Bend only.

MC-KBX-BANP-3D-SM-1M-XX

KBX Mounting Channel, Bendable Silicone Profile, 3D Bending, Surface Mount, 1m, 300mm bending diameter

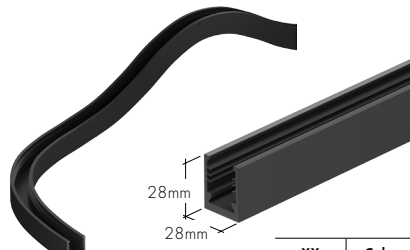

Includes 12 mounting screws

XX	Color
WH	White
BK	Black

LVSP-IP66

Splice box: wet rated, low voltage, gray, IP66

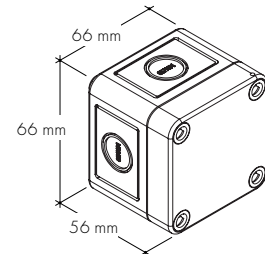

LVSP-IP66-CM

Connector for splice box, low voltage for cable management, gray, IP66

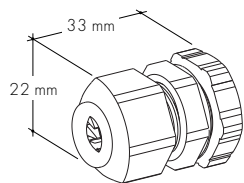

WD59SO | Orderable Length Chart

Use Actual Length for Order Code Entry.

Tolerance for Actual Lengths less than 1.8m is +/- 5mm, Actual Lengths between 1.8m and 4.8m is +/- 7.6mm, and Actual Lengths greater than 4.8m is +/- 15mm

A - End Connector at both ends of Kurba (5mm + 5mm added to overall length)

B - End Connector at one end of Kurba and No Connector or Back Connector or Side Connector at other end of Kurba (5mm + 2mm added to overall length)

C - Any combination of No Connector, Back Connector, or Side Connector on each end of Kurba (2mm + 2mm added to overall length)

Nominal Length (m)	Actual Length (m)			Nominal Length (m)	Actual Length (m)			Nominal Length (m)	Actual Length (m)			Nominal Length (m)	Actual Length (m)		
	A	B	C		A	B	C		A	B	C		A	B	C
0.20	0.198	0.195	0.192	2.45	2.448	2.445	2.442	4.70	4.698	4.695	4.692	6.95	6.948	6.945	6.942
0.25	0.260	0.257	0.254	2.50	2.510	2.507	2.504	4.75	4.760	4.757	4.754	7.00	7.010	7.007	7.004
0.30	0.323	0.320	0.317	2.55	2.573	2.570	2.567	4.80	4.823	4.820	4.817	7.05	7.073	7.070	7.067
0.40	0.385	0.382	0.379	2.65	2.635	2.632	2.629	4.90	4.885	4.882	4.879	7.15	7.135	7.132	7.129
0.45	0.448	0.445	0.442	2.70	2.698	2.695	2.692	4.95	4.948	4.945	4.942	7.20	7.198	7.195	7.192
0.50	0.510	0.507	0.504	2.75	2.760	2.757	2.754	5.00	5.010	5.007	5.004	7.25	7.260	7.257	7.254
0.55	0.573	0.570	0.567	2.80	2.823	2.820	2.817	5.05	5.073	5.070	5.067	7.30	7.323	7.320	7.317
0.65	0.635	0.632	0.629	2.90	2.885	2.882	2.879	5.15	5.135	5.132	5.129	7.40	7.385	7.382	7.379
0.70	0.698	0.695	0.692	2.95	2.948	2.945	2.942	5.20	5.198	5.195	5.192	7.45	7.448	7.445	7.442
0.75	0.760	0.757	0.754	3.00	3.010	3.007	3.004	5.25	5.260	5.257	5.254	7.50	7.510	7.507	7.504
0.80	0.823	0.820	0.817	3.05	3.073	3.070	3.067	5.30	5.323	5.320	5.317	7.55	7.573	7.570	7.567
0.90	0.885	0.882	0.879	3.15	3.135	3.132	3.129	5.40	5.385	5.382	5.379	7.65	7.635	7.632	7.629
0.95	0.948	0.945	0.942	3.20	3.198	3.195	3.192	5.45	5.448	5.445	5.442	7.70	7.698	7.695	7.692
1.00	1.010	1.007	1.004	3.25	3.260	3.257	3.254	5.50	5.510	5.507	5.504	7.75	7.760	7.757	7.754
1.05	1.073	1.070	1.067	3.30	3.323	3.320	3.317	5.55	5.573	5.570	5.567	7.80	7.823	7.820	7.817
1.15	1.135	1.132	1.129	3.40	3.385	3.382	3.379	5.65	5.635	5.632	5.629	7.90	7.885	7.882	7.879
1.20	1.198	1.195	1.192	3.45	3.448	3.445	3.442	5.70	5.698	5.695	5.692	7.95	7.948	7.945	7.942
1.25	1.260	1.257	1.254	3.50	3.510	3.507	3.504	5.75	5.760	5.757	5.754				
1.30	1.323	1.320	1.317	3.55	3.573	3.570	3.567	5.80	5.823	5.820	5.817				
1.40	1.385	1.382	1.379	3.65	3.635	3.632	3.629	5.90	5.885	5.882	5.879				
1.45	1.448	1.445	1.442	3.70	3.698	3.695	3.692	5.95	5.948	5.945	5.942				
1.50	1.510	1.507	1.504	3.75	3.760	3.757	3.754	6.00	6.010	6.007	6.004				
1.55	1.573	1.570	1.567	3.80	3.823	3.820	3.817	6.05	6.073	6.070	6.067				
1.65	1.635	1.632	1.629	3.90	3.885	3.882	3.879	6.15	6.135	6.132	6.129				
1.70	1.698	1.695	1.692	3.95	3.948	3.945	3.942	6.20	6.198	6.195	6.192				
1.75	1.760	1.757	1.754	4.00	4.010	4.007	4.004	6.25	6.260	6.257	6.254				
1.80	1.823	1.820	1.817	4.05	4.073	4.070	4.067	6.30	6.323	6.320	6.317				
1.90	1.885	1.882	1.879	4.15	4.135	4.132	4.129	6.40	6.385	6.382	6.379				
1.95	1.948	1.945	1.942	4.20	4.198	4.195	4.192	6.45	6.448	6.445	6.442				
2.00	2.010	2.007	2.004	4.25	4.260	4.257	4.254	6.50	6.510	6.507	6.504				
2.05	2.073	2.070	2.067	4.30	4.323	4.320	4.317	6.55	6.573	6.570	6.567				
2.15	2.135	2.132	2.129	4.40	4.385	4.382	4.379	6.65	6.635	6.632	6.629				
2.20	2.198	2.195	2.192	4.45	4.448	4.445	4.442	6.70	6.698	6.695	6.692				
2.25	2.260	2.257	2.254	4.50	4.510	4.507	4.504	6.75	6.760	6.757	6.754				
2.30	2.323	2.320	2.317	4.55	4.573	4.570	4.567	6.80	6.823	6.820	6.817				
2.40	2.385	2.382	2.379	4.65	4.635	4.632	4.629	6.90	6.885	6.882	6.879				

Note: all values are rounded to the nearest 2.5mm

Endcap (No Connector) -NPF

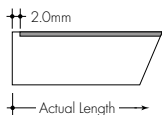

End Connector -IME

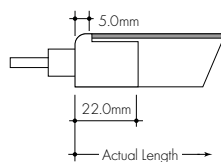

Back Connector -IMB

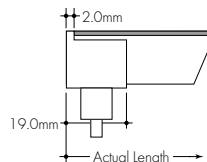

Side Connector -IMSA and -IMSB

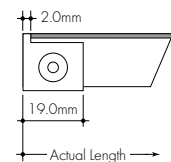

TW5150 | Orderable Length Chart

Use Actual Length for Order Code Entry.

Tolerance for Actual Lengths less than 1.8m is +/- 5mm, Actual Lengths between 1.8m and 4.8m is +/- 7.6mm, and Actual Lengths greater than 4.8m is +/- 15mm

A - End Connector at both ends of Kurba (5mm + 5mm added to overall length)

B - End Connector at one end of Kurba and No Connector or Back Connector or Side Connector at other end of Kurba (5mm + 2mm added to overall length)

C - Any combination of No Connector, Back Connector, or Side Connector on each end of Kurba (2mm + 2mm added to overall length)

Nominal Length (m)	Actual Length (m)			Nominal Length (m)	Actual Length (m)			Nominal Length (m)	Actual Length (m)		
	A	B	C		A	B	C		A	B	C
0.20	0.177	0.174	0.171	3.20	3.177	3.174	3.171	6.20	6.177	6.174	6.170
0.25	0.260	0.257	0.254	3.25	3.260	3.257	3.254	6.25	6.260	6.257	6.254
0.35	0.343	0.340	0.337	3.35	3.343	3.340	3.337	6.35	6.343	6.340	6.337
0.45	0.427	0.424	0.421	3.45	3.427	3.424	3.421	6.45	6.427	6.424	6.420
0.50	0.510	0.507	0.504	3.50	3.510	3.507	3.504	6.50	6.510	6.507	6.504
0.60	0.593	0.590	0.587	3.60	3.593	3.590	3.587	6.60	6.593	6.590	6.587
0.70	0.677	0.674	0.671	3.70	3.677	3.674	3.671	6.70	6.677	6.674	6.670
0.75	0.760	0.757	0.754	3.75	3.760	3.757	3.754	6.75	6.760	6.757	6.754
0.85	0.843	0.840	0.837	3.85	3.843	3.840	3.837	6.85	6.843	6.840	6.837
0.95	0.927	0.924	0.921	3.95	3.927	3.924	3.921	6.95	6.927	6.924	6.920
1.00	1.010	1.007	1.004	4.00	4.010	4.007	4.004	7.00	7.010	7.007	7.004
1.10	1.093	1.090	1.087	4.10	4.093	4.090	4.087	7.10	7.093	7.090	7.087
1.20	1.177	1.174	1.171	4.20	4.177	4.174	4.171	7.20	7.177	7.173	7.170
1.25	1.260	1.257	1.254	4.25	4.260	4.257	4.254	7.25	7.260	7.257	7.254
1.35	1.343	1.340	1.337	4.35	4.343	4.340	4.337	7.35	7.343	7.340	7.337
1.45	1.427	1.424	1.421	4.45	4.427	4.424	4.421	7.45	7.427	7.423	7.420
1.50	1.510	1.507	1.504	4.50	4.510	4.507	4.504	7.50	7.510	7.507	7.504
1.60	1.593	1.590	1.587	4.60	4.593	4.590	4.587	7.60	7.593	7.590	7.587
1.70	1.677	1.674	1.671	4.70	4.677	4.674	4.671	7.70	7.677	7.673	7.670
1.75	1.760	1.757	1.754	4.75	4.760	4.757	4.754	7.75	7.760	7.757	7.754
1.85	1.843	1.840	1.837	4.85	4.843	4.840	4.837	7.85	7.843	7.840	7.837
1.95	1.927	1.924	1.921	4.95	4.927	4.924	4.921	7.95	7.927	7.923	7.920
2.00	2.010	2.007	2.004	5.00	5.010	5.007	5.004				
2.10	2.093	2.090	2.087	5.10	5.093	5.090	5.087				
2.20	2.177	2.174	2.171	5.20	5.177	5.174	5.171				
2.25	2.260	2.257	2.254	5.25	5.260	5.257	5.254				
2.35	2.343	2.340	2.337	5.35	5.343	5.340	5.337				
2.45	2.427	2.424	2.421	5.45	5.427	5.424	5.421				
2.50	2.510	2.507	2.504	5.50	5.510	5.507	5.504				
2.60	2.593	2.590	2.587	5.60	5.593	5.590	5.587				
2.70	2.677	2.674	2.671	5.70	5.677	5.674	5.671				
2.75	2.760	2.757	2.754	5.75	5.760	5.757	5.754				
2.85	2.843	2.840	2.837	5.85	5.843	5.840	5.837				
2.95	2.927	2.924	2.921	5.95	5.927	5.924	5.920				
3.00	3.010	3.007	3.004	6.00	6.010	6.007	6.004				
3.10	3.093	3.090	3.087	6.10	6.093	6.090	6.087				

Note: all values are rounded to the nearest 2.5mm

Endcap (No Connector) -NPF

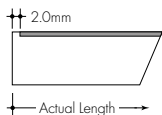

End Connector -IME

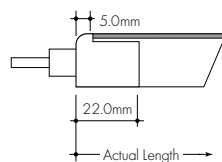

Back Connector -IMB

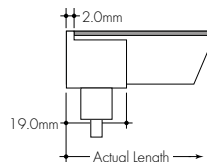

Side Connector -IMSA and -IMSB

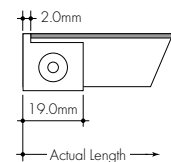

Lifetime and Environmental

At Luminii, we design our linear LED systems with longevity and responsible material use in mind. Our products are engineered to be serviceable and adaptable, with modular components such as drivers and controls that can be replaced or upgraded without full system replacement.

We are actively reducing the environmental impact of our packaging by transitioning to paper-based solutions for reels, bags, and outer packaging wherever possible, while minimising material use and avoiding mixed materials to improve recyclability.

We prioritise the use of recyclable materials in both our products and packaging, and encourage responsible disposal in line with local recycling and WEEE regulations.

CIBSE TM65	35.2kg CO ₂ e(1m)	UK PART L	
CIBSE TM66	2.1	Part L1A / L1B (Dwellings)	<i>Compliant 75 lm/W</i> <i>Source lm (900lm) / Source W (12W)</i>
RoHS Compliance	Yes	Part L2A (General)	-
REACH Compliance	Yes	<i>≥75 lm/W source lumens</i>	
WEEE Compliance	Yes - Registered Producer	<i>≥95lm/W delivered lumens</i>	
Declare	Declared	Part L2A (Display)	-
Lifetime	L90B10 100,000hrs	<i>≥80 lm/W source lumens</i>	
Warranty	5 Years		

Notes: Part L data for Tunable White

Power Supplies for UK, EU, Middle East, Asia and Pacific

Tunable White - DALI 2 | Remote | Constant Voltage

Input Voltage	230V AC 50/60 Hz
Driver Type	Remote Constant Voltage
Location	IP20 Indoor Location Only
Dimming Control	DALI or DALI 2
Min. Dim Level	0.1%
Flicker	IEEE 1789 Compatible No Observable Effect



MODELS	TYPE & CCT RANGE	75W	150W	240W
Order Code	DT6 1800-3000K	PSCV-75-24-18K30K-DT6-LT	PSCV-150-24-18K30K-DT6-LT	PSCV-240-24-18K30K-DT6-LT
	DT8 1800-3000K	PSCV-75-24-18K30K-DT8-LT	PSCV-150-24-18K30K-DT8-LT	PSCV-240-24-18K30K-DT8-LT
	DT6 2700-6500K	PSCV-75-24-27K65K-DT6-LT	PSCV-150-24-27K65K-DT6-LT	PSCV-240-24-27K65K-DT6-LT
	DT8 2700-6500K	PSCV-75-24-27K65K-DT8-LT	PSCV-150-24-27K65K-DT8-LT	PSCV-240-24-27K65K-DT8-LT
Length (mm)		295	352	380
Width (mm)		35	35	50
Depth (mm)		30	30	30

DT8 is recommended for new DALI-2 compatible tunable white installations. DT8 uses one DALI address to provide native control of both brightness and colour temperature.

DT6 is provided for legacy compatibility, where older DALI systems or third-party BMS platforms do not support DT8 colour control. DT6 tunable white control typically uses two DALI addresses/channels, with the control system mixing warm and cool outputs to achieve the required CCT.



Power Supplies for UK, EU, Middle East, Asia and Pacific

Warm Dim - DALI 2 | Remote | Constant Voltage

Input Voltage	230V AC 50/60 Hz
Driver Type	Remote Constant Voltage
Location	IP20 Indoor Location Only
Dimming Control	DALI 2
Min. Dim Level	0.1%
Flicker	IEEE 1789 Compatible No Observable Effect

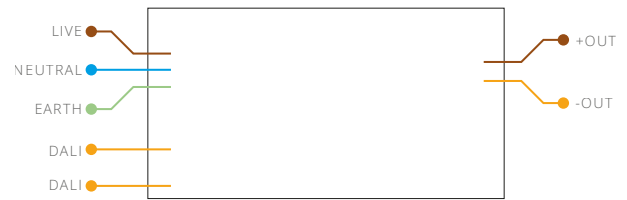

MODELS	40W	75W	150W	240W
Order Code	PSCV-40-24-D-EU	PSCV-75-24-D-EU	PSCV-150-24-D-EU	PSCV-240-24-D-EU
Length (mm)	185	295	295	360
Width (mm)	40	40	40	40
Depth (mm)	30	30	30	30

Warm Dim - 0-10V | Remote | Constant Voltage

Input Voltage	230V AC 50/60 Hz
Driver Type	Remote Constant Voltage
Location	IP20 Indoor Location Only
Dimming Control	0-10V
Min. Dim Level	0.1%
Flicker	IEEE 1789 Compatible No Observable Effect



MODELS	40W	75W	150W	240W
Order Code	PSCV-40-24-A-EU	PSCV-75-24-A-EU	PSCV-150-24-A-EU	PSCV-240-24-A-EU
Length (mm)	185	295	295	360
Width (mm)	40	40	40	40
Depth (mm)	30	30	30	30

Max Series Run Length and Voltage Drop

The maximum series run length must not be exceeded. LED strips must be cut and re-fed from the power supply if the required length exceeds this. Maximum series run lengths can be found on page 1 and vary per output. Voltage drop must not exceed 3% between the PSU and start of the LED strip. Click or scan the QR code to visit our online voltage drop calculator.

