

Kurba Large Sauna Horizontal and Vertical Static White

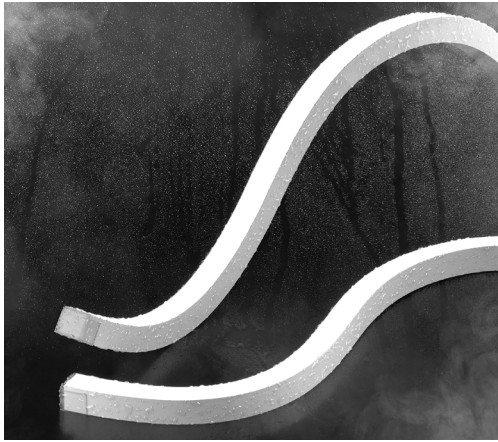

Features

Kurba Large is a dot free direct view, highly versatile, energy efficient and flexible LED strip suitable for Sauna and Spa locations capable of horizontal/side bends and vertical/top bends with a 300mm bending diameter. The silicone material offers excellent heat, weather, UV, and solvent resistance and has a special coating to repel dust and dirt accumulation.

Applications

Sauna and Spa locations

Materials

Silicone for Red list approved, as well as heat, weather, UV, and solvent resistance

Dimming

Dimable down to 1%. Dot Free even illumination. Also available with Black Lens

Average Life (L70)

50,000 hours

Approvals

CE, UKCA, UL, Class 2, IP67

Warranty

5 years

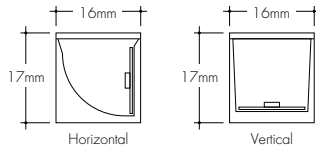

Finish Options

Base White



Technical Information

Bending Direction	Horizontal	Vertical
Output	33LO	33LO
Light Output at 3000K, 80 CRI	292 lm/m	322 lm/m
Average Power Consumption	6 W/m	6 W/m
Efficacy	49 lm/W	54 lm/W
Ordering Increment	55.56 mm	55.56 mm
Maximum Run Length (In Series)	9.8 m	9.8 m
Operating Temperature Range	-40°C to 90°C	-40°C to 90°C

CCT INFO / LUMEN MULTIPLIER (ref. -3000K)

Bending Direction	Horizontal	Vertical
CRI	80 CRI	80 CRI
2200K	0.83	0.83
2400K	0.97	0.97
2700K	0.97	0.97
3000K	1.00	1.00
3500K	1.00	1.00
4000K	1.01	1.01

Ordering Code

MODEL	BEND DIRECTION	LENGTH	OUTPUT	CCT	CRI	LENS	MOUNTING	FINISH	FEED POSITION LEFT	FEED POSITION RIGHT
KBLSN - Kurba Large Sauna	HB - Horizontal Bending VB - Vertical Bending	SEE PAGE 5	33LO - Low	22K - 2200K 24K - 2400K 27K - 2700K 30K - 3000K 35K - 3500K 40K - 4000K	R80 - 80 CRI	SF - Silicone Frosted	NA - See Page 4 for orderable mounting accessories	WH - White	INJECTION MOLD IME - End Feed 1 IMB - Back Feed 1 IMSA - Side A Feed IMSB - Side B Feed ¹ NPF - No Power Feed ²	INJECTION MOLD IME - End Feed 1 IMB - Back Feed 1 IMSA - Side A Feed IMSB - Side B Feed ¹ NPF - No Power Feed ²

Feeds come with 3m wire leads

1 - IMSB - Side B Feed not available with HB - Horizontal Bending
2 - NPF - NPF for Feed Position 1&2 is not a valid configuration option

NOTE: IK10 rating only available with MC-KBLSAP-SM-2M-SA, MC-KBLRCWY-SM-2M-SA, or MC-KBLSAP-TR-2M-SA aluminum mounting profile



Powerfeeds and Connectors

Power Feed Position Options and Orientation

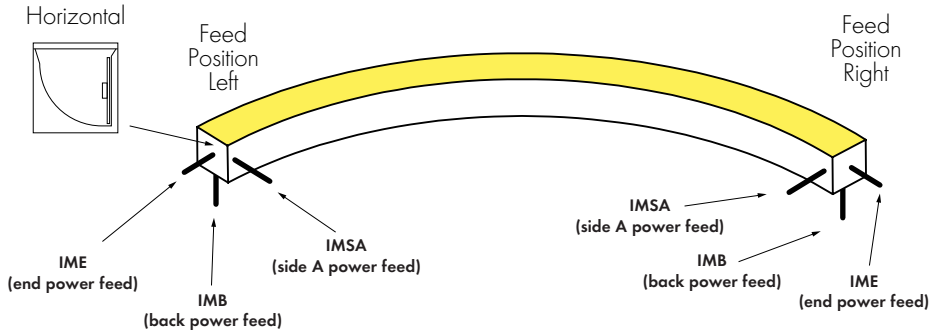

NOTE: IMSB - Side B Feed not available with HB - Horizontal Bending

Horizontal Bend Direction

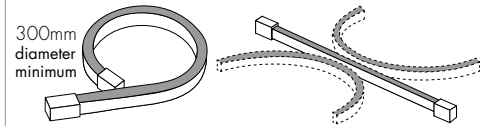

Illuminated surface shown in gray

Horizontal Prohibited Bends

Twisting or bending LED in these positions will cause damage

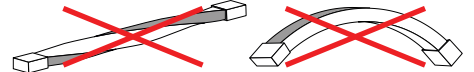

Illuminated surface shown in gray

Do not make sharp bends near the endcap

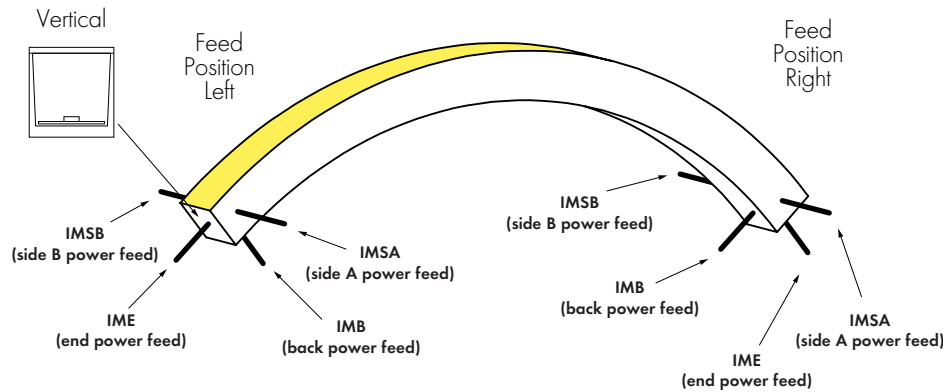

Vertical Bend Direction

Bend LED in these positions only to avoid damage

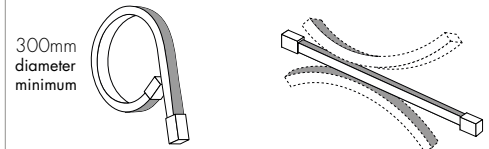

Illuminated surface shown in gray

Vertical Prohibited Bends

Twisting or bending LED in these positions will cause damage

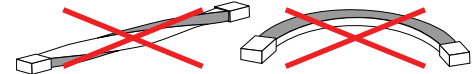

Illuminated surface shown in gray

Do not make sharp bends near the endcap

Linking and Extension Cable Options

END CONNECTOR

Injection-molded End Connector

-IME

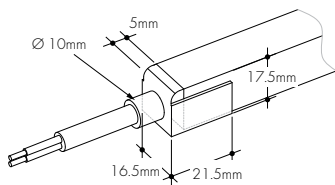

BACK CONNECTOR

Injection-molded Back Connector

-IMB

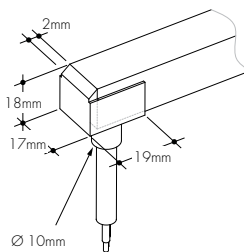

SIDE CONNECTOR

Injection-molded Side Connector

-IMSA and -IMSB

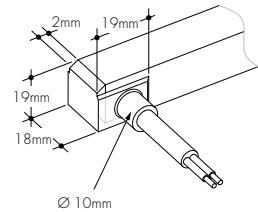

ENDCAP (NO CONNECTOR)

Injection-molded Cap (No Connector)

-NPF

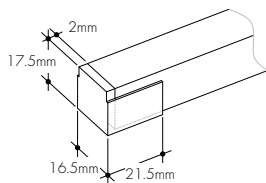

ANTI-WICKING FERRULE

Included on every power feed wire

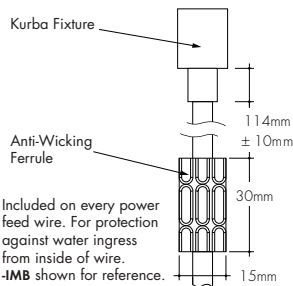

Included on every power feed wire. For protection against water ingress from inside of wire. -IMB shown for reference.

POWER FEED OPTIONS

Feeds come with 3m wire leads



2 Conductor, 18 AWG



Product Dimensions

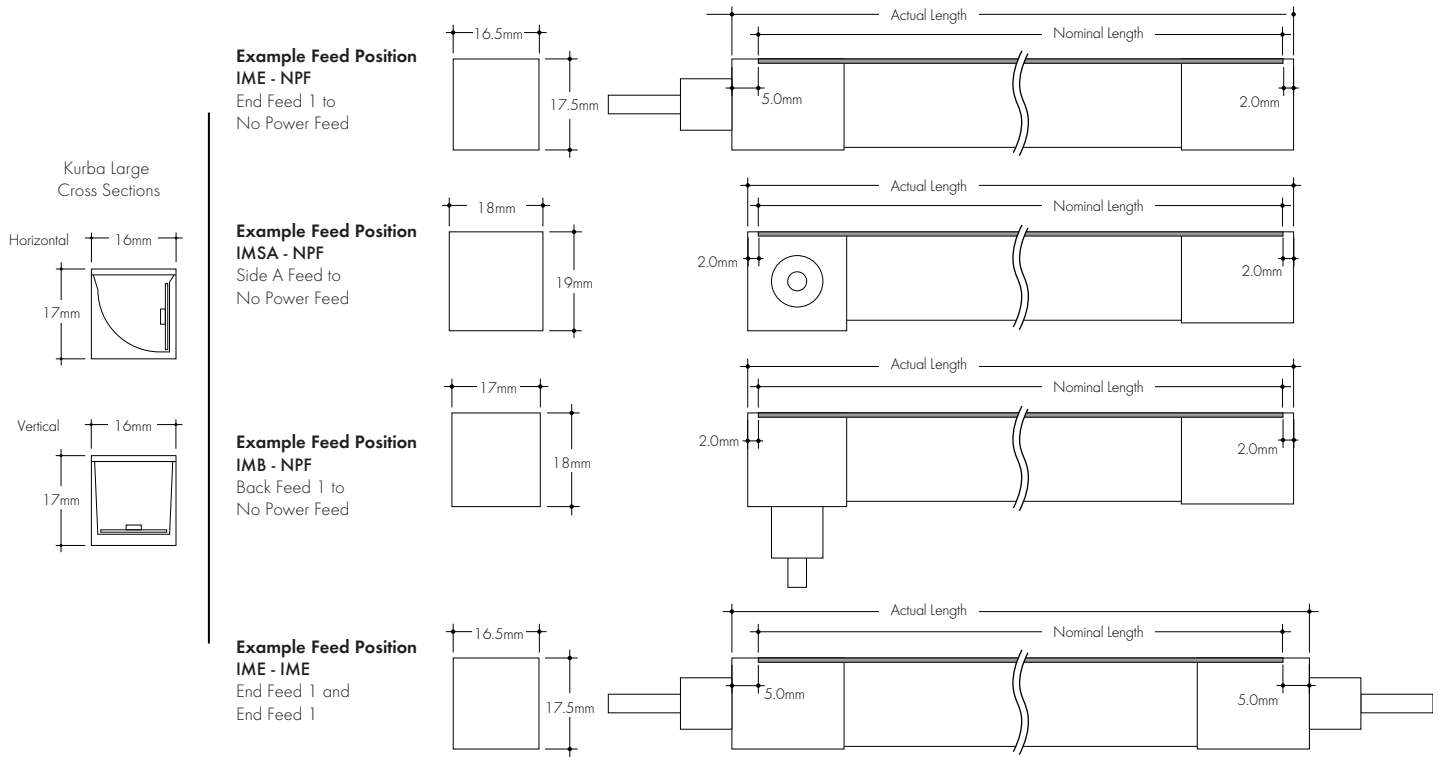

Finish Options

**White
Base**

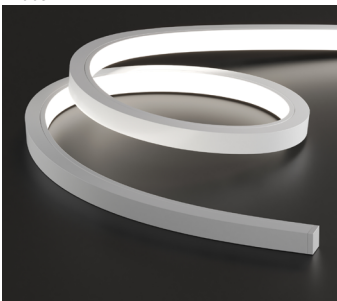

Kurba's base finish is a crisp white which brings a timeless, clean aesthetic that brightens and enhances any space



Light Transmission and Dotting

Output Options	Lens/Finish
	Silicone Frosted/ White Finish
38LO	ND
Transmission Percentage	100%



CD SD ND
 CD - Clear Dotting
 SD - Slight Dotting
 ND - No Dotting

Mounting Accessories

MC-KBL-SAP-SM-20MM-SA

KBL Mounting Clip, Serrated Aluminum Profile, Surface Mount, 20mm, Silver Anodized

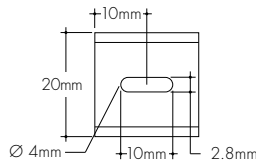
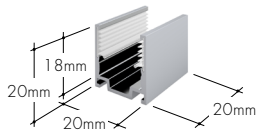

For use with light strip mounted to the ceiling. 1 recommended every 200mm. Includes 1 mounting screw

MC-KBL-SAP-SM-2M-SA

KBL Mounting Channel, Serrated Aluminum Profile, Surface Mount, 2m, Silver Anodized

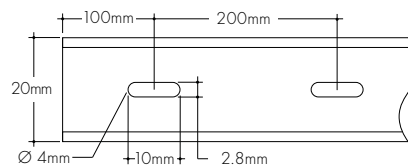
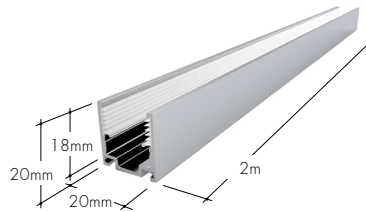

For use with light strip mounted to the ceiling. Includes 10 mounting screws

MC-KBL-FSAP-TR-2M-SA

KBL Mounting Channel, Flanged Serrated Aluminum Profile, Trimmed Recessed Mount, 2m, Silver Anodized

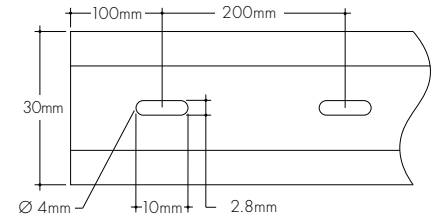
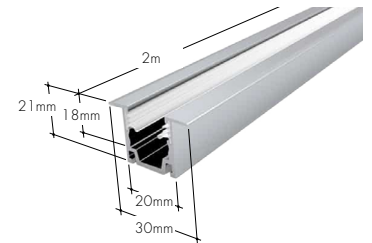

Flanged aluminum mounting channel providing grip. For use with light strip recessed into the ceiling. Includes 10 mounting screws

MC-KBL-RCWY-SM-2M-SA

KBL Mounting Channel, Raceway, Surface Mount, 2m, Silver Anodized

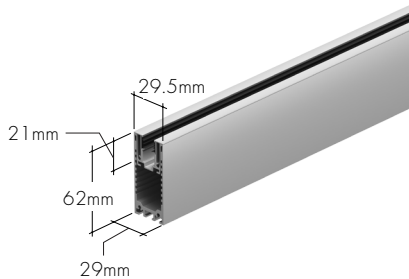

Raceway channel allows for hidden cable management and is a superb option where tidiness is required. **NOTE:** Compatible with IMB - Back Feed only

MC-KBL-BANP-3D-SM-1M-XX

KBL Mounting Channel, Bendable Silicone Profile, 3D Bending, Surface Mount, 1m, 300mm bending diameter

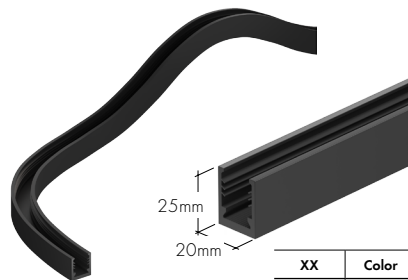

XX	Color
WH	White
BK	Black

Includes 12 mounting screws

LVSP-IP66

Splice box: wet rated, low voltage, gray, IP66

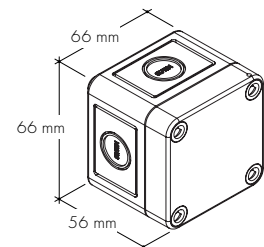

LVSP-IP66-CM

Connector for splice box, low voltage for cable management, gray, IP66

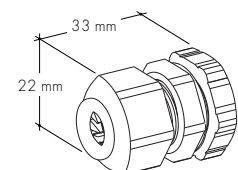

33LO | Orderable Length Chart

Use Actual Length for Order Code Entry

Tolerance for Actual Lengths less than 1.8m is +/- 5mm, Actual Lengths between 1.8m and 4.8m is +/- 7.6mm, and Actual Lengths greater than 4.8m is +/- 15mm

A - End Connector at both ends of Kurba (5mm + 5mm added to overall length)

B - End Connector at one end of Kurba and No Connector or Back Connector or Side Connector at other end of Kurba (5mm + 2mm added to overall length)

C - Any combination of No Connector, Back Connector, or Side Connector on each end of Kurba (2mm + 2mm added to overall length)

Nominal Length (m)	Actual Length (m)			Nominal Length (m)	Actual Length (m)			Nominal Length (m)	Actual Length (m)			Nominal Length (m)	Actual Length (m)			Nominal Length (m)	Actual Length (m)		
	A	B	C		A	B	C		A	B	C		A	B	C		A	B	C
0.20	0.177	0.174	0.171	2.20	2.177	2.174	2.171	4.20	4.177	4.174	4.171	6.20	6.177	6.174	6.171	8.20	8.177	8.174	8.171
0.25	0.232	0.229	0.226	2.25	2.233	2.230	2.226	4.25	4.233	4.230	4.227	6.25	6.233	6.230	6.227	8.25	8.233	8.230	8.227
0.30	0.288	0.285	0.282	2.30	2.288	2.285	2.282	4.30	4.288	4.285	4.282	6.30	6.288	6.285	6.282	8.30	8.289	8.286	8.283
0.35	0.344	0.340	0.337	2.35	2.344	2.341	2.338	4.35	4.344	4.341	4.338	6.35	6.344	6.341	6.338	8.35	8.344	8.341	8.338
0.40	0.399	0.396	0.393	2.40	2.399	2.396	2.393	4.40	4.399	4.396	4.393	6.40	6.400	6.397	6.393	8.40	8.400	8.397	8.394
0.45	0.455	0.452	0.449	2.45	2.455	2.452	2.449	4.45	4.455	4.452	4.449	6.45	6.455	6.452	6.449	8.45	8.455	8.452	8.449
0.50	0.510	0.507	0.504	2.50	2.510	2.507	2.504	4.50	4.511	4.507	4.504	6.50	6.511	6.508	6.505	8.50	8.511	8.508	8.505
0.55	0.566	0.563	0.560	2.55	2.566	2.563	2.560	4.55	4.566	4.563	4.560	6.55	6.566	6.563	6.560	8.55	8.566	8.563	8.560
0.60	0.621	0.618	0.615	2.60	2.621	2.618	2.615	4.60	4.622	4.619	4.616	6.60	6.622	6.619	6.616	8.60	8.622	8.619	8.616
0.70	0.677	0.674	0.671	2.70	2.677	2.674	2.671	4.70	4.677	4.674	4.671	6.70	6.677	6.674	6.671	8.70	8.678	8.674	8.671
0.75	0.732	0.729	0.726	2.75	2.733	2.730	2.727	4.75	4.733	4.730	4.727	6.75	6.733	6.730	6.727	8.75	8.733	8.730	8.727
0.80	0.788	0.785	0.782	2.80	2.788	2.785	2.782	4.80	4.788	4.785	4.782	6.80	6.788	6.785	6.782	8.80	8.789	8.786	8.783
0.85	0.844	0.841	0.837	2.85	2.844	2.841	2.838	4.85	4.844	4.841	4.838	6.85	6.844	6.841	6.838	8.85	8.844	8.841	8.838
0.90	0.899	0.896	0.893	2.90	2.899	2.896	2.893	4.90	4.899	4.896	4.893	6.90	6.900	6.897	6.894	8.90	8.900	8.897	8.894
0.95	0.955	0.952	0.949	2.95	2.955	2.952	2.949	4.95	4.955	4.952	4.949	6.95	6.955	6.952	6.949	8.95	8.955	8.952	8.949
1.00	1.010	1.007	1.004	3.00	3.010	3.007	3.004	5.00	5.011	5.008	5.004	7.00	7.011	7.008	7.005	9.00	9.011	9.008	9.005
1.05	1.066	1.063	1.060	3.05	3.066	3.063	3.060	5.05	5.066	5.063	5.060	7.05	7.066	7.063	7.060	9.05	9.066	9.063	9.060
1.10	1.121	1.118	1.115	3.10	3.122	3.118	3.115	5.10	5.122	5.119	5.116	7.10	7.122	7.119	7.116	9.10	9.122	9.119	9.116
1.20	1.177	1.174	1.171	3.20	3.177	3.174	3.171	5.20	5.177	5.174	5.171	7.20	7.177	7.174	7.171	9.20	9.178	9.175	9.171
1.25	1.232	1.229	1.226	3.25	3.233	3.230	3.227	5.25	5.233	5.230	5.227	7.25	7.233	7.230	7.227	9.25	9.233	9.230	9.227
1.30	1.288	1.285	1.282	3.30	3.288	3.285	3.282	5.30	5.288	5.285	5.282	7.30	7.289	7.285	7.282	9.30	9.289	9.286	9.283
1.35	1.344	1.341	1.338	3.35	3.344	3.341	3.338	5.35	5.344	5.341	5.338	7.35	7.344	7.341	7.338	9.35	9.344	9.341	9.338
1.40	1.399	1.396	1.393	3.40	3.399	3.396	3.393	5.40	5.399	5.396	5.393	7.40	7.400	7.397	7.394	9.40	9.400	9.397	9.394
1.45	1.455	1.452	1.449	3.45	3.455	3.452	3.449	5.45	5.455	5.452	5.449	7.45	7.455	7.452	7.449	9.45	9.455	9.452	9.449
1.50	1.510	1.507	1.504	3.50	3.510	3.507	3.504	5.50	5.511	5.508	5.505	7.50	7.511	7.508	7.505	9.50	9.511	9.508	9.505
1.55	1.566	1.563	1.560	3.55	3.566	3.563	3.560	5.55	5.566	5.563	5.560	7.55	7.566	7.563	7.560	9.55	9.566	9.563	9.560
1.60	1.621	1.618	1.615	3.60	3.622	3.619	3.615	5.60	5.622	5.619	5.616	7.60	7.622	7.619	7.616	9.60	9.622	9.619	9.616
1.70	1.677	1.674	1.671	3.70	3.677	3.674	3.671	5.70	5.677	5.674	5.671	7.70	7.677	7.674	7.671	9.70	9.678	9.675	9.672
1.75	1.733	1.729	1.726	3.75	3.733	3.730	3.727	5.75	5.733	5.730	5.727	7.75	7.733	7.730	7.727	9.75	9.733	9.730	9.727
1.80	1.788	1.785	1.782	3.80	3.788	3.785	3.782	5.80	5.788	5.785	5.782	7.80	7.789	7.786	7.782	9.80	9.789	9.786	9.783
1.85	1.844	1.841	1.838	3.85	3.844	3.841	3.838	5.85	5.844	5.841	5.838	7.85	7.844	7.841	7.838	9.85	9.844	9.841	9.838
1.90	1.899	1.896	1.893	3.90	3.899	3.896	3.893	5.90	5.900	5.896	5.893	7.90	7.900	7.897	7.894	9.90	9.900	9.897	9.894
1.95	1.955	1.952	1.949	3.95	3.955	3.952	3.949	5.95	5.955	5.952	5.949	7.95	7.955	7.952	7.949	9.95	9.955	9.952	9.949
2.00	2.010	2.007	2.004	4.00	4.010	4.007	4.004	6.00	6.011	6.008	6.005	8.00	8.011	8.008	8.005	10.00	10.011	10.008	10.005
2.05	2.066	2.063	2.060	4.05	4.066	4.063	4.060	6.05	6.066	6.063	6.060	8.05	8.066	8.063	8.060				
2.10	2.121	2.118	2.115	4.10	4.122	4.119	4.116	6.10	6.122	6.119	6.116	8.10	8.122	8.119	8.116				

Note: all values are rounded to the nearest 2.5mm

Endcap (No Connector) -NPF

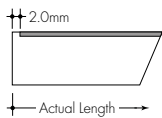

End Connector -JME

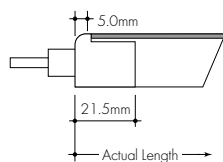

Back Connector -JMB

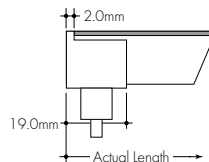

Side Connector -JMSA -JMSB

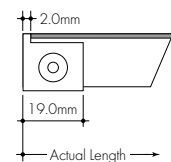

Lifetime and Environmental

At Luminii, we design our linear LED systems with longevity and responsible material use in mind. Our products are engineered to be serviceable and adaptable, with modular components such as drivers and controls that can be replaced or upgraded without full system replacement.

We are actively reducing the environmental impact of our packaging by transitioning to paper-based solutions for reels, bags, and outer packaging wherever possible, while minimising material use and avoiding mixed materials to improve recyclability.

We prioritise the use of recyclable materials in both our products and packaging, and encourage responsible disposal in line with local recycling and WEEE regulations.

CIBSE TM65	24.06kg CO ₂ e(1m)	UK PART L	
CIBSE TM66	2.1	Part L1A / L1B (Dwellings)	<i>Compliant 98 lm/W</i> <i>Source lm (589lm) / Source W (6W)</i>
RoHS Compliance	Yes	<i>≥75 lm/W source lumens</i>	
REACH Compliance	Yes	Part L2A (General)	-
WEEE Compliance	Yes - Registered Producer	<i>≥95lm/W delivered lumens</i>	
Declare	Declared	Part L2A (Display)	<i>Compliant 98 lm/W</i> <i>Source lm (589lm) / Source W (6W)</i>
Lifetime	L90B10 100,000hrs	<i>≥80 lm/W source lumens</i>	
Warranty	5 Years		



Power Supplies for UK, EU, Middle East, Asia and Pacific

DALI 2 | Remote | Constant Voltage

Input Voltage	230V AC 50/60 Hz
Driver Type	Remote Constant Voltage
Location	IP20 Indoor Location Only
Dimming Control	DALI 2
Min. Dim Level	0.1%
Flicker	IEEE 1789 Compatible No Observable Effect

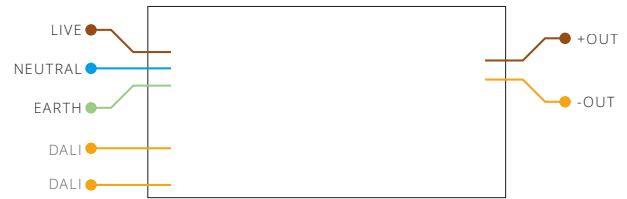

MODELS	40W	75W	150W	240W
Order Code	PSCV-40-24-D-EU	PSCV-75-24-D-EU	PSCV-150-24-D-EU	PSCV-240-24-D-EU
Length (mm)	185	295	295	360
Width (mm)	40	40	40	40
Depth (mm)	30	30	30	30

0-10V | Remote | Constant Voltage

Input Voltage	230V AC 50/60 Hz
Driver Type	Remote Constant Voltage
Location	IP20 Indoor Location Only
Dimming Control	0-10V
Min. Dim Level	0.1%
Flicker	IEEE 1789 Compatible No Observable Effect



MODELS	40W	75W	150W	240W
Order Code	PSCV-40-24-A-EU	PSCV-75-24-A-EU	PSCV-150-24-A-EU	PSCV-240-24-A-EU
Length (mm)	185	295	295	360
Width (mm)	40	40	40	40
Depth (mm)	30	30	30	30

Max Series Run Length and Voltage Drop

The maximum series run length must not be exceeded. LED strips must be cut and re-fed from the power supply if the required length exceeds this. Maximum series run lengths can be found on page 1 and vary per output. Voltage drop must not exceed 3% between the PSU and start of the LED strip. Click or scan the QR code to visit our online voltage drop calculator.

