

Features

Kurba Large is a dot free direct view, highly versatile, energy efficient and flexible LED strip. Suitable for submersion max 5m deep and capable of horizontal/side bends and vertical/top bends with a 300mm bending diameter.

Output Option

Smart Pixel offerings allow for infinite color combinations with cascading and chasing effects

Materials

PVC Material for high chlorine resistance.
Fresh water, sea water (salinity $\leq 4\%$), swimming pool (chlorine $\leq 5\text{ppm}$, ozone $\leq 3\text{ppm}$)

Average Life (L70)

50,000 hours

Approvals

CE, UKCA, UL676, Class 2, IP68

Warranty

3 years

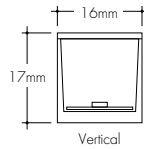
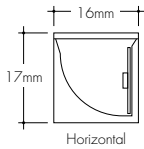

Finish Options

Base White



Technical Information

Bending Direction	Horizontal	Vertical
Output	SPI88SO	SPI88SO
Light Output at RGB30K	768 lm/m	778 lm/m
Average Power Consumption	22 W/m	22 W/m
Efficacy	35 lm/W	35 lm/W
Ordering Increment	83.33 mm	83.33 mm
Maximum Run Length (In Series)	4.3 m	4.3 m
Operating Temperature Range	-20°C to 35°C	-20°C to 35°C
Control/Dimming Protocol	SPI Protocol UCS 2904	SPI Protocol UCS 2904

Ordering Code

MODEL	BEND DIRECTION	LENGTH	OUTPUT	CCT	CRI	LENS	MOUNTING	FINISH	FEED POSITION LEFT	FEED POSITION RIGHT
KBL-PL - Kurba Large Pool	HB - Horizontal Bending VB - Vertical Bending	SEE PAGE 5	SPI88SO - Smart Pixel Control, Standard Output	RGB27K - RGB 2700K RGB30K - RGB 3000K RGB40K - RGB 4000K	R80 - 80CRI	F - Frosted	NA - See Page 4 for orderable mounting accessories	WH - White	DUAL INJECTION MOLD DME - End Feed 1 DMB - Back Feed 1 DMSA - Side A Feed DMSB - Side B Feed ¹ NPF - No Power Feed ²	DUAL INJECTION MOLD DME - End Feed 1 DMB - Back Feed 1 DMSA - Side A Feed DMSB - Side B Feed ¹ NPF - No Power Feed ²

Feeds come with 9m wire leads

1 - DMSB - Side B Feed not available with HB - Horizontal Bending

2 - NPF-NPF for Feed Position 1&2 is not a valid configuration option



Powerfeeds and Connectors

Power Feed Position Options and Orientation

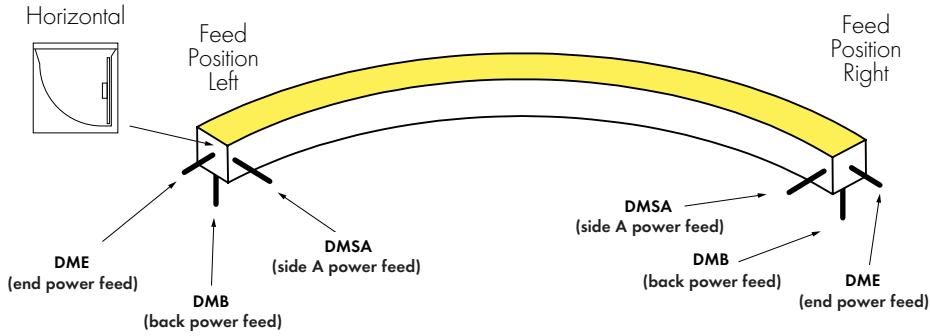

NOTE: IMSB - Side B Feed not available with HB - Horizontal Bending

Horizontal Bend Direction

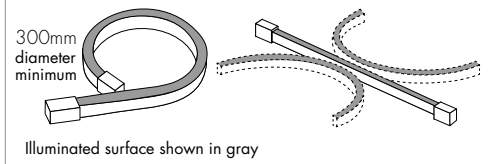

Illuminated surface shown in gray

Horizontal Prohibited Bends

Twisting or bending LED in these positions will cause damage

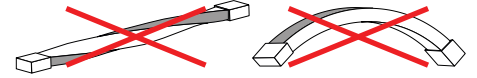

Illuminated surface shown in gray

Do not make sharp bends near the endcap

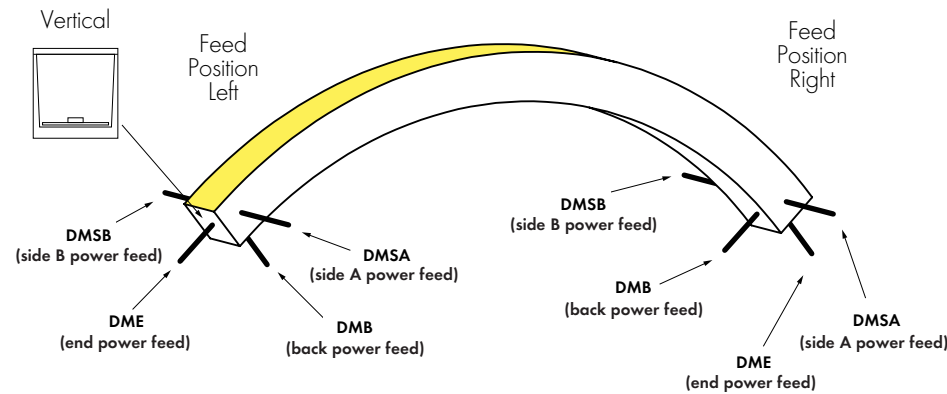

Vertical Bend Direction

Bend LED in these positions only to avoid damage

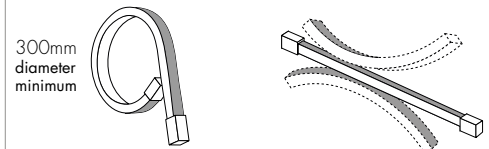

Illuminated surface shown in gray

Vertical Prohibited Bends

Twisting or bending LED in these positions will cause damage

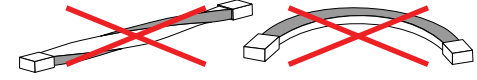

Illuminated surface shown in gray

Do not make sharp bends near the endcap

Linking and Extension Cable Options

END CONNECTOR

Injection-molded End Connector
-IME

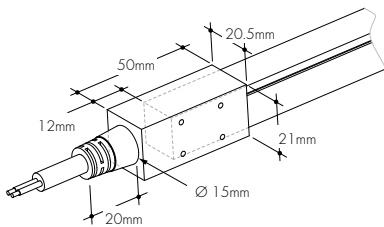

BACK CONNECTOR

Injection-molded Back Connector
-IMB

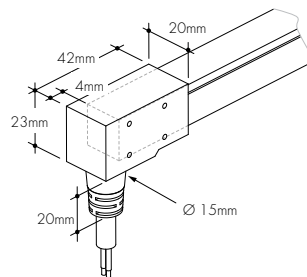

SIDE CONNECTOR

Injection-molded Side Connector
-IMSA and -IMSB

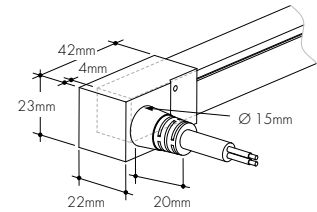

ENDCAP (NO CONNECTOR)

Injection-molded Cap (No Connector)
-NPF

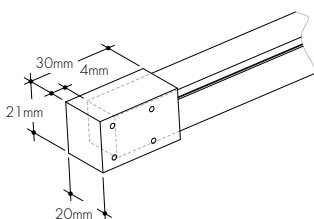

SJTW CABLE

Included on every power feed wire

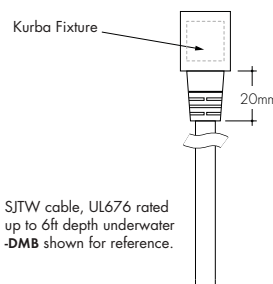

SJTW cable, UL676 rated up to 6ft depth underwater
-DMB shown for reference.

POWER FEED OPTIONS

Feeds come with 9m wire leads

WH/RED/GRN/BLU

BK



3 Conductor
18 AWG, SJTW



Product Dimensions

Kurba Large Pool Rated Cross Sections

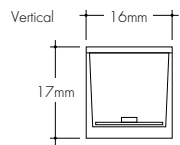
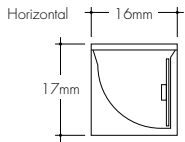

Example Feed Position
DME - NPF
 End Feed 1 to
 No Power Feed

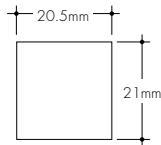

Example Feed Position
DMSA - NPF
 Side A Feed to
 No Power Feed

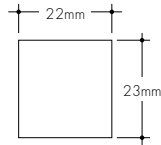

Example Feed Position
DMB - NPF
 Back Feed 1 to
 No Power Feed

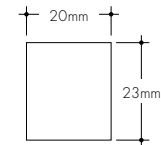

Example Feed Position
DME - DME
 End Feed 1 and
 End Feed 1

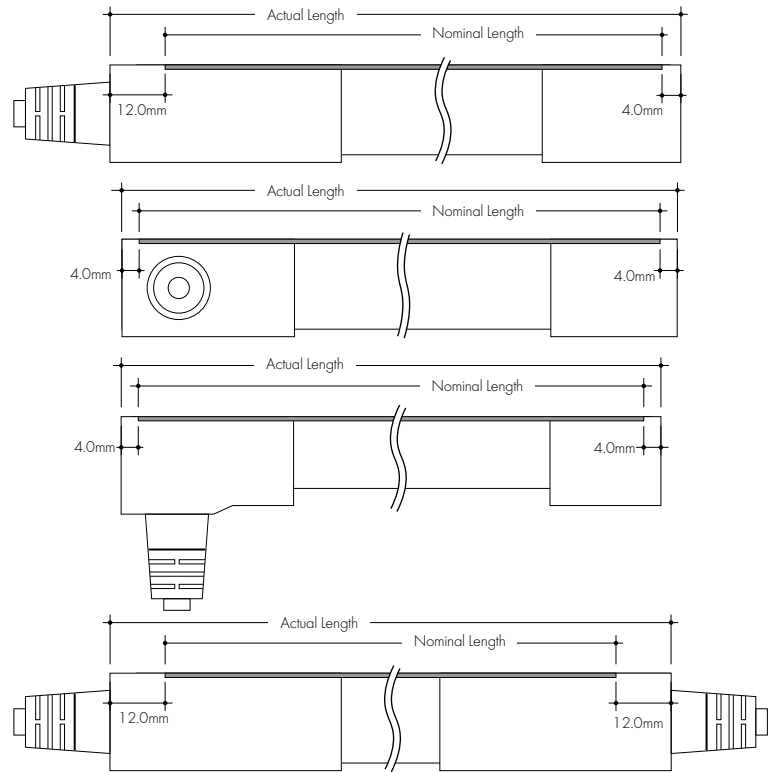
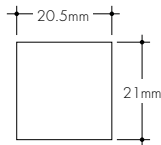

Finish Options

- A wide variety of finish options allowing complete customization of style and aesthetic.

White Base

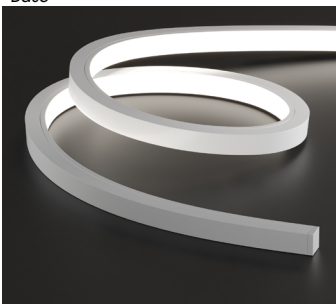

Kurba's base finish is a crisp white which brings a timeless, clean aesthetic that brightens and enhances any space



Light Transmission and Dotting

Output Options	Lens/Accessory
	Silicone Frosted/ White Finish
SPI88SO	ND
Transmission Percentage	100%



CD SD ND
CD - Clear Dotting
SD - Slight Dotting
ND - No Dotting

Mounting Accessories and Optional Connectors

MC-KBL-PLSTC-SM-35MM-CL

Thickened Plastic Mounting Channel for underwater application, 35mm

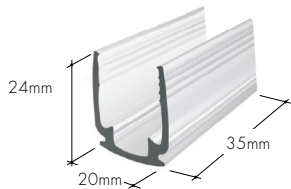

MC-KBL-PLSTC-SM-2M

Thickened Plastic Mounting Channel for underwater application, 2m

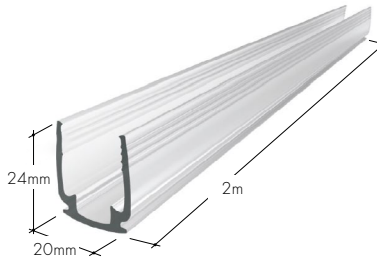

MC-KBL-BANP-3D-SM-1M-XX

KBL Mounting Channel, Bendable Silicone Profile, 3D Bending, Surface Mount, 1m, 300mm bending diameter

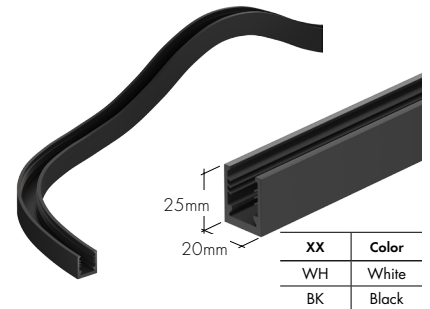

Includes 12 mounting screws

LVSP-IP66

Splice box: wet rated, low voltage, gray, IP66

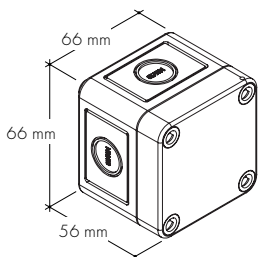

LVSP-IP66-CM

Connector for splice box, low voltage for cable management, gray, IP66

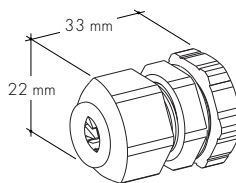

SPI88SO | Orderable Length Chart

Use Actual Length for Order Code Entry

Tolerance for Actual Lengths less than 1.8m is +/- 5mm, Actual Lengths between 1.8m and 4.8m is +/- 7.6mm, and Actual Lengths greater than 4.8m is +/- 15mm

A - End Connector at both ends of Kurba (12mm + 12mm added to overall length)

B - End Connector at one end of Kurba and No Connector or Back Connector or Side Connector at other end of Kurba (12mm + 4mm added to overall length)

C - Any combination of No Connector, Back Connector, or Side Connector on each end of Kurba (4mm + 4mm added to overall length)

Nominal Length (m)	Actual Length (m)				Nominal Length (m)	Actual Length (m)			
	A	B	C	Pixel Qty		A	B	C	Pixel Qty
0.20	0.191	0.183	0.175	2	2.60	2.607	2.599	2.591	31
0.25	0.274	0.266	0.258	3	2.70	2.690	2.683	2.675	32
0.35	0.357	0.349	0.341	4	2.75	2.774	2.766	2.758	33
0.45	0.441	0.433	0.425	5	2.85	2.857	2.849	2.841	34
0.50	0.524	0.516	0.508	6	2.95	2.940	2.933	2.925	35
0.60	0.607	0.599	0.591	7	3.00	3.024	3.016	3.008	36
0.70	0.691	0.683	0.675	8	3.10	3.107	3.099	3.091	37
0.75	0.774	0.766	0.758	9	3.20	3.190	3.183	3.175	38
0.85	0.857	0.849	0.841	10	3.25	3.274	3.266	3.258	39
0.95	0.941	0.933	0.925	11	3.35	3.357	3.349	3.341	40
1.00	1.024	1.016	1.008	12	3.45	3.440	3.433	3.425	41
1.10	1.107	1.099	1.091	13	3.50	3.524	3.516	3.508	42
1.20	1.190	1.183	1.175	14	3.60	3.607	3.599	3.591	43
1.25	1.274	1.266	1.258	15	3.70	3.690	3.683	3.675	44
1.35	1.357	1.349	1.341	16	3.75	3.774	3.766	3.758	45
1.45	1.440	1.433	1.425	17	3.85	3.857	3.849	3.841	46
1.50	1.524	1.516	1.508	18	3.95	3.940	3.933	3.925	47
1.60	1.607	1.599	1.591	19	4.00	4.024	4.016	4.008	48
1.70	1.690	1.683	1.675	20	4.10	4.107	4.099	4.091	49
1.75	1.774	1.766	1.758	21	4.20	4.190	4.183	4.175	50
1.85	1.857	1.849	1.841	22	4.25	4.274	4.266	4.258	51
1.95	1.940	1.933	1.925	23	4.35	4.357	4.349	4.341	52
2.00	2.024	2.016	2.008	24					
2.10	2.107	2.099	2.091	25					
2.20	2.190	2.183	2.175	26					
2.25	2.274	2.266	2.258	27					
2.35	2.357	2.349	2.341	28					
2.45	2.440	2.433	2.425	29					
2.50	2.524	2.516	2.508	30					

Note: all values are rounded to the nearest 2.5mm

Dual injection Molded End Cap (DME)

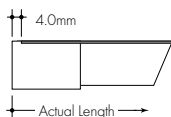

Dual injection Molded End Power Feed (DME)

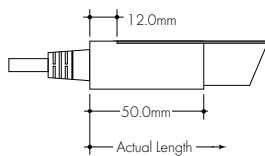

Dual injection Molded Bottom Power Feed (DMB)

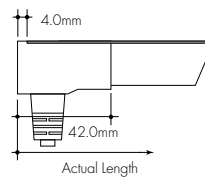

Dual injection Molded Side Power Feed (DMSA - DMSB)

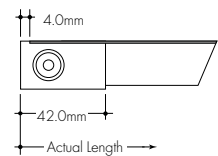

Lifetime and Environmental

At Luminii, we design our linear LED systems with longevity and responsible material use in mind. Our products are engineered to be serviceable and adaptable, with modular components such as drivers and controls that can be replaced or upgraded without full system replacement.

We are actively reducing the environmental impact of our packaging by transitioning to paper-based solutions for reels, bags, and outer packaging wherever possible, while minimising material use and avoiding mixed materials to improve recyclability.

We prioritise the use of recyclable materials in both our products and packaging, and encourage responsible disposal in line with local recycling and WEEE regulations.

CIBSE TM65	21.04kg CO ₂ e(1m)	UK PART L	
CIBSE TM66	2.1	Part L1A / L1B (Dwellings)	-
RoHS Compliance	Yes	<i>≥75 lm/W source lumens</i>	
REACH Compliance	Yes	Part L2A (General)	-
WEEE Compliance	Yes - Registered Producer	<i>≥95lm/W delivered lumens</i>	
Declare	Declared	Part L2A (Display)	-
Lifetime	L90B10 100,000hrs	<i>≥80 lm/W source lumens</i>	
Warranty	5 Years		

