

Kilo S - Installation Instructions

Models KILOS-CF & KILOS-SF

Please read all instructions prior to installation and keep for future reference!

1. PRODUCT TO BE INSTALLED BY A QUALIFIED ELECTRICIAN.
2. PRIOR TO INSTALLATION ENSURE POWER IS OFF AT FUSE BOX TO PREVENT ELECTRICAL SHOCK
3. USE ONLY WITH CLASS 2 POWER UNIT. UTILISER SEULEMENT AVEC LA CLASSE 2 UNITE D'ALIMENTATION ELECTRIQUE.
4. FIXTURE SHOULD BE INSTALLED BY TWO PEOPLE.



REVO.2
04152025

1 / 7



7777 Merrimac Ave
Niles, IL 60714
T 224.333.6033
F 224.757.7557
info@luminii.com
www.luminii.com

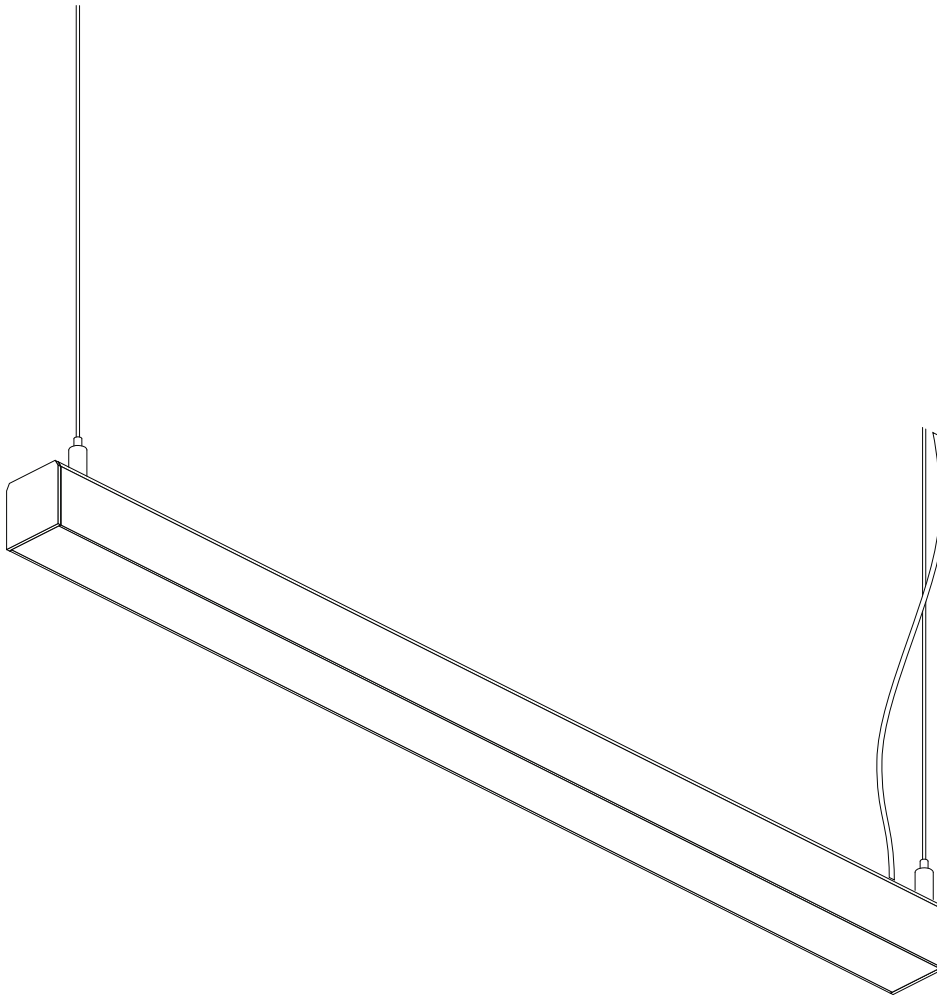

Kilo S - Installation Instructions

Models KILOS-CF & KILOS-SF

Please read all instructions prior to installation and keep for future reference!

1. PRODUCT TO BE INSTALLED BY A QUALIFIED ELECTRICIAN.
2. PRIOR TO INSTALLATION ENSURE POWER IS OFF AT FUSE BOX TO PREVENT ELECTRICAL SHOCK
3. USE ONLY WITH CLASS 2 POWER UNIT. UTILISER SEULEMENT AVEC LA CLASSE 2 UNITE D'ALIMENTATION ELECTRIQUE.
4. FIXTURE SHOULD BE INSTALLED BY TWO PEOPLE.



REVO.2
04152025



7777 Merrimac Ave
Niles, IL 60714
T 224.333.6033
F 224.757.7557
info@luminii.com
www.luminii.com

2 / 7

1

1.1 Measure the distance between the two standoff hubs. Then center the fixture to the junction box and mark the distance of the two standoff hubs to the ceiling.

Note: Prior to installation all 24VDC wires must be present in junction box. Refer to the power supply installation instruction for additional information.

Note: More than one person is recommended for this installation.

2

2.1 On the marked location(s), make a hole using a 13/64" drill bit.

2.2 Insert the anchor into the hole and push completely in.

2.3 Insert wood screw through cap & washer and then tighten to secure into the anchors.

3

3.1 Route the power feed cable through the strain relief bushing, canopy cover, and crossbar assembly

4

4.1 Connect power feed cable wires, per image above, to wires from the power supply. Insert terminations into the junction box.

Note: Prior to installing fixture to power, cable must be prepared to go inside crossbar assembly. If this step is skipped metal sleeve will tangle up.

Kilo S - Installation Instructions

Models KILOS-CF & KILOS-SF

Please read all instructions prior to installation and keep for future reference!

1. PRODUCT TO BE INSTALLED BY A QUALIFIED ELECTRICIAN.
2. PRIOR TO INSTALLATION ENSURE POWER IS OFF AT FUSE BOX TO PREVENT ELECTRICAL SHOCK
3. USE ONLY WITH CLASS 2 POWER UNIT. UTILISER SEULEMENT AVEC LA CLASSE 2 UNITE D'ALIMENTATION ELECTRIQUE.
4. FIXTURE SHOULD BE INSTALLED BY TWO PEOPLE.



REVO.2
04152025

3 / 7



7777 Merrimac Ave
Niles, IL 60714
T 224.333.6033
F 224.757.7557
info@luminii.com
www.luminii.com

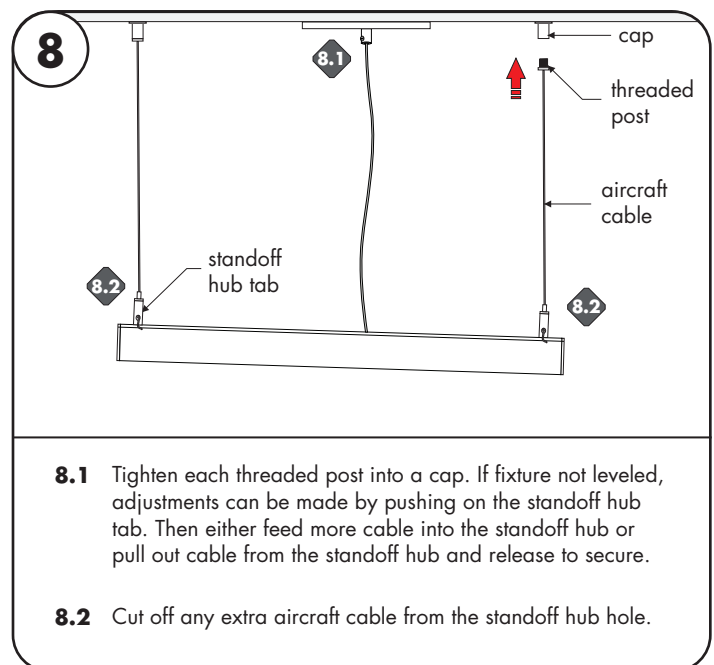
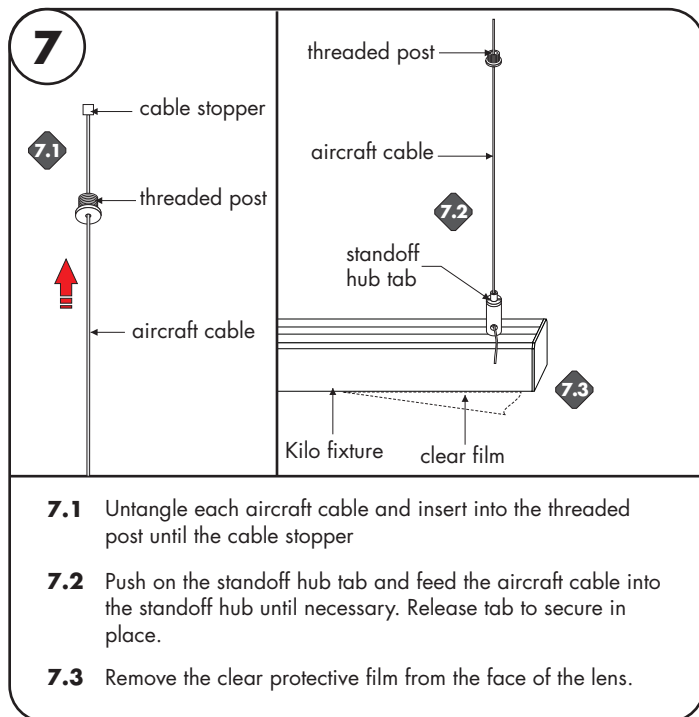
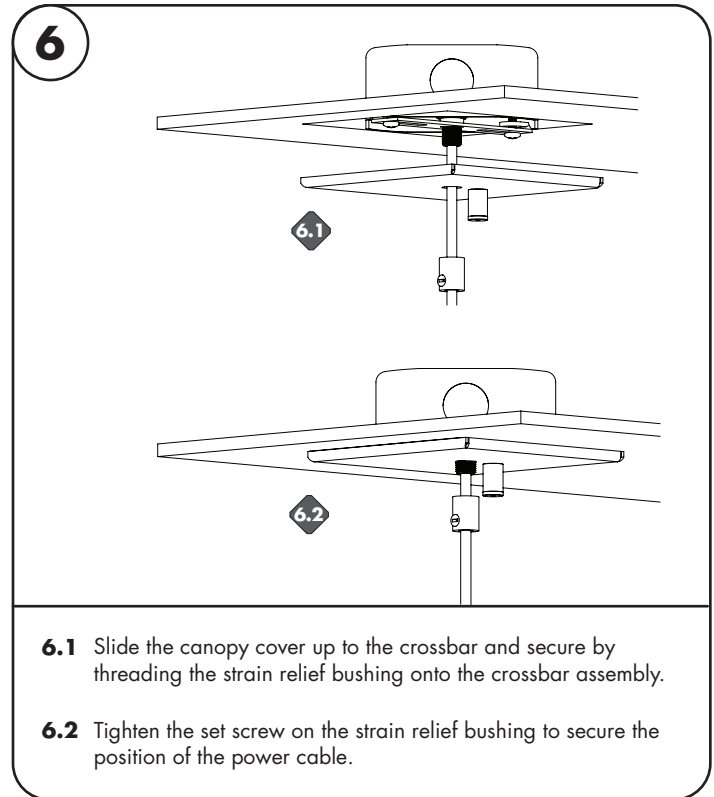
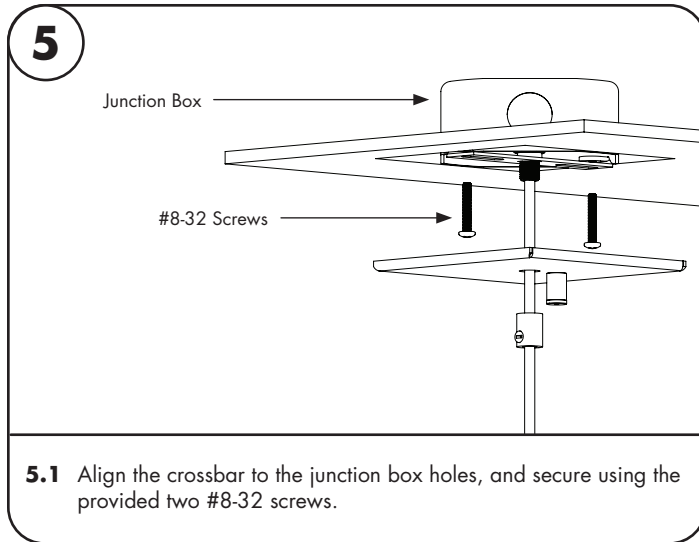

Kilo S - Installation Instructions

Models KILOS-CF & KILOS-SF

Please read all instructions prior to installation and keep for future reference!

1. PRODUCT TO BE INSTALLED BY A QUALIFIED ELECTRICIAN.
2. PRIOR TO INSTALLATION ENSURE POWER IS OFF AT FUSE BOX TO PREVENT ELECTRICAL SHOCK
3. USE ONLY WITH CLASS 2 POWER UNIT. UTILISER SEULEMENT AVEC LA CLASSE 2 UNITE D'ALIMENTATION ELECTRIQUE.
4. FIXTURE SHOULD BE INSTALLED BY TWO PEOPLE.



REVO.2
04152025



7777 Merrimac Ave
Niles, IL 60714
T 224.333.6033
F 224.757.7557
info@luminii.com
www.luminii.com

4 / 7

1

Note: Prior to installation all 24VDC wires must be present in junction box. Refer to the power supply installation instruction for additional information.

Note: More than one person is recommended for this installation.

1.1 Align one standoff hub to the junction box & measure the distance from standoff hub to the other hub. Then mark this location to the ceiling. Make addition marks if using more than one standoffs. Use canopy detail to sighting off center standoff hub.

2

2.1 On the marked location(s), make a hole using a 13/64" drill bit.

2.2 Insert the anchor into the hole and push completely in.

2.3 Insert wood screw through cap & washer and then tighten to secure into the anchors.

3

3.1 Route the power feed cable through the strain relief bushing, canopy cover., and crossbar assembly

4

Note: Prior to installing fixture to power, cable must be prepared to go inside crossbar assembly. If this step is skipped metal sleeve will tangle up.

4.1 Connect power feed cable wires, per image above, to wires from the power supply. Insert terminations into the junction box.

Kilo S - Installation Instructions

Models KILOS-CF & KILOS-SF

Please read all instructions prior to installation and keep for future reference!

1. PRODUCT TO BE INSTALLED BY A QUALIFIED ELECTRICIAN.
2. PRIOR TO INSTALLATION ENSURE POWER IS OFF AT FUSE BOX TO PREVENT ELECTRICAL SHOCK
3. USE ONLY WITH CLASS 2 POWER UNIT. UTILISER SEULEMENT AVEC LA CLASSE 2 UNITE D'ALIMENTATION ELECTRIQUE.
4. FIXTURE SHOULD BE INSTALLED BY TWO PEOPLE.



REVO.2
04152025

5 / 7



7777 Merrimac Ave
Niles, IL 60714
T 224.333.6033
F 224.757.7557
info@luminii.com
www.luminii.com

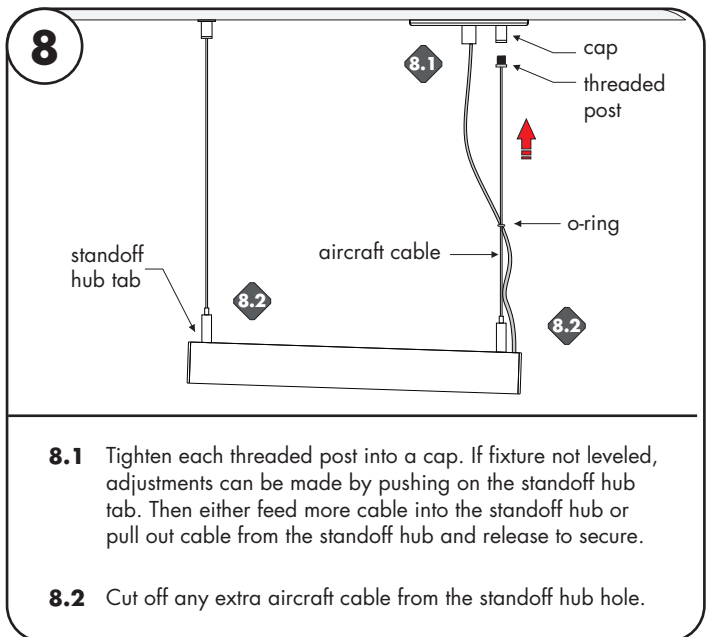
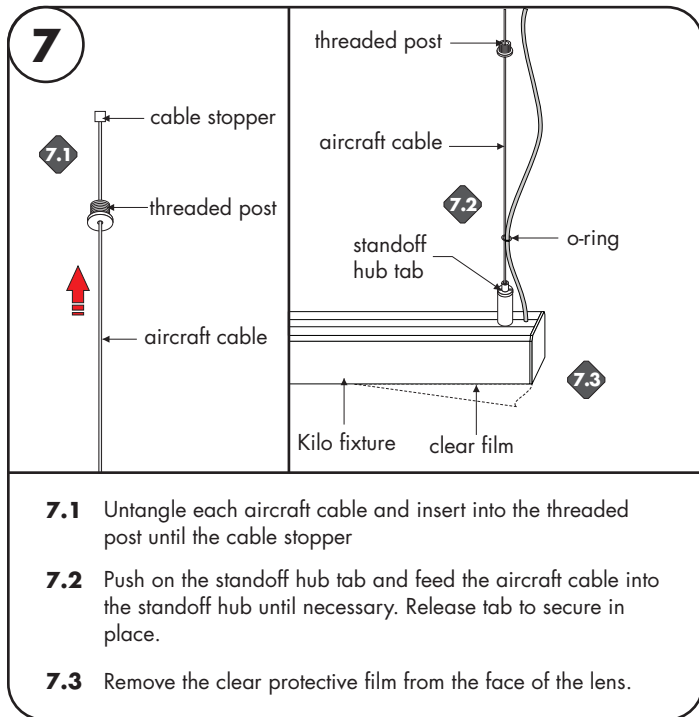
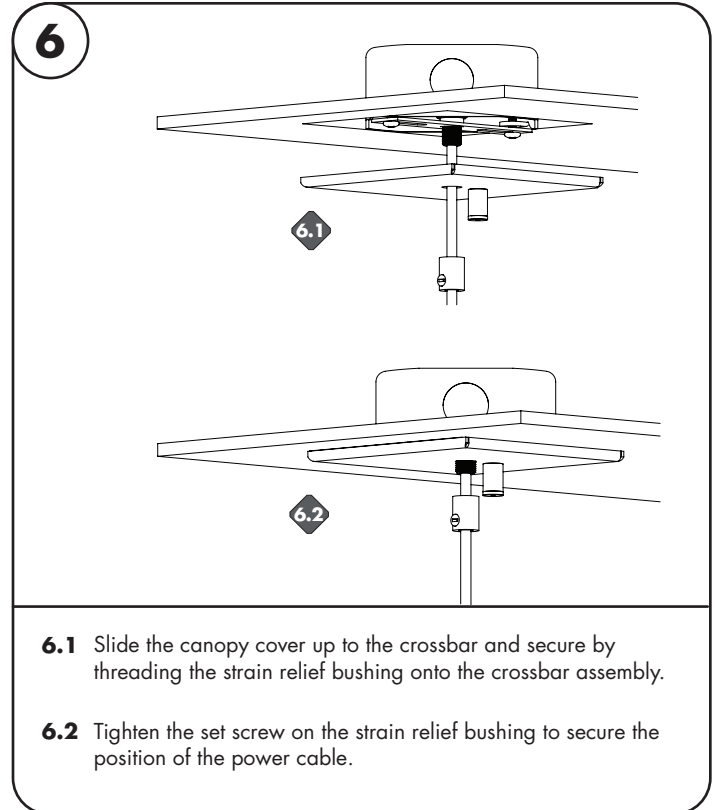
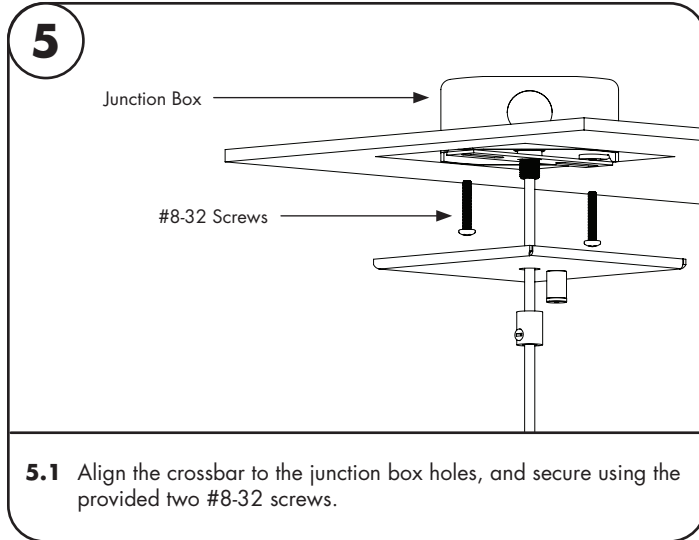

Kilo S - Installation Instructions

Models KILOS-CF & KILOS-SF

Please read all instructions prior to installation and keep for future reference!

1. PRODUCT TO BE INSTALLED BY A QUALIFIED ELECTRICIAN.
2. PRIOR TO INSTALLATION ENSURE POWER IS OFF AT FUSE BOX TO PREVENT ELECTRICAL SHOCK
3. USE ONLY WITH CLASS 2 POWER UNIT. UTILISER SEULEMENT AVEC LA CLASSE 2 UNITE D'ALIMENTATION ELECTRIQUE.
4. FIXTURE SHOULD BE INSTALLED BY TWO PEOPLE.



REVO.2
04152025

6 / 7



7777 Merrimac Ave
Niles, IL 60714
T 224.333.6033
F 224.757.7557
info@luminii.com
www.luminii.com

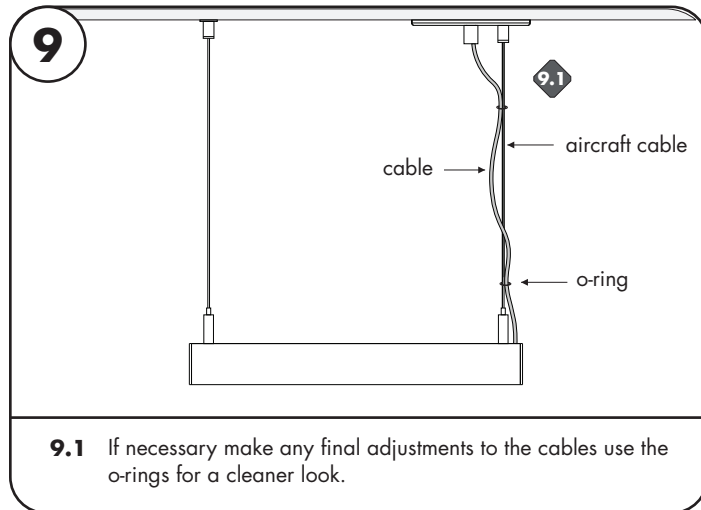

Kilo S - Installation Instructions

Models KILOS-CF & KILOS-SF

Please read all instructions prior to installation and keep for future reference!

1. PRODUCT TO BE INSTALLED BY A QUALIFIED ELECTRICIAN.
2. PRIOR TO INSTALLATION ENSURE POWER IS OFF AT FUSE BOX TO PREVENT ELECTRICAL SHOCK
3. USE ONLY WITH CLASS 2 POWER UNIT. UTILISER SEULEMENT AVEC LA CLASSE 2 UNITE D'ALIMENTATION ELECTRIQUE.
4. FIXTURE SHOULD BE INSTALLED BY TWO PEOPLE.



REVO.2
04152025

7 / 7



7777 Merrimac Ave
Niles, IL 60714
T 224.333.6033
F 224.757.7557
info@luminii.com
www.luminii.com

Power Supply Wiring Diagram

Note: Prior to installation all 24VDC wires must be present near fixture. Refer to the power supply installation instructions for additional information.



Static White
Wiring Diagram PDF



RGB/RGBW
Wiring Diagram PDF



Warm Dim
Wiring Diagram PDF

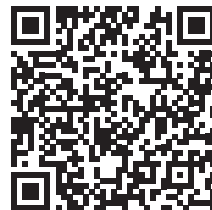

Pixel
Wiring Diagram PDF



Tunable White
Wiring Diagram PDF