

Features

BA240-10MM is a high-performance LED strip designed for applications requiring exceptional colour quality and output from a compact form factor. It delivers 90+ CRI across the full output range, maintaining efficacy above 127 lm/W at 3000K IP20.

With a density of 240 LEDs per metre and multiple lumen output options, the strip provides flexible performance from subtle accent levels through to outputs exceeding 2000 lm per metre. This product is available with IP20, IP54 or IP65* ratings.

*Finished width 12mm

Mounting

LED strip is equipped with 3M™ adhesive tape.

Applications

Indoor only - millwork, cove, architectural reveals, undercabinet, display case, handrail, accent lighting.

Approvals

CE, UKCA, Class III

Operating voltage

24 VDC

Average Life (L70)

50,000 hours

Warranty

5 years

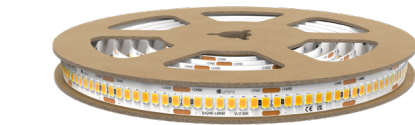

BA240-10MM-IP20/IP54-XX

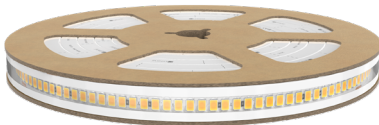

BA240-10MM-IP65-XX



Technical information

TYPE	BA240-10MM-IP20					BA240-10MM-IP54					BA240-10MM-IP65				
	VLO	LO	SO	MO	HO	VLO	LO	SO	MO	HO	VLO	LO	SO	MO	HO
Lumens Output (3000K)	320 lm/m	639 lm/m	1279 lm/m	1880 lm/m	2447 lm/m	314 lm/m	626 lm/m	1253 lm/m	1842 lm/m	2398 lm/m	291 lm/m	581 lm/m	1164 lm/m	1711 lm/m	2227 lm/m
Average Power Consumption	2.4 W/m	4.8 W/m	9.6 W/m	14.4 W/m	19.2 W/m	2.4 W/m	4.8 W/m	9.6 W/m	14.4 W/m	19.2 W/m	2.4 W/m	4.8 W/m	9.6 W/m	14.4 W/m	19.2 W/m
Efficacy	133 lm/W	133 lm/W	133 lm/W	131 lm/W	127 lm/W	131 lm/W	130 lm/W	130 lm/W	128 lm/W	125 lm/W	121 lm/W	121 lm/W	121 lm/W	119 lm/W	116 lm/W
Cutting Increment	33.3 mm					33.3 mm					33.3 mm				
Pitch Length	4.20 mm					4.20 mm					4.20 mm				
Max Run Length (in series)	9 m	8 m	7 m	6 m	5 m	9 m	8 m	7 m	6 m	5 m	9 m	8 m	7 m	6 m	5 m
Dimensions	10 mm W x 2.3 mm H					10 mm W x 2.3 mm H					12 mm W x 5.0 mm H				
Ambient Operating Temperature Range	-20°C - 40°C					-20°C - 40°C					-20°C - 40°C				

CCT	Multiplier (reference - 3000K)	CRI	TM-30		
			R _f	R _g	R ₉
2200K	0.82	92	91	98	53
2400K	0.87	92	90	99	51
2700K	0.97	92	91	97	50
3000K	1.00	92	90	100	52
3500K	1.03	92	90	100	56
4000K	1.05	92	89	100	56
5000K	1.02	93	91	99	71
6500K	0.97	92	92	98	67

IP20/IP54

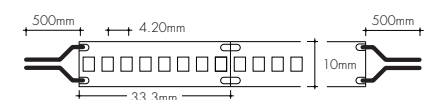

IP65

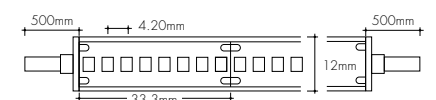

Note: IP65 has a minimum finished size of 12mm x 5.5mm and requires a compatible extrusion/channel to suit.

Ordering code

MODEL	OUTPUT	CCT	REEL SIZE
BA240-10MM-IP20 - IP20 BA240-10MM-IP54 - IP54 BA240-10MM-IP65 - IP65 ¹	VLO - Very Low 2.4 W/m LO - Low 4.8 W/m SO - Standard 9.6 W/m MO - Medium 14.4 W/m HO - High 19.2 W/m	22K - 2200K 24K - 2400K 27K - 2700K 30K - 3000K 35K - 3500K 40K - 4000K 50K - 5000K 65K - 6500K	R5M - Reel, 5 metre

Note: ¹ IP65 versions use the 10mm PCB platform but have a finished width of 12mm due to the silicone extrusion.



Output

CCT	Multiplier	BA240-10MM-IP20					BA240-10MM-IP54					BA240-10MM-IP65				
		VLO (lm/m)	LO (lm/m)	SO (lm/m)	MO (lm/m)	HO (lm/m)	VLO (lm/m)	LO (lm/m)	SO (lm/m)	MO (lm/m)	HO (lm/m)	VLO (lm/m)	LO (lm/m)	SO (lm/m)	MO (lm/m)	HO (lm/m)
2200K	0.82	262	524	1049	1542	2007	257	514	1028	1511	1966	239	477	954	1403	1826
2400K	0.87	278	556	1113	1636	2129	273	545	1090	1603	2086	253	506	1013	1488	1937
2700K	0.97	310	620	1241	1824	2374	304	607	1216	1787	2326	282	564	1129	1659	2160
3000K	1	320	639	1279	1880	2447	314	626	1253	1842	2398	291	581	1164	1711	2227
3500K	1.03	330	658	1317	1936	2520	323	645	1291	1898	2470	300	599	1199	1762	2294
4000K	1.05	336	671	1343	1974	2569	329	658	1316	1935	2518	306	611	1222	1796	2338
5000K	1.02	326	652	1305	1918	2496	320	639	1278	1879	2446	297	593	1187	1745	2271
6500K	0.97	310	620	1241	1824	2374	304	607	1216	1787	2326	282	564	1129	1659	2160

Lifetime and Environmental

At Luminii, we design our LED strip systems with longevity and responsible material use in mind. Our products are engineered to be serviceable and adaptable, with modular components such as drivers and controls that can be replaced or upgraded without full system replacement.

We are actively reducing the environmental impact of our packaging by transitioning to paper-based solutions for reels, bags, and outer packaging wherever possible, while minimising material use and avoiding mixed materials to improve recyclability.

We prioritise the use of recyclable materials in both our products and packaging, and encourage responsible disposal in line with local recycling and WEEE regulations.

CIBSE TM65	46.1 Kg/CO ₂ e (5m complete reel)
CIBSE TM66	2.1
RoHS Compliance	Yes
REACH Compliance	Yes
WEEE Compliance	Yes - Registered Producer
Declare	-
Lifetime	L90B10 100,000hrs
Warranty	5 Years



Lens Options / Light Transmission

KS CHANNEL -KSC

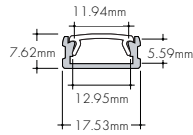

Ordering code

MODEL	LENGTH	LENS	MOUNTING ¹	FINISH
KSC - KS Channel	2M - 2 metre	C - Clear F - Frosted	FC - Fixed Clip FC45 - Fixed Clip 45°	SA - Silver Anodized

¹ - Extrusion comes with 3 selected clips and 2 end caps.

Lens	Clear Lens				Frosted Lens			
Dimming Level	100%	50%	10%	1%	100%	50%	10%	1%
Dotting	CD	CD	CD	CD	ND	SD	SD	CD
Transmission	90%				56%			

KM CHANNEL -KMC

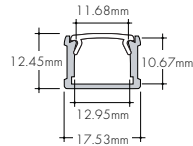

Ordering code

MODEL	LENGTH	LENS	MOUNTING ¹	FINISH
KMC - KM Channel	2M - 2 metre	C - Clear F - Frosted	FC - Fixed Clip FC45 - Fixed Clip 45°	SA - Silver Anodized

¹ - Extrusion comes with 3 selected clips and 2 end caps.

Lens	Clear Lens				Frosted Lens			
Dimming Level	100%	50%	10%	1%	100%	50%	10%	1%
Dotting	CD	CD	CD	CD	ND	ND	ND	ND
Transmission	82%				51%			

KXL CHANNEL -KXLC

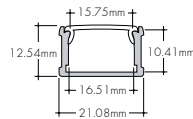

Ordering code

MODEL	LENGTH	LENS	MOUNTING ¹	FINISH
KXLC - KXL Channel	2M - 2 metre	C - Clear F - Frosted	FC - Fixed Clip FC45 - Fixed Clip 45°	SA - Silver Anodized

¹ - Extrusion comes with 3 selected clips and 2 end caps.

Lens	Clear Lens				Frosted Lens			
Dimming Level	100%	50%	10%	1%	100%	50%	10%	1%
Dotting	CD	CD	CD	CD	ND	ND	ND	ND
Transmission	86%				54%			

KRS CHANNEL -KRSC

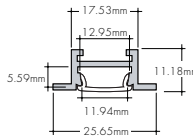

Ordering code

MODEL	LENGTH	LENS	MOUNTING ¹	FINISH
KRSC - KRS Channel	2M - 2 metre	C - Clear F - Frosted	HS - Hard Surface Mounting Bracket GS - Gypsum Surface Mounting Bracket	SA - Silver Anodized

¹ - Extrusion comes with 3-HS/6-GS selected clips and 2 end caps.

Lens	Clear Lens				Frosted Lens			
Dimming Level	100%	50%	10%	1%	100%	50%	10%	1%
Dotting	CD	CD	CD	CD	ND	SD	SD	CD
Transmission	90%				56%			

Installation

All mounting channels are field cuttable using miter saw with circular blade suitable for cutting aluminum.

Ordering

Extrusion are sold separately.

Dotting



CD - Clear Dotting

SD - Slight Dotting

ND - No Dotting



Lens Options / Light Transmission

KRM CHANNEL -KRM C

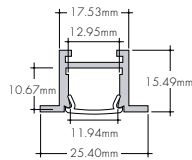
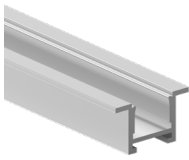

Ordering code

MODEL	LENGTH	LENS	MOUNTING ¹	FINISH
KRMC-KRM Channel	2M- 2 metre	C - Clear F - Frosted	HS - Hard Surface Mounting Bracket GS - Gypsum Surface Mounting Bracket	SA - Silver Anodized

¹ - Extrusion comes with 3-HS/6-GS selected clips and 2 end caps.

Lens	Clear Lens				Frosted Lens				
	Dimming Level	100%	50%	10%	1%	100%	50%	10%	1%
Dotting	CD	CD	CD	CD	ND	ND	ND	ND	ND
Transmission	82%				51%				

KRXL CHANNEL -KRXL C

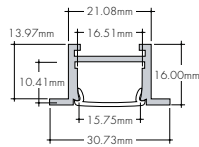
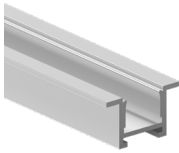

Ordering code

MODEL	LENGTH	LENS	MOUNTING ¹	FINISH
KRXLK-KRXL Channel	2M- 2 metre	C - Clear F - Frosted	HS - Hard Surface Mounting Bracket GS - Gypsum Surface Mounting Bracket	SA - Silver Anodized

¹ - Extrusion comes with 3-HS/6-GS selected clips and 2 end caps.

Lens	Clear Lens				Frosted Lens				
	Dimming Level	100%	50%	10%	1%	100%	50%	10%	1%
Dotting	CD	CD	CD	CD	ND	ND	ND	ND	ND
Transmission	86%				54%				

K45R CHANNEL -K45RC

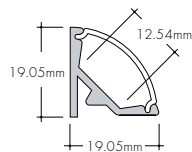

Ordering code

MODEL	LENGTH	LENS	MOUNTING ¹	FINISH
K45RC-K45R Channel	2M- 2 metre	RF - Round Frosted	CB - Concealed Bracket	SA - Silver Anodized

¹ - Extrusion comes with 3 selected clips and 2 end caps.

Lens	Round Frosted				
	Dimming Level	100%	50%	10%	1%
Dotting	ND	ND	ND	ND	ND
Transmission	65%				

KLBC CHANNEL -KLBC

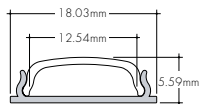

Ordering code

MODEL	LENGTH	LENS	MOUNTING ¹	FINISH
KLBC-KL Bendable Channel	2M- 2 metre	F - Frosted	FC - Fixed Clip	SA - Silver Anodized

¹ - Extrusion comes with 7 selected clips and 2 end caps.

Lens	Round Frosted				
	Dimming Level	100%	50%	10%	1%
Dotting	ND	ND	ND	ND	ND
Transmission	57%				

Installation

All mounting channels are field cuttable using miter saw with circular blade suitable for cutting aluminum.

Ordering

Extrusion are sold separately.

Dotting



CD - Clear Dotting
SD - Slight Dotting
ND - No Dotting



Mounting Clips for KSC, KMC and KLXC

Fixed mounting clip -FC

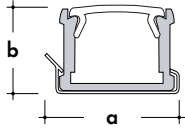

Model	a (mm)	b (mm)
KSC	19.6	7.9
KMC	20.6	13.5
KXLC	24.1	13.2

Fixed mounting clip 45° -FC45

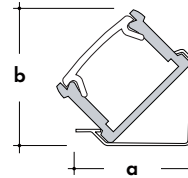

Model	a (mm)	b (mm)
KSC	17.0	16.3
KMC	17.5	20.8
KXLC	23.4	23.4

Mounting Clips for KRSC, KRMC and KRXLC

Stainless Steel Gypsum Surface Mounting Bracket -GS

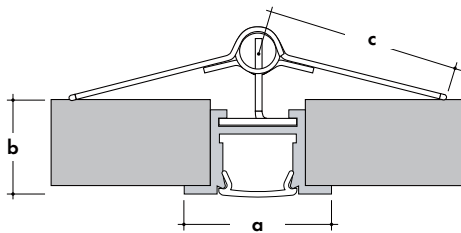

Model	a (mm)	b (mm)	c (mm)
KRSC	25.7	22.4	35.6
KRMC	25.7	26.7	35.6
KRXLC	30.7	26.7	35.6

Stainless Steel Hard Surface Mounting Bracket -HS

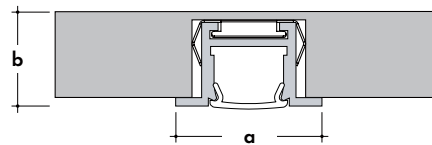

Model	a (mm)	b (mm)
KRSC	25.7	11.7
KRMC	25.7	16.3
KRXLC	30.7	16.3

Mounting Clip for K45RC

Stainless Steel Concealed Bracket -CB

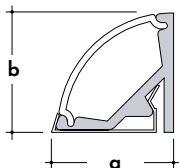

Model	a (mm)	b (mm)
K45RC	19.0	19.0

Mounting Clip for KLBC

Stainless steel screw-in mounting bracket -FC

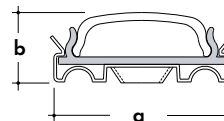

Model	a (mm)	b (mm)
KLBC	19.3	7.6



Basics Strip BA240-10MM

Minii Connectors for IP20 and IP54

Minii connectors are easy, field-installable accessories that make joining LL strip simple! Their minimal width allows them to fit into extrusions, while their transparent frame eliminates dark spots.

Note: verify internal extrusion dimensions to confirm compatibility

LL-PJC-10

Jumper minii connector with 76mm wire for 10mm IP20 and IP54 LED strip. 4.5A max rating.

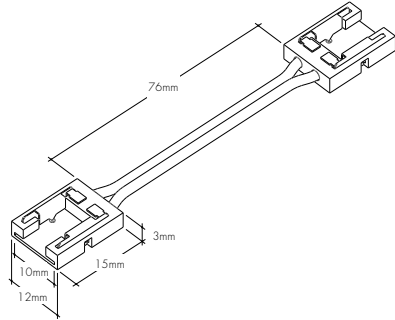

LL-PFC-10-1.8M

Power feed minii connector with 1.8m wire for 10mm IP20 and IP54 LED strip. 4.5A max rating.

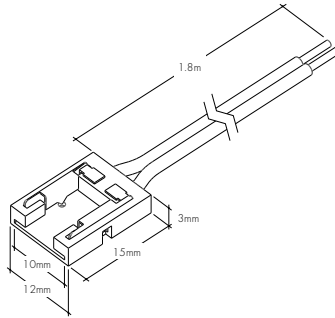

LL-BSC-10

Butt splice minii connector for 10mm IP20 and IP54 LED strip. 4.5A max rating.

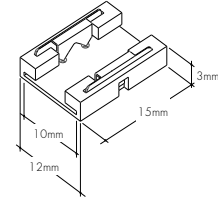

Sample Layout

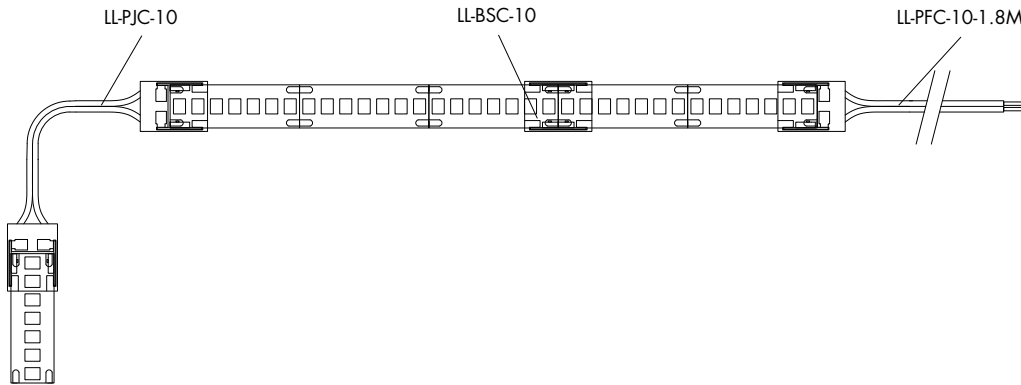

Accessories for IP20 and IP54

CL1

Mounting clip

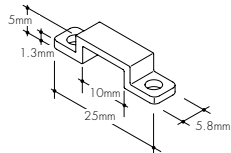

LVSP-IP20-4T-BK

Low Voltage, 4 Terminal Splice Box, Black

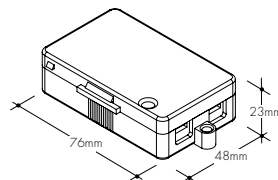

LL-ZIP

Cable/Wire Strain Relief Clip

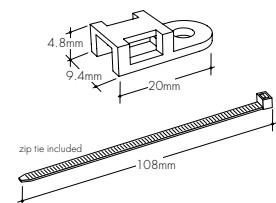

Recommended every 300mm when LineLED strip is facing down



IP65 Connectors

These connectors allow for field cutting and connections of IP65 LED strip.

BA-IP65-PJC-WT-10

Jumper connector with 150mm wire for IP65 LED strip. 4.5A max rating.

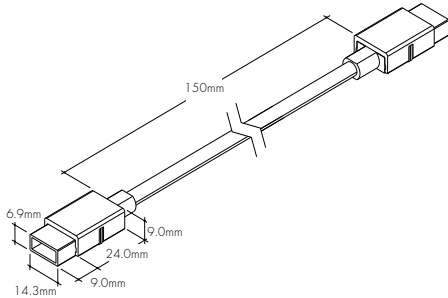

BA-IP65-PFC-10-WT-1M

Wet Power feed mini connector with 150mm wire for IP65 LED strip. 4.5A max rating.

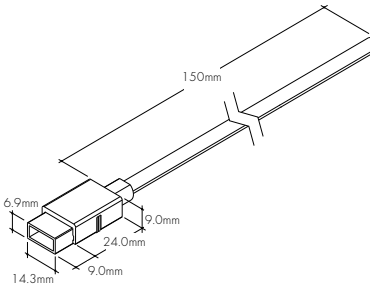

LL-BSC-10

Butt splice connector for IP65 strip. 4.5A max rating. Must be sealed with silicone.

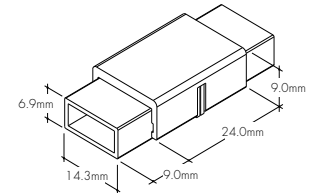

Sample Layout

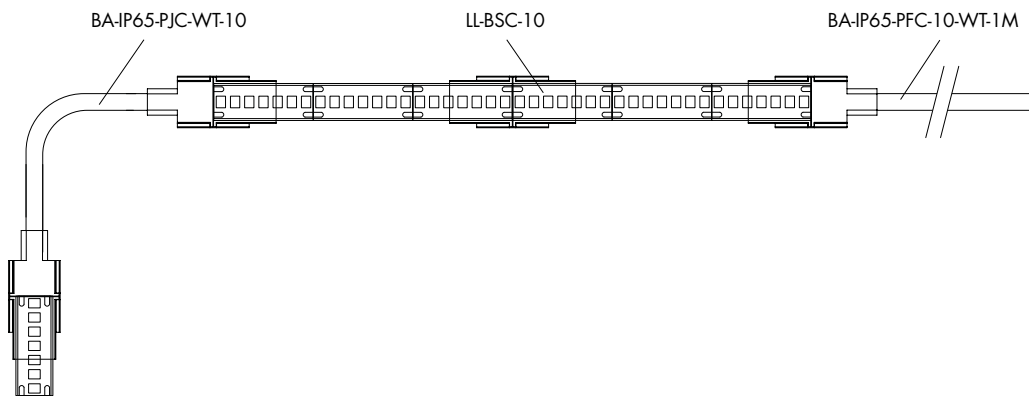

Accessories

LVSP-IP66

Splice box: wet rated, low voltage, gray

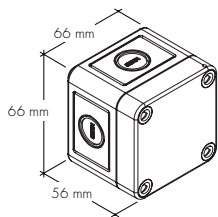

LVSP-IP66-CM

Splice box connector, low voltage, gray

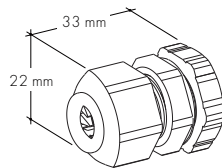

CL2

Mounting clip

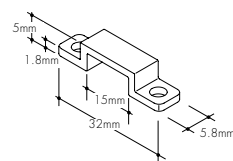

Recommended every 300mm when LineLED strip is facing down

LL-ZIP

Cable/Wire Strain Relief Clip

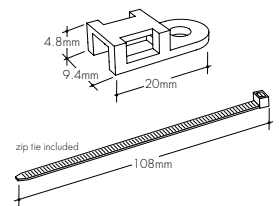

EC-SIL-10MM

Silicone End Cap for sealing the end of IP65 LED strip

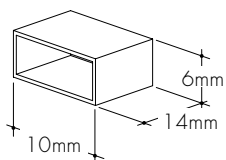

SIL-502-RTV

ASI 502 high performance 100% RTV silicone sealant, 83ml

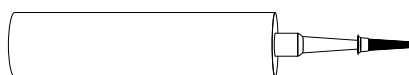

Basics Strip BA240-10MM

Power Supplies for UK, EU, Middle East, Asia and Pacific

DALI 2 | Remote | Constant Voltage

Input Voltage	230V AC 50/60 Hz
Driver Type	Remote Constant Voltage
Location	IP20 Indoor Location Only
Dimming Control	DALI 2
Min. Dim Level	0.1%
Flicker	IEEE 1789 Compatible No Observable Effect



MODELS	40W	75W	150W	240W
Order Code	PSCV-40-24-D-EU	PSCV-75-24-D-EU	PSCV-150-24-D-EU	PSCV-240-24-D-EU
Length (mm)	185	295	295	360
Width (mm)	40	40	40	40
Depth (mm)	30	30	30	30

0-10V | Remote | Constant Voltage

Input Voltage	230V AC 50/60 Hz
Driver Type	Remote Constant Voltage
Location	IP20 Indoor Location Only
Dimming Control	0-10V
Min. Dim Level	0.1%
Flicker	IEEE 1789 Compatible No Observable Effect



MODELS	40W	75W	150W	240W
Order Code	PSCV-40-24-A-EU	PSCV-75-24-A-EU	PSCV-150-24-A-EU	PSCV-240-24-A-EU
Length (mm)	185	295	295	360
Width (mm)	40	40	40	40
Depth (mm)	30	30	30	30

Max Series Run Length and Voltage Drop

The maximum series run length must not be exceeded. LED strips must be cut and re-fed from the power supply if the required length exceeds this. Maximum series run lengths can be found on page 1 and vary per output. Voltage drop must not exceed 3% between the PSU and start of the LED strip. Click or scan the QR code to visit our online voltage drop calculator.

