



BA160-10MM-IP20/IP54-XX



BA160-10MM-IP65-XX



Features

BA160-10MM is a high-performance LED strip designed for applications requiring exceptional colour quality and output from a compact form factor. It delivers 90+ CRI across the full output range, maintaining efficacy above 126 lm/W at 3000K IP20.

With a density of 160 LEDs per metre and multiple lumen output options, the strip provides flexible performance from subtle accent levels through to outputs exceeding 2000 lm per metre. This product is available with IP20, IP54 or IP65 ratings.

Mounting

LED strip is equipped with 3M™ adhesive tape.

Applications

Indoor only - millwork, cove, architectural reveals, undercabinet, display case, handrail, accent lighting.

Approvals

CE, UKCA, Class III

Operating voltage

24 VDC

Average Life (L70)

50,000 hours

Warranty

5 years



Technical information

TYPE	BA160-10MM-IP20					BA160-10MM-IP54					BA160-10MM-IP65				
	VLO	LO	SO	MO	HO	VLO	LO	SO	MO	HO	VLO	LO	SO	MO	HO
Lumens Output (3000K)	317 lm/m	635 lm/m	1239 lm/m	1835 lm/m	2427 lm/m	311 lm/m	622 lm/m	1214 lm/m	1798 lm/m	2378 lm/m	288 lm/m	578 lm/m	1127 lm/m	1670 lm/m	2209 lm/m
Average Power Consumption	2.4 W/m	4.8 W/m	9.6 W/m	14.4 W/m	19.2 W/m	2.4 W/m	4.8 W/m	9.6 W/m	14.4 W/m	19.2 W/m	2.4 W/m	4.8 W/m	9.6 W/m	14.4 W/m	19.2 W/m
Efficacy	132 lm/W	132 lm/W	129 lm/W	127 lm/W	126 lm/W	129 lm/W	130 lm/W	126 lm/W	125 lm/W	124 lm/W	120 lm/W	120 lm/W	117 lm/W	116 lm/W	115 lm/W
Cutting Increment	50.0 mm					50.0 mm					50.0 mm				
Pitch Length	6.25 mm					6.25 mm					6.25 mm				
Max Run Length (in series)	9 m	8 m	7 m	6 m	5 m	9 m	8 m	7 m	6 m	5 m	9 m	8 m	7 m	6 m	5 m
Dimensions	10 mm W x 2.3 mm H					10 mm W x 2.3 mm H					12 mm W x 5.0 mm H				
Ambient Operating Temperature Range	-20°C - 40°C					-20°C - 40°C					-20°C - 40°C				

CCT	Multiplier (reference - 3000K)	CRI	TM-30		
			R _f	R _g	R _g
2200K	0.82	92	91	98	53
2400K	0.87	92	90	99	51
2700K	0.97	92	91	97	50
3000K	1.00	92	90	100	52
3500K	1.03	92	90	100	56
4000K	1.05	92	89	100	56
5000K	1.02	93	91	99	71
6500K	0.97	92	92	98	67

IP20/IP54

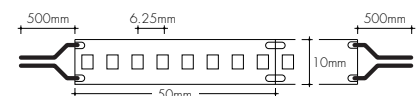

IP65

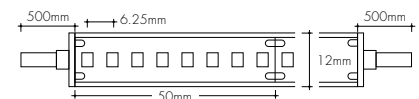

Note: IP65 has a minimum finished size of 12mm x 5.5mm and requires a compatible extrusion/channel to suit.

Ordering code

MODEL	OUTPUT	CCT	REEL SIZE
BA160-10MM-IP20 - IP20 BA160-10MM-IP54 - IP54 BA160-10MM-IP65 - IP65 ¹	VLO - Very Low 2.4 W/m LO - Low 4.8 W/m SO - Standard 9.6 W/m MO - Medium 14.4 W/m HO - High 19.2 W/m	22K - 2200K 24K - 2400K 27K - 2700K 30K - 3000K 35K - 3500K 40K - 4000K 50K - 5000K 65K - 6500K	R5M - Reel, 5 metre

Note: ¹ IP65 versions use the 10mm PCB platform but have a finished width of 12mm due to the silicone extrusion.



Output

CCT	Multiplier	BA160-10MM-IP20					BA160-10MM-IP54					BA160-10MM-IP65				
		VLO (lm/m)	LO (lm/m)	SO (lm/m)	MO (lm/m)	HO (lm/m)	VLO (lm/m)	LO (lm/m)	SO (lm/m)	MO (lm/m)	HO (lm/m)	VLO (lm/m)	LO (lm/m)	SO (lm/m)	MO (lm/m)	HO (lm/m)
2200K	0.82	260	521	1016	1505	1990	255	510	996	1475	1950	237	474	925	1369	1811
2400K	0.87	276	552	1078	1596	2111	270	541	1056	1565	2069	251	503	981	1453	1921
2700K	0.97	307	616	1202	1780	2354	301	604	1178	1744	2307	280	561	1094	1620	2142
3000K	1	317	635	1239	1835	2427	311	622	1214	1798	2378	288	578	1127	1670	2209
3500K	1.03	327	654	1276	1890	2500	320	641	1251	1852	2450	297	595	1161	1720	2275
4000K	1.05	333	667	1301	1927	2548	326	653	1275	1888	2497	303	607	1184	1753	2319
5000K	1.02	323	648	1264	1872	2476	317	635	1239	1834	2426	294	589	1150	1703	2253
6500K	0.97	307	616	1202	1780	2354	301	604	1178	1744	2307	280	561	1094	1620	2142

Lifetime and Environmental

At Luminii, we design our LED strip systems with longevity and responsible material use in mind. Our products are engineered to be serviceable and adaptable, with modular components such as drivers and controls that can be replaced or upgraded without full system replacement.

We are actively reducing the environmental impact of our packaging by transitioning to paper-based solutions for reels, bags, and outer packaging wherever possible, while minimising material use and avoiding mixed materials to improve recyclability.

We prioritise the use of recyclable materials in both our products and packaging, and encourage responsible disposal in line with local recycling and WEEE regulations.

CIBSE TM65	42.3 Kg/CO ₂ e (5m complete reel)
CIBSE TM66	2.1
RoHS Compliance	Yes
REACH Compliance	Yes
WEEE Compliance	Yes - Registered Producer
Declare	-
Lifetime	L90B10 100,000hrs
Warranty	5 Years



Lens Options / Light Transmission

KS CHANNEL -KSC

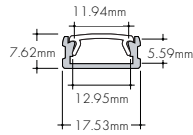

Ordering code

MODEL	LENGTH	LENS	MOUNTING ¹	FINISH
KSC - KS Channel	2M - 2 metre	C - Clear F - Frosted	FC - Fixed Clip FC45 - Fixed Clip 45°	SA - Silver Anodized

¹ - Extrusion comes with 3 selected clips and 2 end caps.

Lens	Clear Lens				Frosted Lens			
Dimming Level	100%	50%	10%	1%	100%	50%	10%	1%
Dotting	CD	CD	CD	CD	ND	SD	SD	CD
Transmission	90%				56%			

KM CHANNEL -KMC

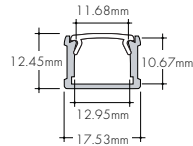

Ordering code

MODEL	LENGTH	LENS	MOUNTING ¹	FINISH
KMC - KM Channel	2M - 2 metre	C - Clear F - Frosted	FC - Fixed Clip FC45 - Fixed Clip 45°	SA - Silver Anodized

¹ - Extrusion comes with 3 selected clips and 2 end caps.

Lens	Clear Lens				Frosted Lens			
Dimming Level	100%	50%	10%	1%	100%	50%	10%	1%
Dotting	CD	CD	CD	CD	ND	ND	ND	ND
Transmission	82%				51%			

KXL CHANNEL -KXLC

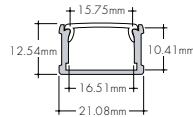

Ordering code

MODEL	LENGTH	LENS	MOUNTING ¹	FINISH
KXLC - KXL Channel	2M - 2 metre	C - Clear F - Frosted	FC - Fixed Clip FC45 - Fixed Clip 45°	SA - Silver Anodized

¹ - Extrusion comes with 3 selected clips and 2 end caps.

Lens	Clear Lens				Frosted Lens			
Dimming Level	100%	50%	10%	1%	100%	50%	10%	1%
Dotting	CD	CD	CD	CD	ND	ND	ND	ND
Transmission	86%				54%			

KRS CHANNEL -KRSC

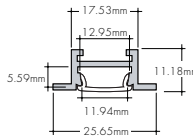

Ordering code

MODEL	LENGTH	LENS	MOUNTING ¹	FINISH
KRSC - KRS Channel	2M - 2 metre	C - Clear F - Frosted	HS - Hard Surface Mounting Bracket GS - Gypsum Surface Mounting Bracket	SA - Silver Anodized

¹ - Extrusion comes with 3-HS/6-GS selected clips and 2 end caps.

Lens	Clear Lens				Frosted Lens			
Dimming Level	100%	50%	10%	1%	100%	50%	10%	1%
Dotting	CD	CD	CD	CD	ND	SD	SD	CD
Transmission	90%				56%			

Installation

All mounting channels are field cuttable using miter saw with circular blade suitable for cutting aluminum.

Ordering

Extrusion are sold separately.

Dotting



CD - Clear Dotting

SD - Slight Dotting

ND - No Dotting



Lens Options / Light Transmission

KRM CHANNEL -KRM C

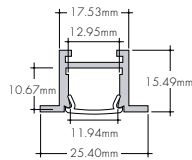
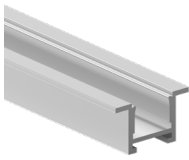

Ordering code

MODEL	LENGTH	LENS	MOUNTING ¹	FINISH
KRMC-KRM Channel	2M- 2 metre	C - Clear F - Frosted	HS - Hard Surface Mounting Bracket GS - Gypsum Surface Mounting Bracket	SA - Silver Anodized

¹ - Extrusion comes with 3-HS/6-GS selected clips and 2 end caps.

Lens	Clear Lens				Frosted Lens				
	Dimming Level	100%	50%	10%	1%	100%	50%	10%	1%
Dotting	CD	CD	CD	CD	ND	ND	ND	ND	ND
Transmission	82%				51%				

KRXL CHANNEL -KRXL C

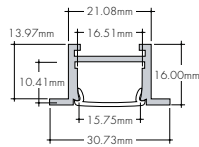
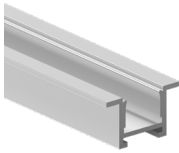

Ordering code

MODEL	LENGTH	LENS	MOUNTING ¹	FINISH
KRXLK-KRXL Channel	2M- 2 metre	C - Clear F - Frosted	HS - Hard Surface Mounting Bracket GS - Gypsum Surface Mounting Bracket	SA - Silver Anodized

¹ - Extrusion comes with 3-HS/6-GS selected clips and 2 end caps.

Lens	Clear Lens				Frosted Lens				
	Dimming Level	100%	50%	10%	1%	100%	50%	10%	1%
Dotting	CD	CD	CD	CD	ND	ND	ND	ND	ND
Transmission	86%				54%				

K45R CHANNEL -K45RC

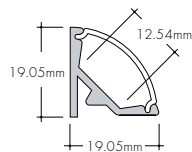

Ordering code

MODEL	LENGTH	LENS	MOUNTING ¹	FINISH
K45RC-K45R Channel	2M- 2 metre	RF - Round Frosted	CB - Concealed Bracket	SA - Silver Anodized

¹ - Extrusion comes with 3 selected clips and 2 end caps.

Lens	Round Frosted				
	Dimming Level	100%	50%	10%	1%
Dotting	ND	ND	ND	ND	ND
Transmission	65%				

KLBC CHANNEL -KLBC

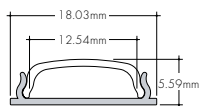

Ordering code

MODEL	LENGTH	LENS	MOUNTING ¹	FINISH
KLBC-KL Bendable Channel	2M- 2 metre	F - Frosted	FC - Fixed Clip	SA - Silver Anodized

¹ - Extrusion comes with 7 selected clips and 2 end caps.

Lens	Round Frosted				
	Dimming Level	100%	50%	10%	1%
Dotting	ND	ND	ND	ND	ND
Transmission	57%				

Installation

All mounting channels are field cuttable using miter saw with circular blade suitable for cutting aluminum.

Ordering

Extrusion are sold separately.

Dotting



CD - Clear Dotting
SD - Slight Dotting
ND - No Dotting



Mounting Clips for KSC, KMC and KLXC

Fixed mounting clip -FC

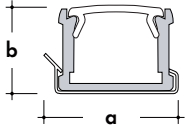

Model	a (mm)	b (mm)
KSC	19.6	7.9
KMC	20.6	13.5
KXLC	24.1	13.2

Fixed mounting clip 45° -FC45

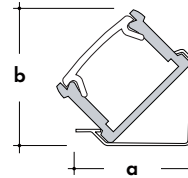

Model	a (mm)	b (mm)
KSC	17.0	16.3
KMC	17.5	20.8
KXLC	23.4	23.4

Mounting Clips for KRSC, KRMC and KRXLC

Stainless Steel Gypsum Surface Mounting Bracket -GS

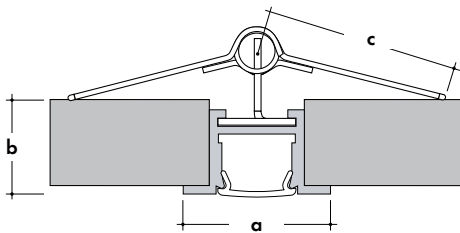

Model	a (mm)	b (mm)	c (mm)
KRSC	25.7	22.4	35.6
KRMC	25.7	26.7	35.6
KRXLC	30.7	26.7	35.6

Stainless Steel Hard Surface Mounting Bracket -HS

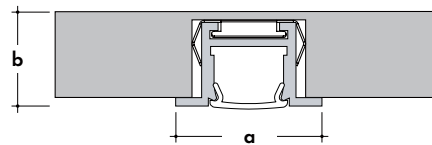

Model	a (mm)	b (mm)
KRSC	25.7	11.7
KRMC	25.7	16.3
KRXLC	30.7	16.3

Mounting Clip for K45RC

Stainless Steel Concealed Bracket -CB

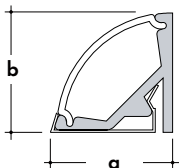

Model	a (mm)	b (mm)
K45RC	19.0	19.0

Mounting Clip for KLBC

Stainless steel screw-in mounting bracket -FC

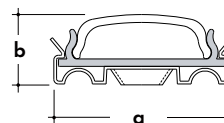

Model	a (mm)	b (mm)
KLBC	19.3	7.6



Minii Connectors for IP20 and IP54

Minii connectors are easy, field-installable accessories that make joining LL strip simple! Their minimal width allows them to fit into extrusions, while their transparent frame eliminates dark spots.

Note: verify internal extrusion dimensions to confirm compatibility

LL-PJC-10

Jumper minii connector with 76mm wire for 10mm IP20 and IP54 LED strip. 4.5A max rating.

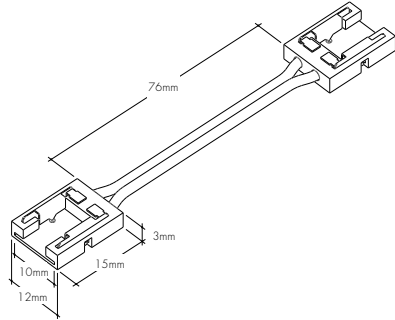

LL-PFC-10-1.8M

Power feed minii connector with 1.8m wire for 10mm IP20 and IP54 LED strip. 4.5A max rating.

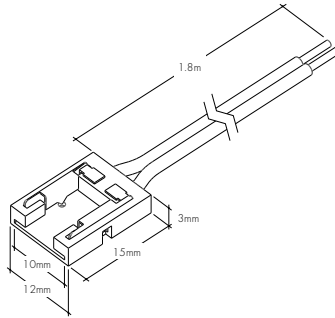

LL-BSC-10

Butt splice minii connector for 10mm IP20 and IP54 LED strip. 4.5A max rating.

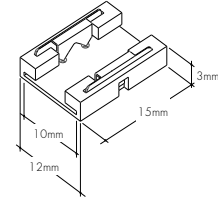

Sample Layout

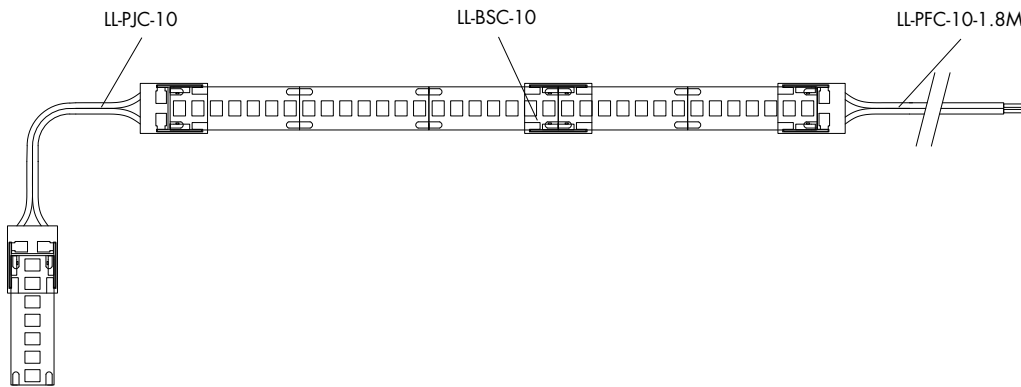

Accessories for IP20 and IP54

CL1

Mounting clip

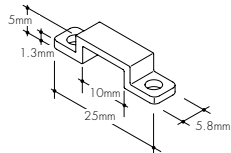

LVSP-IP20-4T-BK

Low Voltage, 4 Terminal Splice Box, Black

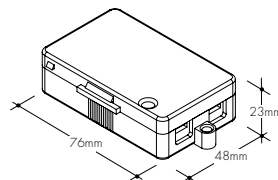

LL-ZIP

Cable/Wire Strain Relief Clip

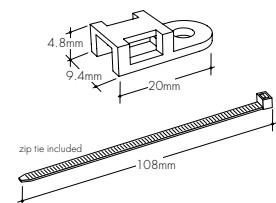

Recommended every 300mm when LineLED strip is facing down



IP65 Connectors

These connectors allow for field cutting and connections of IP65 LED strip.

BA-IP65-PJC-WT-10

Jumper connector with 150mm wire for IP65 LED strip. 4.5A max rating.

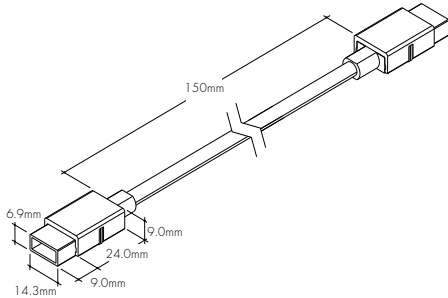

BA-IP65-PFC-10-WT-1M

Wet Power feed mini connector with 150mm wire for IP65 LED strip. 4.5A max rating.

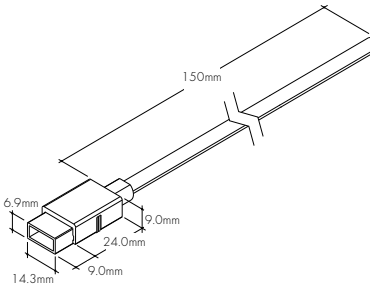

LL-BSC-10

Butt splice connector for IP65 strip. 4.5A max rating. Must be sealed with silicone.

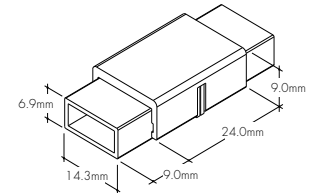

Sample Layout

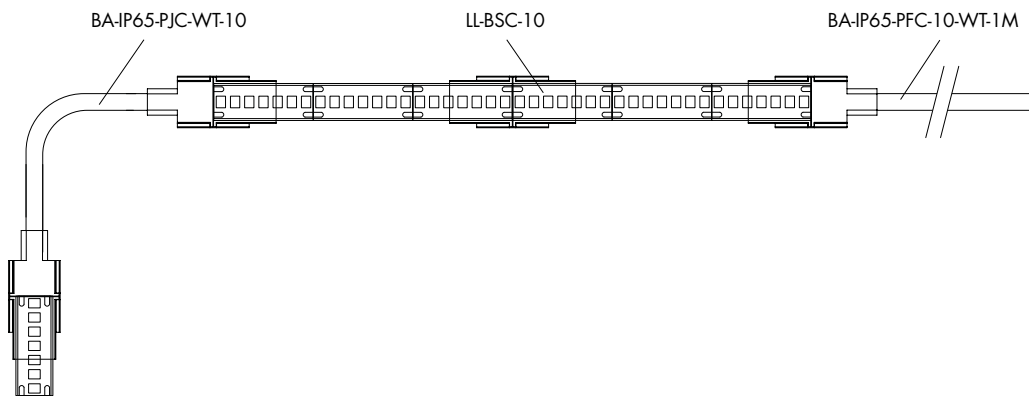

Accessories

LVSP-IP66

Splice box: wet rated, low voltage, gray

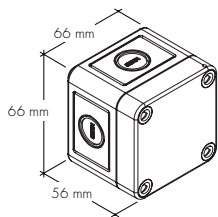

LVSP-IP66-CM

Splice box connector, low voltage, gray

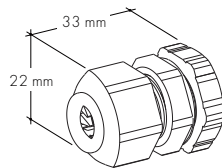

CL2

Mounting clip

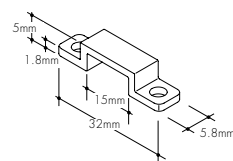

Recommended every 300mm when LineLED strip is facing down

LL-ZIP

Cable/Wire Strain Relief Clip

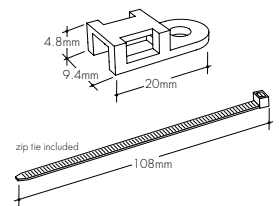

EC-SIL-10MM

Silicone End Cap for sealing the end of IP65 LED strip

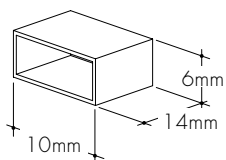

SIL-502-RTV

ASI 502 high performance 100% RTV silicone sealant, 83ml

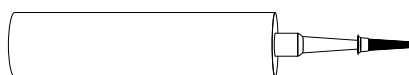

Basics Strip BA160-10MM

Power Supplies for UK, EU, Middle East, Asia and Pacific

DALI 2 | Remote | Constant Voltage

Input Voltage	230V AC 50/60 Hz
Driver Type	Remote Constant Voltage
Location	IP20 Indoor Location Only
Dimming Control	DALI 2
Min. Dim Level	0.1%
Flicker	IEEE 1789 Compatible No Observable Effect



MODELS	40W	75W	150W	240W
Order Code	PSCV-40-24-D-EU	PSCV-75-24-D-EU	PSCV-150-24-D-EU	PSCV-240-24-D-EU
Length (mm)	185	295	295	360
Width (mm)	40	40	40	40
Depth (mm)	30	30	30	30

0-10V | Remote | Constant Voltage

Input Voltage	230V AC 50/60 Hz
Driver Type	Remote Constant Voltage
Location	IP20 Indoor Location Only
Dimming Control	0-10V
Min. Dim Level	0.1%
Flicker	IEEE 1789 Compatible No Observable Effect



MODELS	40W	75W	150W	240W
Order Code	PSCV-40-24-A-EU	PSCV-75-24-A-EU	PSCV-150-24-A-EU	PSCV-240-24-A-EU
Length (mm)	185	295	295	360
Width (mm)	40	40	40	40
Depth (mm)	30	30	30	30

Max Series Run Length and Voltage Drop

The maximum series run length must not be exceeded. LED strips must be cut and re-fed from the power supply if the required length exceeds this. Maximum series run lengths can be found on page 1 and vary per output. Voltage drop must not exceed 3% between the PSU and start of the LED strip. Click or scan the QR code to visit our online voltage drop calculator.

