

LIDEA Deluxe

alva®

Fully Sealed Healthcare Grade Lamp Shade, High Performance Led Wall Sconce



Lidea-24 with Island Breeze Resin, ESN trim

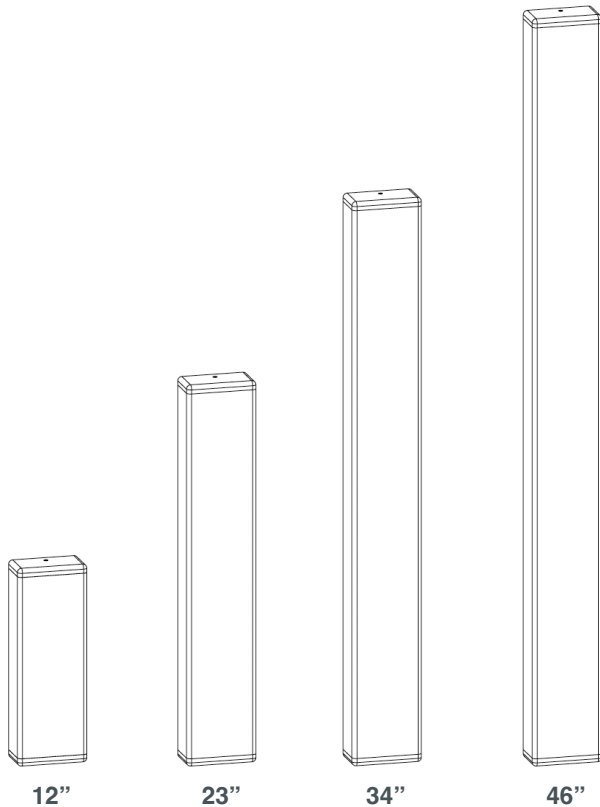

APPLICATIONS

- Healthcare, Commercial Bathroom Vanities, Senior Living, Retail, Corporate, High-Rises, Hospitality

MOUNTING

- J-Box 3.0 or 4.0 compatible
- Can be mounted vertically or horizontally or ceiling

DIMMING

- 0-10V Dimming and LumenSelect 4-level light output dial

SPECIFICATIONS

- Fully sealed lamp shade
- High Efficiency, fully integrated proprietary LED Module
- L90 - 100,000+ hours. 10 years / 24/7
- 120-277 Vac Input
- 90 CRI (minimum)
- Color Temperature Select (CCT), Integrated four CCT select (2700K, 3000K, 3500K, 4000K) OPTIONAL (specify)

CERTIFICATIONS

- UL Damp Listed
- ADA Compliant
- IK10 UL Certified (protected against 20 joules of impact)
- Fully Sealed Shade
- Title 24 JA8 Certified

CONSTRUCTION

- Shade: Durable ARCHITECTURAL RESIN by ALVA
- Trim: Architectural grade metal finish. Optional Antimicrobial Finish (must specify)

LIDEA Deluxe

alva®

Fully Sealed Healthcare Grade Lamp Shade, High Performance Led Wall Sconce

LUMENSELECT™

LUMENSELECT™, a dimming control panel on all ALVA luminaires, allows you to customize light output to create the desired atmosphere and to limit the consumption of electricity. The LUMENSELECT™ rotary switch should be turned gently clockwise with a small flathead screwdriver with a 1/8" or 3mm wide tip, one click at a time from factory setting to get desired output level.

Setting LUMENSELECT™ Levels

Set LUMENSELECT™ levels using the control panel on the end cap of ALVA luminaires. ALVA luminaires come factory set at 100% light output. You may choose from four output settings, typically performed at the time of installation:

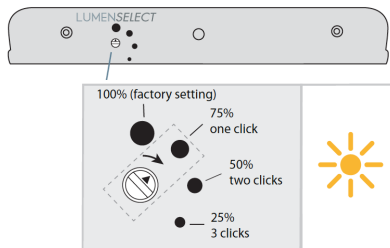

- 100% light output & energy consumption
- 75% light output & energy consumption
- 50% light output & energy consumption
- 25% light output & energy consumption

CCTSELECT

Set CCTSELECT levels using control panel on the end cap of ALVA luminaires. ALVA luminaires come set at your call out in your order. If CCT is not indicated, your module will be set at 3000K by default.

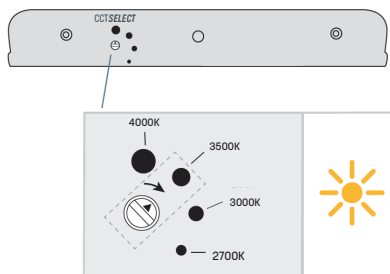

REMOTE DIMMING OPTION, 0 - 10V (100 - 10%)

0-10V dimming may be used with compatible dimmer controls (Please refer to alvalight.com for a listing of compatible dimmers)



Lidea-46 with White Resin shade, ESN trim

Line Drawing

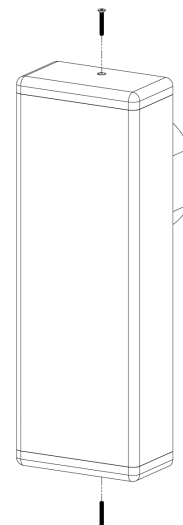

LIDEA Deluxe



Fully Sealed Healthcare Grade Lamp Shade, High Performance Led Wall Sconce

Resin Shade Options Vandal resistant, architectural resin by ALVA®

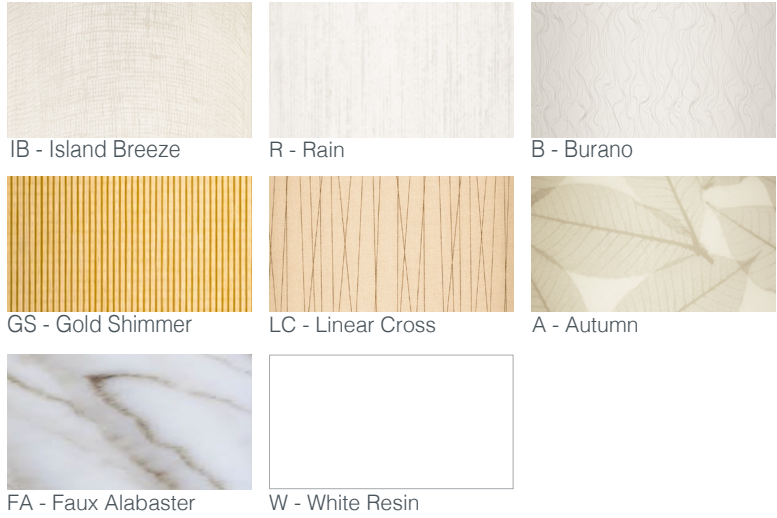

Metal Trim Options Powder Coat Finish Options

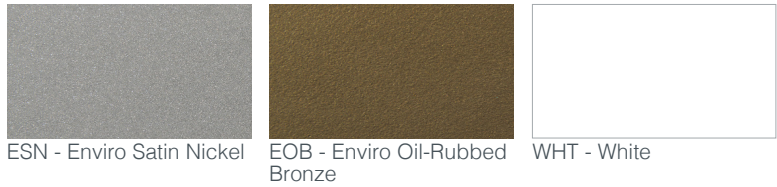

MODEL	WATTS	DELIVERED LUMENS	LENGTH	WIDTH	DEPTH	WEIGHT	DIMMING	WARRANTY
Lidea Deluxe-12	12.5W	620 LM	12"	4.5"	3"	5 lbs	0-10V	10 year
Lidea Deluxe-23	25W	1226 LM	23"	4.5"	3"	10 lbs	0-10V	10 year
Lidea Deluxe-34	35W	1860 LM	34"	4.5"	3"	14 lbs	0-10V	10 year
Lidea Deluxe-46	50W	2452 LM	46"	4.5"	3"	20 lbs	0-10V	10 year

ORDER CODE:

MODEL	LENGTH	SHADE PATTERN	METAL TRIM	CCT	ANTIMICROBIAL FINISH
LIDEA					
	12 12"	IB Island Breeze	ESN Enviro Satin Nickel	2700 2700K	AM Antimicrobial Finish
	23 23"	A Autumn		3000 3000K	
	34 34"	LC Linear Cross	EOB Enviro Oil-Rubbed Bronze	3500 3500K	
	46 45.5"	GS Gold Shimmer		4000 4000K	
		B Burano	WHT White		
		W White			
		R Rain			
		FA Faux Alabaster			