

mCAL Channel - Installation Instructions



7777 Merrimac Ave
Niles, IL 60714
T 224.333.6033
F 224.757.7557
info@luminii.com
www.luminii.com

Please read all instructions prior to installation and keep for future reference!

- | | |
|--|--|
| 1. PRODUCT TO BE INSTALLED BY A QUALIFIED ELECTRICIAN. | 5. WALL MOUNT ONLY |
| 2. USE ONLY WITH CLASS 2 POWER UNIT | 6. SUITABLE FOR INSTALLATION WITHIN THE CLOSET STORAGE SPACE |
| 3. 24 VOLTS DC | 7. INHERENTLY PROTECTED |
| 4. SUITABLE FOR DAMP LOCATIONS | 8. FIXTURE SHOULD BE INSTALLED BY TWO PEOPLE |

1

1.1 If necessary cut the extrusion, reflector & cover to the desired length, with the proper equipment/tool that is appropriate to cut aluminum.

2

2.1 LineLED can be shortened by cutting along the dashed lines in between the solder pads. Make sure the cut is made on the side of the LineLED without the wire leads. LineLED cannot touch the metal endcap which will shorten the circuit.

3

3.1 Prior to installing the fixture, 3 sets of holes need to be made into the extrusion. Refer to drawing above to make all necessary holes to the extrusion. For installation to work properly.

- Drill two 5/32" hole, 4" from each end of the extrusion and at least 2 more for the mounting the extrusion properly.
- Drill two 3/32" holes, 1/8" away from each end of the fixtures. For the endcaps to secure properly.
- If necessary drill a 1/2" hole on the extrusion to connect a conduit connector.

4

4.1 Holes will also have to be made to the reflector, Refer to drawing above to make all necessary holes to the reflector.

- Drill two 9/64" hole, 1/2" from each end of the extrusion, to secure reflector to extrusion.
- Drill a 11/64" hole, 1/4" from one end of the reflector for the LineLED wires to connect to the power feed wire.

mCAL Channel - Installation Instructions

Please read all instructions prior to installation and keep for future reference!

1. PRODUCT TO BE INSTALLED BY A QUALIFIED ELECTRICIAN.
2. USE ONLY WITH CLASS 2 POWER UNIT
3. 24 VOLTS DC
4. SUITABLE FOR DAMP LOCATIONS
5. WALL MOUNT ONLY
6. SUITABLE FOR INSTALLATION WITHIN THE CLOSET STORAGE SPACE
7. INHERENTLY PROTECTED
8. FIXTURE SHOULD BE INSTALLED BY TWO PEOPLE

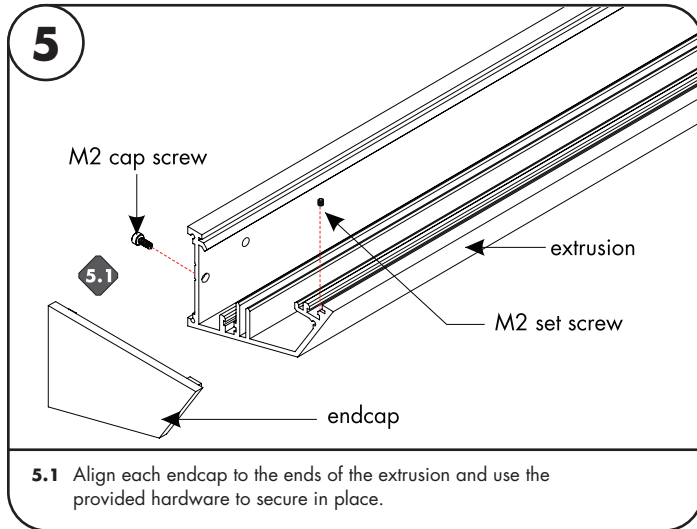

5.1 Align each endcap to the ends of the extrusion and use the provided hardware to secure in place.

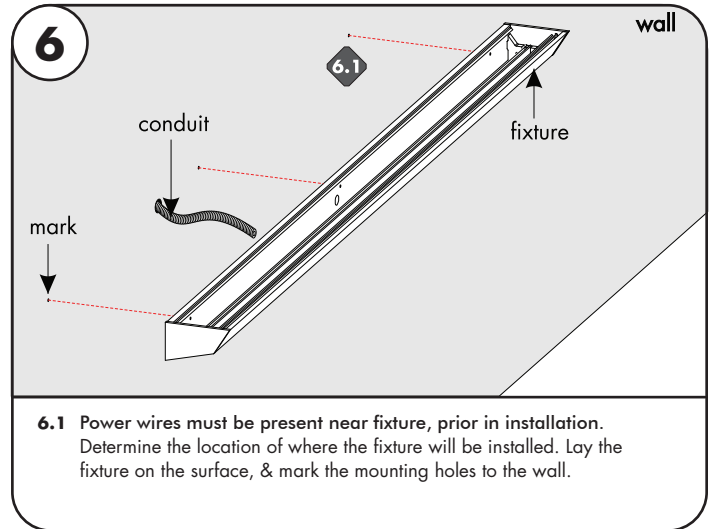

6.1 Power wires must be present near fixture, prior in installation. Determine the location of where the fixture will be installed. Lay the fixture on the surface, & mark the mounting holes to the wall.

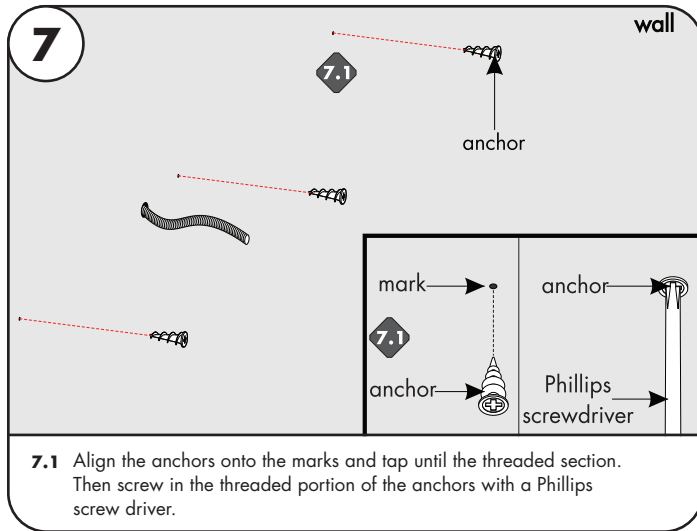

7.1 Align the anchors onto the marks and tap until the threaded section. Then screw in the threaded portion of the anchors with a Phillips screw driver.

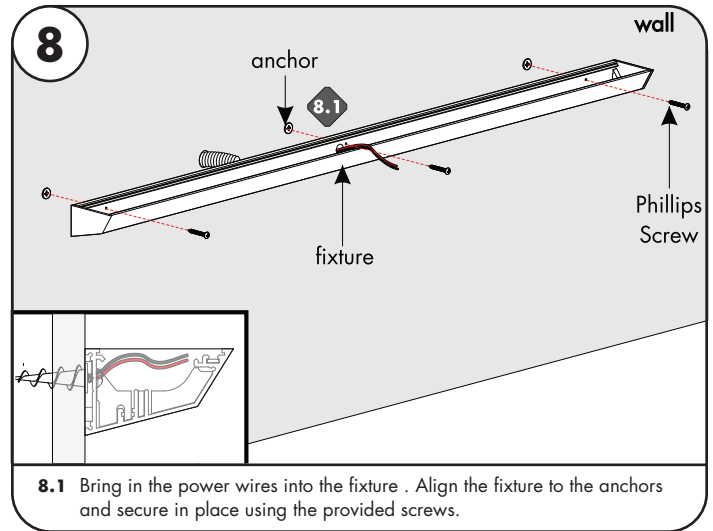

8.1 Bring in the power wires into the fixture . Align the fixture to the anchors and secure in place using the provided screws.

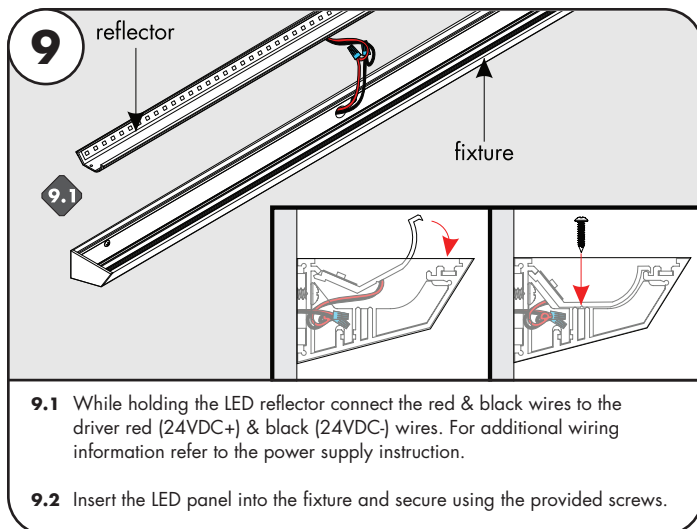

9.1 While holding the LED reflector connect the red & black wires to the driver red (24VDC+) & black (24VDC-) wires. For additional wiring information refer to the power supply instruction.

9.2 Insert the LED panel into the fixture and secure using the provided screws.

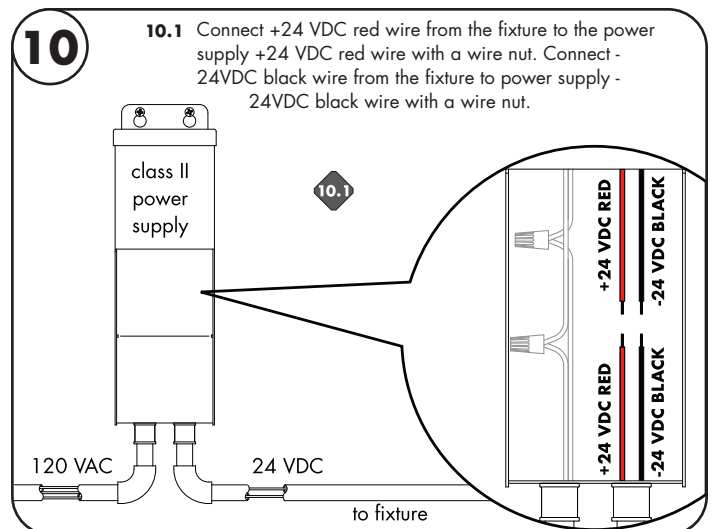

10.1 Connect +24 VDC red wire from the fixture to the power supply +24 VDC red wire with a wire nut. Connect -24VDC black wire from the fixture to power supply -24VDC black wire with a wire nut.