



Features

- Diffuse output module to support Stenos track system
- Advanced diffuser film provides even, dot-free illumination
- Optional integrated louver design
- Available with Standard and High Output, as well as four CCTs
- L90 > 50k hours
- Single bin sorted LED provides industry-best color quality
- Rotate module 180° to quickly change between Channel 1 and Channel 2
- 24VDC Class 2

Finish Options

- Black Painted
- White Painted



Profile Dimensions

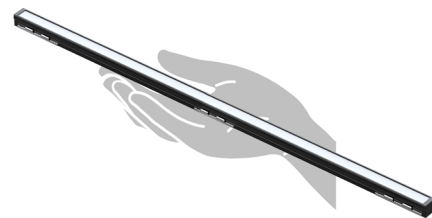
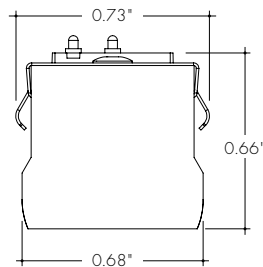
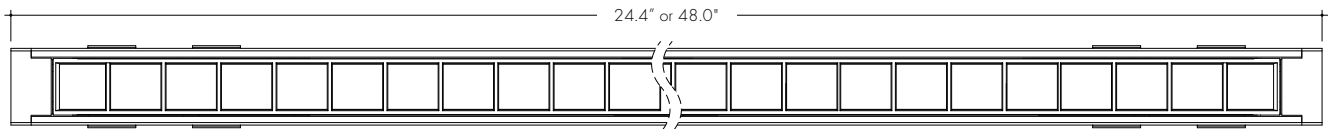
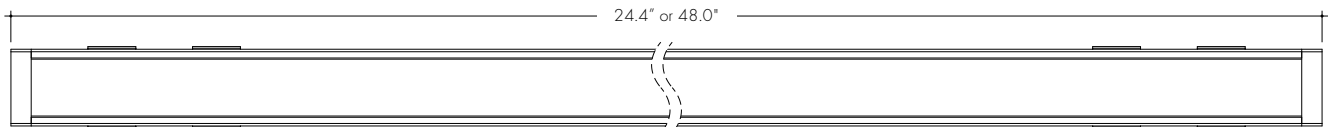

24" Ambient Module

Technical Information

TYPE	24"		48"	
	SO	HO	SO	HO
OUTPUT OPTIONS				
Lumen Output (3000K) <small>(with a Frosted Lens)</small>	475 lm	1000 lm	950 lm	2025 lm
Power Consumption	5.5 W	12.3 W	11.0 W	24.7 W
Efficacy	86 lm/W	81 lm/W	86 lm/W	82 lm/W
Transmission %	100%		60%	

CCT	Multiplier <small>(ref. - 3000K)</small>	CRI	TM-30		
			R _f	R _g	R ₉
2700K	0.94	92	90	99	58
3000K	1.00	92	89	99	57
3500K	1.02	92	89	99	60
4000K	1.02	92	86	94	71

Ordering Code | Ambient Module

MODEL	LENGTH	CCT	OUTPUT	OPTIC	FINISH
SMA-Stenos Ambient Module	24-24.4* 48-48.0*	27K-2700K 30K-3000K 35K-3500K 40K-4000K	SO-Standard HO-High	F-Frosted L-Louver ¹	BK-Black WH-White

¹ - Louvers are only available for Black Fixtures.

Ambient Modules and Louvers

Ambient Module without Louver



Ambient Module with Louver



Track Options

Ambient Module in Surface or Suspended Track

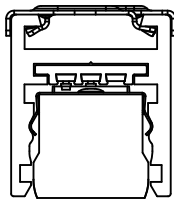

Ambient Module in Recessed Trimmed Track

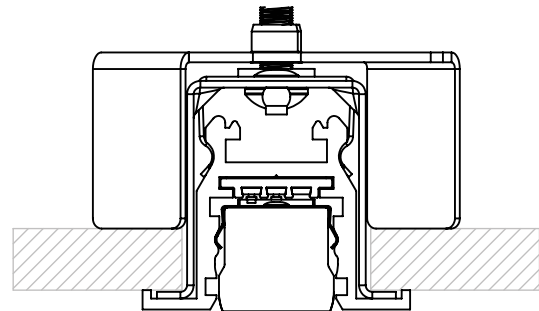

Ambient Module in Recessed Trimless Track

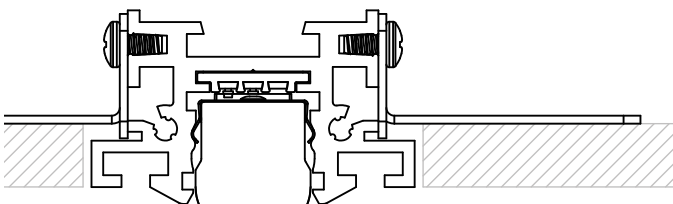

Ambient Module in Recessed Deep Trimless Track

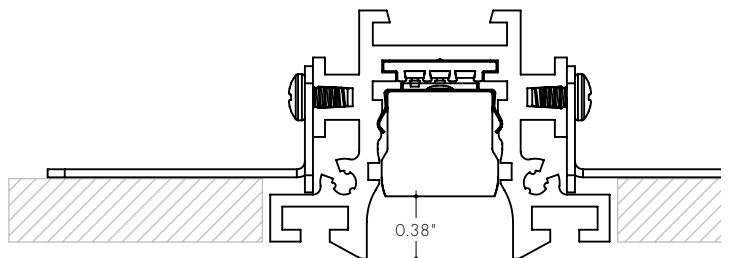

Ambient Module | Photometry

SMA-24-30K-SO-F-BK/WH

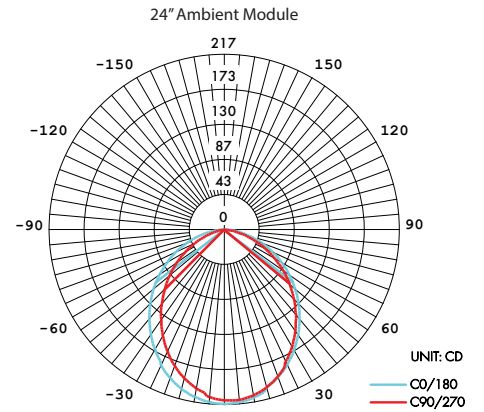

SMA-24-30K-SO-L-BK/WH

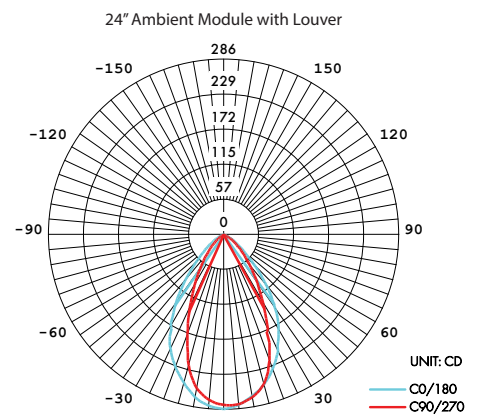

SMA-48-30K-SO-F-BK/WH

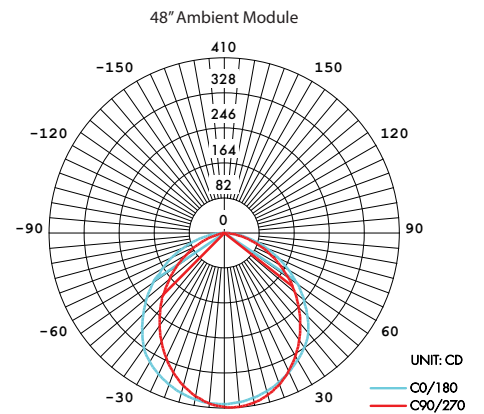

SMA-48-30K-SO-L-BK/WH

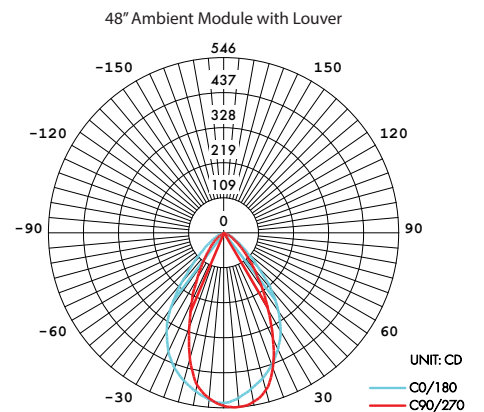
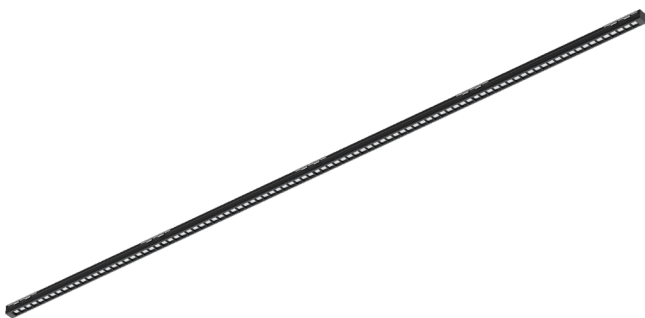

Ambient Module | TM-30-15: Data

27K CCT

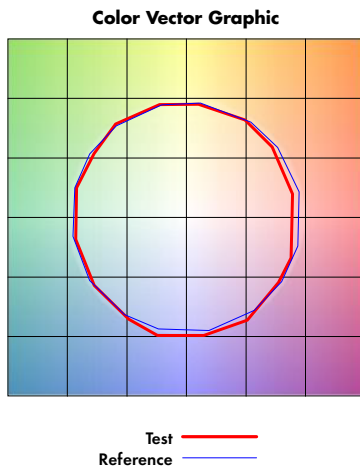

Graphic Shifts (%)			
Hue Bin	Rf	Chroma	Hue
1	88.1	-5.7%	0.5%
2	89.5	-3.8%	3.5%
3	87.4	-1.2%	5.7%
4	93.0	-1.1%	1.9%
5	94.5	0.4%	2.2%
6	95.0	1.7%	-0.8%
7	92.0	-2.7%	-2.0%
8	96.6	-1.3%	-0.2%
9	92.6	-2.3%	2.9%
10	88.3	-0.8%	6.8%
11	87.3	2.0%	8.2%
12	88.1	5.5%	0.4%
13	89.5	3.3%	-6.3%
14	85.0	4.0%	-10.2%
15	90.0	-2.2%	-4.8%
16	82.5	-3.6%	-11.5%

30K CCT

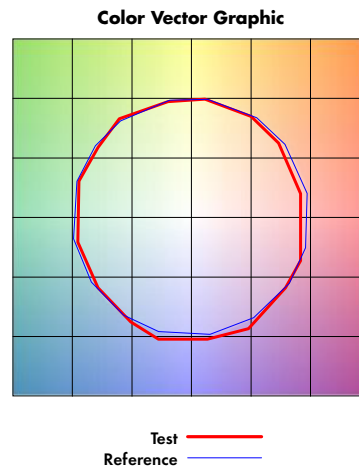

Graphic Shifts (%)			
Hue Bin	Rf	Chroma	Hue
1	88.3	-5.6%	0.1%
2	89.5	-4.0%	3.4%
3	86.6	-1.3%	6.0%
4	92.4	-0.3%	3.2%
5	93.0	-0.9%	2.2%
6	95.1	2.0%	-0.8%
7	91.9	-2.5%	-2.1%
8	96.2	-1.6%	-0.4%
9	91.9	-2.8%	3.9%
10	85.3	-1.8%	7.4%
11	84.6	1.6%	9.4%
12	88.4	6.4%	1.6%
13	91.2	3.4%	-4.2%
14	85.7	5.1%	-9.0%
15	86.8	-0.8%	-7.4%
16	83.1	-2.2%	-11.8%

35K CCT

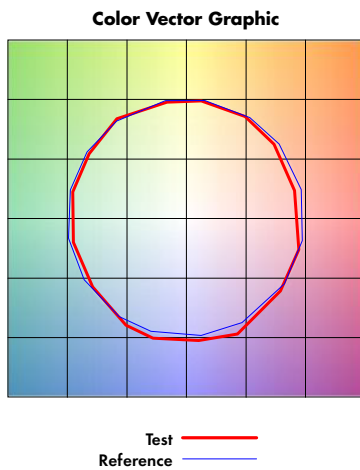

Graphic Shifts (%)			
Hue Bin	Rf	Chroma	Hue
1	88.2	-5.7%	0.1%
2	90.1	-3.8%	3.0%
3	87.1	-1.3%	5.6%
4	91.5	-0.9%	3.0%
5	92.4	-1.5%	1.9%
6	95.5	1.5%	-0.6%
7	93.2	-2.8%	-0.9%
8	94.4	-2.6%	0.9%
9	90.6	-3.0%	4.6%
10	83.8	-2.4%	9.4%
11	82.4	3.0%	10.4%
12	86.9	5.2%	3.4%
13	92.3	3.3%	-2.9%
14	86.4	5.8%	-7.8%
15	86.9	0.2%	-7.8%
16	84.6	-1.9%	-7.9%

40K CCT

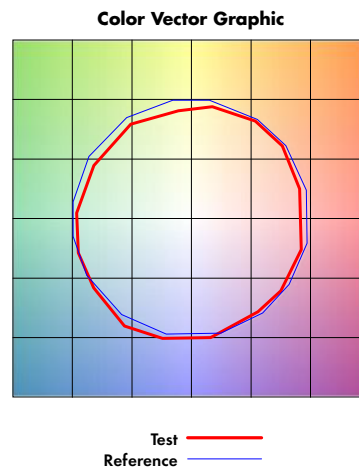

Graphic Shifts (%)			
Hue Bin	Rf	Chroma	Hue
1	85.8	-5.2%	2.3%
2	91.6	-1.8%	1.7%
3	93.7	-2.0%	0.5%
4	88.5	-4.9%	-3.5%
5	85.5	-9.3%	-2.6%
6	89.2	-6.4%	-0.1%
7	84.9	-8.0%	4.4%
8	8.6	-4.8%	8.0%
9	79.9	-1.6%	13.5%
10	79.5	1.0%	11.7%
11	84.0	6.5%	7.1%
12	89.2	4.0%	-2.9%
13	85.0	2.5%	-10.0%
14	88.5	-2.8%	-4.6%
15	80.8	-2.9%	-9.0%
16	81.5	-3.7%	-6.0%

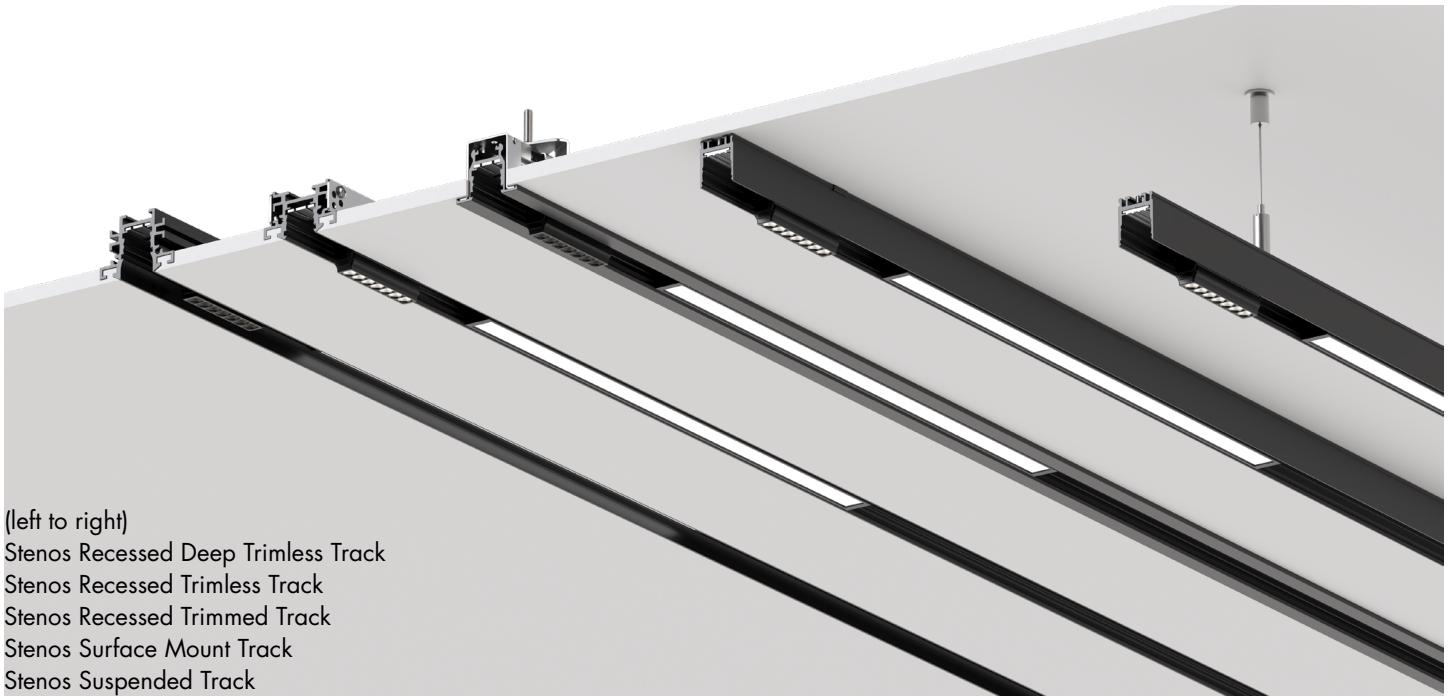

(left to right)
Stenos Recessed Deep Trimless Track
Stenos Recessed Trimless Track
Stenos Recessed Trimmed Track
Stenos Surface Mount Track
Stenos Suspended Track



Stenos Directional Module

Stenos Directional Module with Louver

Stenos Directional Module with Wall Wash

Stenos Ambient Module

Stenos Ambient Module with Louver

