

### Features

LLRGBW36 is a small profile LED strip incorporating 4 discrete emitters in each LED - red, green, blue, and 3000K white. Increased pitch provides more continuous light, while a High Output option offers incredible brightness. 36 LEDs per foot. Luminii attention to color quality provides balanced output across the color gamut, as well as true, balanced white.



#### Mounting

LED strip is equipped with 3M™ adhesive transfer tape (9472LE).

#### Applications

Indoor only - millwork, cove, architectural reveals, undercabinet, display case, handrail, accent lighting.

#### Approvals

Class 2 damp listed

#### Operating voltage

24 VDC

#### Average Life (L70)

50,000 hours

#### Warranty

7 years



### Technical Specifications

TYPE	LLRGBW36	
OUTPUT OPTIONS	SO	HO
Lumens Output (all channels full on)	212 lm/ft	351 lm/ft
Average Power Consumption (for a 4' section)	4 W/ft	7.6 W/ft
Cutting Increment (in)	1.97"	
Pitch Length	0.33"	
Efficacy	53 lm/W	46 lm/W
Max Run Length (in series)	26 ft	13 ft
Dimensions	0.39" W x 0.07" H	

#### RGBW (3000K)

Tape	CRI	TM-30		
		R <sub>f</sub>	R <sub>g</sub>	R <sub>9</sub>
LLRGBW36-SO	95	94	106	82
LLRGBW36-HO	95	93	106	84

Color	Dominant Wavelength	RGBW36SO	RGBW36HO
Red	620nm	35 lm/ft	63 lm/ft
Green	525nm	95 lm/ft	164 lm/ft
Blue	467nm	21 lm/ft	33 lm/ft
White	NA	67 lm/ft	110 lm/ft

#### Section Start/End Options

##### SL

Soldered lead wires (72")



##### NC

No connector

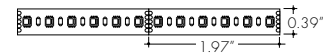

##### LF

Lead Female 3" cable

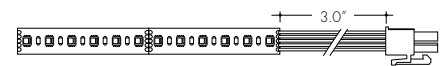

##### LM

Lead Male 3" cable

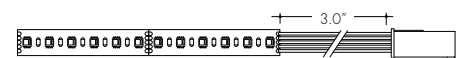

### Ordering Code

MODEL	OUTPUT	SECTION START	SECTION END	LENGTH
LLRGBW36 - Line LED LLRGBW36 Red, green, blue, and white	SO - Standard HO - High	SL - Soldered lead wires (72") LF - Female Quick Connect LM - Male Quick Connect NC - No Connector	SL - Soldered lead wires (72") LF - Female Quick Connect LM - Male Quick Connect NC - No Connector	Ordered in one foot increments. See chart above for max run length.

## Accessories

**CL1**  
Mounting clip

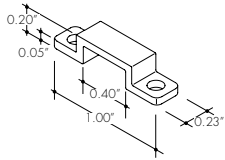

**LL.ZIP**  
Cable/Wire Strain Relief Clip

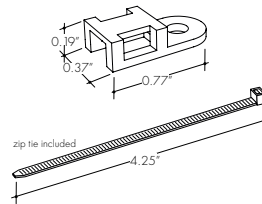

Recommended every 12" when LineLED strip is facing down

**Lens Options / Light Transmission**

<b>C</b> Clear	<b>HF</b> Half (50%) Frosted	<b>GR</b> Graze	<b>F</b> Frosted	<b>FF</b> Flat Frosted	<b>R</b> Raised	<b>S</b> Square Frosted	<b>Q</b> Round Square Frosted	<b>13°</b> 13° Semi-Frosted
<b>BOS Channel (BOSC-XX)</b> 	<b>CLA Channel (CLAC-XX)</b> 	<b>MCAL Channel (MCALC-XX)</b> 	<b>K45V Channel (K45V-XX)</b> 					
<b>F</b> 52% <b>SI</b> 66% <b>R</b> 60% <b>G</b> 76%	<b>S</b> 62% <b>Q</b> 65%	<b>C</b> 86%	<b>C</b> 82% <b>HF</b> 68% <b>F</b> 45% <b>13°</b> 76%					
<b>K45R Channel (K45R-XX)</b> 	<b>Kilo Channel (KILORC-XX)</b> 	<b>Kilo Channel (KILOC-XX)</b> 	<b>KL Channel (KLC-XX)</b> 					
<b>RF</b> 61%	<b>C</b> 85% <b>F</b> 75%	<b>C</b> 85% <b>F</b> 75%	<b>C</b> 81% <b>HF</b> 67% <b>F</b> 51%					
<b>KRL Channel (KRLC-XX)</b> 	<b>KM Channel (KMC-XX)</b> 	<b>KRM Channel (KRMC-XX)</b> 	<b>KS Channel (KSC-XX)</b> 					
<b>C</b> 81% <b>HF</b> 67% <b>F</b> 51%	<b>C</b> 82% <b>HF</b> 68% <b>F</b> 45% <b>FF</b> 52% <b>R</b> 58% <b>GR</b> 56%	<b>C</b> 82% <b>HF</b> 68% <b>F</b> 45% <b>FF</b> 52% <b>GR</b> 56%	<b>C</b> 86% <b>HF</b> 71% <b>F</b> 56% <b>FF</b> 60% <b>R</b> 64% <b>M</b> 85%					
<b>KRS Channel (KRSC-XX)</b> 	<b>KXL Channel (KXLC-XX)</b> 	<b>KRXL Channel (KRXLC-XX)</b> 	<b>RO15 Channel (RO15-XX)</b> 					
<b>C</b> 86% <b>HF</b> 71% <b>F</b> 56% <b>FF</b> 60% <b>M</b> 85%	<b>C</b> 79% <b>HF</b> 66% <b>F</b> 49%	<b>C</b> 79% <b>HF</b> 66% <b>F</b> 49%	<b>C</b> 65% <b>F</b> 41%					

**Installation**

All mounting channels are field cuttable using miter saw with circular blade suitable for cutting aluminum.

**Ordering**

Extrusions are sold separately. View respective specsheets for details on ordering extrusions and their accessories (endcaps, mounting brackets, etc).

**Led Dotting per Extrusion**

using the frosted lens option

Extrusion	LLRGBW36
KSC, KRSC	CD
KMC, KRMC, K45VC, K45RC	ND
KXLC, KRXLC	ND
KLC, KRLC	CD
RO	ND
BOSC	ND
CLAC	ND
KILOC, KILORC	ND

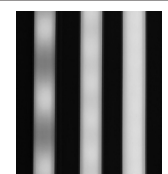

**CD SD ND**  
**CD** - Clear Dotting  
**SD** - Slight Dotting  
**ND** - No Dotting

## Power Consumption

Tested at full power with PDC Series power supplies.

LLRGBW36				
Nominal Length	SO		HO	
	W/ft	Total wattage	W/ft	Total wattage
1	4.0	4.0	7.3	7.3
2	3.6	7.3	7.2	14.5
3	3.8	11.0	7.3	21.3
4	3.9	15.1	7.4	28.8
5	3.8	18.9	7.3	35.9
6	3.9	23.5	7.4	44.8
7	3.9	27.4	7.3	51.9
8	3.8	30.8	7.2	57.2
9	3.8	34.0	6.8	61.4
10	3.9	38.6	6.9	68.7
11	3.8	41.9	6.8	74.8
12	3.8	45.5	6.6	79.2
13	3.7	48.6	6.4	83.0
14	3.7	51.8		
15	3.7	54.6		
16	3.6	58.1		
17	3.5	60.3		
18	3.5	63.6		
19	3.5	65.7		
20	3.4	68.2		
21	3.4	71.4		
22	3.3	73.1		
23	3.2	73.9		
24	3.1	75.2		
25	3.2	78.6		
26	3.1	79.5		

## Voltage Drop Calculator

The below chart assumes nominal voltage of 24 Volts and a Voltage Drop Allowance of 3% through the wire

Wattage [W]	Maximum Wire Length From Power Supply to Start of Run [ft]						
	12 AWG	14 AWG	16 AWG	18 AWG	20 AWG	22 AWG	24 AWG
<b>5</b>	1088.2	684.4	430.3	270.6	170.2	107.1	67.3
<b>10</b>	544.1	342.2	215.1	135.3	85.1	53.5	33.7
<b>15</b>	362.7	228.1	143.4	90.2	56.7	35.7	22.4
<b>20</b>	272.0	171.1	107.6	67.7	42.6	26.8	16.8
<b>25</b>	217.6	136.9	86.1	54.1	34.0	21.4	13.5
<b>30</b>	181.4	114.1	71.7	45.1	28.4	17.8	11.2
<b>35</b>	155.5	97.8	61.5	38.7	24.3	15.3	9.6
<b>40</b>	136.0	85.5	53.8	33.8	21.3	13.4	8.4
<b>45</b>	120.9	76.0	47.8	30.1	18.9	11.9	7.5
<b>50</b>	108.8	68.4	43.0	27.1	17.0	10.7	6.7
<b>55</b>	98.9	62.2	39.1	24.6	15.5	9.7	6.1
<b>60</b>	90.7	57.0	35.9	22.6	14.2	8.9	5.6
<b>65</b>	83.7	52.6	33.1	20.8	13.1	8.2	5.2
<b>70</b>	77.7	48.9	30.7	19.3	12.2	7.6	4.8
<b>75</b>	72.5	45.6	28.7	18.0	11.3	7.1	4.5
<b>80</b>	68.0	42.8	26.9	16.9	10.6	6.7	4.2
<b>85</b>	64.0	40.3	25.3	15.9	10.0	6.3	4.0
<b>90</b>	60.5	38.0	23.9	15.0	9.5	5.9	3.7
<b>96</b>	56.7	35.6	22.4	14.1	8.9	5.6	3.5

## Power Supplies

See fixture and power supply instructions & spec sheet for wiring information. Dimming possible in select models - view luminii website for list of compatible dimmers.

### Ordering Code DMX Dimming Power Supplies 0.1% 120VAC - 277VAC Requires Controller

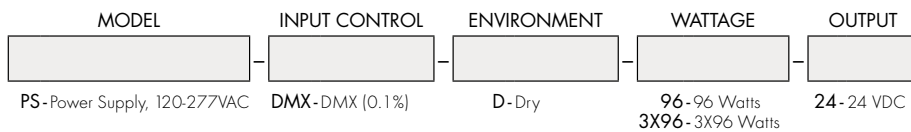

MODELS	96W	3X96
<b>Length</b>	14.40"	15.00"
<b>Width</b>	5.20"	6.62"
<b>Depth</b>	2.60"	4.56"

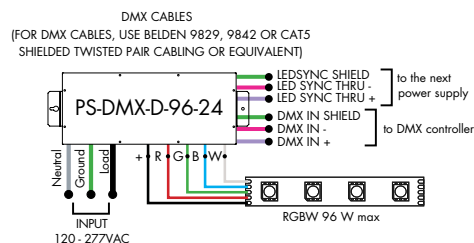
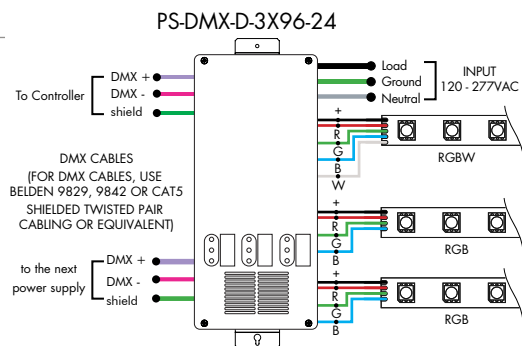

### Ordering Code Non-Dimming Power Supply 120VAC - 277VAC Requires Controller and Decoder

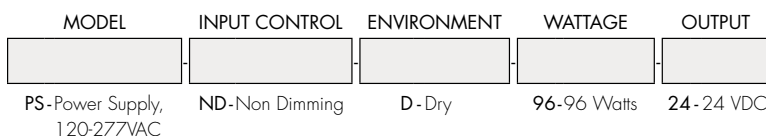

MODELS	96W
<b>Length</b>	14.40"
<b>Width</b>	5.20"
<b>Depth</b>	2.60"

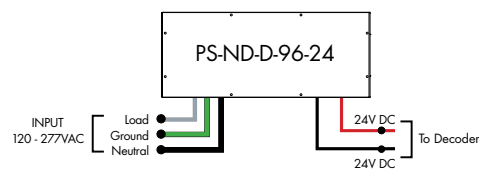

### Ordering Code Universal Dimming Power Supplies 1% 120VAC - 277VAC Requires Controller and Decoder

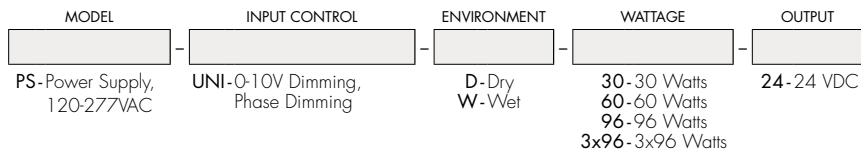

Compatibility: View a complete list of compatible dimmers on product page [\(Link\)](#) 0-10V - 1% dimming  
 MLV/ELV/TRIAC - 1% dimming, consult dimming compatibility chart

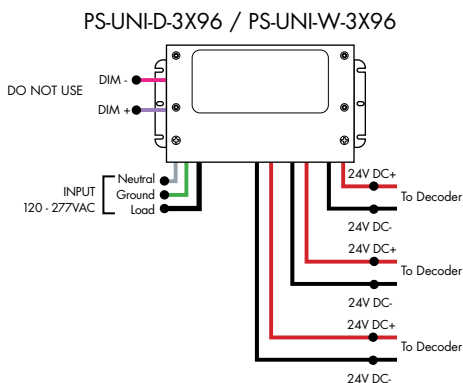
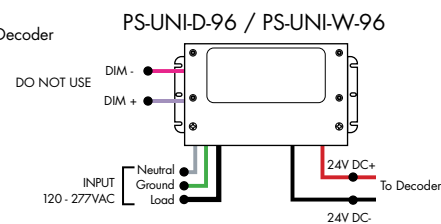

MODELS	PS-UNI-W-30W	PS-UNI-W-60W	PS-UNI-W-96W	PS-UNI-W-3X96W
<b>Length</b>	6.50"	7.40"	8.66"	11.85"
<b>Width</b>	3.73"	3.73"	3.73"	4.32"
<b>Depth</b>	1.61"	1.61"	1.61"	1.81"

MODELS	PS-UNI-D-30W	PS-UNI-D-60W	PS-UNI-D-96W	PS-UNI-D-3X96W
<b>Length</b>	8.77"	8.77"	8.11"	9.94"
<b>Width</b>	4.27"	4.27"	5.60"	7.61"
<b>Depth</b>	1.83"	1.83"	1.83"	2.02"

## Controllers and Decoders



MODEL

**RGBW-RC-R**

RGBW-RC-R - RGBW receiver

The RGBW receiver is easily paired with controller by the click of a button. Receiver can be reset to factory settings at any time.

Each receiver can store one static RGB color, one color sequence, and one brightness setting for the white LED strip. Receivers assigned to the same scene within the same zone will have the same LED static color and color sequence.

**Operating Voltage**  
12-36 VDC

**Power Capacity**  
up to 96W at 24V

**Operating Temperature Range**  
from -4°F to +122°F in case



MODEL

**RGBW-SR**

RGBW-SR - RGBW signal repeater

Extends identical signal when connected in series to an RGBW LED control system. The RGBW signal repeater works with Luminii RGB and RGBW controllers, receivers, and decoders.

RGBW signal can be extended indefinitely when adequate power supply (not included) is connected to the system.

**Operating Voltage**  
12-36 VDC

**Power Capacity**  
up to 96W at 24V

**Operating Temperature Range**  
from -4°F to +122°F in case



MODEL

**DDMX-RGBW**

DDMX-RGBW - DMX decoder

Translates controller DMX512 programs for RGB and white LED strips.

Unique DMX address for the decoder can be set easily and displayed by the numeric display on the case. Changing and resetting the DMX address requires manual input.

Use power repeater to expand output.

**Operating Voltage**  
12-36 VDC

**Power Capacity**  
up to 96W at 24V

**Operating Temperature Range**  
from -4°F to +122°F in case

**Controllers and Decoders**



MODEL

**RGBW-MC3**

RGBW-MC3-4-zone RGBW controller

Easy to operate wireless interface suitable for static or color changing scenes. Control 4 different color zones separately or at the same time. RGBW receiver (RGBW-RC-R) required for operation. Assign multiple receivers per zone to cover a large area.

Color wheel enables highly stable and sensitive color control functionality. Create your own color changing sequences with ease and flexibility.

**Power**

qty 3 AAA batteries

**Scenes**

up to 4 unique zones

**Signal**

Wireless (RF)

**Energy Saving**

Deactivates after 10 seconds of inactivity

**Color Parameters**

- Brightness
- Saturation
- Primary colors
- Speed of color changing sequence
- Fading

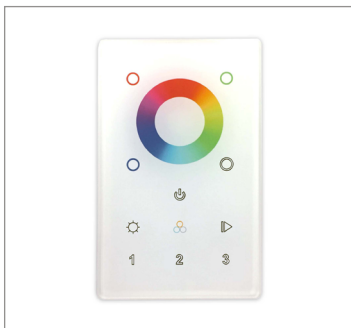

MODEL

ZONES

COLOR

DMX - DMX Controller	3Z - Three Zone 1Z - One Zone	RGBW - Red, Green, Blue, & White
----------------------	----------------------------------	----------------------------------

DMX /Wireless RGB-W wall-mount controller controls DMX lighting fixtures, wireless control of RGB-W lighting fixture or use both simultaneously. Fits in any standard US switch box. Includes all the outputs in the back of the controller.

Control brightness levels with a single touch, personalize and memorize 3 different scenes, and even create 3 variations of white.

**Features**

- 2 in 1 in-Wall Controller: DMX Control or Wireless RGB-W
- 65,000 Color Options, Dimming and Speed Control
- Memory Function
- 50 Foot Wireless Range
- Easily Fits Standard US Switch Boxes
- Touch Sensitive Glass Surface
- Includes 10 Built in Programs, or Create and Play Your Own

**Operating Voltage**

12 - 24V DC

**Color Parameters**

- Brightness
- Saturation
- Primary colors
- Fading
- Color changing speed

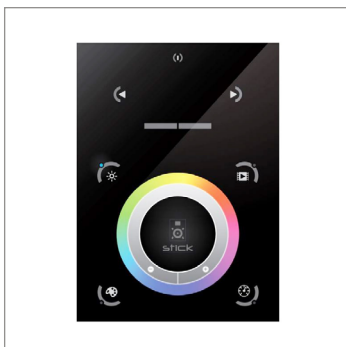

MODEL

**TSDMX-E**

TSDMX-E - Touchscreen DMX controller

Programmable advanced DMX512 lighting controller featuring a touch-screen interface. Operates as stand alone controller or integrated with most architectural lighting control systems. Can controller endless DMX512 enabled devices.

Mounts to standard single or dual gang wall box with the included power supply inside the junction box. Terminal block design for power and data connections.

**Features**

- Sleek glass design which sits 0.43" from the wall
- Graphical color display to show selected environment
- Color/dimmer/speed palette
- Color temperature mixing
- Touch sensitive buttons. No mechanical parts
- Touch sensitive wheel allows for accurate color selection
- Multi-zone microSD memory
- Multi-room control with 500 scenes, 10 zones
- 1024 DMX channels. Control 340 RGB fixtures
- USB & Ethernet connectivity for programming and control

**Power Supply**

7 VDC (included)

**Programmability**

PC, Mac, Tablet, Smartphone

**Output Signal**

DMX512 (1024 channels)

**Color Parameters**

- Brightness
- Saturation
- Speed of color changing sequence
- Fading / dimming / brightness



## Controllers and Decoders



MODEL

**DDMX-5CH-RDM-PRO**

DDMX-5CH-RDM-PRO-DMX512 Decoder

DMX512 decoder with RDM functionality features 5 PWM output channels with common anode. High PWM output frequency range allows the product to be used in HD video conferencing spaces. All DMX products to be installed per DMX512 Standard.

**Power**  
96 Watt

**Inputs**  
RJ45, XLR-5Pin, Terminal Block

**DMX Channels**  
1 to 5 settable

**PWM Output Resolution Ratio**  
8 or 16 bit

**PWM Output Frequency**  
500Hz - 30KHz

**Output Dimming Curve Gamma Value**  
0.1 ~ 9.9



MODEL

**RGBW-WI-R**

RGBW-WI-R - WIFI generator

RGBW-WI-R creates a local network that enables any electronic device (phone, tablet, etc.) to control the RGB/W strip connected to a RGBW-RC-R receiver.

The control functions are achieved through a free application download for Android and iOS devices called REALCOLOR.

**Operating Voltage**  
12-36 VDC

**Power Supply**  
PI-130-24 (included)

**Operating Temperature Range**  
from -4°F to +122°F in case