

**Features**

Kurba Medium Domed is a dot free direct view, narrow profile, energy efficient and flexible LED strip suitable for outdoor wet locations capable of horizontal/side bends with a 2.5" bending radius. The silicone material offers excellent heat, weather, UV, and solvent resistance and has a special coating to repel dust and dirt accumulation.

**Applications**

Indoor/Outdoor dry & wet location

**Materials**

Silicone for red list approved, as well as heat, weather, UV, and solvent resistance

**Dimming**

Dot Free even illumination. Unique Domed lens for wide view angle. Dimable down to 1%

**Average Life (L70)**

50,000 Hours

**Approvals**

24VDC Class 2 wet listed, IP68

**Warranty**

3 years

**Finish Options** (see page 2 for additional information)

**Base**  White

**Premium**  Black  Red  Green  Blue



**Technical Information**

Bending Direction	Horizontal
Output	2250
Light Output at 3000K	158 lm/ft
Average Power Consumption at 4'	3.66 W/ft
Efficacy	43 lm/W
Ordering Increment	3.28"
Maximum Run Length (In Series)	26'
Operating Temperature Range	-40°F to 131°F

CCT INFO / LUMEN MULTIPLIER	
Color Temperature	Multiplier (ref. -3000K)
2200K	0.80
2400K	0.90
2700K	1.00
3000K	1.00
3500K	1.00
4000K	1.00

Note: 80 CRI

**Constraints**

**Horizontal Bend Direction**

Bend LED in these positions only to avoid damage

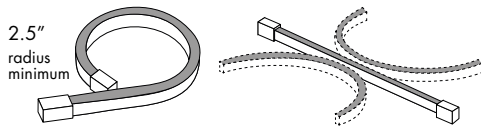

Illuminated surface shown in gray

**Horizontal Prohibited Bends**

Twisting or bending LED in these positions will cause damage

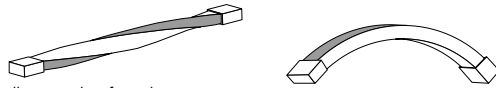

Illuminated surface shown in gray

Do not make sharp bends near the endcap

**Ordering Code**

MODEL	RATING	BEND DIRECTION	LENGTH	OUTPUT <sup>1</sup>	CCT	LENS	MOUNTING	FINISH <sup>2</sup>	FEED POSITION LEFT	FEED POSITION RIGHT
KBM-Kurba Medium	W-Wet	HB-Horizontal Bending	SEE PCC CHART ON PAGE 6	2250-Standard	22K-2200K 24K-2400K 27K-2700K 30K-3000K 35K-3500K 40K-4000K	DSF-Domed Lens	NA-See Page 4 for orderable mounting accessories	WH-White BK-Black RED-Red GRN-Green BLU-Blue	INJECTION MOLD IME-End Feed 1 IMB-Back Feed 1 IMSA-Side 1 Feed NPF-No Power Feed <sup>3</sup>	INJECTION MOLD IME-End Feed 1 IMB-Back Feed 1 IMSA-Side 1 Feed NPF-No Power Feed <sup>3</sup>

Feeds come with 118" wire leads

1 - Title 24 JA8 compliance achievable, contact factory for specific requests  
2 - Red, Green, and Blue finishes have an MOQ of 350ft

3 - NPF-NPF for Feed Position 1&2 is not a valid configuration option

## Powerfeeds and Connectors

### Power Feed Position Options and Orientation

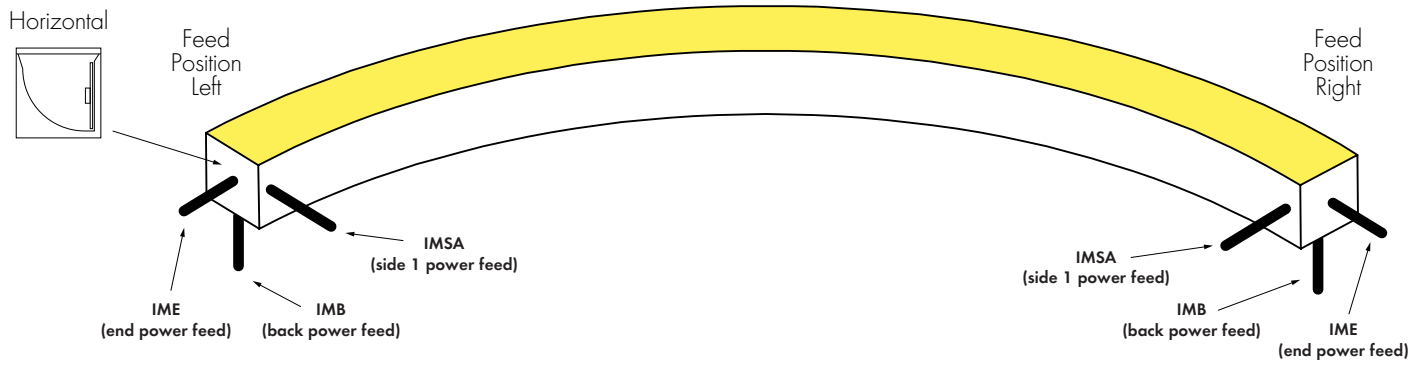

### Linking and Extension Cable Options

#### END CONNECTOR

Injection-molded End Connector  
-IME

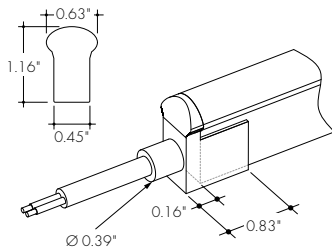

#### BACK CONNECTOR

Injection-molded Back Connector  
-IMB

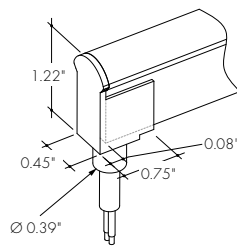

#### SIDE CONNECTOR

Injection-molded Side Connector  
-IMSA

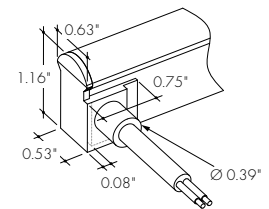

#### ENDCAP (NO CONNECTOR)

Injection-molded Cap (No Connector)  
-NPF

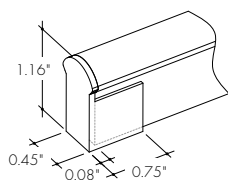

#### ANTI-WICKING FERRULE

Included on every power feed wire

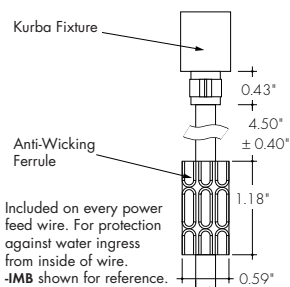

**Product Dimensions**

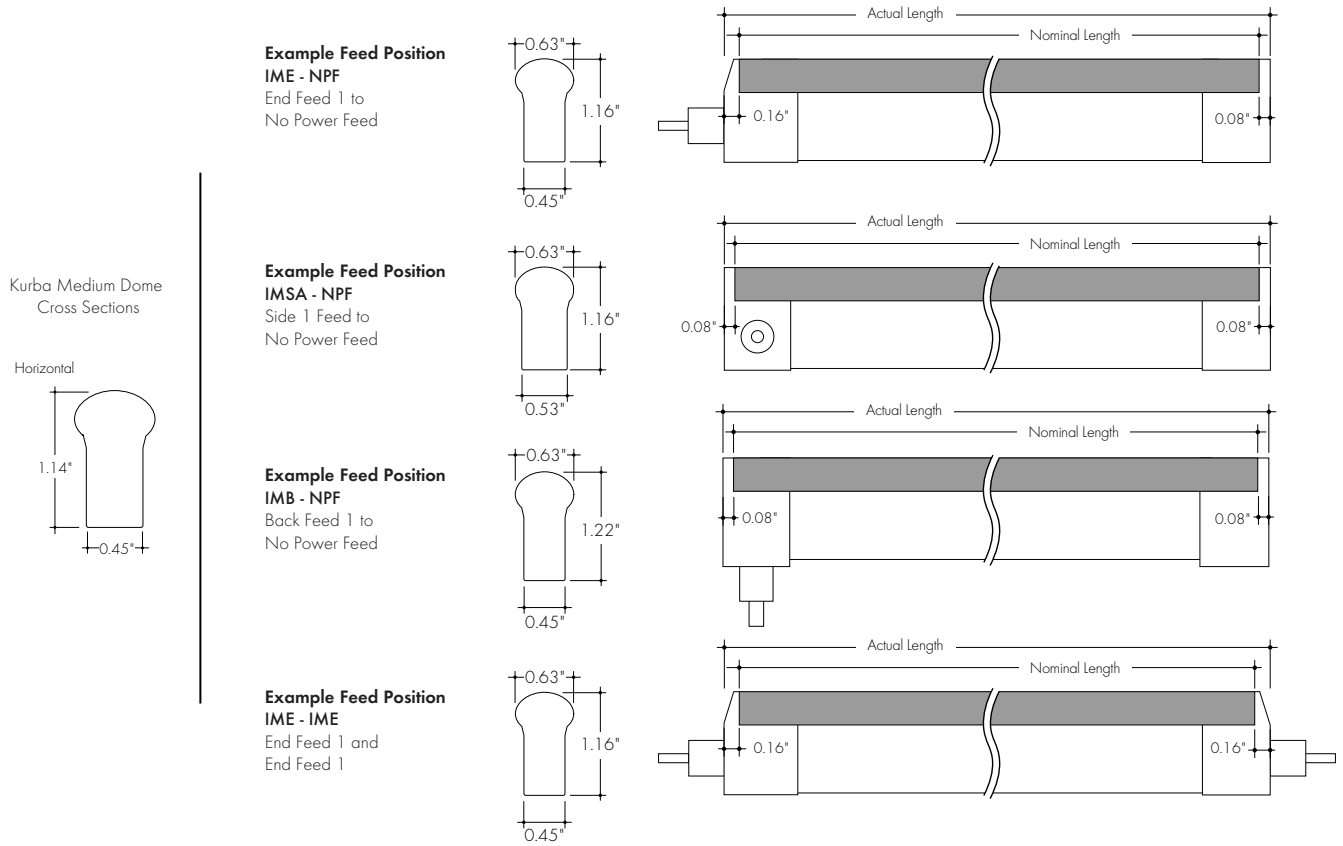

**Finish Options**

- A wide variety of finish options allowing complete customization of style and aesthetic.
- Red, Green, and Blue finishes have an minimum order quantity of 350ft

**White Base**

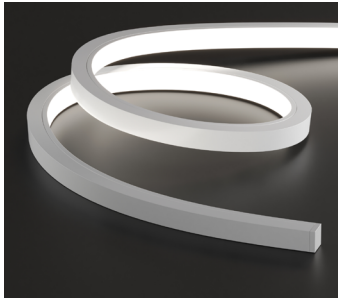

Kurba's base finish is a crisp white which brings a timeless, clean aesthetic that brightens and enhances any space

**Black Finish w/ Black Lens Premium**



Also available with a blackout aesthetic - the Black Lens paired with the Black Finish provides for a sleek, all black profile that keeps the strip concealed in the off-state.

**Red Premium**

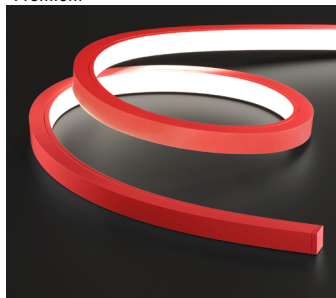

Red adds a bright and bold statement, perfect for creating a striking and dynamic ambiance with its vibrancy

**Green Premium**

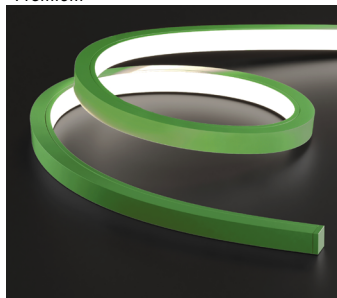

Green embraces a refreshing and natural feel, reminiscent of emerald green, add touch of tranquility and harmony to your space with this option

**Blue Premium**

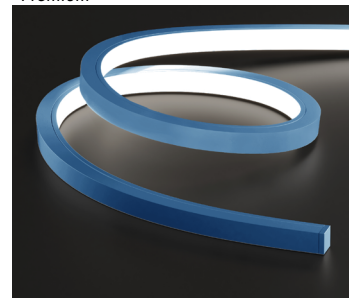

Blue evokes the serenity of the deep sea by combining vivid cobalt and azure tones.

**Light Transmission and Dotting**

Output Options	Lens/Accessory	
	Domed Lens/ White Finish	Domed Lens/ White, Black, Red, Green, Blue Finish
22SO	ND	ND
<b>Transmission Percentage</b>	100%	80%

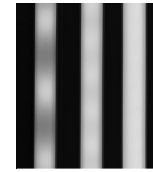

**CD SD ND**  
**CD** - Clear Dotting  
**SD** - Slight Dotting  
**ND** - No Dotting

**Mounting Accessories & Optional Connectors**

**MC-KBM-SAP-SM-0.8-SA**

KBM Mounting Channel, Serrated Aluminum Profile, Surface Mount, 0.8in, Silver Anodized

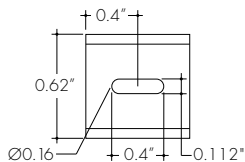
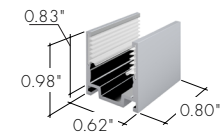

For use with light strip mounted to the ceiling.  
 1 recommended every 8 in.

**MC-KBM-SAP-SM-78-SA**

KBM Mounting Channel, Serrated Aluminum Profile, Surface Mount, 78in, Silver Anodized

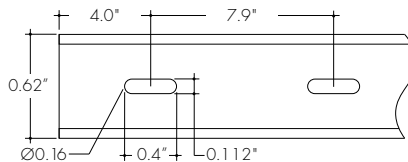
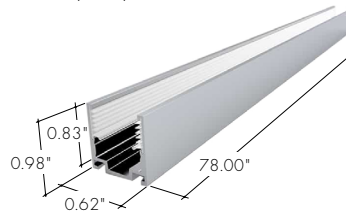

For use with light strip mounted to the ceiling.

**MC-KBM-FSAP-TR-78-SA**

KBM Mounting Channel, Flanged Serrated Aluminum Profile, Trimmed Recessed Mount, 78in, Silver Anodized

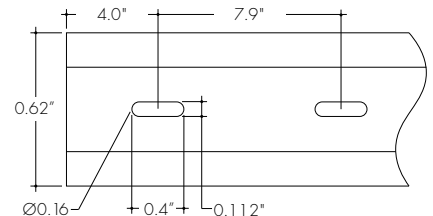
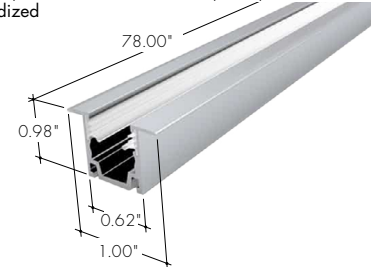

Flanged aluminum mounting channel providing grip.  
 For use with light strip recessed into the ceiling.

**MC-KBM-BSAP-HB-SM-38-SA**

KBM Mounting Channel, Bendable Serrated Aluminum Profile, Horizontal Bending, Surface Mount, 38in, Silver Anodized

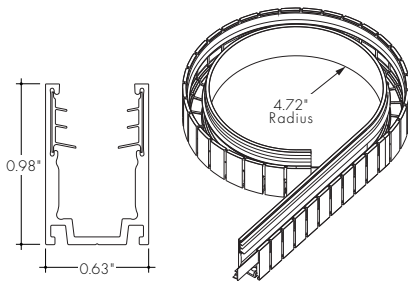

Bendable stainless steel mounting channel providing grip.  
 For use with light strip mounted to the ceiling.  
**NOTE:** Compatible with IMB - Back Feed only

**MC-KBM-RCWY-SM-78-SA**

KBM Mounting Channel, Raceway, Surface Mount, 78in, Silver Anodized

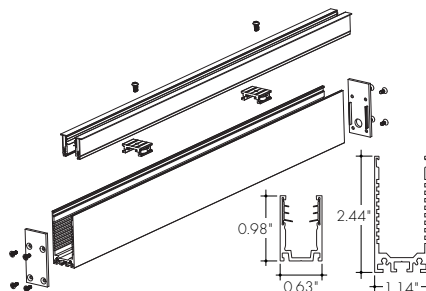

Raceway channel allows for hidden cable management and is a superb option where tidiness is required.  
**NOTE:** Compatible with IMB - Back Feed only

**LVSP-WET**

Splice box: wet rated, low voltage, gray

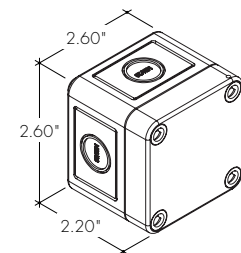

**LVSP-WET-CM**

Connector for splice box, low voltage for cable management, gray

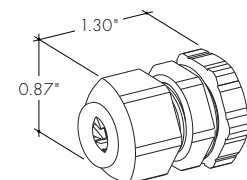

Mounting Accessories and Optional Connectors

Photometry

KBM-W-HB-48-22SO-30K-DSF-NA-WH

Kurba Medium, Horizontal Bend, 4ft, 3000K, 22SO, Domed Silicone Frosted Lens

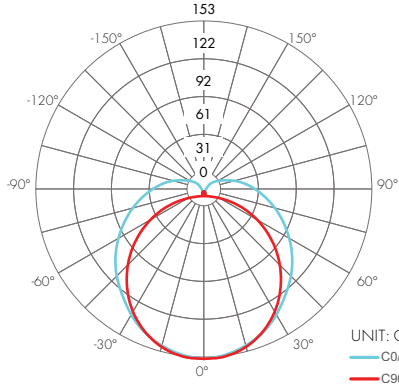

Zonal Lumen Summary 3000K

Zone	Lumen	% Fixture
0-30	114	18.1%
0-40	158	25.0%
0-60	347	54.9%
0-90	519	82.2%
<b>Total</b>	<b>632</b>	<b>100.0%</b>

Beam Angle



## 2250 | Power Consumption Per Fixture Length

Based on operation with PDCU series of power supplies. Use Actual Length for Order Code Entry.  
 Tolerance for Actual Lengths less than 6 ft is +/- 0.2", Actual Lengths between 6 ft and 16 ft is +/- 0.3", and Actual Lengths greater than 16 ft is +/- 0.6"  
**A** - End Connector at both ends of Kurba (0.16" + 0.16" added to overall length)  
**B** - End Connector at one end of Kurba and No Connector or Back Connector or Side Connector at other end of Kurba (0.16" + 0.08" added to overall length)  
**C** - Any combination of No Connector, Back Connector, or Side Connector on each end of Kurba (0.08" + 0.08" added to overall length)

Nominal Length (in)	Actual Length (in)				Nominal Length (in)	Actual Length (in)				Nominal Length (in)	Actual Length (in)			
	W	A	B	C		W	A	B	C		W	A	B	C
7	2.1	6.9	6.8	6.7	125	38.1	125.0	124.9	124.8	243	74.1	243.1	243.0	242.9
10	3.1	10.2	10.1	10.0	128	39.1	128.3	128.2	128.1	246	75.1	246.4	246.3	246.2
(1 ft) 14	4.1	13.4	13.4	13.3	(11 ft) 132	40.1	131.5	131.5	131.4	250	76.1	249.7	249.6	249.5
17	5.1	16.7	16.6	16.6	135	41.1	134.8	134.7	134.7	(21 ft) 253	77.1	252.9	252.9	252.8
20	6.1	20.0	19.9	19.8	138	42.1	138.1	138.0	137.9	256	78.1	256.2	256.1	256.1
(2 ft) 23	7.1	23.3	23.2	23.1	141	43.1	141.4	141.3	141.2	260	79.1	259.5	259.4	259.3
27	8.1	26.6	26.5	26.4	(12 ft) 145	44.1	144.7	144.6	144.5	(22 ft) 263	80.1	262.8	262.7	262.6
30	9.1	29.8	29.8	29.7	148	45.1	148.0	147.9	147.8	266	81.1	266.1	266.0	265.9
33	10.1	33.1	33.0	33.0	151	46.1	151.2	151.2	151.1	269	82.1	269.3	269.3	269.2
(3 ft) 36	11.1	36.4	36.3	36.2	(13 ft) 155	47.1	154.5	154.4	154.4	273	83.1	272.6	272.5	272.5
40	12.1	39.7	39.6	39.5	158	48.1	157.8	157.7	157.6	(23 ft) 276	84.1	275.9	275.8	275.7
43	13.1	43.0	42.9	42.8	161	49.1	161.1	161.0	160.9	279	85.1	279.2	279.1	279.0
46	14.1	46.2	46.2	46.1	164	50.1	164.4	164.3	164.2	282	86.1	282.5	282.4	282.3
(4 ft) 50	15.1	49.5	49.5	49.4	(14 ft) 168	51.1	167.6	167.6	167.5	286	87.1	285.7	285.7	285.6
53	16.1	52.8	52.7	52.7	171	52.1	170.9	170.8	170.8	(24 ft) 289	88.1	289.0	288.9	288.9
56	17.1	56.1	56.0	55.9	174	53.1	174.2	174.1	174.0	292	89.1	292.3	292.2	292.1
(5 ft) 59	18.1	59.4	59.3	59.2	178	54.1	177.5	177.4	177.3	296	90.1	295.6	295.5	295.4
63	19.1	62.7	62.6	62.5	(15 ft) 181	55.1	180.8	180.7	180.6	(25 ft) 299	91.1	298.9	298.8	298.7
66	20.1	65.9	65.9	65.8	184	56.1	184.0	184.0	183.9	302	92.1	302.1	302.1	302.0
69	21.1	69.2	69.1	69.1	187	57.1	187.3	187.2	187.2	305	93.1	305.4	305.3	305.3
(6 ft) 73	22.1	72.5	72.4	72.3	(16 ft) 191	58.1	190.6	190.5	190.4	309	94.1	308.7	308.6	308.5
76	23.1	75.8	75.7	75.6	194	59.1	193.9	193.8	193.7	(26 ft) 312	95.1	312.0	311.9	311.8
79	24.1	79.1	79.0	78.9	197	60.1	197.2	197.1	197.0					
(7 ft) 82	25.1	82.3	82.3	82.2	200	61.1	200.4	200.4	200.3					
86	26.1	85.6	85.5	85.5	(17 ft) 204	62.1	203.7	203.6	203.6					
89	27.1	88.9	88.8	88.7	207	63.1	207.0	206.9	206.8					
92	28.1	92.2	92.1	92.0	210	64.1	210.3	210.2	210.1					
(8 ft) 96	29.1	95.5	95.4	95.3	214	65.1	213.6	213.5	213.4					
99	30.1	98.7	98.7	98.6	(18 ft) 217	66.1	216.8	216.8	216.7					
102	31.1	102.0	101.9	101.9	220	67.1	220.1	220.0	220.0					
105	32.1	105.3	105.2	105.1	223	68.1	223.4	223.3	223.2					
(9 ft) 109	33.1	108.6	108.5	108.4	(19 ft) 227	69.1	226.7	226.6	226.5					
112	34.1	111.9	111.8	111.7	230	70.1	230.0	229.9	229.8					
115	35.1	115.1	115.1	115.0	233	71.1	233.3	233.2	233.1					
(10 ft) 118	36.1	118.4	118.3	118.3	237	72.1	236.5	236.5	236.4					
122	37.1	121.7	121.6	121.5	(20 ft) 240	73.1	239.8	239.7	239.7					

Note: all values are rounded to the nearest 0.1 inch

Endcap (No Connector) -NPF

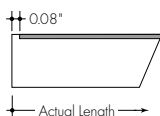

End Connector -IME

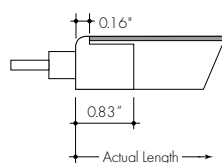

Back Connector -IMB

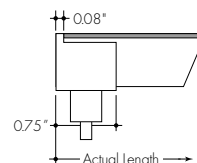

Side Connector -IMSA and -IMSB

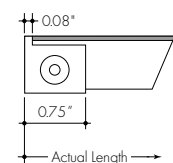

## Power Supplies

See Power Supply instructions and spec sheet for wiring information. For a complete list of compatible dimmers, see Compatible Dimming Chart on the Resources page.

### For use with Static White

#### Ordering Code Universal Dimming Power Supplies 1% 120VAC - 277VAC

MODEL	INPUT CONTROL	ENVIRONMENT	WATTAGE	OUTPUT
PS-Power Supply, 120-277VAC	UNI-0-10V Dimming, Phase Dimming	D-Dry W-Wet	30-30 Watts 60-60 Watts 96-96 Watts 3x96-3x96 Watts	24-24 VDC

Compatibility: View a complete list of compatible dimmers on product page [\(Link\)](#)

0-10V - 1% dimming  
MLV/ELV/TRIAC - 1% dimming, consult dimming compatibility chart

MODELS	PS-UNI-W-30W	PS-UNI-W-60W	PS-UNI-W-96W	PS-UNI-W-3X96W
<b>Length</b>	6.50"	7.40"	8.66"	11.85"
<b>Width</b>	3.73"	3.73"	3.73"	4.32"
<b>Depth</b>	1.61"	1.61"	1.61"	1.81"

MODELS	PS-UNI-D-30W	PS-UNI-D-60W	PS-UNI-D-96W	PS-UNI-D-3X96W
<b>Length</b>	8.77"	8.77"	8.11"	9.94"
<b>Width</b>	4.27"	4.27"	5.60"	7.61"
<b>Depth</b>	1.83"	1.83"	1.83"	2.02"

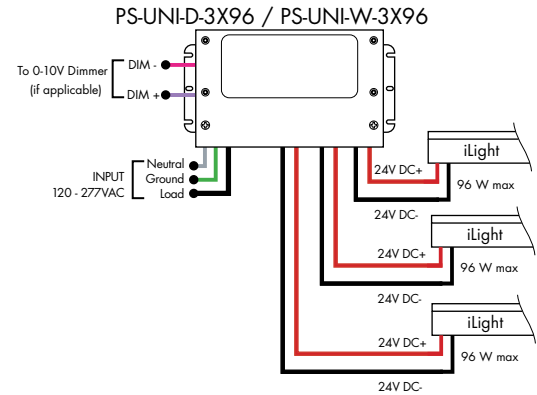
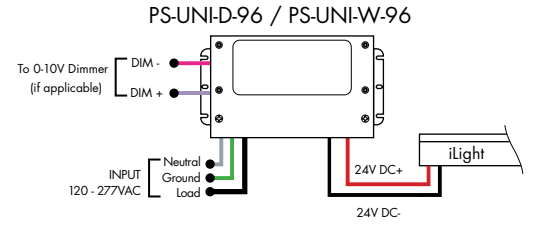

### For use with Static White

#### 0-10V Dimming Power Supplies 0.1% 120VAC - 277VAC

MODEL	POWER	OUTPUT	INPUT CONTROL	ENVIRONMENT
PS-Power Supply, 120-277VAC	96-96 Watts 3x96-3x96 Watts	24-24 VDC	010V-LIN-0-10V Dimming (0.1%), Linear 010V-LOG-0-10V Dimming (0.1%), Logarithmic	D-Dry

MODELS	96W	3X96
<b>Length</b>	14.40"	15.00"
<b>Width</b>	5.20"	6.62"
<b>Depth</b>	2.60"	4.45"

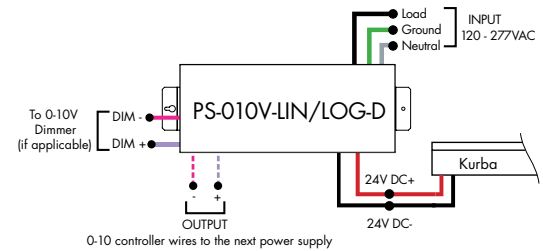
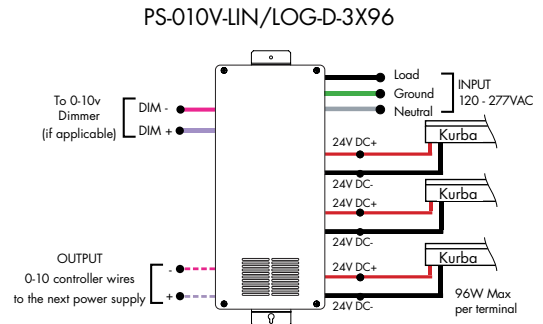

## Power Supplies

See Power Supply instructions and spec sheet for wiring information. For a complete list of compatible dimmers, see Compatible Dimming Chart on the Resources page.

### For use with Static White

#### Athena 0-10V LED Driver

MODEL	INPUT CONTROL	ENVIRONMENT	WATTAGE	OUTPUT	FEATURE
PS-Power Supply, 120-277VAC	010V-LIN-0-10V Dimming (0.1%), Linear 010V-LOG-0-10V Dimming (0.1%), Logarithmic	D-Dry	96-96 Watts	24-24 VDC	AWN-R-Athena

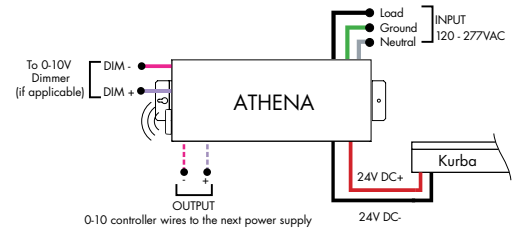

MODELS	96W
Length	14.40"
Width	5.20"
Depth	2.60"

### For use with Static White

#### Ordering Code Phase Dimming Power Supply 1% 120VAC - 277VAC

MODEL	INPUT CONTROL	ENVIRONMENT	WATTAGE	OUTPUT	OUTPUT CONTROL
PS-Power Supply, 120-277VAC	PH-Phase Dimming (Triac, ELV, MLV)	D-Dry	96-96 Watts	24-24 VDC	DC-Direct Current

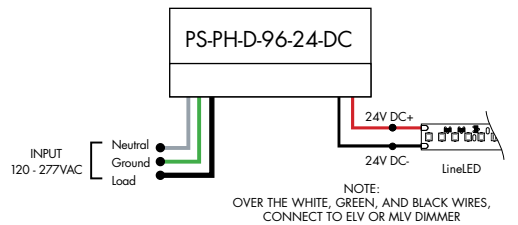

MLV/ELV/TRIAC - 1% dimming, consult dimming compatibility chart ([link](#))

MODELS	96W
Length	8.25"
Width	4.10"
Depth	1.56"

### For use with Static White

#### DALI Dimming Power Supplies 0.1% 120VAC - 277VAC

MODEL	INPUT CONTROL	ENVIRONMENT	WATTAGE	OUTPUT
PS-Power Supply, 120-277VAC	DALI-DALI (0.1%)	D-Dry	96-96 Watts 3x96-3x96 Watts	24-24 VDC

Model	96W	3X96
Length	14.40"	15.00"
Width	5.20"	6.62"
Depth	2.60"	4.56"

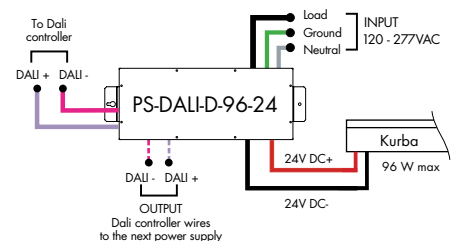
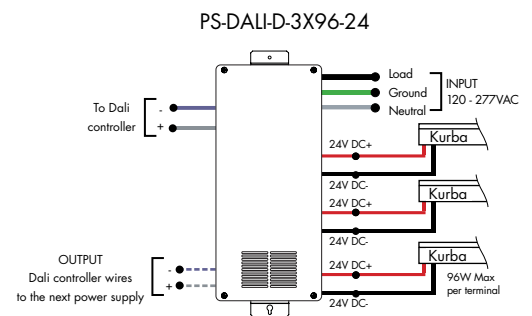



## Power Supplies

See Power Supply instructions and spec sheet for wiring information. For a complete list of compatible dimmers, see Compatible Dimming Chart on the Resources page.

### For use with Static White

#### Athena 0-10V LED Driver

MODEL	INPUT CONTROL	ENVIRONMENT	WATTAGE	OUTPUT	FEATURE
PS-Power Supply, 120-277VAC	010V-0-10V Dimming (1%)	D-Dry	96-96 Watts	24-24 VDC	ENL-0-10V Enlightened

<b>Model</b>	<b>96W</b>
<b>Length</b>	14.40"
<b>Width</b>	5.20"
<b>Depth</b>	2.60"

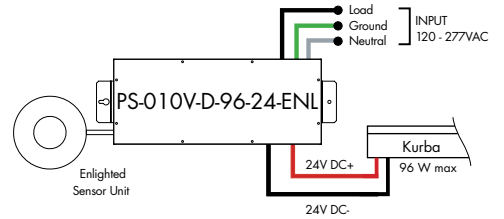

### For use with Static White

Requires Zonal Control

#### DMX Dimming Power Supplies 0.1% 120VAC - 277VAC

MODEL	INPUT CONTROL	ENVIRONMENT	WATTAGE	OUTPUT
PS-Power Supply, 120-277VAC	DMX-DMX (0.1%)	D-Dry	96-96 Watts 3x96-3x96 Watts	24-24 VDC

MODELS	96W	3X96
<b>Length</b>	14.40"	15.00"
<b>Width</b>	5.20"	6.62"
<b>Depth</b>	2.60"	4.56"

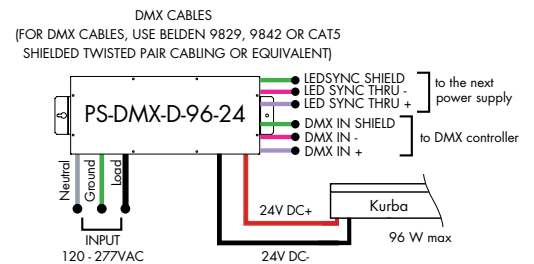
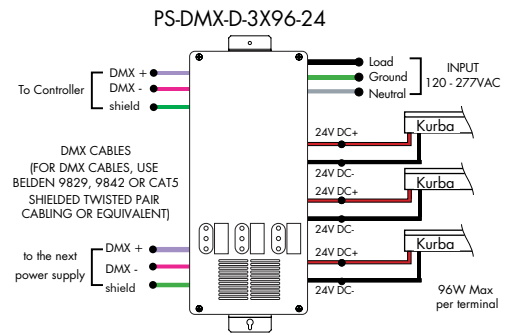

### For use with Static White

#### DMX Dimming Power Supplies 0.1% 120VAC - 277VAC

MODEL	INPUT CONTROL	ENVIRONMENT	WATTAGE	OUTPUT
PS-Power Supply, 120-277VAC	ND-Non Dimming	D-Dry	96-96 Watts	24-24 VDC

<b>MODELS</b>	<b>96W</b>
<b>Length</b>	14.40"
<b>Width</b>	5.20"
<b>Depth</b>	2.60"

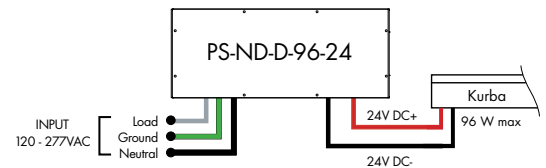

## Power Supplies

See Power Supply instructions and spec sheet for wiring information. For a complete list of compatible dimmers, see Compatible Dimming Chart on the Resources page.

### For use with Static White

#### In-Ground Power Supplies

MODEL	INPUT CONTROL	ENVIRONMENT	WATTAGE	OUTPUT
PS120	ELV-ELV Dimming (1%)	IG-In Ground	2X96-2X96 Watts	24-24 VDC
PS120-Power Supply, 120VAC PS240-Power Supply, 240VAC PS277-Power Supply, 277VAC				

#### MODELS 2X96W

<b>Length</b>	8.40"
<b>Width</b>	8.30"
<b>Depth</b>	8.10"

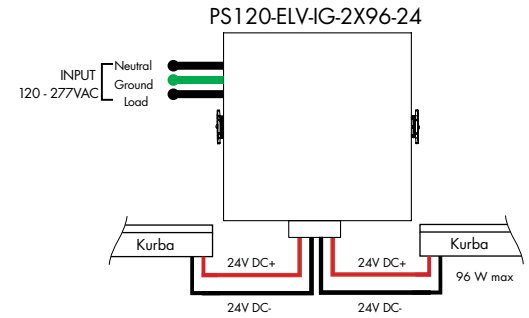

Luminii is a Lutron OEM Advantage Partner

#### Lutron Power Supplies 1%

MODEL

**L3DA4U1UKL-CV240**

HiLume™ 1% EcoSystem Voltage LED driver  
40W max

#### MODELS L3DA4U1UKL-CV240

<b>Length</b>	4.98"
<b>Width</b>	4.00"
<b>Depth</b>	2.62"

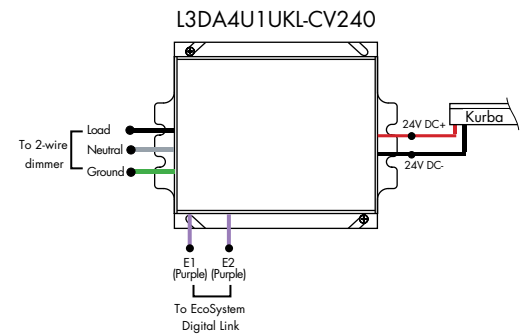

Luminii is a Lutron OEM Advantage Partner

#### Lutron Power Supplies 0.1%

MODEL

**L3D0-96W24V-U**

HiLume™ 0.1% EcoSystem Voltage LED Driver with Soft-On, Fade-to-Black™  
96W max

#### MODELS L3D0

<b>Length</b>	10.50"
<b>Width</b>	5.50"
<b>Depth</b>	2.00"

