

Bara - Installation Instructions

Models BARC-XX



7777 Merrimac Ave
Niles, IL 60714
T 224.333.6033
F 224.757.7557
info@luminii.com
www.luminii.com

REV.0.6
09302024

1 / 8

Please read all instructions prior to installation and keep for future reference!

1. PRODUCT TO BE INSTALLED BY A QUALIFIED ELECTRICIAN.
2. USE ONLY WITH CLASS 2 POWER UNIT.
3. 24 VOLTS DC.
4. SUITABLE FOR DAMP LOCATIONS.
5. SURFACE MOUNT ONLY
6. APPROVED FOR CLOSET/STORAGE SPACE INSTALLATION PER NEC 410.16(A)(3) AND 410.16(C)(5) ON OUTPUTS 5.7W/FT OR LESS
7. INHERENTLY PROTECTED

1

Note: Complete fixture must be built prior to installing. To make all necessary reference marks & to also ensure all parts are included. Then it can be taken apart for installation.

1.1 Snap lens into the extrusion, then align & center the extrusion to the determined location. Make all necessary markings to install to the surface. Prior to installation of extrusion, 24VDC power must be present.

2

Caution: Safety equipment is recommended, when modifications are being made to the extrusion & lens.

2.1 If necessary extrusion, lens, & mounting channel (if applicable) can be cut in the field. Snap all parts together then using the proper blade for aluminum cut to the desired length.

3

3.1 LineLED can be shortened by cutting along the dashed lines in between the solder pads. Make sure the cut is made on the side of the LineLED without the wire leads. LineLED cannot touch the metal endcap which will shorten the circuit.

4

remove paper backing from the adhesive tape of the LineLED before installing the extrusion

4.1 Prior to installing LineLED to extrusion, clean extrusion from any debris. Gently push LineLED onto aluminum extrusion. Then install endcaps at each ends of the extrusion.

5

5.1 Remove the protective film from the diffuser lens. Snap the diffuser lens into the aluminum extrusion.

Note If you are installing the Myka blade louver, please install carefully. Once the blade louver is installed, it cannot be removed without damaging it.

Bara - Installation Instructions

Models BARC-XX

Please read all instructions prior to installation and keep for future reference!

1. PRODUCT TO BE INSTALLED BY A QUALIFIED ELECTRICIAN.
2. USE ONLY WITH CLASS 2 POWER UNIT.
3. 24 VOLTS DC.
4. SUITABLE FOR DAMP LOCATIONS.
5. SURFACE MOUNT ONLY
6. APPROVED FOR CLOSET/STORAGE SPACE INSTALLATION PER NEC 410.16(A)(3) AND 410.16(C)(5) ON OUTPUTS 5.7W/FT OR LESS
7. INHERENTLY PROTECTED



REV0.6
09302024

2 / 8



7777 Merrimac Ave
Niles, IL 60714
T 224.333.6033
F 224.757.7557
info@luminii.com
www.luminii.com

Magnetic Installation

Note: Prior to installation all 24VDC wires must be present near fixture. Refer to the power supply installation instructions for additional information.
Note: More than one person is recommended for this installation.

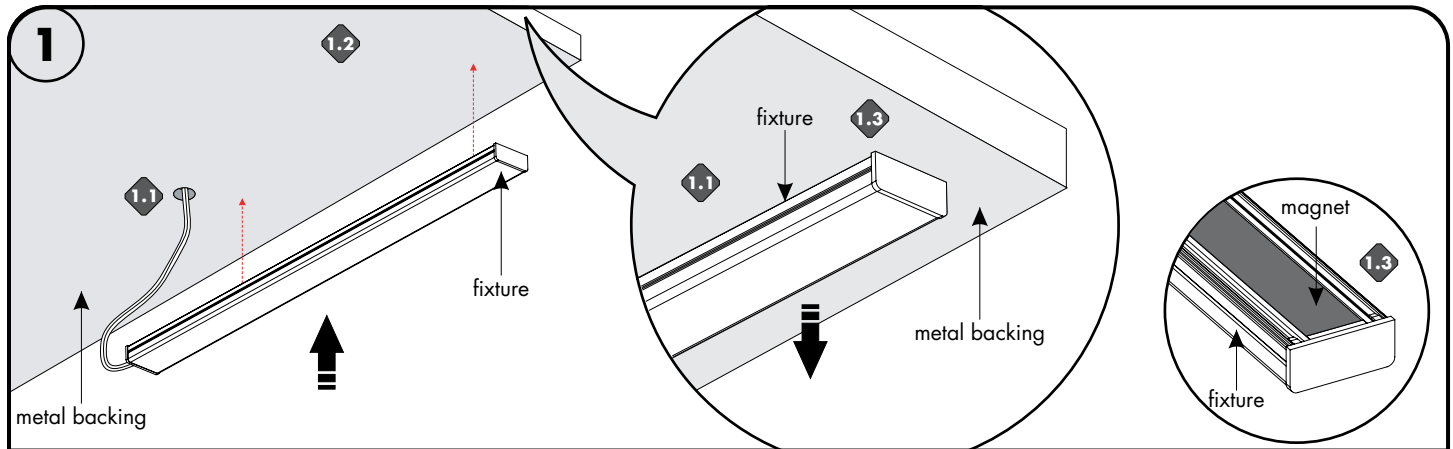

- 1.1 If necessary make any pass through holes for wire lead/connector to the surface, depending on the power feed option.
- 1.2 Clean the surface area thoroughly from any debris. Must be made of steel or a ferrous metal
- 1.3 Snap the fixture onto the metal surface. If necessary fixture can easily be removed by pulling off the surface and repositioning correctly.

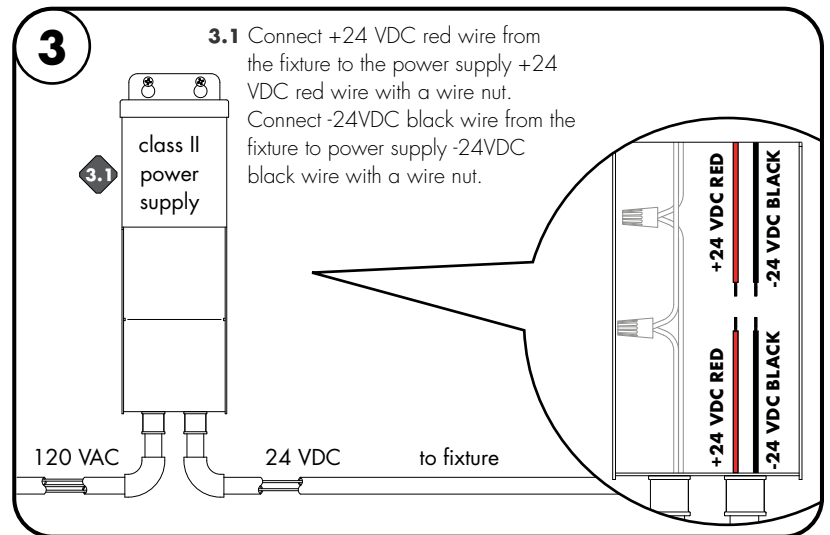
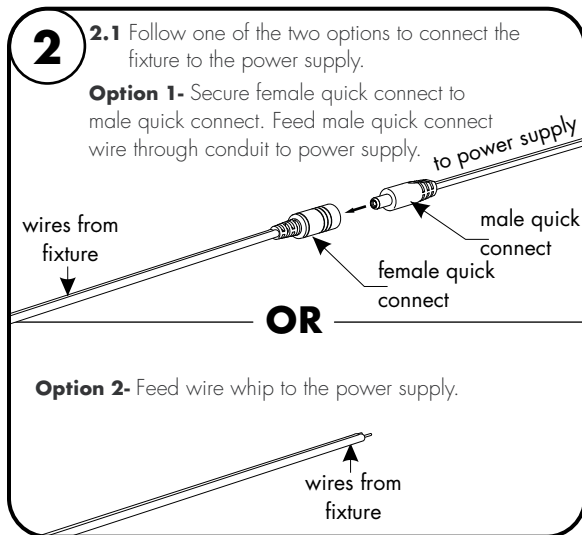

Bara - Installation Instructions

Models BARC-XX



7777 Merrimac Ave
Niles, IL 60714
T 224.333.6033
F 224.757.7557
info@luminii.com
www.luminii.com

REV.0.6
09302024

3 / 8

Please read all instructions prior to installation and keep for future reference!

1. PRODUCT TO BE INSTALLED BY A QUALIFIED ELECTRICIAN.
2. USE ONLY WITH CLASS 2 POWER UNIT.
3. 24 VOLTS DC.
4. SUITABLE FOR DAMP LOCATIONS.
5. SURFACE MOUNT ONLY.
6. APPROVED FOR CLOSET/STORAGE SPACE INSTALLATION PER NEC 410.16(A)(3) AND 410.16(C)(5) ON OUTPUTS 5.7W/FT OR LESS.
7. INHERENTLY PROTECTED

Fixed Mounting Clip Installation - Drywall

Note: Prior to installation all 24VDC wires must be present near fixture. Refer to the power supply installation instructions for additional information.
Note: More than one person is recommended for this installation.

<p>1</p> <p>back of fixture</p> <p>4" every 24" 4"</p>	<p>1.2</p>	
<p>1.1 Determine the location of where the fixture(s) will be installed. Lay the fixture(s) on the surface, and make any necessary reference marks for the fixed mounting clips. Make marks 4" from each end of the fixture(s) and also every 24" in between.</p>	<p>1.2 Drill holes using a 0.180" Ø drill bit.</p>	
<p>1.3</p>	<p>1.4</p> <p>fixed clip</p> <p>#6 screw</p>	<p>1.5</p> <p>fixed clip</p> <p>fixture</p> <p>1.5.1</p> <p>1.5.2</p> <p>Snap</p> <p>Note: DO NOT snap two sides at the same time</p>
<p>1.3 Insert plastic drywall anchors, hammering flush to drywall surface.</p>	<p>1.4 Place bracket over drywall anchor and fasten to drywall using a #6 SS screw, 0.75" long.</p>	<p>1.5 Clip on the light fixtures</p> <ul style="list-style-type: none"> .1 Align light fixture to one side of the clips, make sure the fixture is held. .2 Snap on the other side.

2 Follow one of the two options to connect the fixture to the power supply.

Option 1- Secure female quick connect to male quick connect. Feed male quick connect wire through conduit to power supply.

wires from fixture

to power supply

male quick connect

female quick connect

OR

Option 2- Feed wire whip to the power supply.

wires from fixture

3

Connect +24 VDC red wire from the fixture to the power supply +24 VDC red wire with a wire nut. Connect -24VDC black wire from the fixture to power supply -24VDC black wire with a wire nut.

class II power supply

120 VAC

24 VDC to fixture

+24 VDC RED

-24 VDC BLACK

+24 VDC RED

-24 VDC BLACK

Bara - Installation Instructions

Models BARC-XX



7777 Merrimac Ave
Niles, IL 60714
T 224.333.6033
F 224.757.7557
info@luminii.com
www.luminii.com

REVO.6
09302024

4 / 8

Please read all instructions prior to installation and keep for future reference!

1. PRODUCT TO BE INSTALLED BY A QUALIFIED ELECTRICIAN.
2. USE ONLY WITH CLASS 2 POWER UNIT.
3. 24 VOLTS DC.
4. SUITABLE FOR DAMP LOCATIONS.
5. SURFACE MOUNT ONLY
6. APPROVED FOR CLOSET/STORAGE SPACE INSTALLATION PER NEC 410.16(A)(3) AND 410.16(C)(5) ON OUTPUTS 5.7W/FT OR LESS
7. INHERENTLY PROTECTED

Fixed Mounting Clip Installation - Millwork

Note: Prior to installation all 24VDC wires must be present near fixture. Refer to the power supply installation instructions for additional information.
Note: More than one person is recommended for this installation.

1 back of fixture

1.1 4" every 24" 4"

fixed clip
#4 size screw

1.1 Determine the location of where the fixture(s) will be installed. Lay the fixture(s) on the surface, and make any necessary reference marks for the fixed mounting clips. Make marks 4" from each end of the fixture(s) and also every 24" in between.

1.2 Lay the fixed clip onto the reference mark points. Drill a 0.1" starter hole. Lay down the clips and secure with the screw.

1.3 Clip on the light fixtures

- .1 Align light fixture to one side of the clips, make sure the fixture is held.
- .2 Snap on the other side.

1.3.1 fixed clip
fixture

1.3.2 Snap

Note: DO NOT snap two sides at the same time

2 Follow one of the two options to connect the fixture to the power supply.

Option 1- Secure female quick connect to male quick connect. Feed male quick connect wire through conduit to power supply.

wires from fixture to power supply
male quick connect
female quick connect

OR

Option 2- Feed wire whip to the power supply.

wires from fixture

3

Connect +24 VDC red wire from the fixture to the power supply +24 VDC red wire with a wire nut. Connect -24VDC black wire from the fixture to power supply -24VDC black wire with a wire nut.

class II power supply

120 VAC 24 VDC to fixture

+24 VDC RED
-24 VDC BLACK

Bara - Installation Instructions

Models BARC-XX



7777 Merrimac Ave
Niles, IL 60714
T 224.333.6033
F 224.757.7557
info@luminii.com
www.luminii.com

REV.0.6
09302024

5 / 8

Please read all instructions prior to installation and keep for future reference!

1. PRODUCT TO BE INSTALLED BY A QUALIFIED ELECTRICIAN.
2. USE ONLY WITH CLASS 2 POWER UNIT.
3. 24 VOLTS DC.
4. SUITABLE FOR DAMP LOCATIONS.
5. SURFACE MOUNT ONLY.
6. APPROVED FOR CLOSET/STORAGE SPACE INSTALLATION PER NEC 410.16(A)(3) AND 410.16(C)(5) ON OUTPUTS 5.7W/FT OR LESS.
7. INHERENTLY PROTECTED

Lay-in Grid Clip Installation

Note: Prior to installation all 24VDC wires must be present near fixture. Refer to the power supply installation instructions for additional information.
Note: More than one person is recommended for this installation.

1 **1.1**

1.2

1.3

1.3

1.3.1

1.3.2

Note: DO NOT snap two sides at the same time

- 1.1** Prior to installing the fixture on the grid, reference the back of the fixture to take into consideration end caps & power feed. In addition take into account the lead wires they are slightly off centered .
- 1.2** Then align & rotate to secure each t-bar clip to the track. Install a t-bar clip 4" from each end of the fixture and also one every 24" in between the fixture.
- 1.3** Clip on the light fixtures
 - .1** Align light fixture to one side of the clips, make sure the fixture is held.
 - .2** Snap on the other side.

Optional

front view

If necessary, use metal shears to cut a notch on T-bar/Tile for fixture lead ensuring sharp bends in wire management are avoided to prevent the wire leads from stripping and causing a short.

2 Follow one of the two options to connect the fixture to the power supply.

Option 1- Secure female quick connect to male quick connect. Feed male quick connect wire through conduit to power supply.

OR

Option 2- Feed wire whip to the power supply.

3

Connect +24 VDC red wire from the fixture to the power supply +24 VDC red wire with a wire nut.
Connect -24VDC black wire from the fixture to power supply -24 VDC black wire with a wire nut.

Bara - Installation Instructions

Models BARC-XX



7777 Merrimac Ave
Niles, IL 60714
T 224.333.6033
F 224.757.7557
info@luminii.com
www.luminii.com

REV.0.6
09302024

6 / 8

Please read all instructions prior to installation and keep for future reference!

1. PRODUCT TO BE INSTALLED BY A QUALIFIED ELECTRICIAN.
2. USE ONLY WITH CLASS 2 POWER UNIT.
3. 24 VOLTS DC.
4. SUITABLE FOR DAMP LOCATIONS.
5. SURFACE MOUNT ONLY.
6. APPROVED FOR CLOSET/STORAGE SPACE INSTALLATION PER NEC 410.16(A)(3) AND 410.16(C)(5) ON OUTPUTS 5.7W/FT OR LESS.
7. INHERENTLY PROTECTED

Tegular Grid Clip Installation

Note: Prior to installation all 24VDC wires must be present near fixture. Refer to the power supply installation instructions for additional information.
Note: More than one person is recommended for this installation.

1

back of fixture

lead wire (centered)

4" every 24" 4"

1.3

tegular grid clip

1.2

tegular grid

tegular grid clip

Snap

1.3.1

clip

fixture

1.3.2

Snap

1.1 Prior to installing the fixture on the grid, reference the back of the fixture to take into consideration end caps & power feed. In addition take into account the lead wires they are slightly off centered.

1.2 Then align & insert one side of tegular grid clip to the track, snap on the other side. Install a clip 4" from each end of Clip on the fixture and also one every 24" in between the fixture.

1.3 .1 Align light fixture to one side of the clips, make sure the fixture is held.

.2 Snap on the other side.

Note: DO NOT snap two sides at the same time

Optional

tegular grid

female quick connect

male quick connect

notch

bara fixture

mounting surface

front view

male quick connect

female quick connect

bara fixture

If necessary, use metal shears to cut a notch on tegular grid for fixture lead ensuring sharp bends in wire management are avoided to prevent the wire leads from stripping and causing a short.

2 Follow one of the two options to connect the fixture to the power supply.

Option 1- Secure female quick connect to male quick connect. Feed male quick connect wire through conduit to power supply.

wires from fixture

female quick connect

male quick connect

to power supply

OR

Option 2- Feed wire whip to the power supply.

wires from fixture

3

class II power supply

120 VAC

24 VDC to fixture

Connect +24 VDC red wire from the fixture to the power supply +24 VDC red wire with a wire nut.
Connect -24VDC black wire from the fixture to power supply -24 VDC black wire with a wire nut.

+24 VDC RED

-24 VDC BLACK

Bara - Installation Instructions

Models BARC-XX



7777 Merrimac Ave
Niles, IL 60714
T 224.333.6033
F 224.757.7557
info@luminii.com
www.luminii.com

REV.0.6
09302024

7 / 8

Please read all instructions prior to installation and keep for future reference!

1. PRODUCT TO BE INSTALLED BY A QUALIFIED ELECTRICIAN.
2. USE ONLY WITH CLASS 2 POWER UNIT.
3. 24 VOLTS DC.
4. SUITABLE FOR DAMP LOCATIONS.
5. SURFACE MOUNT ONLY
6. APPROVED FOR CLOSET/STORAGE SPACE INSTALLATION PER NEC 410.16(A)(3) AND 410.16(C)(5) ON OUTPUTS 5.7W/FT OR LESS
7. INHERENTLY PROTECTED

Slot Tee Grid Clip Installation

Note: Prior to installation all 24VDC wires must be present near fixture. Refer to the power supply installation instructions for additional information.
Note: More than one person is recommended for this installation.

1.1 Prior to installing the fixture on the grid, reference the back of the fixture to take into consideration end caps & power feed. In addition take into account the lead wires they are slightly off centered.

1.2 Then align & insert top of slot tee grid clip into the trak. Use screwdriver to secure the clip. Install a clip 4" from each end of Clip on the fixture and also one every 24" in between the fixture.

1.3.1 Align light fixture to one side of the clips, make sure the fixture is held.
1.3.2 Snap on the other side.

1.3.1 Align light fixture to one side of the clips, make sure the fixture is held.

1.3.2 Snap on the other side.

Note: DO NOT snap two sides at the same time

Optional

lead wire
slot tee grid
hole
mounting surface
bara fixture

front view

lead wire
bara fixture

If necessary, drill a hole with grid for fixture lead ensuring sharp bends in wire management are be avoided to prevent the wire leads from stripping and causing a short.

2 Follow one of the two options to connect the fixture to the power supply.

Option 1- Secure female quick connect to male quick connect. Feed male quick connect wire through conduit to power supply.

wires from fixture
female quick connect
male quick connect
to power supply

OR

Option 2- Feed wire whip to the power supply.

wires from fixture

3

class II power supply
120 VAC
24 VDC to fixture

Connect +24 VDC red wire from the fixture to the power supply +24 VDC red wire with a wire nut.
Connect -24VDC black wire from the fixture to power supply -24 VDC black wire with a wire nut.

+24 VDC RED
-24 VDC BLACK

Bara - Installation Instructions

Models BARC-XX

Please read all instructions prior to installation and keep for future reference!

1. PRODUCT TO BE INSTALLED BY A QUALIFIED ELECTRICIAN.
2. USE ONLY WITH CLASS 2 POWER UNIT.
3. 24 VOLTS DC.
4. SUITABLE FOR DAMP LOCATIONS.
5. SURFACE MOUNT ONLY
6. APPROVED FOR CLOSET/STORAGE SPACE INSTALLATION PER NEC 410.16(A)(3) AND 410.16(C)(5) ON OUTPUTS 5.7W/FT OR LESS
7. INHERENTLY PROTECTED



REV.0.6
09302024

8 / 8



7777 Merrimac Ave
Niles, IL 60714
T 224.333.6033
F 224.757.7557
info@luminii.com
www.luminii.com

power supplies at the end of the run

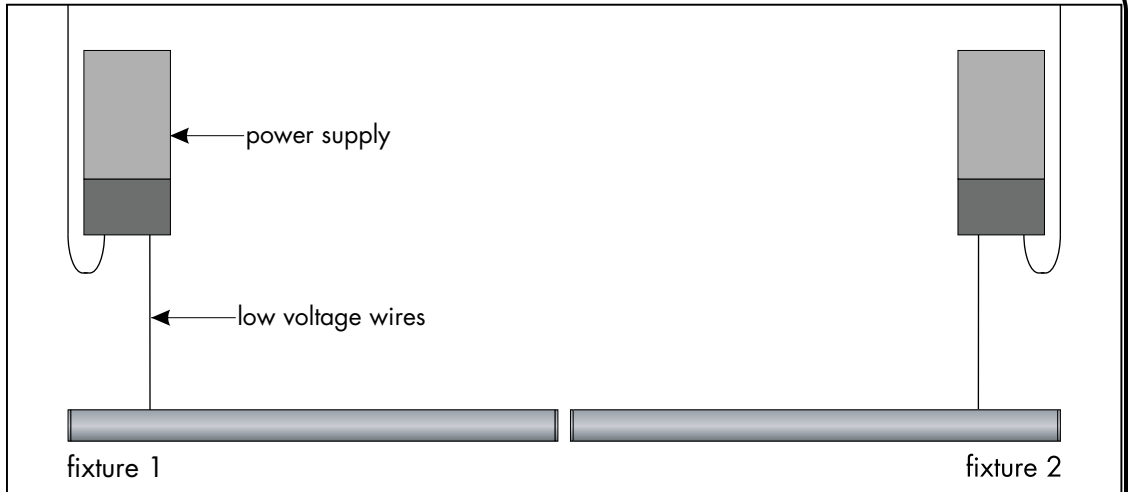

power supplies in the middle of the run

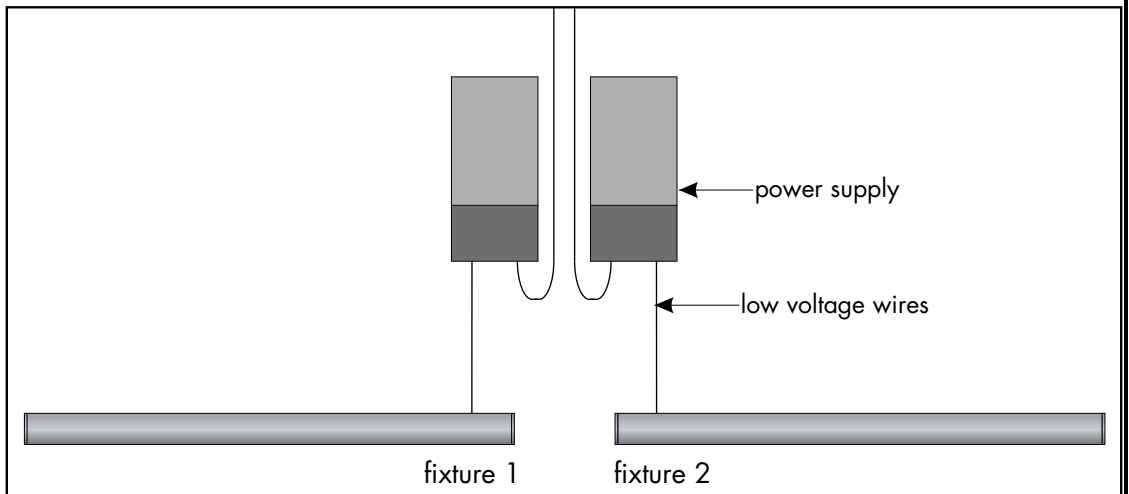

consecutive layout, NOT RECOMMENDED

