

Dynamic white Controller - Installation Instructions

Models DDW-MC



7777 N. Merrimac Ave
Niles, IL 60714
T 224.333.6033
F 224.757.7557
info@luminii.com
www.luminii.com

Please read all instructions prior to installation and keep for future reference!

1. Product to be installed by a qualified electrician.

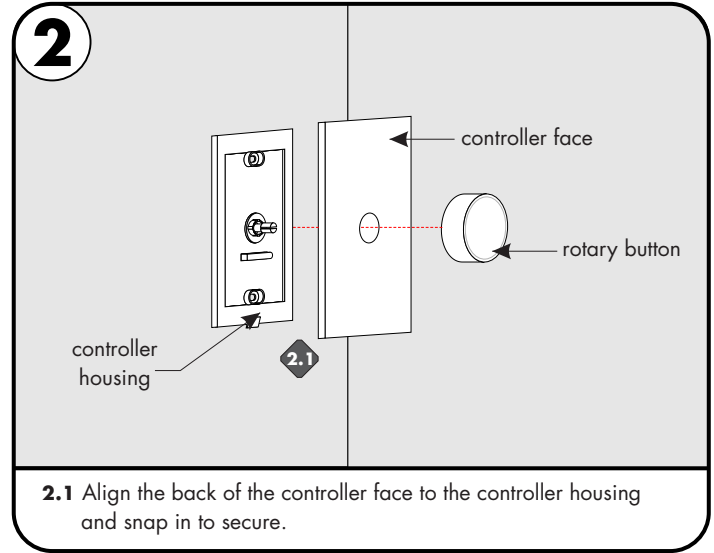
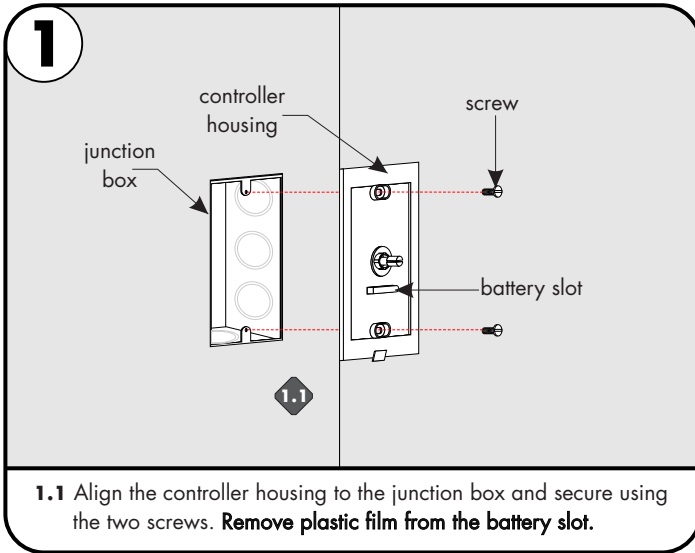

Operations to controller

1. Press the learning key on the receiver, then push the rotary button on the controller. Once successfully learn, the LED lights will blink on the receiver. Do the same for the other receivers if you use them, you can add as many optional receivers as you want.
2. Short press once the rotary button to switch on/off.
Adjust dim brightness by the rotary button from left to right 0.1 - 100%.
Adjust dim brightness by the rotary button from right to left 0.1 - 100%.

Double click rotary button, it will enter into dimming color temperature mode, dim WW & CW associatively, for example if WW is 70%, CW is 30%.
Double click again, will enter into dimming brightness mode.

If necessary controller battery can be replaced by pulling off the controller face plate, then replacing battery from the battery slot.

