

Features

Kurba Medium Domed is a dot free direct view, narrow profile, energy efficient and flexible LED strip suitable for outdoor wet locations capable of horizontal/side bends with a 2.5" bending radius. The silicone material offers excellent heat, weather, UV, and solvent resistance and has a special coating to repel dust and dirt accumulation.

Applications

Indoor/Outdoor dry & wet location

Materials

Silicone for red list approved, as well as heat, weather, UV, and solvent resistance

Dimming

Dot Free even illumination. Unique Domed lens for wide view angle. Dimable down to 1%

Average Life (L70)

50,000 Hours

Approvals

24VDC Class 2 wet listed, IP68

Warranty

3 years

Finish Options (see page 2 for additional information)

Base White

Premium Black Red Green Blue



Technical Information

Bending Direction	Horizontal
Output	2250
Light Output at 3000K	158 lm/ft
Average Power Consumption at 4'	3.66 W/ft
Efficacy	43 lm/W
Ordering Increment	3.28"
Maximum Run Length (In Series)	26'
Operating Temperature Range	-40°F to 131°F

CCT INFO / LUMEN MULTIPLIER	
Color Temperature	Multiplier (ref. -3000K)
2200K	0.80
2400K	0.90
2700K	1.00
3000K	1.00
3500K	1.00
4000K	1.00

Note: 80 CRI

Constraints

Horizontal Bend Direction

Bend LED in these positions only to avoid damage

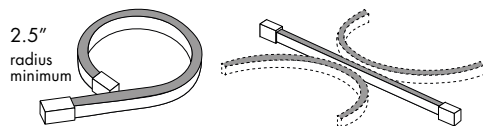

Illuminated surface shown in gray

Horizontal Prohibited Bends

Twisting or bending LED in these positions will cause damage

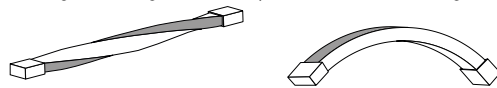

Illuminated surface shown in gray

Do not make sharp bends near the endcap

Ordering Code

MODEL	RATING	BEND DIRECTION	LENGTH	OUTPUT	CCT	LENS ¹	MOUNTING	FINISH	FEED POSITION LEFT	FEED POSITION RIGHT
KBM-Kurba Medium	W-Wet	HB-Horizontal Bending	SEE PCC CHART ON PAGE 6	2250-Standard	22K-2200K 24K-2400K 27K-2700K 30K-3000K 35K-3500K 40K-4000K	DSF-Domed Lens	NA-See Page 4 for orderable mounting accessories	WH-White BK-Black RED-Red GRN-Green BLU-Blue	INJECTION MOLD IME-End Feed 1 IMB-Back Feed 1 IMSA-Side 1 Feed NPF-No Power Feed ¹	INJECTION MOLD IME-End Feed 1 IMB-Back Feed 1 IMSA-Side 1 Feed NPF-No Power Feed ¹

Feeds come with 90° wire leads

¹ -NPF-NPF for Feed Position 1&2 is not a valid configuration option

Powerfeeds and Connectors

Power Feed Position Options and Orientation

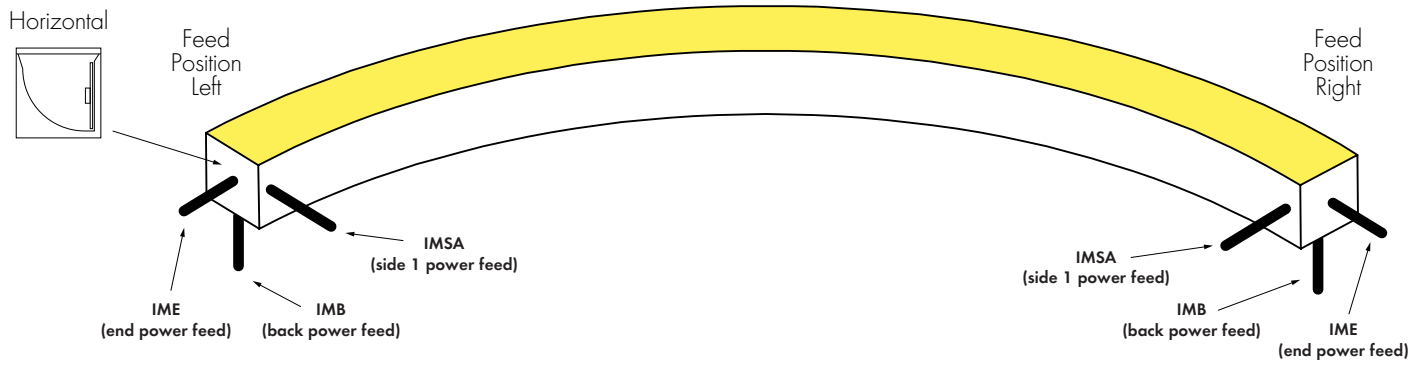

Linking and Extension Cable Options

END CONNECTOR

Injection-molded End Connector
-IME

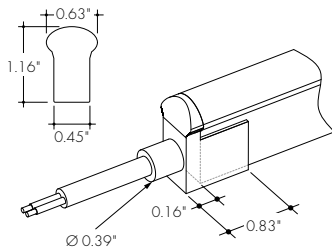

BACK CONNECTOR

Injection-molded Back Connector
-IMB

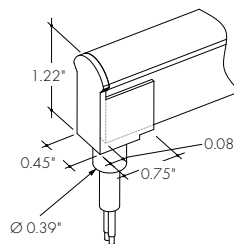

SIDE CONNECTOR

Injection-molded Side Connector
-IMS

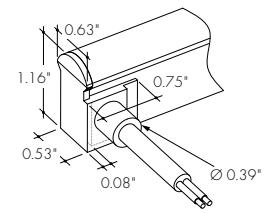

ENDCAP (NO CONNECTOR)

Injection-molded Cap (No Connector)
-NPF

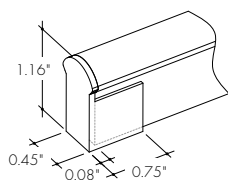

ANTI-WICKING FERRULE

Included on every power feed wire

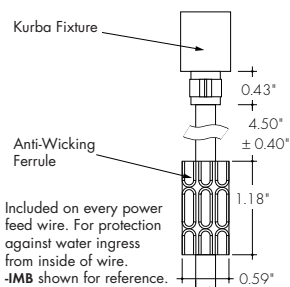

Product Dimensions

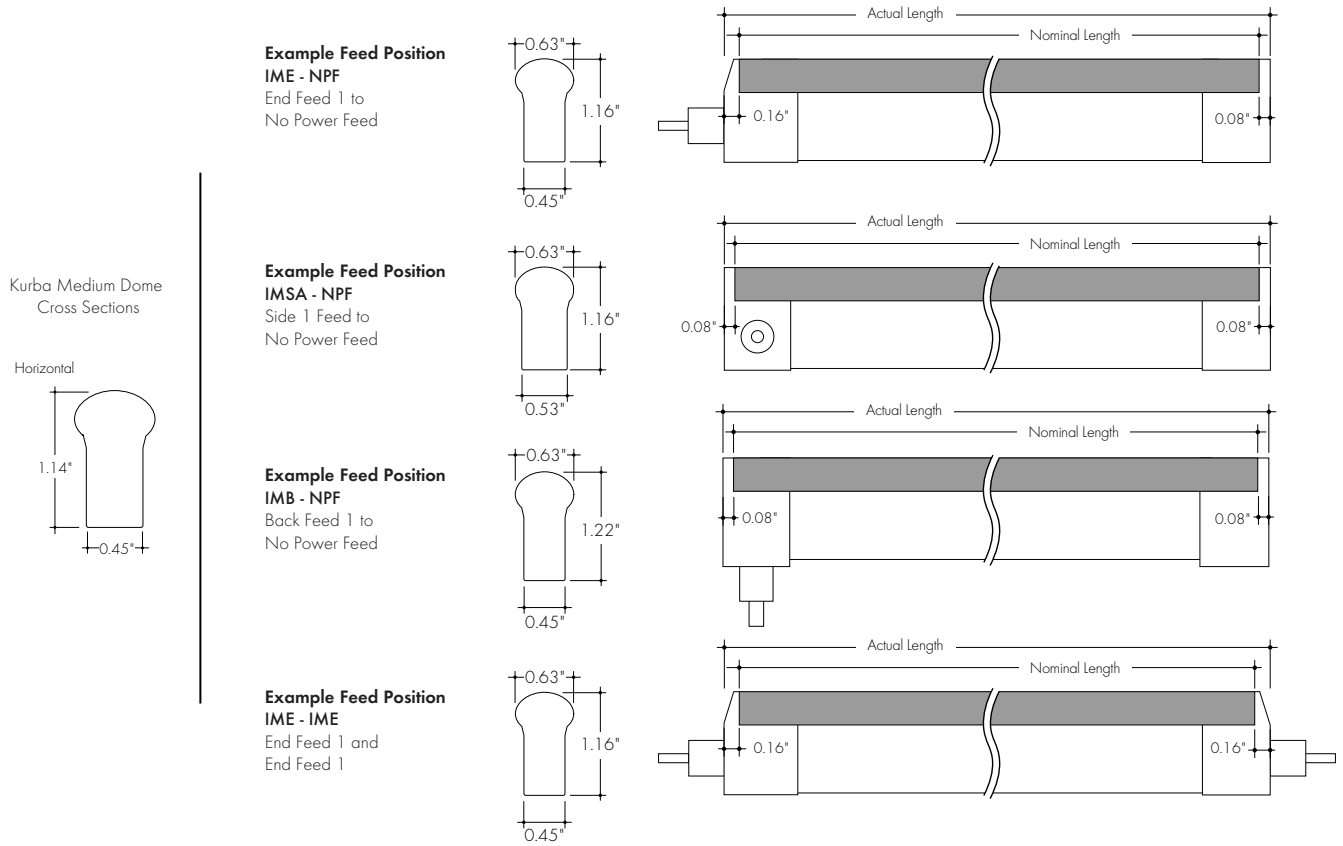

Finish Options

- A wide variety of finish options allowing complete customization of style and aesthetic.

White
Base

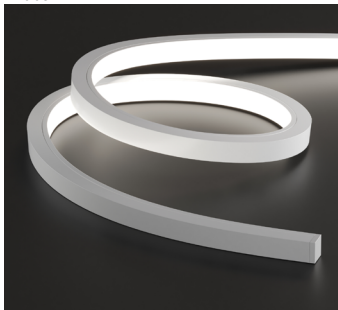

Kurba's base finish is a crisp white which brings a timeless, clean aesthetic that brightens and enhances any space

Black Finish w/ Black Lens
Premium



Also available with a blackout aesthetic - the Black Lens paired with the Black Finish provides for a sleek, all black profile that keeps the strip concealed in the off-state.

Red
Premium

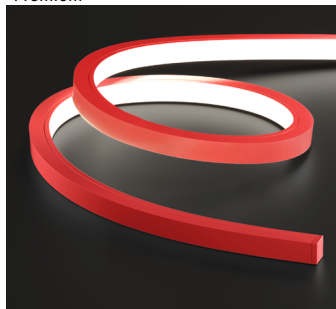

Red adds a bright and bold statement, perfect for creating a striking and dynamic ambience with its vibrancy

Green
Premium

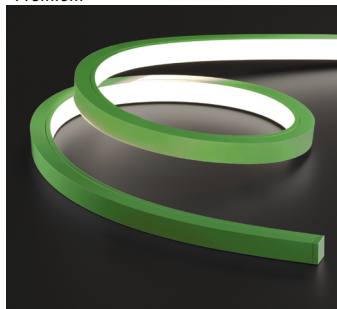

Green embraces a refreshing and natural feel, reminiscent of emerald green, add touch of tranquility and harmony to your space with this option

Blue
Premium

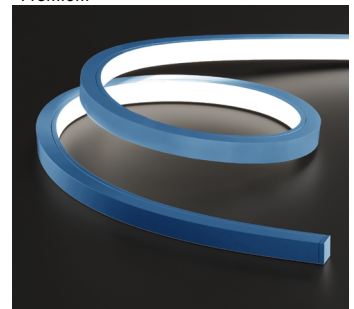

Blue evokes the serenity of the deep sea by combining vivid cobalt and azure tones.

Light Transmission and Dotting

Output Options	Lens/Accessory	
	Domed Lens/ White Finish	Domed Lens/ White, Black, Red, Green, Blue Finish
22SO	ND	ND
Transmission Percentage	100%	80%

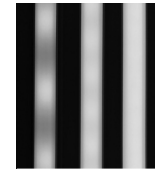

CD SD ND
CD - Clear Dotting
SD - Slight Dotting
ND - No Dotting

Mounting Accessories & Optional Connectors

MC-KBM-SAP-SM-0.8-SA

KBM Mounting Channel, Serrated Aluminum Profile, Surface Mount, 0.8in, Silver Anodized

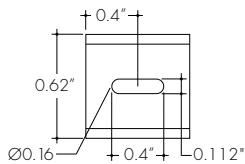
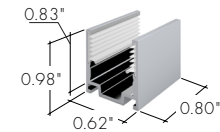

For use with light strip mounted to the ceiling.
 1 recommended every 8 in.

MC-KBM-SAP-SM-78-SA

KBM Mounting Channel, Serrated Aluminum Profile, Surface Mount, 78in, Silver Anodized

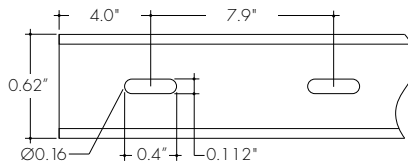
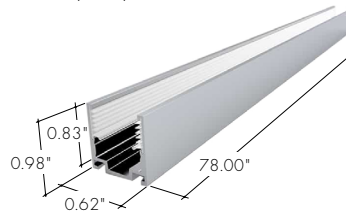

For use with light strip mounted to the ceiling.

MC-KBM-FSAP-TR-78-SA

KBM Mounting Channel, Flanged Serrated Aluminum Profile, Trimmed Recessed Mount, 78in, Silver Anodized

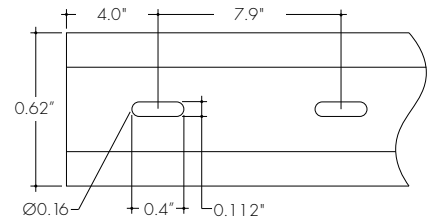
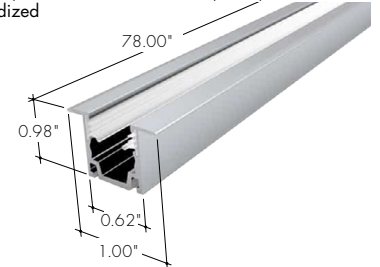

Flanged aluminum mounting channel providing grip.
 For use with light strip recessed into the ceiling.

MC-KBM-BSAP-HB-SM-38-SA

KBM Mounting Channel, Bendable Serrated Aluminum Profile, Horizontal Bending, Surface Mount, 38in, Silver Anodized

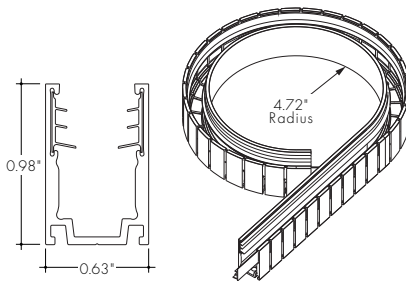

Bendable stainless steel mounting channel providing grip.
 For use with light strip mounted to the ceiling.
NOTE: Compatible with IMB - Back Feed only

MC-KBM-RCWY-SM-78-SA

KBM Mounting Channel, Raceway, Surface Mount, 78in, Silver Anodized

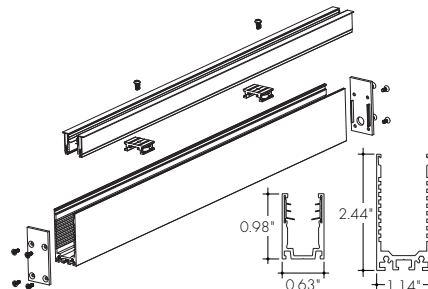

Raceway channel allows for hidden cable management and is a superb option where tidiness is required.
NOTE: Compatible with IMB - Back Feed only

LVSP-WET

Splice box: wet rated, low voltage, gray

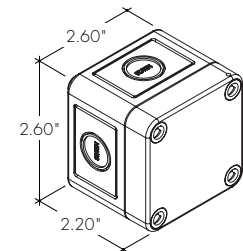

LVSP-WET-CM

Connector for splice box, low voltage for cable management, gray

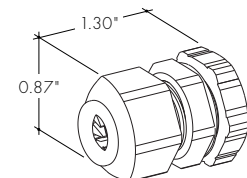

Mounting Accessories and Optional Connectors

Photometry

KBM-W-HB-48-22SO-30K-DSF-NA-WH

Kurba Medium, Horizontal Bend, 4ft, 3000K, 22SO, Domed Silicone Frosted Lens

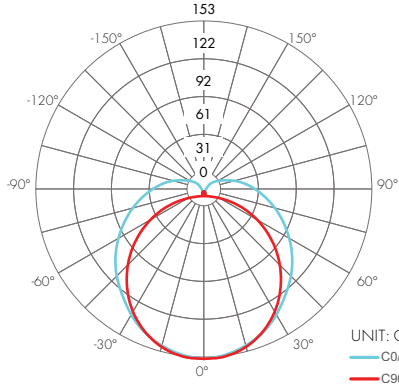

Zonal Lumen Summary 3000K

Zone	Lumen	% Fixture
0-30	114	18.1%
0-40	158	25.0%
0-60	347	54.9%
0-90	519	82.2%
Total	632	100.0%

Total

Beam Angle



UNIT: CD
 — C0/180
 — C90/270

22SO | Power Consumption Per Fixture Length

Based on operation with PDCU series of power supplies. Use Actual Length for Order Code Entry.
 Tolerance for Actual Lengths less than 6 ft is +/- 0.2", Actual Lengths between 6 ft and 16 ft is +/- 0.3", and Actual Lengths greater than 16 ft is +/- 0.6"
A - End Connector at both ends of Kurba (0.16" + 0.16" added to overall length)
B - End Connector at one end of Kurba and No Connector or Back Connector or Side Connector at other end of Kurba (0.16" + 0.08" added to overall length)
C - Any combination of No Connector, Back Connector, or Side Connector on each end of Kurba (0.08" + 0.08" added to overall length)

Nominal Length (in)	Actual Length (in)				Nominal Length (in)	Actual Length (in)				Nominal Length (in)	Actual Length (in)			
	W	A	B	C		W	A	B	C		W	A	B	C
7	2.1	6.9	6.8	6.7	125	38.1	125.0	124.9	124.8	243	74.1	243.1	243.0	242.9
10	3.1	10.2	10.1	10.0	128	39.1	128.3	128.2	128.1	246	75.1	246.4	246.3	246.2
(1 ft) 14	4.1	13.4	13.4	13.3	(11 ft) 132	40.1	131.5	131.5	131.4	250	76.1	249.7	249.6	249.5
17	5.1	16.7	16.6	16.6	135	41.1	134.8	134.7	134.7	(21 ft) 253	77.1	252.9	252.9	252.8
20	6.1	20.0	19.9	19.8	138	42.1	138.1	138.0	137.9	256	78.1	256.2	256.1	256.1
(2 ft) 23	7.1	23.3	23.2	23.1	141	43.1	141.4	141.3	141.2	260	79.1	259.5	259.4	259.3
27	8.1	26.6	26.5	26.4	(12 ft) 145	44.1	144.7	144.6	144.5	(22 ft) 263	80.1	262.8	262.7	262.6
30	9.1	29.8	29.8	29.7	148	45.1	148.0	147.9	147.8	266	81.1	266.1	266.0	265.9
33	10.1	33.1	33.0	33.0	151	46.1	151.2	151.2	151.1	269	82.1	269.3	269.3	269.2
(3 ft) 36	11.1	36.4	36.3	36.2	(13 ft) 155	47.1	154.5	154.4	154.4	273	83.1	272.6	272.5	272.5
40	12.1	39.7	39.6	39.5	158	48.1	157.8	157.7	157.6	(23 ft) 276	84.1	275.9	275.8	275.7
43	13.1	43.0	42.9	42.8	161	49.1	161.1	161.0	160.9	279	85.1	279.2	279.1	279.0
46	14.1	46.2	46.2	46.1	164	50.1	164.4	164.3	164.2	282	86.1	282.5	282.4	282.3
(4 ft) 50	15.1	49.5	49.5	49.4	(14 ft) 168	51.1	167.6	167.6	167.5	286	87.1	285.7	285.7	285.6
53	16.1	52.8	52.7	52.7	171	52.1	170.9	170.8	170.8	(24 ft) 289	88.1	289.0	288.9	288.9
56	17.1	56.1	56.0	55.9	174	53.1	174.2	174.1	174.0	292	89.1	292.3	292.2	292.1
(5 ft) 59	18.1	59.4	59.3	59.2	178	54.1	177.5	177.4	177.3	296	90.1	295.6	295.5	295.4
63	19.1	62.7	62.6	62.5	(15 ft) 181	55.1	180.8	180.7	180.6	(25 ft) 299	91.1	298.9	298.8	298.7
66	20.1	65.9	65.9	65.8	184	56.1	184.0	184.0	183.9	302	92.1	302.1	302.1	302.0
69	21.1	69.2	69.1	69.1	187	57.1	187.3	187.2	187.2	305	93.1	305.4	305.3	305.3
(6 ft) 73	22.1	72.5	72.4	72.3	(16 ft) 191	58.1	190.6	190.5	190.4	309	94.1	308.7	308.6	308.5
76	23.1	75.8	75.7	75.6	194	59.1	193.9	193.8	193.7	(26 ft) 312	95.1	312.0	311.9	311.8
79	24.1	79.1	79.0	78.9	197	60.1	197.2	197.1	197.0					
(7 ft) 82	25.1	82.3	82.3	82.2	200	61.1	200.4	200.4	200.3					
86	26.1	85.6	85.5	85.5	(17 ft) 204	62.1	203.7	203.6	203.6					
89	27.1	88.9	88.8	88.7	207	63.1	207.0	206.9	206.8					
92	28.1	92.2	92.1	92.0	210	64.1	210.3	210.2	210.1					
(8 ft) 96	29.1	95.5	95.4	95.3	214	65.1	213.6	213.5	213.4					
99	30.1	98.7	98.7	98.6	(18 ft) 217	66.1	216.8	216.8	216.7					
102	31.1	102.0	101.9	101.9	220	67.1	220.1	220.0	220.0					
105	32.1	105.3	105.2	105.1	223	68.1	223.4	223.3	223.2					
(9 ft) 109	33.1	108.6	108.5	108.4	(19 ft) 227	69.1	226.7	226.6	226.5					
112	34.1	111.9	111.8	111.7	230	70.1	230.0	229.9	229.8					
115	35.1	115.1	115.1	115.0	233	71.1	233.3	233.2	233.1					
(10 ft) 118	36.1	118.4	118.3	118.3	237	72.1	236.5	236.5	236.4					
122	37.1	121.7	121.6	121.5	(20 ft) 240	73.1	239.8	239.7	239.7					

Note: all values are rounded to the nearest 0.1 inch

Endcap (No Connector) -NPF

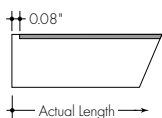

End Connector -IME

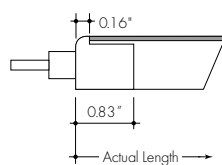

Back Connector -IMB

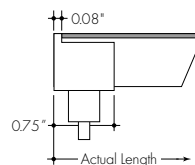

Side Connector -IMSA and -IMSB

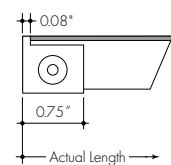

Power Supplies

See Power Supply instructions and spec sheet for wiring information. For a complete list of compatible dimmers, see Compatible Dimming Chart on the Resources page.

Universal Power Supply 1% 120VAC - 277VAC

MODEL	POWER	OUTPUT
PDCU-D - IP20 Dry Series	30 - 30 W 60 - 60 W 96 - 96 W 3X96 - 3X96 W	24 - 24 VDC
PDCU-W - IP66 Wet Series	96 - 96 W 3X96 - 3X96 W	

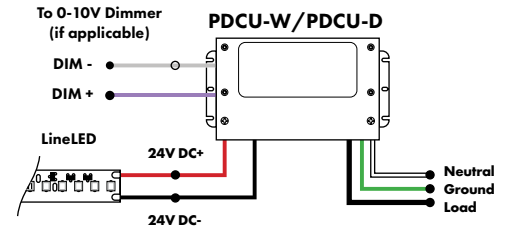

0-10V dims down to 1%, MLV/ELV/TRIAC dims down to 1%.
For a complete list of compatible dimmers, see [Compatible Dimming Chart](#) on the Resources page.

MODELS	PDCU-W 96W	PDCU-W 3X96W	PDCU-D 30W	PDCU-D 60W	PDCU-D 96W	PDCU-D 3X96W
Length	8.66"	11.85"	6.10"	7.93"	8.25"	9.57"
Width	3.73"	4.32"	3.35"	3.35"	4.10"	5.94"
Depth	1.61"	1.81"	1.33"	1.32"	1.56"	1.13"

0-10V Dimming Power Supplies 0.1% 120VAC - 277VAC

MODEL	POWER	OUTPUT	DIMMING
PS010V - 0-10V Power Supply dims down to 0.1%	96 - 96 Watt 3X96 - 3 X 96 Watt	24 - 24 VDC	LIN - Linear LOG - Logarithmic

MODELS	96W	3X96
Length	14.40"	15.75"
Width	5.20"	6.62"
Depth	2.60"	4.95"

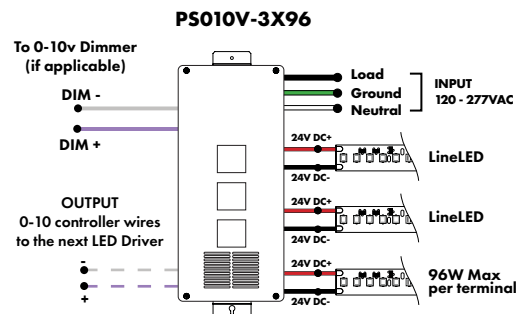
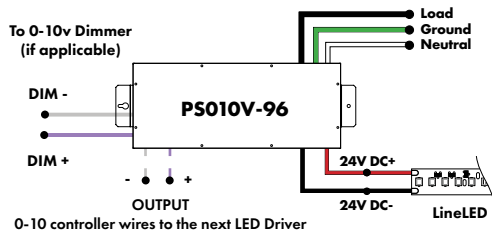

Power Supplies

See Power Supply instructions and spec sheet for wiring information. For a complete list of compatible dimmers, see Compatible Dimming Chart on the Resources page.

DMX Dimming Power Supplies 120VAC - 277VAC

MODEL	POWER	OUTPUT
PSDMX - DMX Power Supply dims down to 0%	96 - 96 Watt 3X96 - 3 X 96 Watt	24 - 24 VDC

Features eldoLED's LINEARdrive configurable dimmable drivers

MODELS	96W	3X96
Length	14.40"	15.75"
Width	5.20"	6.62"
Depth	2.60"	4.95"

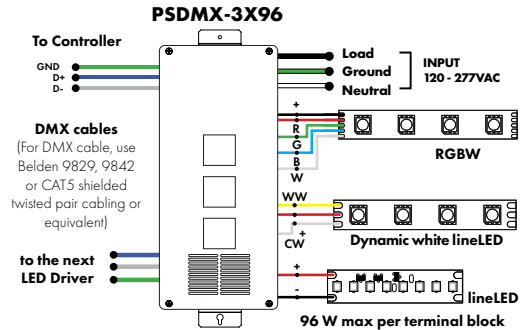
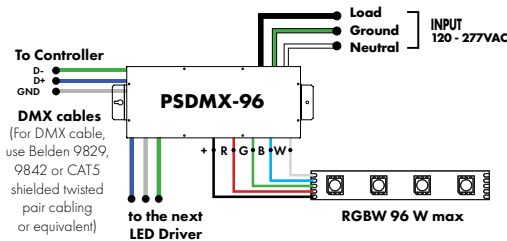

DALI 0% Dimming Power Supplies 120VAC - 277VAC

MODEL	POWER	OUTPUT
PSDALI - DALI Power Supply dims down to 0%	96 - 96 Watt 3X96 - 3 X 96 Watt	24 - 24 VDC

Features eldoLED's LINEARdrive configurable dimmable drivers

Model	96W	3X96
Length	14.40"	15.75"
Width	5.20"	6.62"
Depth	2.60"	4.95"

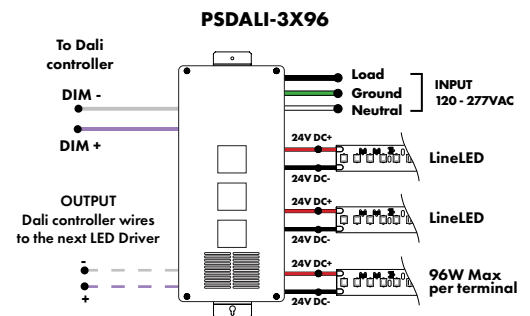
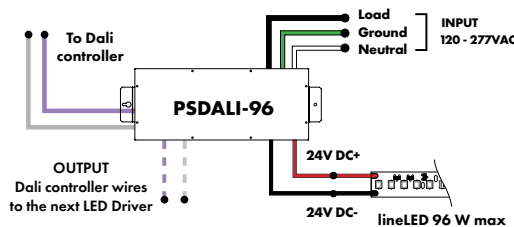

Enlighted Enabled Dimming Power Supplies 120VAC - 277VAC

MODEL	POWER	OUTPUT	DIMMING	LOCATION
PSV - PSV Series	96 - 96 Watt	24 - 24 VDC	ENL - Enlighted Dimming dims down to 0%	D - Damp

Model	96W
Length	14.40"
Width	5.20"
Depth	2.60"

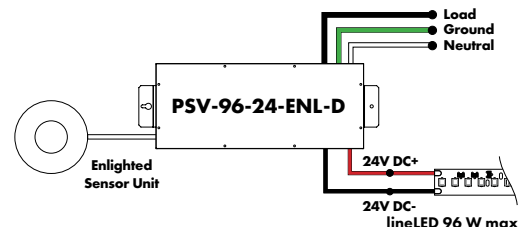

Power Supplies

See Power Supply instructions and spec sheet for wiring information. For a complete list of compatible dimmers, see Compatible Dimming Chart on the Resources page.

Non-Dimming Power Supply 120VAC - 277VAC

MODEL	POWER	OUTPUT	DIMMING	LOCATION
PSV - PSV Series	96 - 96 Watt	24 - 24 VDC	ND - Non Dimming	D - Damp

MODELS	96W
Length	14.40"
Width	5.20"
Depth	2.60"

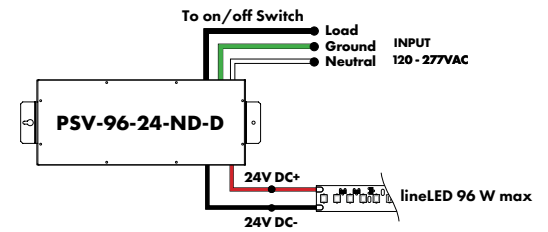

Luminii is a Lutron OEM Advantage Partner

Lutron Power Supplies 1%

MODEL
L3DA4U1UKL-CV240

HiLume™ 1% EcoSystem Voltage LED driver
40W max

MODELS	L3DA4U1UKL-CV240
Length	4.98"
Width	4.00"
Depth	2.62"

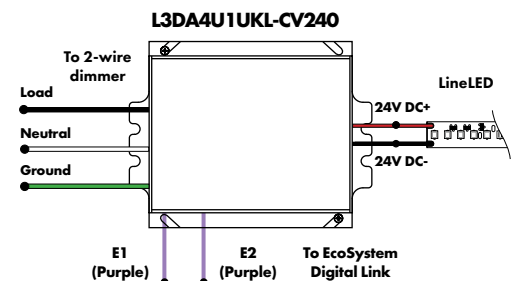

Luminii is a Lutron OEM Advantage Partner

Lutron Power Supplies 0.1%

MODEL
L3D0-96W24V-U

HiLume™ 0.1% EcoSystem Voltage LED Driver with Soft-On, Fade-to-Black™
96W max

MODELS	L3D0
Length	10.50"
Width	5.50"
Depth	2.00"

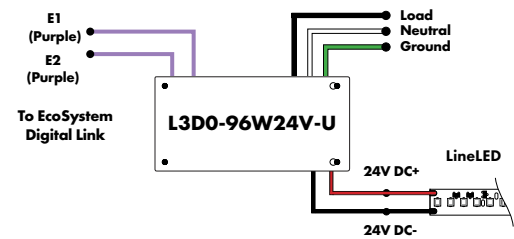

In-Ground Power Supplies

MODEL	POWER	OUTPUT	INPUT
IG - In ground CVE Series CVE - ELV Dimming DALI - eldoLED Dali dimming Both dims down to 0%	96X2 - 2 X 96 Watt	24 - 24 VDC	Blank - 120 V 277 - 240/277 V

MODELS	Dual Circuit
Length	8.40"
Width	8.30"
Depth	8.10"

