

Features

Kurba Large is a UL676 Pool Rated light strip with a sleek, direct view profile. Suitable for submersion max 6 ft deep and capable of horizontal/side and vertical/top bends up to 6" radius. Built with robust factory made power feeds or end caps using UL676 Pool Rated SJTV cabling, Kurba Large Pool Rated mounts to a specifically designed thick plastic channel.

Applications

Indoor/Outdoor wet & submerged location

Average Life (L70)

50,000 hours

Materials

PVC Material for high chlorine resistance

Approvals

24VDC Class 2 wet listed, IP68

Dimming

Dimable down to 1%. Dot Free even illumination. Also available with Black Lens

Warranty

3 years

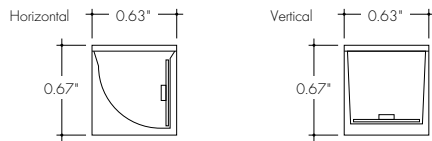

Finish Options (see page 2 for additional information)

Base White

Premium Black Red Green Blue



Technical Information

Bending Direction	Horizontal		Vertical		CCT INFO / LUMEN MULTIPLIER	
	Output	33MO	38HO (Black Lens only)	33MO	38MO (Black Lens only)	Color Temperature
Light Output at 3000K	162 lm/ft	45 lm/ft	183 lm/ft	57 lm/ft	2200K	0.83
Average Power Consumption at 4'	3.66 W/ft	4.57 W/ft	3.66 W/ft	3.66 W/ft	2400K	0.97
Efficacy	44 lm/W	10 lm/W	50 lm/W	16 lm/W	2700K	1.00
Ordering Increment	2.19"	2.19"	2.19"	2.19"	3000K	1.00
Maximum Run Length (In Series)	26'	19'	26'	26'	3500K	1.01
Operating Temperature Range	-40°F to 131°F	-40°F to 113°F	-40°F to 131°F	-40°F to 131°F	4000K	0.99

Note: 80 CRI

Constraints

Horizontal Bend Direction

Bend LED in these positions only to avoid damage

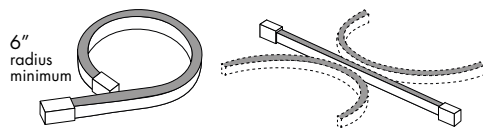

Illuminated surface shown in gray

Horizontal Prohibited Bends

Twisting or bending LED in these positions will cause damage

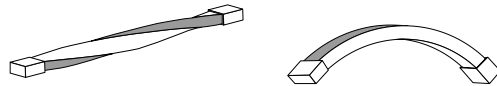

Illuminated surface shown in gray

Do not make sharp bends near the endcap

Vertical Bend Direction

Bend LED in these positions only to avoid damage

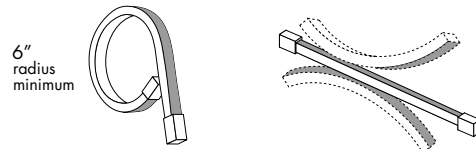

Illuminated surface shown in gray

Vertical Prohibited Bends

Twisting or bending LED in these positions will cause damage

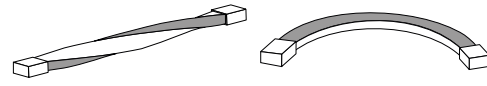

Illuminated surface shown in gray

Do not make sharp bends near the endcap

Ordering Code

MODEL	RATING ¹	BEND DIRECTION	LENGTH	OUTPUT ^{1,2}	CCT	LENS	MOUNTING	FINISH	FEED POSITION LEFT	FEED POSITION RIGHT
KBL-Kurba Large	P-Pool	HB-Horizontal Bending VB-Vertical Bending	SEE PCC CHART ON PAGES 5 - 7	33MO-Medium 38MO-Medium 38HO-High	22K-2200K 24K-2400K 27K-2700K 30K-3000K 35K-3500K 40K-4000K	F-Frosted BL-Black lens	NA-See Page 4 for orderable mounting accessories	WH-White BK-Black RED-Red GRN-Green BLU-Blue BK-Black	INJECTION MOLD IME-End Feed 1 IMB-Back Feed 1 IMSA-Side 1 Feed IMSB-Side 2 Feed ³ NPF-No Power Feed ⁴	INJECTION MOLD IME-End Feed 1 IMB-Back Feed 1 IMSA-Side 1 Feed IMSB-Side 2 Feed ³ NPF-No Power Feed ⁴
									Feeds come with 90" wire leads	

1 - Title 24 JA8 compliant depending on Output, CCT, and Lens selections. See Technical Information and Lens Transmission charts to calculate specific efficacies.
2 - 38MO Not Available for Horizontal Bending, 38HO Not Available for Vertical Bending

3 - IMSB - Side 2 Feed not available with HB - Horizontal Bending
4 - NPF-NPF for Feed Position 1&2 is not a valid configuration option

Powerfeeds and Connectors

Power Feed Position Options and Orientation

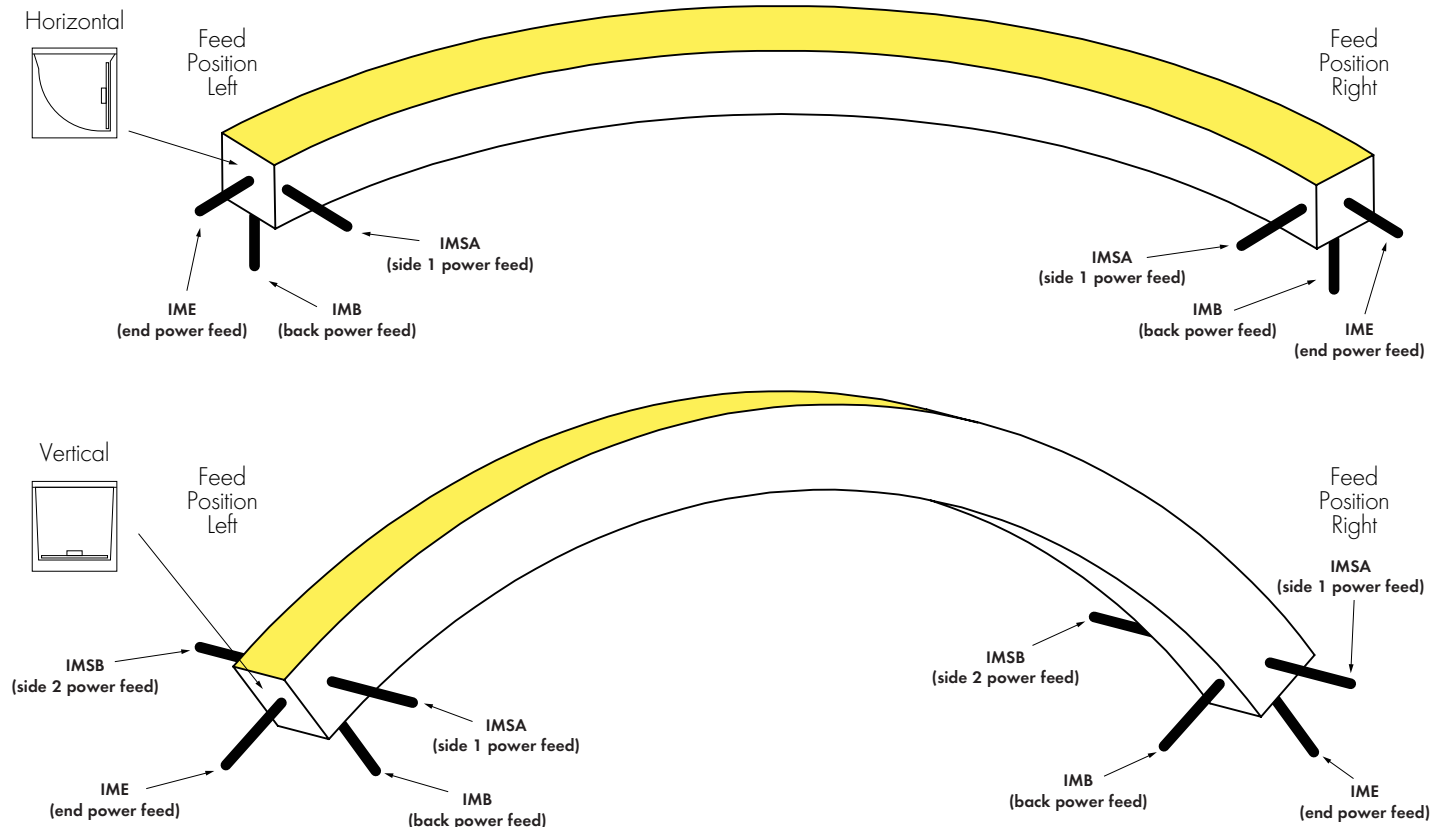

NOTE: IMSB - Side 2 Feed not available with HB - Horizontal Bending

Linking and Extension Cable Options

END CONNECTOR

Injection-molded End Connector
-IME

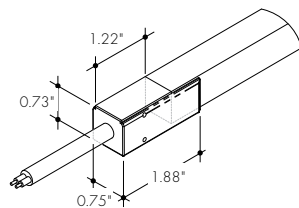

BACK CONNECTOR

Injection-molded Back Connector
-IMB

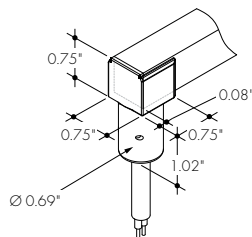

SIDE CONNECTOR

Injection-molded Side Connector
-MSA and -MSB

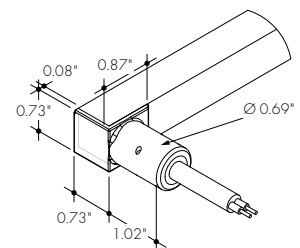

ENDCAP (NO CONNECTOR)

Injection-molded Cap (No Connector)
-NPF

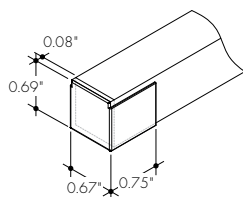

ANTI-WICKING FERRULE

Included on every power feed wire

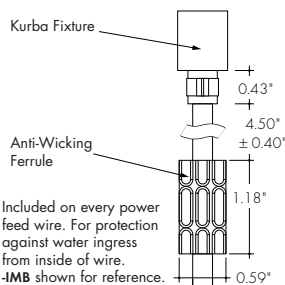

Product Dimensions

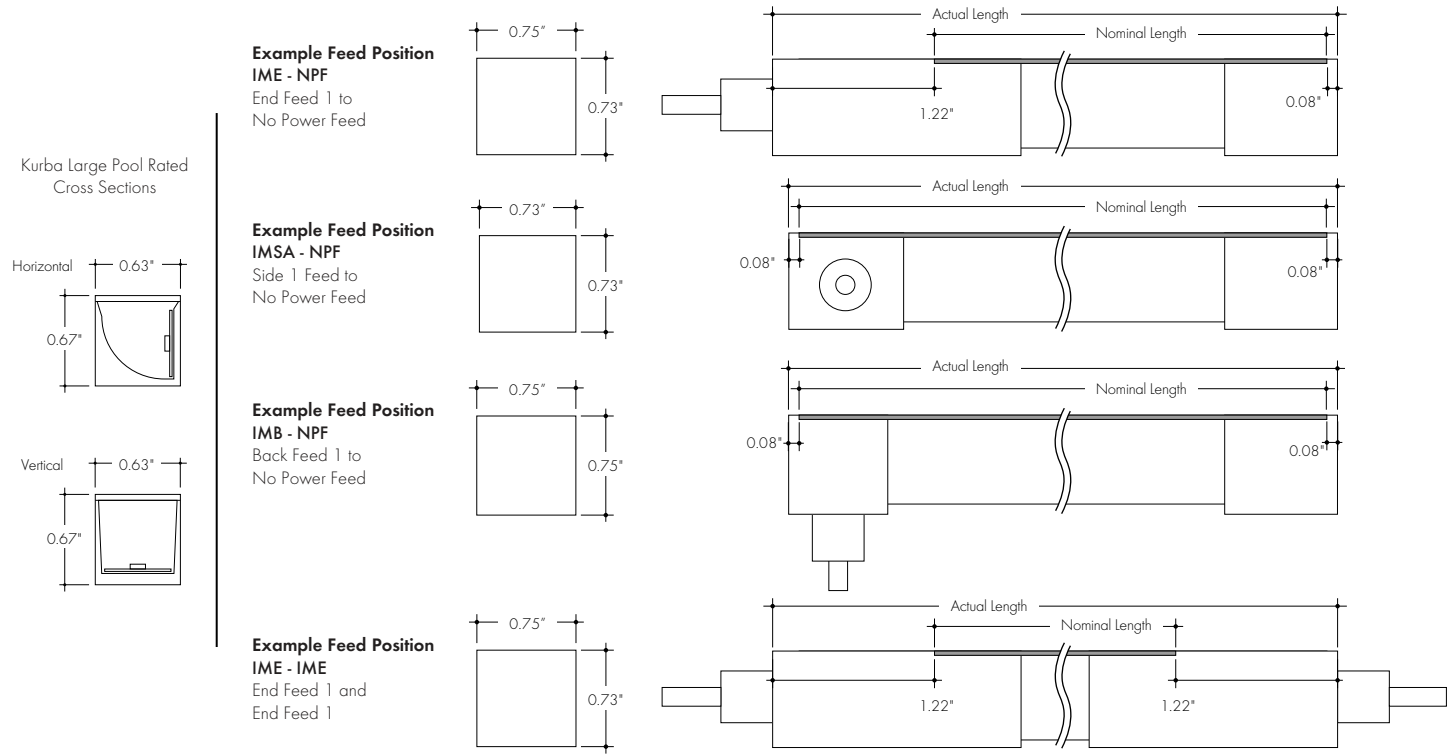

Finish Options

- A wide variety of finish options allowing complete customization of style and aesthetic.



Kurba's base finish is a crisp white which brings a timeless, clean aesthetic that brightens and enhances any space.



Also available with a blackout aesthetic - the Black Lens paired with the Black Finish provides for a sleek, all black profile that keeps the strip concealed in the off-state.

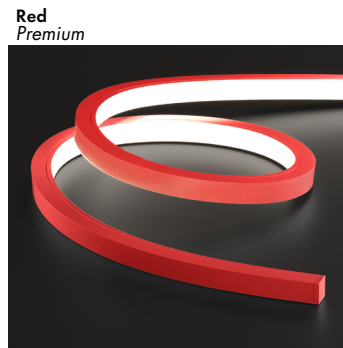

Red adds a bright and bold statement, perfect for creating a striking and dynamic ambiance with its vibrancy.

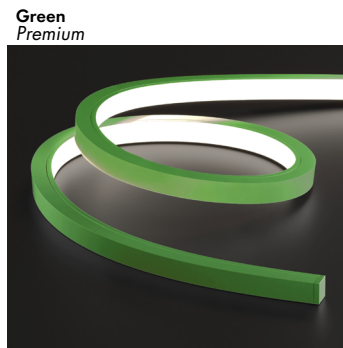

Green embraces a refreshing and natural feel, reminiscent of emerald green, add touch of tranquility and harmony to your space with this option.

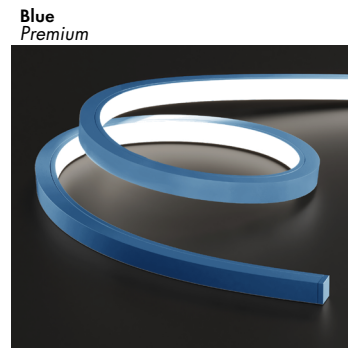

Blue evokes the serenity of the deep sea by combining vivid cobalt and azure tones.

Light Transmission and Dotting

Output Options	Lens/Accessory					
	Silicone Frosted/ White Finish	Silicone Frosted/ Red Finish	Silicone Frosted/ Green Finish	Silicone Frosted/ Blue Finish	Silicone Frosted/ Black Finish	Black Lens/ Black Finish
33MO	ND	ND	ND	ND	ND	N/A
38MO	N/A	N/A	N/A	N/A	N/A	ND
38HO	N/A	N/A	N/A	N/A	N/A	ND
Transmission Percentage	100%	80%	80%	80%	80%	17%

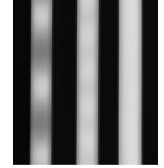

CD - Clear Dotting
SD - Slight Dotting
ND - No Dotting

Mounting Accessories and Optional Connectors

MC-NFP-KBL-78

Thickened Plastic Mounting Channel for underwater application, 78"

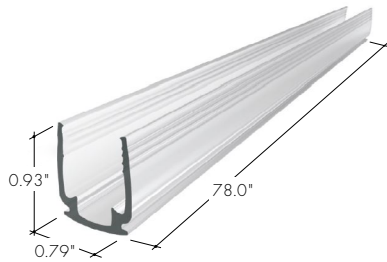

MC-KBL-BANP-3D-SM-78-XX

KBL Mounting Channel, Bendable Anole Profile, 3D Bending, Surface Mount, 78in,

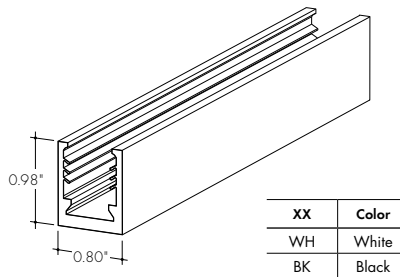

LVSP-WET

Splice box: wet rated, low voltage, gray

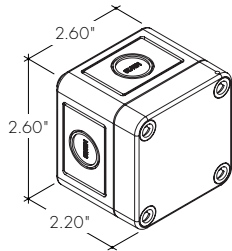

LVSP-WET-CM

Connector for splice box, low voltage for cable management, gray

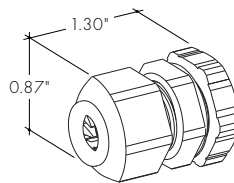

Photometry

KBL-PL-HB-48-33MO-30K-SF-NA-WH

Kurba Large Pool, Horizontal Bend, 4ft, 3000K, 33MO, Silicone Frosted Lens

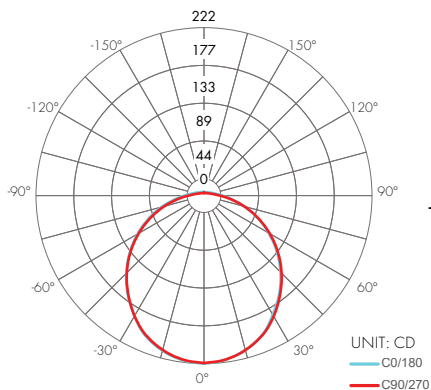

Zonal Lumen Summary 3000K

Zone	Lumen	% Fixture
0-30	171	26.3%
0-40	234	36.2%
0-60	495	76.4%
0-90	644	99.4%
0-180	648	100.0%



KBL-PL-VB-48-33MO-30K-SF-NA-WH

Kurba Large Pool, Vertical Bend, 4ft, 3000K, 33MO, Silicone Frosted Lens

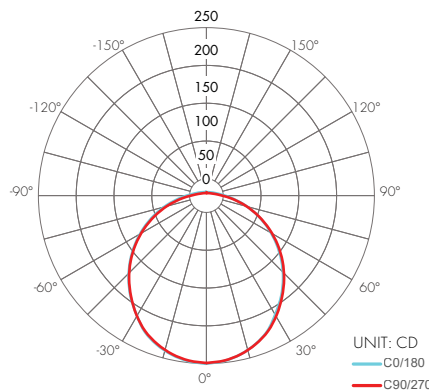

Zonal Lumen Summary 3000K

Zone	Lumen	% Fixture
0-30	193	26.3%
0-40	265	36.2%
0-60	557	76.1%
0-90	725	99.0%
0-180	732	100.0%



38MO (Vertical Only) | Power Consumption Per Fixture Length

Based on operation with PDCU series of power supplies. Use Actual Length for Order Code Entry.
 Tolerance for Actual Lengths less than 6 ft is +/- 0.2", Actual Lengths between 6 ft and 16 ft is +/- 0.3", and Actual Lengths greater than 16 ft is +/- 0.6"
 A - End Connector at both ends of Kurba (1.22" + 1.22" added to overall length)
 B - End Connector at one end of Kurba and No Connector or Back Connector or Side Connector at other end of Kurba (1.22" + 0.08" added to overall length)
 C - Any combination of No Connector, Back Connector, or Side Connector on each end of Kurba (0.08" + 0.08" added to overall length)

Nominal Length (in)	Actual Length (in)				Nominal Length (in)	Actual Length (in)				Nominal Length (in)	Actual Length (in)				Nominal Length (in)	Actual Length (in)			
	W	A	B	C		W	A	B	C		W	A	B	C		W	A	B	C
7	2.7	9.0	7.9	6.7	86	26.8	87.7	86.6	85.5	165	50.8	166.5	165.4	164.2	243	74.8	245.2	244.1	243.0
9	3.4	11.2	10.0	8.9	88	27.4	89.9	88.8	87.7	167	51.4	168.7	167.5	166.4	246	75.4	247.4	246.3	245.1
(1 ft) 11	4.1	13.4	12.2	11.1	90	28.1	92.1	91.0	89.8	(14 ft) 169	52.1	170.9	169.7	168.6	248	76.1	249.6	248.5	247.3
14	4.7	15.6	14.4	13.3	92	28.8	94.3	93.2	92.0	171	52.8	173.1	171.9	170.8	250	76.8	251.8	250.7	249.5
16	5.4	17.8	16.6	15.5	95	29.4	96.5	95.4	94.2	173	53.4	175.2	174.1	173.0	(21 ft) 252	77.4	254.0	252.9	251.7
18	6.1	19.9	18.8	17.7	(8 ft) 97	30.1	98.7	97.5	96.4	176	54.1	177.4	176.3	175.2	254	78.1	256.2	255.0	253.9
20	6.7	22.1	21.0	19.8	99	30.8	100.9	99.7	98.6	178	54.8	179.6	178.5	177.3	257	78.8	258.4	257.2	256.1
22	7.4	24.3	23.2	22.0	101	31.4	103.1	101.9	100.8	(15 ft) 180	55.4	181.8	180.7	179.5	259	79.4	260.6	259.4	258.3
(2 ft) 24	8.1	26.5	25.4	24.2	103	32.1	105.2	104.1	103.0	182	56.1	184.0	182.9	181.7	261	80.1	262.7	261.6	260.5
27	8.7	28.7	27.5	26.4	106	32.8	107.4	106.3	105.2	184	56.8	186.2	185.0	183.9	(22 ft) 263	80.8	264.9	263.8	262.6
29	9.4	30.9	29.7	28.6	(9 ft) 108	33.4	109.6	108.5	107.3	187	57.4	188.4	187.2	186.1	265	81.4	267.1	266.0	264.8
31	10.1	33.1	31.9	30.8	110	34.1	111.8	110.7	109.5	189	58.1	190.6	189.4	188.3	268	82.1	269.3	268.2	267.0
33	10.7	35.3	34.1	33.0	112	34.8	114.0	112.9	111.7	(16 ft) 191	58.8	192.7	191.6	190.5	270	82.8	271.5	270.4	269.2
(3 ft) 35	11.4	37.4	36.3	35.2	114	35.4	116.2	115.0	113.9	193	59.4	194.9	193.8	192.7	272	83.4	273.7	272.5	271.4
38	12.1	39.6	38.5	37.3	116	36.1	118.4	117.2	116.1	195	60.1	197.1	196.0	194.8	274	84.1	275.9	274.7	273.6
40	12.7	41.8	40.7	39.5	119	36.8	120.6	119.4	118.3	198	60.8	199.3	198.2	197.0	(23 ft) 276	84.8	278.1	276.9	275.8
42	13.4	44.0	42.9	41.7	(10 ft) 121	37.4	122.7	121.6	120.5	200	61.4	201.5	200.4	199.2	279	85.4	280.2	279.1	278.0
44	14.1	46.2	45.0	43.9	123	38.1	124.9	123.8	122.7	202	62.1	203.7	202.5	201.4	281	86.1	282.4	281.3	280.1
46	14.7	48.4	47.2	46.1	125	38.8	127.1	126.0	124.8	(17 ft) 204	62.8	205.9	204.7	203.6	283	86.8	284.6	283.5	282.3
(4 ft) 49	15.4	50.6	49.4	48.3	127	39.4	129.3	128.2	127.0	206	63.4	208.1	206.9	205.8	285	87.4	286.8	285.7	284.5
51	16.1	52.8	51.6	50.5	130	40.1	131.5	130.4	129.2	208	64.1	210.2	209.1	208.0	(24 ft) 287	88.1	289.0	287.8	286.7
53	16.7	54.9	53.8	52.7	(11 ft) 132	40.8	133.7	132.5	131.4	211	64.8	212.4	211.3	210.2	289	88.8	291.2	290.0	288.9
55	17.4	57.1	56.0	54.8	134	41.4	135.9	134.7	133.6	213	65.4	214.6	213.5	212.3	292	89.4	293.4	292.2	291.1
57	18.1	59.3	58.2	57.0	136	42.1	138.1	136.9	135.8	(18 ft) 215	66.1	216.8	215.7	214.5	294	90.1	295.6	294.4	293.3
(5 ft) 60	18.7	61.5	60.4	59.2	138	42.8	140.2	139.1	138.0	217	66.8	219.0	217.9	216.7	296	90.8	297.7	296.6	295.5
62	19.4	63.7	62.5	61.4	141	43.4	142.4	141.3	140.2	219	67.4	221.2	220.0	218.9	298	91.4	299.9	298.8	297.6
64	20.1	65.9	64.7	63.6	143	44.1	144.6	143.5	142.3	222	68.1	223.4	222.2	221.1	(25 ft) 300	92.1	302.1	301.0	299.8
66	20.8	68.1	66.9	65.8	(12 ft) 145	44.8	146.8	145.7	144.5	224	68.8	225.6	224.4	223.3	302	92.8	304.3	303.2	302.0
68	21.4	70.2	69.1	68.0	147	45.4	149.0	147.9	146.7	226	69.4	227.7	226.6	225.5	304	93.4	306.5	305.3	304.2
70	22.1	72.4	71.3	70.2	149	46.1	151.2	150.0	148.9	(19 ft) 228	70.1	229.9	228.8	227.6	307	94.1	308.7	307.5	306.4
(6 ft) 73	22.8	74.6	73.5	72.3	152	46.8	153.4	152.2	151.1	230	70.8	232.1	231.0	229.8	309	94.8	310.9	309.7	308.6
75	23.4	76.8	75.7	74.5	154	47.4	155.6	154.4	153.3	233	71.4	234.3	233.2	232.0	(26 ft) 311	95.4	313.1	311.9	310.8
77	24.1	79.0	77.9	76.7	(13 ft) 156	48.1	157.7	156.6	155.5	235	72.1	236.5	235.4	234.2					
80	24.8	81.2	80.0	78.9	158	48.8	159.9	158.8	157.7	237	72.8	238.7	237.5	236.4					
81	25.4	83.4	82.2	81.1	160	49.4	162.1	161.0	159.8	(20 ft) 239	73.4	240.9	239.7	238.6					
(7 ft) 84	26.1	85.6	84.4	83.3	162	50.1	164.3	163.2	162.0	241	74.1	243.1	241.9	240.8					

Note: all values are rounded to the nearest 0.1 inch

Injection Molded End Cap (IME)

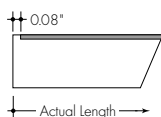

Injection Molded End Power Feed (IME)

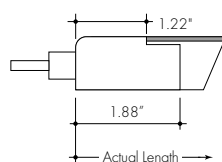

Injection Molded Bottom Power Feed (IMB)

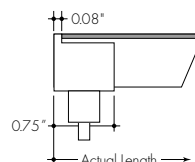

Injection Molded Side Power Feed (IMSA)

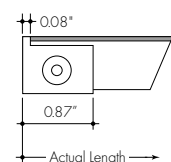

38HO (Horizontal Only) | Power Consumption Per Fixture Length

Based on operation with PDCU series of power supplies. Use Actual Length for Order Code Entry.
 Tolerance for Actual Lengths less than 6 ft is +/- 0.2", Actual Lengths between 6 ft and 16 ft is +/- 0.3", and Actual Lengths greater than 16 ft is +/- 0.6"
 A - End Connector at both ends of Kurba (1.22" + 1.22" added to overall length)
 B - End Connector at one end of Kurba and No Connector or Back Connector or Side Connector or Side Connector at other end of Kurba (1.22" + 0.08" added to overall length)
 C - Any combination of No Connector, Back Connector, or Side Connector on each end of Kurba (0.08" + 0.08" added to overall length)

Nominal Length (in)	Actual Length (in)				Nominal Length (in)	Actual Length (in)				Nominal Length (in)	Actual Length (in)			
	W	A	B	C		W	A	B	C		W	A	B	C
7	3.4	9.0	7.9	6.7	86	33.4	87.7	86.6	85.5	165	63.5	166.5	165.4	164.2
9	4.3	11.2	10.0	8.9	88	34.3	89.9	88.8	87.7	167	64.3	168.7	167.5	166.4
(1 ft) 11	5.1	13.4	12.2	11.1	90	35.1	92.1	91.0	89.8	(14 ft) 169	65.1	170.9	169.7	168.6
14	5.9	15.6	14.4	13.3	92	35.9	94.3	93.2	92.0	171	66.0	173.1	171.9	170.8
16	6.8	17.8	16.6	15.5	95	36.8	96.5	95.4	94.2	173	66.8	175.2	174.1	173.0
18	7.6	19.9	18.8	17.7	(8 ft) 97	37.6	98.7	97.5	96.4	176	67.6	177.4	176.3	175.2
20	8.4	22.1	21.0	19.8	99	38.4	100.9	99.7	98.6	178	68.5	179.6	178.5	177.3
22	9.3	24.3	23.2	22.0	101	39.3	103.1	101.9	100.8	(15 ft) 180	69.3	181.8	180.7	179.5
(2 ft) 24	10.1	26.5	25.4	24.2	103	40.1	105.2	104.1	103.0	182	70.1	184.0	182.9	181.7
27	10.9	28.7	27.5	26.4	106	40.9	107.4	106.3	105.2	184	71.0	186.2	185.0	183.9
29	11.8	30.9	29.7	28.6	(9 ft) 108	41.8	109.6	108.5	107.3	187	71.8	188.4	187.2	186.1
31	12.6	33.1	31.9	30.8	110	42.6	111.8	110.7	109.5	189	72.6	190.6	189.4	188.3
33	13.4	35.3	34.1	33.0	112	43.4	114.0	112.9	111.7	(16 ft) 191	73.5	192.7	191.6	190.5
(3 ft) 35	14.3	37.4	36.3	35.2	114	44.3	116.2	115.0	113.9	193	74.3	194.9	193.8	192.7
38	15.1	39.6	38.5	37.3	116	45.1	118.4	117.2	116.1	195	75.1	197.1	196.0	194.8
40	15.9	41.8	40.7	39.5	119	45.9	120.6	119.4	118.3	198	76.0	199.3	198.2	197.0
42	16.8	44.0	42.9	41.7	(10 ft) 121	46.8	122.7	121.6	120.5	200	76.8	201.5	200.4	199.2
44	17.6	46.2	45.0	43.9	123	47.6	124.9	123.8	122.7	202	77.6	203.7	202.5	201.4
46	18.4	48.4	47.2	46.1	125	48.4	127.1	126.0	124.8	(17 ft) 204	78.5	205.9	204.7	203.6
(4 ft) 49	19.3	50.6	49.4	48.3	127	49.3	129.3	128.2	127.0	206	79.3	208.1	206.9	205.8
51	20.1	52.8	51.6	50.5	130	50.1	131.5	130.4	129.2	208	80.1	210.2	209.1	208.0
53	20.9	54.9	53.8	52.7	(11 ft) 132	50.9	133.7	132.5	131.4	211	81.0	212.4	211.3	210.2
55	21.8	57.1	56.0	54.8	134	51.8	135.9	134.7	133.6	213	81.8	214.6	213.5	212.3
57	22.6	59.3	58.2	57.0	136	52.6	138.1	136.9	135.8	(18 ft) 215	82.6	216.8	215.7	214.5
(5 ft) 60	23.4	61.5	60.4	59.2	138	53.4	140.2	139.1	138.0	217	83.5	219.0	217.9	216.7
62	24.3	63.7	62.5	61.4	141	54.3	142.4	141.3	140.2	219	84.3	221.2	220.0	218.9
64	25.1	65.9	64.7	63.6	143	55.1	144.6	143.5	142.3	222	85.1	223.4	222.2	221.1
66	25.9	68.1	66.9	65.8	(12 ft) 145	55.9	146.8	145.7	144.5	224	86.0	225.6	224.4	223.3
68	26.8	70.2	69.1	68.0	147	56.8	149.0	147.9	146.7	226	86.8	227.7	226.6	225.5
70	27.6	72.4	71.3	70.2	149	57.6	151.2	150.0	148.9	(19 ft) 228	87.6	229.9	228.8	227.6
(6 ft) 73	28.4	74.6	73.5	72.3	152	58.4	153.4	152.2	151.1					
75	29.3	76.8	75.7	74.5	154	59.3	155.6	154.4	153.3					
77	30.1	79.0	77.9	76.7	(13 ft) 156	60.1	157.7	156.6	155.5					
80	30.9	81.2	80.0	78.9	158	61.0	159.9	158.8	157.7					
81	31.8	83.4	82.2	81.1	160	61.8	162.1	161.0	159.8					
(7 ft) 84	32.6	85.6	84.4	83.3	162	62.6	164.3	163.2	162.0					

Note: all values are rounded to the nearest 0.1 inch

Injection Molded End Cap (IME)

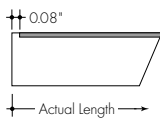

Injection Molded End Power Feed (IME)

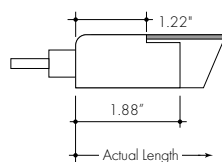

Injection Molded Bottom Power Feed (IMB)

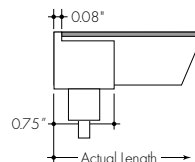

Injection Molded Side Power Feed (IMSA)

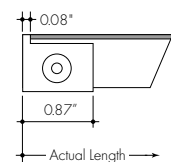

Power Supplies

See Power Supply instructions and spec sheet for wiring information. For a complete list of compatible dimmers, see Compatible Dimming Chart on the Resources page.

Universal Power Supply 1% 120VAC - 277VAC

MODEL	INPUT CONTROL	ENVIRONMENT	POWER	OUTPUT
PS - Pool & Spa Rated Power Supply	UNI - 0-10V, Phase Dimming	PR - Pool Rated	96 - 96 W	24 - 24 VDC

0-10V dims down to 1%, MLV/ELV/TRIAC dims down to 1%.
 For a complete list of compatible dimmers, see [Compatible Dimming Chart](#) on the Resources page.

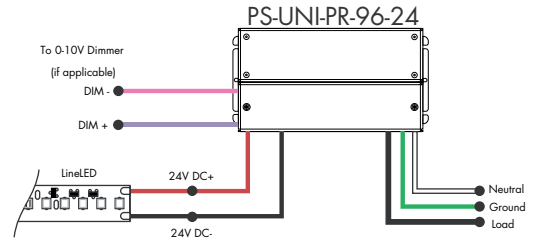

MODELS	PS-UNI-PR-96-24
Length	8.71"
Width	4.56"
Depth	1.86"