

Features

Kurba Large is a dot free direct view, highly versatile, energy efficient and flexible LED strip. Suitable for submersion max 6 ft deep and capable of horizontal/side bends and vertical/top bends with a 6" bending radius.

Output Option

• Smart Pixel offerings allow for infinite color combinations with cascading and chasing effects

Average Life

50,000 hours

Approvals

24VDC Class 2 wet listed, IP68

Warranty

3 years

Materials

PVC Material for high chlorine resistance

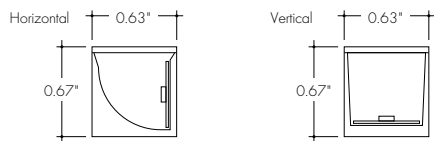

Finish Options (see page 2 for additional information)

Base White

Premium Black Red Green Blue



Technical Information

| Bending Direction | Horizontal | Vertical |
|---------------------------------|-----------------------|-----------------------|
| Output | SPI26SO | SPI26SO |
| Light Output at 3000K | 242 lm/ft | 286 lm/ft |
| Average Power Consumption at 4' | 6.71 W/ft | 6.71 W/ft |
| Efficacy | 36 lm/W | 43 lm/W |
| Ordering Increment | 3.28" | 3.28" |
| Maximum Run Length (In Series) | 13' | 13' |
| Operating Temperature Range | -40°F to 113°F | -40°F to 113°F |
| Control/Dimming Protocol | SPI Protocol UCS 2904 | SPI Protocol UCS 2904 |

Constraints

Horizontal Bend Direction

Bend LED in these positions only to avoid damage

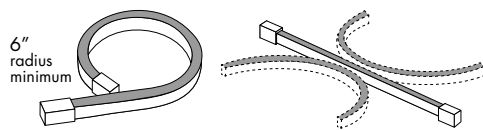

Illuminated surface shown in gray

Horizontal Prohibited Bends

Twisting or bending LED in these positions will cause damage

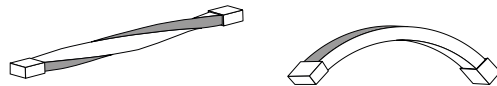

Illuminated surface shown in gray

Do not make sharp bends near the endcap

Vertical Bend Direction

Bend LED in these positions only to avoid damage

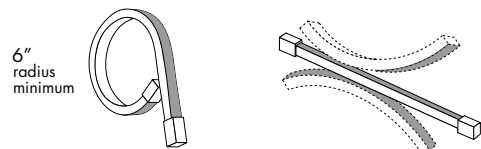

Illuminated surface shown in gray

Vertical Prohibited Bends

Twisting or bending LED in these positions will cause damage

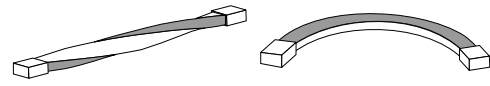

Illuminated surface shown in gray

Do not make sharp bends near the endcap

Ordering Code

| MODEL | RATING | BEND DIRECTION | LENGTH | OUTPUT ² | CCT ¹ | LENS ² | MOUNTING | FINISH | FEED POSITION LEFT | FEED POSITION RIGHT |
|-------------------|----------|--|-------------------------|--|--|--------------------------------|--|--|--|--|
| KBL - Kurba Large | P - Pool | HB - Horizontal Bending VB - Vertical Bending | SEE PCC CHART ON PAGE 5 | SPI26SO - Smart Pixel Control, Standard Output | RGB26K - RGB 2600K RGB27K - RGB 2700K RGB30K - RGB 3000K RGB40K - RGB 4000K | F - Frosted BL - Black lens | NA - See Page 4 for orderable mounting accessories | WH - White BK - Black RED - Red GRN - Green BLU - Blue | INJECTION MOLD IME - End Feed 1 IMB - Back Feed 1 IMSA - Side 1 Feed IMSB - Side 2 Feed ³ NPF - No Power Feed ⁴ | INJECTION MOLD IME - End Feed 1 IMB - Back Feed 1 IMSA - Side 1 Feed IMSB - Side 2 Feed ³ NPF - No Power Feed ⁴ |

1 - BL - Black lens only available with RGB26K - RGB26K CCT
2 - BL - Black lens can only be used with BK - Black Finish

3 - IMSB - Side 2 Feed not available with HB - Horizontal Bending
4 - NPF-NPF for Feed Position 1&2 is not a valid configuration option

Feeds come with 90° wire leads

Powerfeeds and Connectors

Power Feed Position Options and Orientation

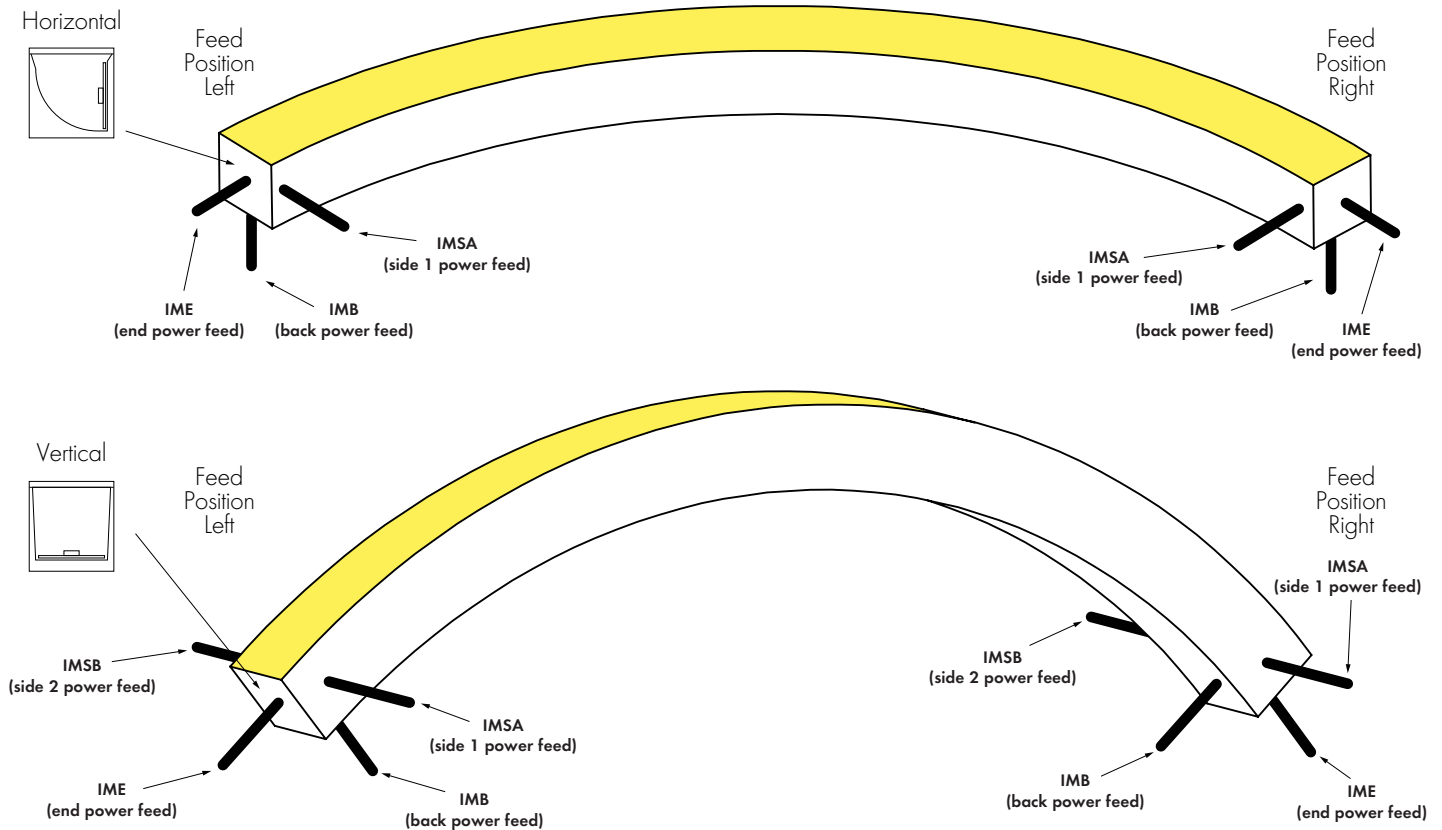

NOTE: IMSB - Side 2 Feed not available with HB - Horizontal Bending

Linking and Extension Cable Options

END CONNECTOR

Injection-molded End Connector
-IME

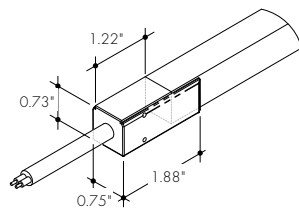

BACK CONNECTOR

Injection-molded Back Connector
-IMB

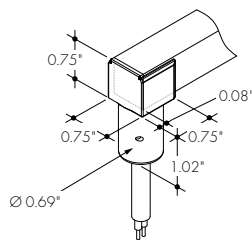

SIDE CONNECTOR

Injection-molded Side Connector
-IMSA and -IMSB

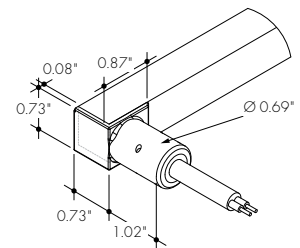

ENDCAP (NO CONNECTOR)

Injection-molded Cap (No Connector)
-NPF

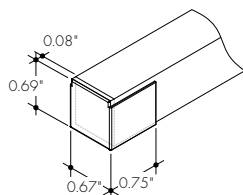

ANTI-WICKING FERRULE

Included on every power feed wire

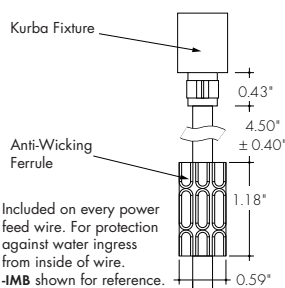

Product Dimensions

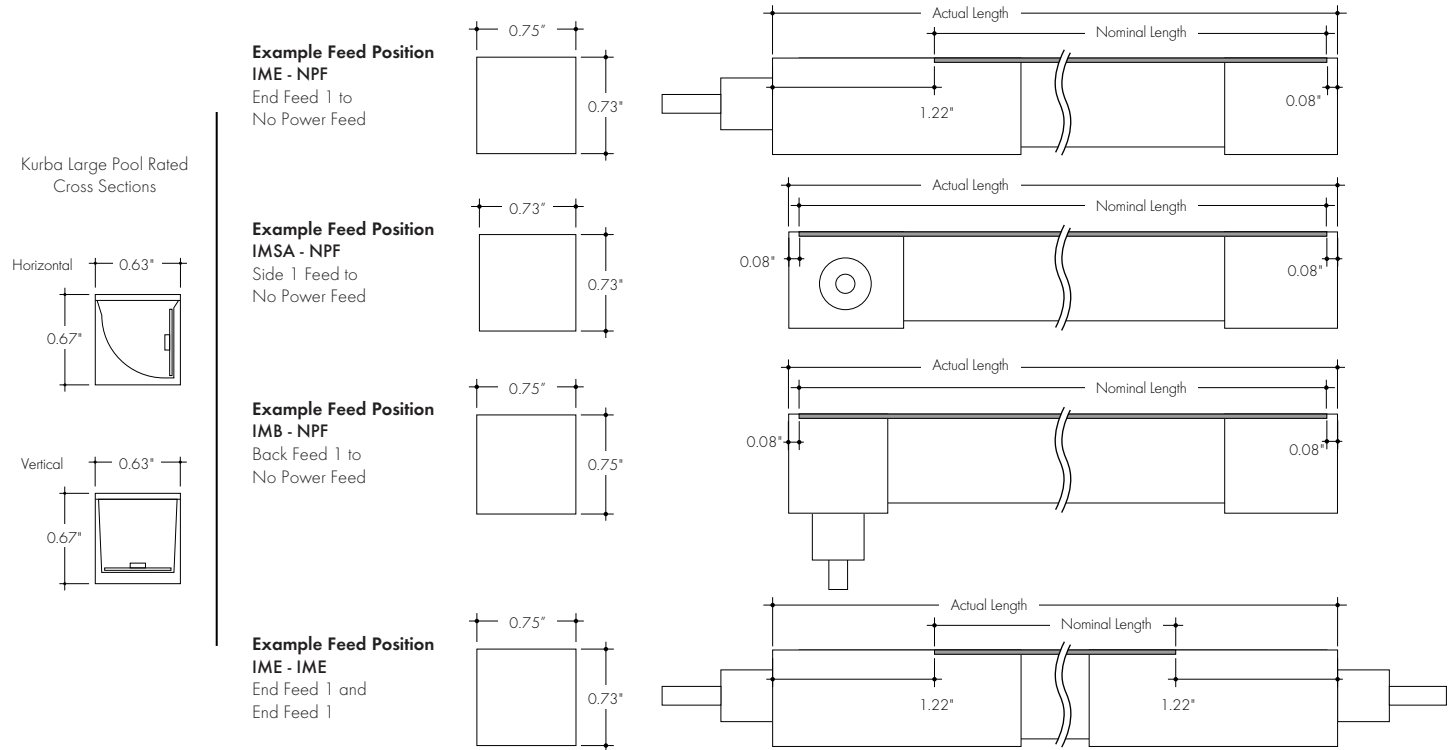

Finish Options

- A wide variety of finish options allowing complete customization of style and aesthetic.



Kurba's base finish is a crisp white which brings a timeless, clean aesthetic that brightens and enhances any space.



Also available with a blackout aesthetic - the Black Lens paired with the Black Finish provides for a sleek, all black profile that keeps the strip concealed in the off-state.

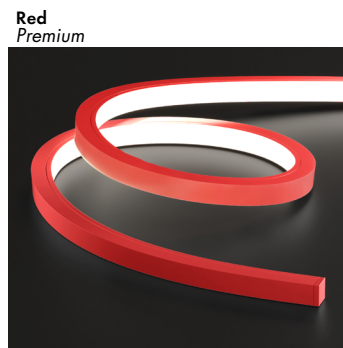

Red adds a bright and bold statement, perfect for creating a striking and dynamic ambiance with its vibrancy.

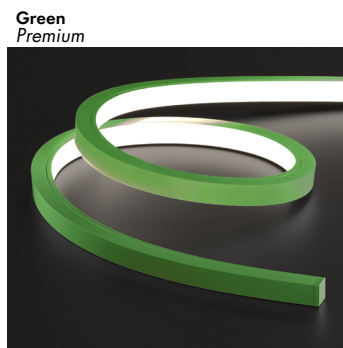

Green embraces a refreshing and natural feel, reminiscent of emerald green, add touch of tranquility and harmony to your space with this option.

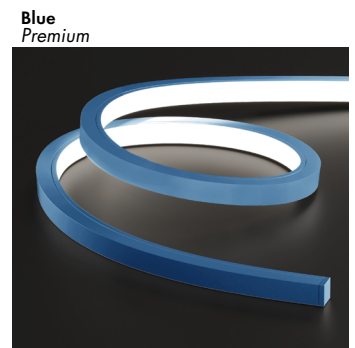

Blue evokes the serenity of the deep sea by combining vivid cobalt and azure tones.

Light Transmission and Dotting

| Output Options | Lens/Accessory | | | | | |
|-------------------------|-----------------------------------|---------------------------------|-----------------------------------|----------------------------------|-----------------------------------|-----------------------------|
| | Silicone Frosted/ White Finish | Silicone Frosted/ Red Finish | Silicone Frosted/ Green Finish | Silicone Frosted/ Blue Finish | Silicone Frosted/ Black Finish | Black Lens/ Black Finish |
| SPI26SO | ND | ND | ND | ND | ND | ND |
| Transmission Percentage | 100% | 80% | 80% | 80% | 80% | 17% |

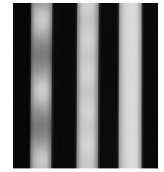

CD SD ND
CD - Clear Dotting
SD - Slight Dotting
ND - No Dotting

Mounting Accessories and Optional Connectors

MC-NFP-KBL-78

Thickened Plastic Mounting Channel for underwater application, 78"

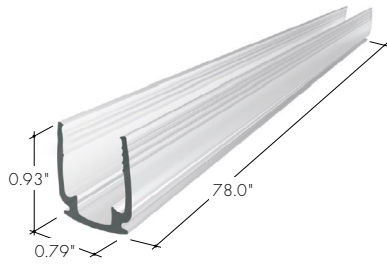

MC-KBL-BANP-3D-SM-78-XX

KBL Mounting Channel, Bendable Anole Profile, 3D Bending, Surface Mount, 78in,

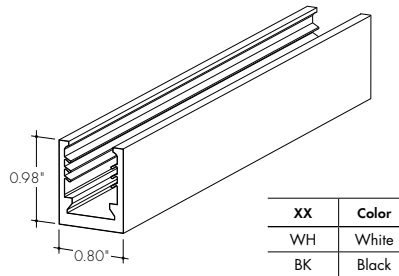

LVSP-WET

Splice box: wet rated, low voltage, gray

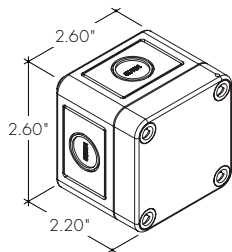

LVSP-WET-CM

Connector for splice box, low voltage for cable management, gray

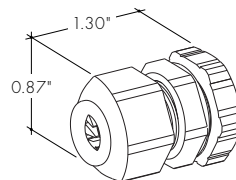

SPI26SO | Power Consumption Per Fixture Length

Based on operation with PDCU series of power supplies. Use Actual Length for Order Code Entry.
 Tolerance for Actual Lengths less than 6 ft is +/- 0.2", Actual Lengths between 6 ft and 16 ft is +/- 0.3", and Actual Lengths greater than 16 ft is +/- 0.6"
 A - End Connector at both ends of Kurba (1.22" + 1.22" added to overall length)
 B - End Connector at one end of Kurba and No Connector or Back Connector or Side Connector at other end of Kurba (1.22" + 0.08" added to overall length)
 C - Any combination of No Connector, Back Connector, or Side Connector on each end of Kurba (0.08" + 0.08" added to overall length)

| Nominal Length (in) | Actual Length (in) | | | | Nominal Length (in) | Actual Length (in) | | | |
|---------------------|--------------------|-------|-------|-------|---------------------|--------------------|-------|-------|-------|
| | W | A | B | C | | W | A | B | C |
| 7 | 5.0 | 9.0 | 7.9 | 6.7 | 125 | 63.9 | 127.1 | 126.0 | 124.8 |
| 10 | 6.9 | 12.3 | 11.1 | 10.0 | 128 | 65.6 | 130.4 | 129.2 | 128.1 |
| (1 ft) 14 | 8.7 | 15.6 | 14.4 | 13.3 | (11 ft) 132 | 67.2 | 133.7 | 132.5 | 131.4 |
| 17 | 10.5 | 18.8 | 17.7 | 16.6 | 135 | 68.9 | 136.9 | 135.8 | 134.7 |
| 20 | 12.4 | 22.1 | 21.0 | 19.8 | 138 | 70.5 | 140.2 | 139.1 | 137.9 |
| (2 ft) 23 | 14.2 | 25.4 | 24.3 | 23.1 | 141 | 72.2 | 143.5 | 142.4 | 141.2 |
| 27 | 16.0 | 28.7 | 27.5 | 26.4 | (12 ft) 145 | 73.8 | 146.8 | 145.7 | 144.5 |
| 30 | 17.9 | 32.0 | 30.8 | 29.7 | 148 | 75.5 | 150.1 | 148.9 | 147.8 |
| 33 | 19.7 | 35.2 | 34.1 | 33.0 | 151 | 77.1 | 153.4 | 152.2 | 151.1 |
| (3 ft) 36 | 21.5 | 38.5 | 37.4 | 36.2 | (13 ft) 155 | 78.8 | 156.6 | 155.5 | 154.4 |
| 40 | 23.4 | 41.8 | 40.7 | 39.5 | | | | | |
| 43 | 25.2 | 45.1 | 43.9 | 42.8 | | | | | |
| 46 | 27.0 | 48.4 | 47.2 | 46.1 | | | | | |
| (4 ft) 50 | 28.9 | 51.7 | 50.5 | 49.4 | | | | | |
| 53 | 27.6 | 54.9 | 53.8 | 52.7 | | | | | |
| 56 | 29.3 | 58.2 | 57.1 | 55.9 | | | | | |
| (5 ft) 59 | 30.9 | 61.5 | 60.4 | 59.2 | | | | | |
| 63 | 32.6 | 64.8 | 63.6 | 62.5 | | | | | |
| 66 | 34.2 | 68.1 | 66.9 | 65.8 | | | | | |
| 69 | 35.9 | 71.3 | 70.2 | 69.1 | | | | | |
| (6 ft) 73 | 37.5 | 74.6 | 73.5 | 72.3 | | | | | |
| 76 | 39.2 | 77.9 | 76.8 | 75.6 | | | | | |
| 79 | 40.8 | 81.2 | 80.0 | 78.9 | | | | | |
| (7 ft) 82 | 42.5 | 84.5 | 83.3 | 82.2 | | | | | |
| 86 | 44.1 | 87.7 | 86.6 | 85.5 | | | | | |
| 89 | 45.8 | 91.0 | 89.9 | 88.7 | | | | | |
| 92 | 47.4 | 94.3 | 93.2 | 92.0 | | | | | |
| (8 ft) 96 | 49.1 | 97.6 | 96.4 | 95.3 | | | | | |
| 99 | 50.7 | 100.9 | 99.7 | 98.6 | | | | | |
| 102 | 52.4 | 104.1 | 103.0 | 101.9 | | | | | |
| 105 | 54.0 | 107.4 | 106.3 | 105.1 | | | | | |
| (9 ft) 109 | 55.7 | 110.7 | 109.6 | 108.4 | | | | | |
| 112 | 57.3 | 114.0 | 112.8 | 111.7 | | | | | |
| 115 | 59.0 | 117.3 | 116.1 | 115.0 | | | | | |
| (10 ft) 118 | 60.6 | 120.5 | 119.4 | 118.3 | | | | | |
| 122 | 62.3 | 123.8 | 122.7 | 121.5 | | | | | |

Note: all values are rounded to the nearest 0.1 inch

Injection Molded End Cap (IME)

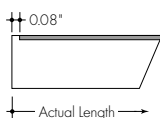

Injection Molded End Power Feed (IME)

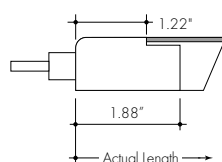

Injection Molded Bottom Power Feed (IMB)

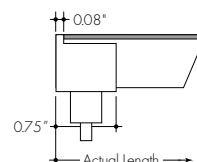

Injection Molded Side Power Feed (IMSA)

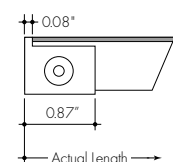

Power Supplies

See Power Supply instructions and spec sheet for wiring information. For a complete list of compatible dimmers, see Compatible Dimming Chart on the Resources page.

Universal Power Supply 1% 120VAC - 277VAC

| MODEL | INPUT CONTROL | ENVIRONMENT | POWER | OUTPUT |
|------------------------------------|----------------------------|-----------------|-----------|-------------|
| PS - Pool & Spa Rated Power Supply | UNI - 0-10V, Phase Dimming | PR - Pool Rated | 96 - 96 W | 24 - 24 VDC |

0-10V dims down to 1%, MLV/ELV/TRIAC dims down to 1%.
 For a complete list of compatible dimmers, see [Compatible Dimming Chart](#) on the Resources page.

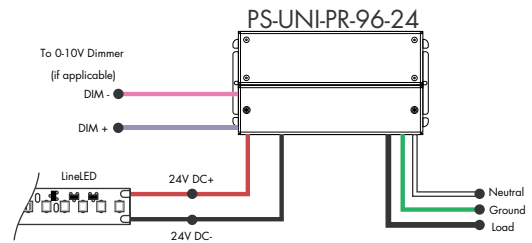

| MODELS | PS-UNI-PR-96-24 |
|---------------|-----------------|
| Length | 8.71" |
| Width | 4.56" |
| Depth | 1.86" |

Smart Pixel Decoder

SPI signal to DMX signal decoder



Model
SR-DMX-SPI
 SR-DMX-SPI - Smart Pixel Decoder

The SR-DMX-SPI is a smart LED pixel decoder that controls RGB/RGBW pixel LED strips with SPI signal. Designed with an OLED backlit panel, the pixel controller allows for easy configuration of most settings. Four push buttons are available for control of the LED functions.

*For pixel only.

Features

- 2 in 1 in-Wall Controller: DMX Control or Wireless RGB-W
- SPI signal output for RGB/RGBW pixel light control
- DMX512 controllable and RF/WIFI remote controllable
- Capable of addressing up to 1020 RGB pixels & 765 RGB pixels
- OLED panel allows for easy configuration

Operating Voltage

12 - 36V DC

Power capacity

up to 96W at 24V

Operating temperature range

from -4°F to +122°F in case