

**Features**

Kurba Large is a dot free direct view, highly versatile, energy efficient and flexible LED strip suitable for outdoor wet locations capable of horizontal/side bends and vertical/top bends with a 6" bending radius. The silicone material offers excellent heat, weather, UV, and solvent resistance and has a special coating to repel dust and dirt accumulation.

**Output Options**

- 2-Wire Warm Dim gradually warms the color temperature as you dim down the brightness
- Tunable White allows individual control of CCT and output
- RGB options offer balanced output across the color gamut and a true white with RGBW
- Smart Pixel offerings allow for infinite color combinations with cascading and chasing effects

**Average Life (L70)**

50,000 hours

**Approvals**

24VDC Class 2 wet listed, IP68

**Warranty**

3 years

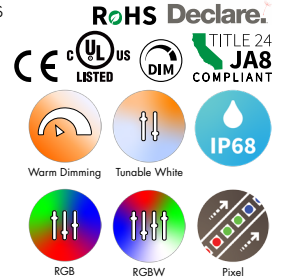

**Finish Options** (see page 2 for additional information)

**Base**  White

**Premium**  Black  Red  Green  Blue

**Technical Information**

Bending Direction	Horizontal					Vertical				
	Output	WD5950	TW4450	RGB2650	RGBW2650	SPI2650	WD5950	TW4450	RGB2650	RGBW2650
Light Output at 3000K	178 lm/ft	166 lm/ft	110 lm/ft	192 lm/ft	242 lm/ft	214 lm/ft	194 lm/ft	125 lm/ft	205 lm/ft	286 lm/ft
Average Power Consumption at 4'	3.66 W/ft	3.66 W/ft	3.66 W/ft	4.57 W/ft	6.71 W/ft	3.66 W/ft	3.66 W/ft	3.66 W/ft	4.57 W/ft	6.71 W/ft
Efficacy	49 lm/W	45 lm/W	30 lm/W	42 lm/W	36 lm/W	58 lm/W	53 lm/W	34 lm/W	45 lm/W	43 lm/W
Ordering Increment	2.46"	3.28"	3.28"	3.28"	3.28"	2.46"	3.28"	3.28"	3.28"	3.28"
Maximum Run Length (In Series)	26'	26'	26'	19'	13'	26'	26'	26'	19'	13'
Operating Temperature	-40°F to 131°F	-40°F to 131°F	-40°F to 131°F	-40°F to 113°F	-40°F to 113°F	-40°F to 131°F	-40°F to 131°F	-40°F to 131°F	-40°F to 113°F	-40°F to 113°F
Control/Dimming Protocol	Phase & 0-10V	0-10V, DMX	DMX	DMX	SPI Protocol UCS 2904	Phase & 0-10V	0-10V, DMX	DMX	DMX	SPI Protocol UCS 2904

**Constraints**

**Horizontal Bend Direction**

Bend LED in these positions only to avoid damage

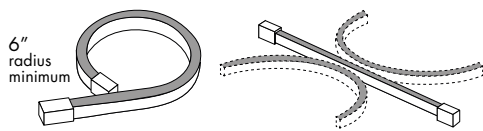

Illuminated surface shown in gray

**Horizontal Prohibited Bends**

Twisting or bending LED in these positions will cause damage

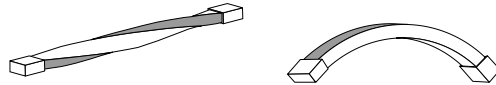

Illuminated surface shown in gray

Do not make sharp bends near the endcap

**Vertical Bend Direction**

Bend LED in these positions only to avoid damage

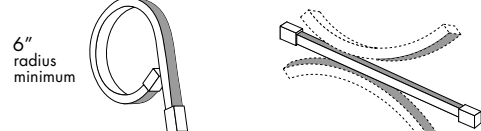

Illuminated surface shown in gray

**Vertical Prohibited Bends**

Twisting or bending LED in these positions will cause damage

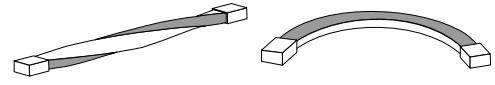

Illuminated surface shown in gray

Do not make sharp bends near the endcap

**Ordering Code**

MODEL	RATING	BEND DIRECTION	LENGTH	OUTPUT <sup>1,2</sup>	CCT	LENS	MOUNTING	FINISH	FEED POSITION LEFT	FEED POSITION RIGHT
KBL - Kurba Large	W - Wet	HB - Horizontal Bending VB - Vertical Bending	SEE PCC CHART ON PAGES 6 - 10	WD5950 - Warm Dim, Standard Output TW4450 - Tunable White, Standard Output RGB2650 - RGB, Standard Output RGBW2650 - RGBW, Standard Output SPI2650 - Smart Pixel Control, Standard Output	18K30K - 1800K-3000K 22K57K - 2200K-5700K 26K42K - 2600K-4200K <sup>2</sup> RGB - Red, Green, Blue RGB26K - RGB 2600K <sup>2</sup> RGB27K - RGB 2700K RGB30K - RGB 3000K RGB40K - RGB 4000K	SF - Silicone Frosted BL - Black Lens <sup>3</sup>	NA - See Page 4 - 5 for orderable mounting accessories	WH - White BK - Black RED - Red GRN - Green BLU - Blue	INJECTION MOLD IME - End Feed 1 IMB - Back Feed 1 IMS - Side 1 Feed IMSB - Side 2 Feed <sup>4</sup> NPF - No Power Feed <sup>5</sup>	INJECTION MOLD IME - End Feed 1 IMB - Back Feed 1 IMS - Side 1 Feed IMSB - Side 2 Feed <sup>4</sup> NPF - No Power Feed <sup>5</sup>

Feeds come with 90° wire leads

1 - Title 24 JA8 compliant depending on Output, CCT, and lens selections. See Technical Information and Lens Transmission charts to calculate specific efficacies.

2 - Black Lens only available with 26K42K, RGB, and RGB26K CCT options  
3 - BL - Black lens can only be used with BK - Black Finish

4 - IMSB - Side 2 Feed not available with HB - Horizontal Bending  
5 - NPF/NPF for Feed Position 1&2 is not a valid configuration option

## Powerfeeds and Connectors

### Power Feed Position Options and Orientation

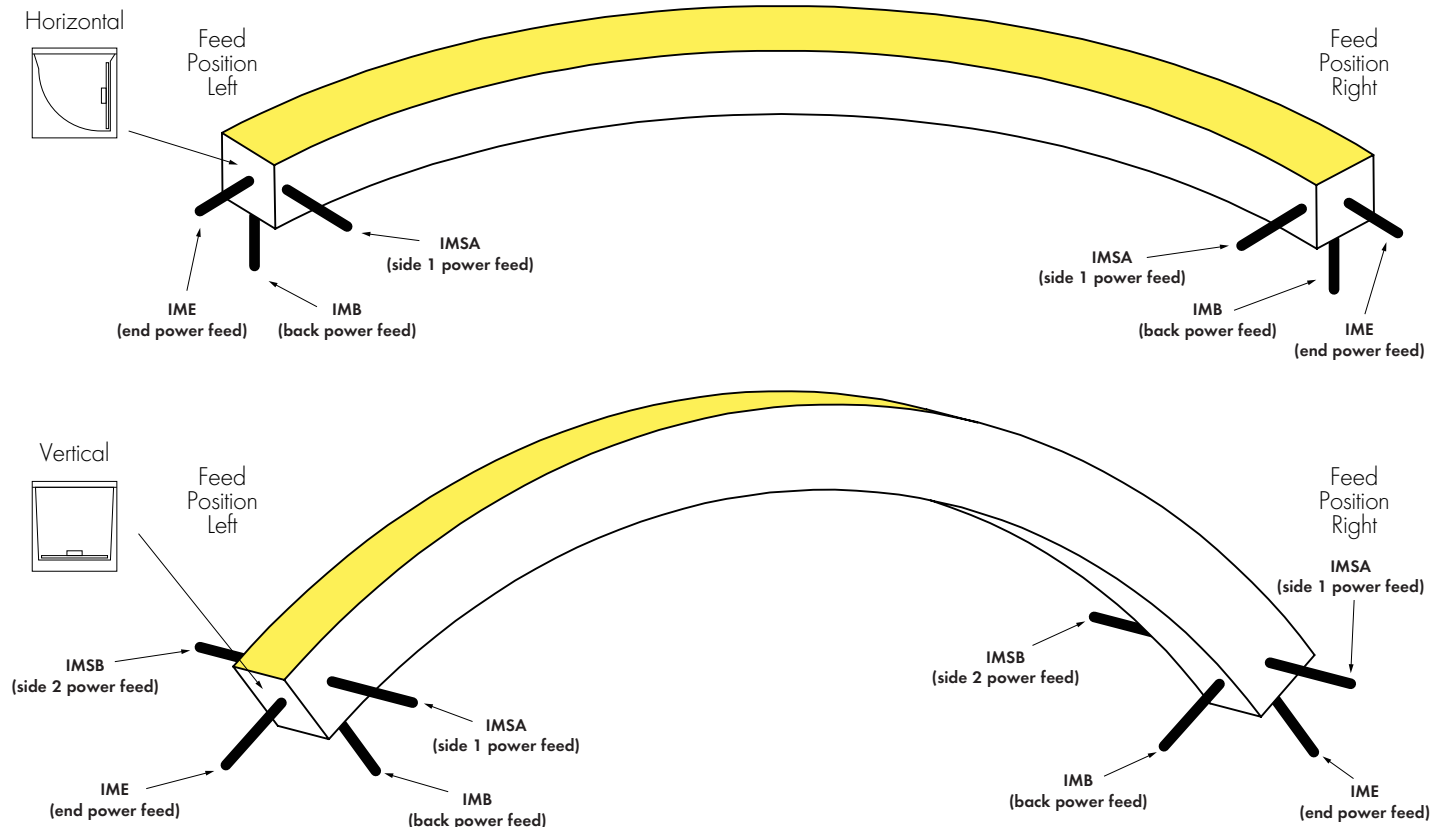

NOTE: IMSB - Side 2 Feed not available with HB - Horizontal Bending

### Linking and Extension Cable Options

#### END CONNECTOR

Injection-molded End Connector  
-IME

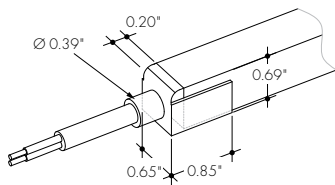

#### BACK CONNECTOR

Injection-molded Back Connector  
-IMB

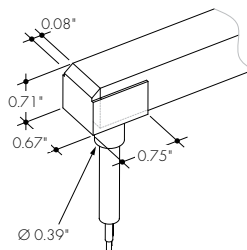

#### SIDE CONNECTOR

Injection-molded Side Connector  
-MSA and -MSB

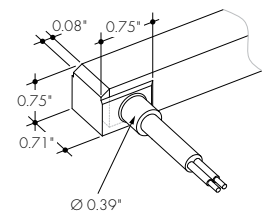

#### ENDCAP (NO CONNECTOR)

Injection-molded Cap (No Connector)  
-NPF

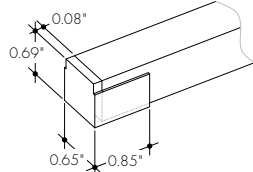

#### ANTI-WICKING FERRULE

Included on every power feed wire

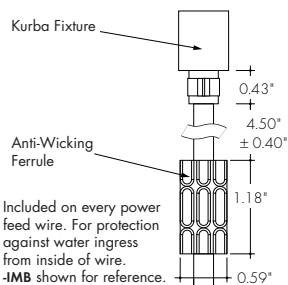

**Product Dimensions**

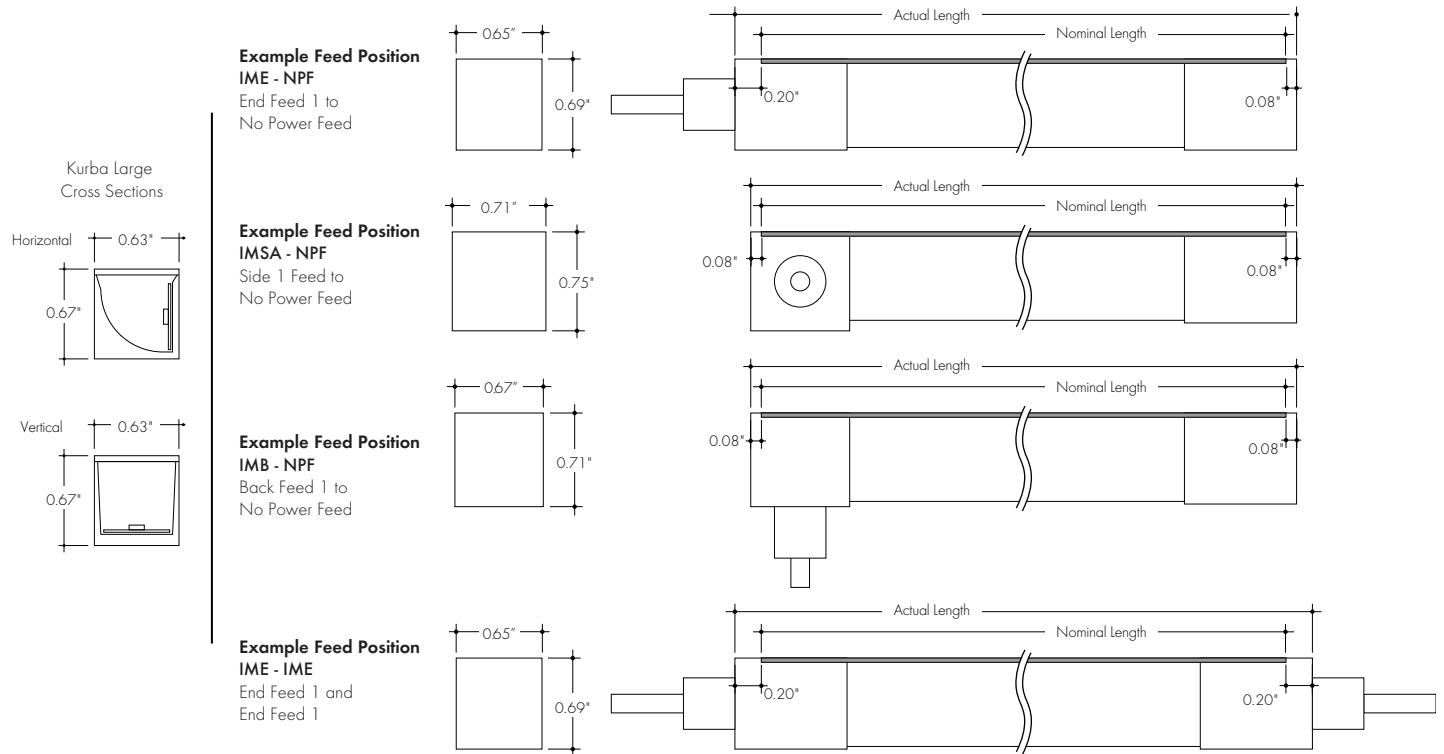

**Finish Options**

- A wide variety of finish options allowing complete customization of style and aesthetic.



Kurba's base finish is a crisp white which brings a timeless, clean aesthetic that brightens and enhances any space.



Also available with a blackout aesthetic - the Black Lens paired with the Black Finish provides for a sleek, all black profile that keeps the strip concealed in the off-state.

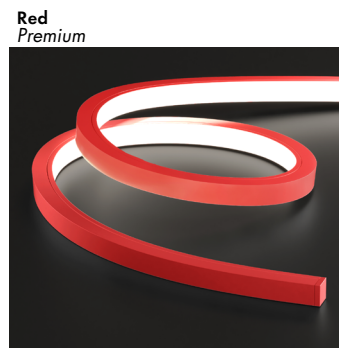

Red adds a bright and bold statement, perfect for creating a striking and dynamic ambiance with its vibrancy.

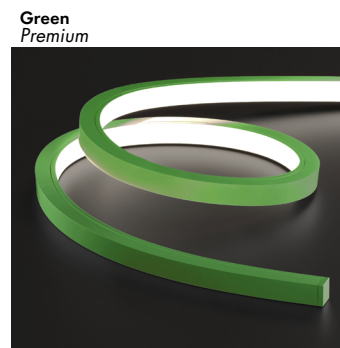

Green embraces a refreshing and natural feel, reminiscent of emerald green, add touch of tranquility and harmony to your space with this option.

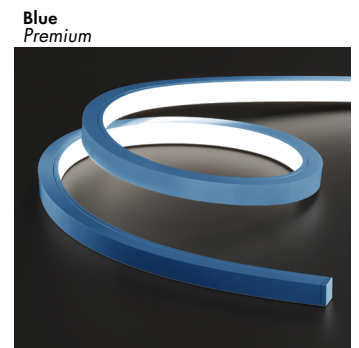

Blue evokes the serenity of the deep sea by combining vivid cobalt and azure tones.

## Light Transmission and Dotting

Output Options	Lens/Accessory					
	Silicone Frosted/ White Finish	Silicone Frosted/ Red Finish	Silicone Frosted/ Green Finish	Silicone Frosted/ Blue Finish	Silicone Frosted/ Black Finish	Black Lens/ Black Finish
WD59SO	ND	ND	ND	ND	ND	ND
TW44SO	ND	ND	ND	ND	ND	ND
RGB26SO	ND	ND	ND	ND	ND	ND
RGBW26SO	ND	ND	ND	ND	ND	ND
SP126SO	ND	ND	ND	ND	ND	ND
<b>Transmission Percentage</b>	100%	80%	80%	80%	80%	17%

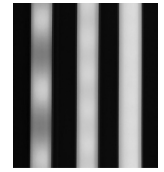

**CD** - Clear Dotting  
**SD** - Slight Dotting  
**ND** - No Dotting

## Mounting Accessories

### MC-KBL-SAP-SM-0.8-SA

KBL Mounting Channel, Serrated Aluminum Profile, Surface Mount, 0.8in, Silver Anodized

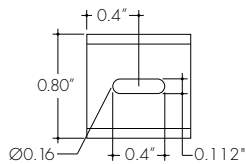
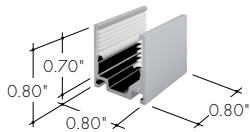

For use with light strip mounted to the ceiling. 1 recommended every 8 in.

### MC-KBL-SAP-SM-78-SA

KBL Mounting Channel, Serrated Aluminum Profile, Surface Mount, 78in, Silver Anodized

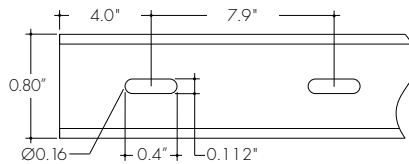
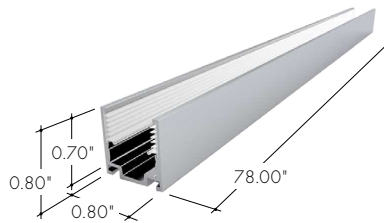

For use with light strip mounted to the ceiling.

### MC-KBL-FSAP-TR-78-SA

KBL Mounting Channel, Flanged Serrated Aluminum Profile, Trimmed Recessed Mount, 78in, Silver Anodized

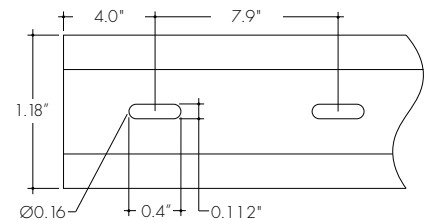
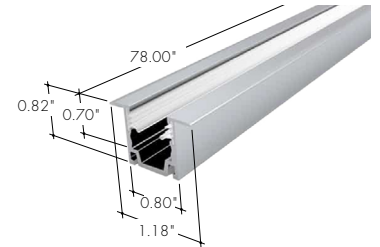

Flanged aluminum mounting channel providing grip. For use with light strip recessed into the ceiling.

### MC-KBL-RCWY-SM-78-SA

KBL Mounting Channel, Raceway, Surface Mount, 78in, Silver Anodized

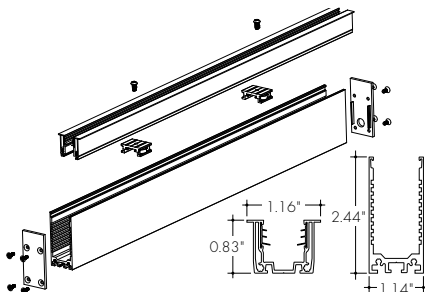

Raceway channel allows for hidden cable management and is a superb option where tidiness is required.  
**NOTE:** Compatible with **IMB** - Back Feed only

### MC-KBL-BSSP-3D-SM-34-SS

KBL Mounting Channel, Bendable Stainless Steel Profile, 3D Bending, Surface Mount, 34in, Stainless Steel



For use with light strip mounted to the ceiling.

### MC-KBL-BSAP-HB-SM-38-SA

KBL Mounting Channel, Bendable Serrated Aluminum Profile, Horizontal Bending, Surface Mount, 38in, Silver Anodized

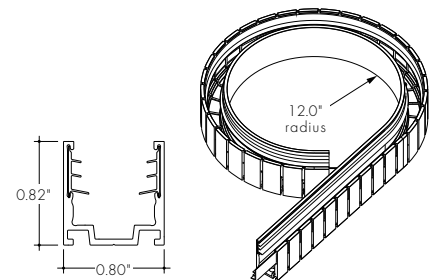

For use with light strip mounted to the ceiling.  
**NOTE:** Not Available on Vertical Bending.

**Mounting Accessories and Optional Connectors**

**MC-KBL-BANP-3D-SM-78-XX**

KBL Mounting Channel, Bendable Anole Profile, 3D Bending, Surface Mount, 78in, 6" inch Bending Radius

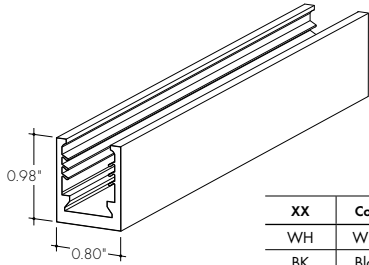

XX	Color
WH	White
BK	Black

**LVSP-WET**

Splice box: wet rated, low voltage, gray

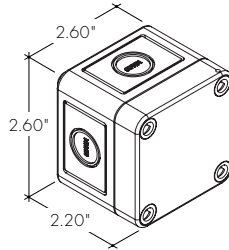

**LVSP-WET-CM**

Connector for splice box, low voltage for cable management, gray

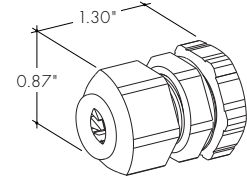

**WD59SO | Power Consumption Per Fixture Length**

Based on operation with PDCU series of power supplies. Use Actual Length for Order Code Entry.  
 Tolerance for Actual Lengths less than 6 ft is +/- 0.2", Actual Lengths between 6 ft and 16 ft is +/- 0.3", and Actual Lengths greater than 16 ft is +/- 0.6"  
 A - End Connector at both ends of Kurba (0.20" + 0.20" added to overall length)  
 B - End Connector at one end of Kurba and No Connector or Back Connector or Side Connector at other end of Kurba (0.20" + 0.08" added to overall length)  
 C - Any combination of No Connector, Back Connector, or Side Connector on each end of Kurba (0.08" + 0.08" added to overall length)

Nominal Length (in)	Actual Length (in)				Nominal Length (in)	Actual Length (in)				Nominal Length (in)	Actual Length (in)				Nominal Length (in)	Actual Length (in)			
	W	A	B	C		W	A	B	C		W	A	B	C		W	A	B	C
8	2.4	7.8	7.7	7.5	(8 ft) 96	29.4	96.4	96.2	96.1	185	56.4	184.9	184.8	184.7	274	83.4	273.5	273.4	273.3
10	3.1	10.2	10.1	10.0	99	30.1	98.8	98.7	98.6	187	57.1	187.4	187.3	187.2	(23 ft) 276	84.1	276.0	275.9	275.8
(1 ft) 13	3.9	12.7	12.6	12.5	101	30.9	101.3	101.2	101.0	190	57.9	189.9	189.7	189.6	278	84.9	278.5	278.3	278.2
15	4.6	15.2	15.0	14.9	104	31.6	103.7	103.6	103.5	(16 ft) 192	58.6	192.3	192.2	192.1	281	85.6	280.9	280.8	280.7
18	5.4	17.6	17.5	17.4	106	32.4	106.2	106.1	106.0	195	59.4	194.8	194.7	194.5	283	86.4	283.4	283.3	283.1
20	6.1	20.1	20.0	19.8	(9 ft) 109	33.1	108.7	108.5	108.4	197	60.1	197.3	197.1	197.0	286	87.1	285.8	285.7	285.6
23	6.9	22.5	22.4	22.3	111	33.9	111.1	111.0	110.9	200	60.9	199.7	199.6	199.5	(24 ft) 288	87.9	288.3	288.2	288.1
(2 ft) 25	7.6	25.0	24.9	24.8	114	34.6	113.6	113.5	113.3	202	61.6	202.2	202.1	201.9	291	88.6	290.8	290.6	290.5
27	8.4	27.5	27.3	27.2	116	35.4	116.0	115.9	115.8	(17 ft) 205	62.4	204.6	204.5	204.4	293	89.4	293.2	293.1	293.0
30	9.1	29.9	29.8	29.7	119	36.1	118.5	118.4	118.3	207	63.1	207.1	207.0	206.9	296	90.1	295.7	295.6	295.4
32	9.9	32.4	32.3	32.1	(10 ft) 121	36.9	121.0	120.9	120.7	210	63.9	209.6	209.4	209.3	298	90.9	298.1	298.0	297.9
(3 ft) 35	10.6	34.8	34.7	34.6	123	37.6	123.4	123.3	123.2	212	64.6	212.0	211.9	211.8	(25 ft) 301	91.6	300.6	300.5	300.4
37	11.4	37.3	37.2	37.1	126	38.4	125.9	125.8	125.7	214	65.4	214.5	214.4	214.2	303	92.4	303.1	302.9	302.8
40	12.1	39.8	39.7	39.5	128	39.1	128.4	128.2	128.1	(18 ft) 217	66.1	216.9	216.8	216.7	306	93.1	305.5	305.4	305.3
42	12.9	42.2	42.1	42.0	(11 ft) 131	39.9	130.8	130.7	130.6	219	66.9	219.4	219.3	219.2	308	93.9	308.0	307.9	307.7
45	13.6	44.7	44.6	44.5	133	40.6	133.3	133.2	133.0	222	67.6	221.9	221.7	221.6	310	94.6	310.4	310.3	310.2
(4 ft) 47	14.4	47.2	47.0	46.9	136	41.4	135.7	135.6	135.5	224	68.4	224.3	224.2	224.1	(26 ft) 313	95.4	312.9	312.8	312.7
50	15.1	49.6	49.5	49.4	138	42.1	138.2	138.1	138.0	(19 ft) 227	69.1	226.8	226.7	226.5					
52	15.9	52.1	52.0	51.8	141	42.9	140.7	140.5	140.4	229	69.9	229.2	229.1	229.0					
55	16.6	54.5	54.4	54.3	(12 ft) 143	43.6	143.1	143.0	142.9	232	70.6	231.7	231.6	231.5					
57	17.4	57.0	56.9	56.8	146	44.4	145.6	145.5	145.3	234	71.4	234.2	234.0	233.9					
(5 ft) 59	18.1	59.5	59.3	59.2	148	45.1	148.0	147.9	147.8	237	72.1	236.6	236.5	236.4					
62	18.9	61.9	61.8	61.7	150	45.9	150.5	150.4	150.3	(20 ft) 239	72.9	239.1	239.0	238.8					
64	19.6	64.4	64.3	64.1	153	46.6	153.0	152.8	152.7	242	73.6	241.5	241.4	241.3					
67	20.4	66.8	66.7	66.6	(13 ft) 155	47.4	155.4	155.3	155.2	244	74.4	244.0	243.9	243.8					
69	21.1	69.3	69.2	69.1	158	48.1	157.9	157.8	157.6	246	75.1	246.5	246.3	246.2					
(6 ft) 72	21.9	71.8	71.6	71.5	160	48.9	160.3	160.2	160.1	249	75.9	248.9	248.8	248.7					
74	22.6	74.2	74.1	74.0	163	49.6	162.8	162.7	162.6	(21 ft) 251	76.6	251.4	251.3	251.1					
77	23.4	76.7	76.6	76.4	165	50.4	165.3	165.1	165.0	254	77.4	253.8	253.7	253.6					
79	24.1	79.1	79.0	78.9	(14 ft) 168	51.1	167.7	167.6	167.5	256	78.1	256.3	256.2	256.1					
82	24.9	81.6	81.5	81.4	170	51.9	170.2	170.1	169.9	259	78.9	258.8	258.6	258.5					
(7 ft) 84	25.6	84.1	83.9	83.8	173	52.6	172.6	172.5	172.4	261	79.6	261.2	261.1	261.0					
87	26.4	86.5	86.4	86.3	175	53.4	175.1	175.0	174.9	(22 ft) 264	80.4	263.7	263.6	263.4					
89	27.1	89.0	88.9	88.7	178	54.1	177.6	177.4	177.3	266	81.1	266.1	266.0	265.9					
91	27.9	91.4	91.3	91.2	(15 ft) 180	54.9	180.0	179.9	179.8	269	81.9	268.6	268.5	268.4					
94	28.6	93.9	93.8	93.7	182	55.6	182.5	182.4	182.2	271	82.6	271.1	270.9	270.8					

Note: all values are rounded to the nearest 0.1 inch

Endcap (No Connector) -NPF

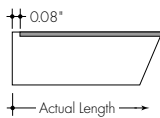

End Connector -IME

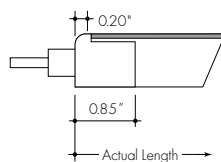

Back Connector -IMB

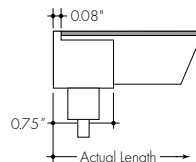

Side Connector -IMSA -IMSB

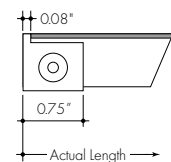

### TW44SO | Power Consumption Per Fixture Length

Based on operation with PDCU series of power supplies. Use Actual Length for Order Code Entry.  
 Tolerance for Actual Lengths less than 6 ft is +/- 0.2", Actual Lengths between 6 ft and 16 ft is +/- 0.3", and Actual Lengths greater than 16 ft is +/- 0.6"  
 A - End Connector at both ends of Kurba (0.20" + 0.20" added to overall length)  
 B - End Connector at one end of Kurba and No Connector or Back Connector or Side Connector at other end of Kurba (0.20" + 0.08" added to overall length)  
 C - Any combination of No Connector, Back Connector, or Side Connector on each end of Kurba (0.08" + 0.08" added to overall length)

Nominal Length (in)	Actual Length (in)				Nominal Length (in)	Actual Length (in)				Nominal Length (in)	Actual Length (in)			
	W	A	B	C		W	A	B	C		W	A	B	C
7	2.1	7.0	6.8	6.7	125	38.1	125.1	124.9	124.8	243	74.1	243.2	243.1	242.9
10	3.1	10.2	10.1	10.0	128	39.1	128.3	128.2	128.1	246	75.1	246.5	246.3	246.2
(1 ft) 14	4.1	13.5	13.4	13.3	(11 ft) 132	40.1	131.6	131.5	131.4	250	76.1	249.7	249.6	249.5
17	5.1	16.8	16.7	16.6	135	41.1	134.9	134.8	134.7	(21 ft) 253	77.1	253.0	252.9	252.8
20	6.1	20.1	20.0	19.8	138	42.1	138.2	138.1	137.9	256	78.1	256.3	256.2	256.1
(2 ft) 23	7.1	23.4	23.2	23.1	141	43.1	141.5	141.4	141.2	260	79.1	259.6	259.5	259.3
27	8.1	26.6	26.5	26.4	(12 ft) 145	44.1	144.8	144.6	144.5	(22 ft) 263	80.1	262.9	262.7	262.6
30	9.1	29.9	29.8	29.7	148	45.1	148.0	147.9	147.8	266	81.1	266.1	266.0	265.9
33	10.1	33.2	33.1	33.0	151	46.1	151.3	151.2	151.1	269	82.1	269.4	269.3	269.2
(3 ft) 36	11.1	36.5	36.4	36.2	(13 ft) 155	47.1	154.6	154.5	154.4	273	83.1	272.7	272.6	272.5
40	12.1	39.8	39.6	39.5	158	48.1	157.9	157.8	157.6	(23 ft) 276	84.1	276.0	275.9	275.7
43	13.1	43.0	42.9	42.8	161	49.1	161.2	161.0	160.9	279	85.1	279.3	279.1	279.0
46	14.1	46.3	46.2	46.1	164	50.1	164.4	164.3	164.2	282	86.1	282.5	282.4	282.3
(4 ft) 50	15.1	49.6	49.5	49.4	(14 ft) 168	51.1	167.7	167.6	167.5	286	87.1	285.8	285.7	285.6
53	16.1	52.9	52.8	52.7	171	52.1	171.0	170.9	170.8	(24 ft) 289	88.1	289.1	289.0	288.9
56	17.1	56.2	56.1	55.9	174	53.1	174.3	174.2	174.0	292	89.1	292.4	292.3	292.1
(5 ft) 59	18.1	59.5	59.3	59.2	178	54.1	177.6	177.4	177.3	296	90.1	295.7	295.5	295.4
63	19.1	62.7	62.6	62.5	(15 ft) 181	55.1	180.8	180.7	180.6	(25 ft) 299	91.1	298.9	298.8	298.7
66	20.1	66.0	65.9	65.8	184	56.1	184.1	184.0	183.9	302	92.1	302.2	302.1	302.0
69	21.1	69.3	69.2	69.1	187	57.1	187.4	187.3	187.2	305	93.1	305.5	305.4	305.3
(6 ft) 73	22.1	72.6	72.5	72.3	(16 ft) 191	58.1	190.7	190.6	190.4	309	94.1	308.8	308.7	308.5
76	23.1	75.9	75.7	75.6	194	59.1	194.0	193.8	193.7	(26 ft) 312	95.1	312.1	311.9	311.8
79	24.1	79.1	79.0	78.9	197	60.1	197.2	197.1	197.0					
(7 ft) 82	25.1	82.4	82.3	82.2	200	61.1	200.5	200.4	200.3					
86	26.1	85.7	85.6	85.5	(17 ft) 204	62.1	203.8	203.7	203.6					
89	27.1	89.0	88.9	88.7	207	63.1	207.1	207.0	206.8					
92	28.1	92.3	92.1	92.0	210	64.1	210.4	210.2	210.1					
(8 ft) 96	29.1	95.5	95.4	95.3	214	65.1	213.6	213.5	213.4					
99	30.1	98.8	98.7	98.6	(18 ft) 217	66.1	216.9	216.8	216.7					
102	31.1	102.1	102.0	101.9	220	67.1	220.2	220.1	220.0					
105	32.1	105.4	105.3	105.1	223	68.1	223.5	223.4	223.2					
(9 ft) 109	33.1	108.7	108.5	108.4	(19 ft) 227	69.1	226.8	226.6	226.5					
112	34.1	111.9	111.8	111.7	230	70.1	230.0	229.9	229.8					
115	35.1	115.2	115.1	115.0	233	71.1	233.3	233.2	233.1					
(10 ft) 118	36.1	118.5	118.4	118.3	237	72.1	236.6	236.5	236.4					
122	37.1	121.8	121.7	121.5	(20 ft) 240	73.1	239.9	239.8	239.7					

Note: all values are rounded to the nearest 0.1 inch

Endcap (No Connector) -NPF

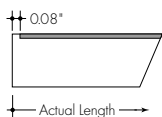

End Connector -IME

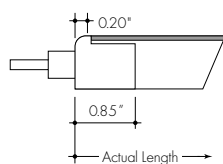

Back Connector -IMB

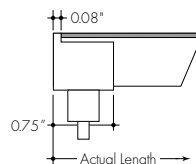

Side Connector -IMSA -IMSB

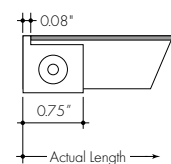

### RGB26SO | Power Consumption Per Fixture Length

Based on operation with PDCU series of power supplies. Use Actual Length for Order Code Entry. Tolerance for Actual Lengths less than 6 ft is +/- 0.2", Actual Lengths between 6 ft and 16 ft is +/- 0.3", and Actual Lengths greater than 16 ft is +/- 0.6"

- A** - End Connector at both ends of Kurba (0.20" + 0.20" added to overall length)
- B** - End Connector at one end of Kurba and No Connector or Back Connector or Side Connector at other end of Kurba (0.20" + 0.08" added to overall length)
- C** - Any combination of No Connector, Back Connector, or Side Connector on each end of Kurba (0.08" + 0.08" added to overall length)

Nominal Length (in)	Actual Length (in)				Nominal Length (in)	Actual Length (in)				Nominal Length (in)	Actual Length (in)			
	W	A	B	C		W	A	B	C		W	A	B	C
7	2.1	7.0	6.8	6.7	125	38.1	125.1	124.9	124.8	243	74.1	243.2	243.1	242.9
10	3.1	10.2	10.1	10.0	128	39.1	128.3	128.2	128.1	246	75.1	246.5	246.3	246.2
(1 ft) 14	4.1	13.5	13.4	13.3	(11 ft) 132	40.1	131.6	131.5	131.4	250	76.1	249.7	249.6	249.5
17	5.1	16.8	16.7	16.6	135	41.1	134.9	134.8	134.7	(21 ft) 253	77.1	253.0	252.9	252.8
20	6.1	20.1	20.0	19.8	138	42.1	138.2	138.1	137.9	256	78.1	256.3	256.2	256.1
(2 ft) 23	7.1	23.4	23.2	23.1	141	43.1	141.5	141.4	141.2	260	79.1	259.6	259.5	259.3
27	8.1	26.6	26.5	26.4	(12 ft) 145	44.1	144.8	144.6	144.5	(22 ft) 263	80.1	262.9	262.7	262.6
30	9.1	29.9	29.8	29.7	148	45.1	148.0	147.9	147.8	266	81.1	266.1	266.0	265.9
33	10.1	33.2	33.1	33.0	151	46.1	151.3	151.2	151.1	269	82.1	269.4	269.3	269.2
(3 ft) 36	11.1	36.5	36.4	36.2	(13 ft) 155	47.1	154.6	154.5	154.4	273	83.1	272.7	272.6	272.5
40	12.1	39.8	39.6	39.5	158	48.1	157.9	157.8	157.6	(23 ft) 276	84.1	276.0	275.9	275.7
43	13.1	43.0	42.9	42.8	161	49.1	161.2	161.0	160.9	279	85.1	279.3	279.1	279.0
46	14.1	46.3	46.2	46.1	164	50.1	164.4	164.3	164.2	282	86.1	282.5	282.4	282.3
(4 ft) 50	15.1	49.6	49.5	49.4	(14 ft) 168	51.1	167.7	167.6	167.5	286	87.1	285.8	285.7	285.6
53	16.1	52.9	52.8	52.7	171	52.1	171.0	170.9	170.8	(24 ft) 289	88.1	289.1	289.0	288.9
56	17.1	56.2	56.1	55.9	174	53.1	174.3	174.2	174.0	292	89.1	292.4	292.3	292.1
(5 ft) 59	18.1	59.5	59.3	59.2	178	54.1	177.6	177.4	177.3	296	90.1	295.7	295.5	295.4
63	19.1	62.7	62.6	62.5	(15 ft) 181	55.1	180.8	180.7	180.6	(25 ft) 299	91.1	298.9	298.8	298.7
66	20.1	66.0	65.9	65.8	184	56.1	184.1	184.0	183.9	302	92.1	302.2	302.1	302.0
69	21.1	69.3	69.2	69.1	187	57.1	187.4	187.3	187.2	305	93.1	305.5	305.4	305.3
(6 ft) 73	22.1	72.6	72.5	72.3	(16 ft) 191	58.1	190.7	190.6	190.4	309	94.1	308.8	308.7	308.5
76	23.1	75.9	75.7	75.6	194	59.1	194.0	193.8	193.7	(26 ft) 312	95.1	312.1	311.9	311.8
79	24.1	79.1	79.0	78.9	197	60.1	197.2	197.1	197.0					
(7 ft) 82	25.1	82.4	82.3	82.2	200	61.1	200.5	200.4	200.3					
86	26.1	85.7	85.6	85.5	(17 ft) 204	62.1	203.8	203.7	203.6					
89	27.1	89.0	88.9	88.7	207	63.1	207.1	207.0	206.8					
92	28.1	92.3	92.1	92.0	210	64.1	210.4	210.2	210.1					
(8 ft) 96	29.1	95.5	95.4	95.3	214	65.1	213.6	213.5	213.4					
99	30.1	98.8	98.7	98.6	(18 ft) 217	66.1	216.9	216.8	216.7					
102	31.1	102.1	102.0	101.9	220	67.1	220.2	220.1	220.0					
105	32.1	105.4	105.3	105.1	223	68.1	223.5	223.4	223.2					
(9 ft) 109	33.1	108.7	108.5	108.4	(19 ft) 227	69.1	226.8	226.6	226.5					
112	34.1	111.9	111.8	111.7	230	70.1	230.0	229.9	229.8					
115	35.1	115.2	115.1	115.0	233	71.1	233.3	233.2	233.1					
(10 ft) 118	36.1	118.5	118.4	118.3	237	72.1	236.6	236.5	236.4					
122	37.1	121.8	121.7	121.5	(20 ft) 240	73.1	239.9	239.8	239.7					

Note: all values are rounded to the nearest 0.1 inch

Endcap (No Connector) -NPF

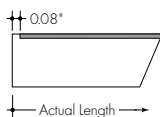

End Connector -IME

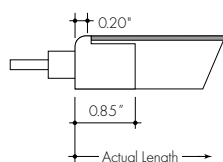

Back Connector -IMB

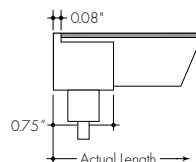

Side Connector -IMSA -IMSB

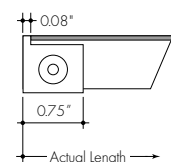



### RGBW26SO | Power Consumption Per Fixture Length

Based on operation with PDCU series of power supplies. Use Actual Length for Order Code Entry.  
 Tolerance for Actual Lengths less than 6 ft is +/- 0.2", Actual Lengths between 6 ft and 16 ft is +/- 0.3", and Actual Lengths greater than 16 ft is +/- 0.6"  
 A - End Connector at both ends of Kurba (0.20" + 0.20" added to overall length)  
 B - End Connector at one end of Kurba and No Connector or Back Connector or Side Connector at other end of Kurba (0.20" + 0.08" added to overall length)  
 C - Any combination of No Connector, Back Connector, or Side Connector on each end of Kurba (0.08" + 0.08" added to overall length)

Nominal Length (in)	Actual Length (in)				Nominal Length (in)	Actual Length (in)			
	W	A	B	C		W	A	B	C
7	2.7	7.0	6.8	6.7	125	47.6	125.1	124.9	124.8
10	3.9	10.2	10.1	10.0	128	48.9	128.3	128.2	128.1
(1 ft) 14	5.1	13.5	13.4	13.3	(11 ft) 132	50.1	131.6	131.5	131.4
17	6.4	16.8	16.7	16.6	135	51.4	134.9	134.8	134.7
20	7.6	20.1	20.0	19.8	138	52.6	138.2	138.1	137.9
(2 ft) 23	8.9	23.4	23.2	23.1	141	53.9	141.5	141.4	141.2
27	10.1	26.6	26.5	26.4	(12 ft) 145	55.1	144.8	144.6	144.5
30	11.4	29.9	29.8	29.7	148	56.4	148.0	147.9	147.8
33	12.6	33.2	33.1	33.0	151	57.6	151.3	151.2	151.1
(3 ft) 36	13.9	36.5	36.4	36.2	(13 ft) 155	58.9	154.6	154.5	154.4
40	15.1	39.8	39.6	39.5	158	60.1	157.9	157.8	157.6
43	16.4	43.0	42.9	42.8	161	61.4	161.2	161.0	160.9
46	17.6	46.3	46.2	46.1	164	62.6	164.4	164.3	164.2
(4 ft) 50	18.9	49.6	49.5	49.4	(14 ft) 168	63.9	167.7	167.6	167.5
53	20.1	52.9	52.8	52.7	171	65.1	171.0	170.9	170.8
56	21.4	56.2	56.1	55.9	174	66.4	174.3	174.2	174.0
(5 ft) 59	22.6	59.5	59.3	59.2	178	67.6	177.6	177.4	177.3
63	23.9	62.7	62.6	62.5	(15 ft) 181	68.9	180.8	180.7	180.6
66	25.1	66.0	65.9	65.8	184	70.1	184.1	184.0	183.9
69	26.4	69.3	69.2	69.1	187	71.4	187.4	187.3	187.2
(6 ft) 73	27.6	72.6	72.5	72.3	(16 ft) 191	72.6	190.7	190.6	190.4
76	28.9	75.9	75.7	75.6	194	73.9	194.0	193.8	193.7
79	30.1	79.1	79.0	78.9	197	75.1	197.2	197.1	197.0
(7 ft) 82	31.4	82.4	82.3	82.2	200	76.4	200.5	200.4	200.3
86	32.6	85.7	85.6	85.5	(17 ft) 204	77.6	203.8	203.7	203.6
89	33.9	89.0	88.9	88.7	207	78.9	207.1	207.0	206.8
92	35.1	92.3	92.1	92.0	210	80.1	210.4	210.2	210.1
(8 ft) 96	36.4	95.5	95.4	95.3	214	81.4	213.6	213.5	213.4
99	37.6	98.8	98.7	98.6	(18 ft) 217	82.6	216.9	216.8	216.7
102	38.9	102.1	102.0	101.9	220	83.9	220.2	220.1	220.0
105	40.1	105.4	105.3	105.1	223	85.1	223.5	223.4	223.2
(9 ft) 109	41.4	108.7	108.5	108.4	(19 ft) 227	86.4	226.8	226.6	226.5
112	42.6	111.9	111.8	111.7					
115	43.9	115.2	115.1	115.0					
(10 ft) 118	45.1	118.5	118.4	118.3					
122	46.4	121.8	121.7	121.5					

Note: all values are rounded to the nearest 0.1 inch

Endcap (No Connector) -NPF

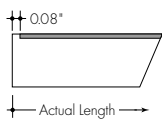

End Connector -IME

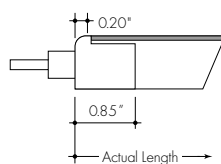

Back Connector -IMB

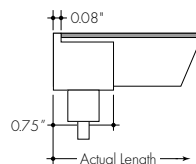

Side Connector -IMSA -IMSB

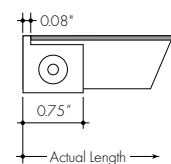

### SPI26SO | Power Consumption Per Fixture Length

Based on operation with PDCU series of power supplies. Use Actual Length for Order Code Entry.  
 Tolerance for Actual Lengths less than 6 ft is +/- 0.2", Actual Lengths between 6 ft and 16 ft is +/- 0.3", and Actual Lengths greater than 16 ft is +/- 0.6"  
 A - End Connector at both ends of Kurba (0.20" + 0.20" added to overall length)  
 B - End Connector at one end of Kurba and No Connector or Back Connector or Side Connector at other end of Kurba (0.20" + 0.08" added to overall length)  
 C - Any combination of No Connector, Back Connector, or Side Connector on each end of Kurba (0.08" + 0.08" added to overall length)

Nominal Length (in)	Actual Length (in)				Nominal Length (in)	Actual Length (in)			
	W	A	B	C		W	A	B	C
7	3.9	7.0	6.8	6.7	125	62.9	125.1	124.9	124.8
10	5.7	10.2	10.1	10.0	128	64.6	128.3	128.2	128.1
(1 ft) 14	7.6	13.5	13.4	13.3	(11 ft) 132	66.2	131.6	131.5	131.4
17	9.4	16.8	16.7	16.6	135	67.9	134.9	134.8	134.7
20	11.2	20.1	20.0	19.8	138	69.5	138.2	138.1	137.9
(2 ft) 23	13.1	23.4	23.2	23.1	141	71.2	141.5	141.4	141.2
27	14.9	26.6	26.5	26.4	(12 ft) 145	72.8	144.8	144.6	144.5
30	16.7	29.9	29.8	29.7	148	74.5	148.0	147.9	147.8
33	18.6	33.2	33.1	33.0	151	76.1	151.3	151.2	151.1
(3 ft) 36	20.4	36.5	36.4	36.2	(13 ft) 155	77.8	154.6	154.5	154.4
40	22.2	39.8	39.6	39.5					
43	24.1	43.0	42.9	42.8					
46	25.9	46.3	46.2	46.1					
(4 ft) 50	27.7	49.6	49.5	49.4					
53	26.6	52.9	52.8	52.7					
56	28.3	56.2	56.1	55.9					
(5 ft) 59	29.9	59.5	59.3	59.2					
63	31.6	62.7	62.6	62.5					
66	33.2	66.0	65.9	65.8					
69	34.9	69.3	69.2	69.1					
(6 ft) 73	36.5	72.6	72.5	72.3					
76	38.2	75.9	75.7	75.6					
79	39.8	79.1	79.0	78.9					
(7 ft) 82	41.5	82.4	82.3	82.2					
86	43.1	85.7	85.6	85.5					
89	44.8	89.0	88.9	88.7					
92	46.4	92.3	92.1	92.0					
(8 ft) 96	48.1	95.5	95.4	95.3					
99	49.7	98.8	98.7	98.6					
102	51.4	102.1	102.0	101.9					
105	53.0	105.4	105.3	105.1					
(9 ft) 109	54.7	108.7	108.5	108.4					
112	56.3	111.9	111.8	111.7					
115	58.0	115.2	115.1	115.0					
(10 ft) 118	59.6	118.5	118.4	118.3					
122	61.3	121.8	121.7	121.5					

Note: all values are rounded to the nearest 0.1 inch

Endcap (No Connector) -NPF

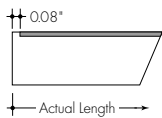

End Connector -IME

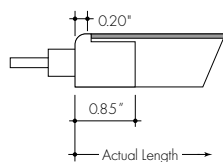

Back Connector -IMB

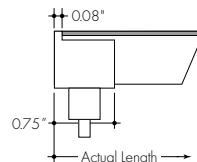

Side Connector -IMSA -IMSB

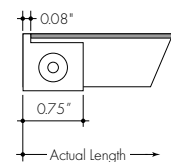

## Power Supplies

See fixture and power supply instructions & spec sheet for wiring information. Dimming possible in select models - view Luminii website for list of compatible dimmers.

### For use with Warm Dim

#### Universal Power Supply 1% 120VAC - 277VAC

MODEL	POWER	OUTPUT
PDCU-D - IP20 Dry Series	30 - 30 W 60 - 60 W 96 - 96 W 3X96 - 3X96 W	24 - 24 VDC
PDCU-W - IP66 Wet Series	96 - 96 W 3X96 - 3X96 W	

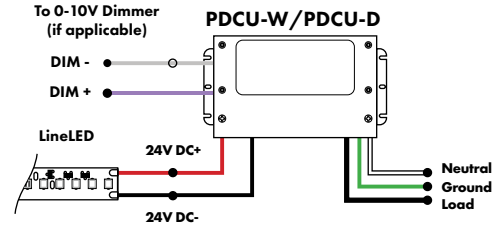

0-10V dims down to 1%, MLV/ELV/TRIAC dims down to 1%.  
For a complete list of compatible dimmers, see [Compatible Dimming Chart](#) on the Resources page.

MODELS	PDCU-W 96W	PDCU-W 3X96W	PDCU-D 30W	PDCU-D 60W	PDCU-D 96W	PDCU-D 3X96W
<b>Length</b>	8.66"	11.85"	6.10"	7.93"	8.25"	9.57"
<b>Width</b>	3.73"	4.32"	3.35"	3.35"	4.10"	5.94"
<b>Depth</b>	1.61"	1.81"	1.33"	1.32"	1.56"	1.13"

### For use with RGB/RGBW, RGB42/RGBW36 or with Tunable White

#### DMX 0% Dimming Power Supplies 120VAC - 277VAC

MODEL	POWER	OUTPUT
PSDMX-DMX Power Supply dims down to 0%	96 - 96 Watt 3X96 - 3 X 96 Watt	24-24 VDC

MODELS	96W	3X96
<b>A Length</b>	14.40"	15.75"
<b>B Width</b>	5.20"	6.62"
<b>Depth</b>	2.60"	4.95"

Features eldoLED's LINEARdrive configurable dimmable drivers.  
DDMX-RGBW DMX Decoder not required when purchasing this power supply.

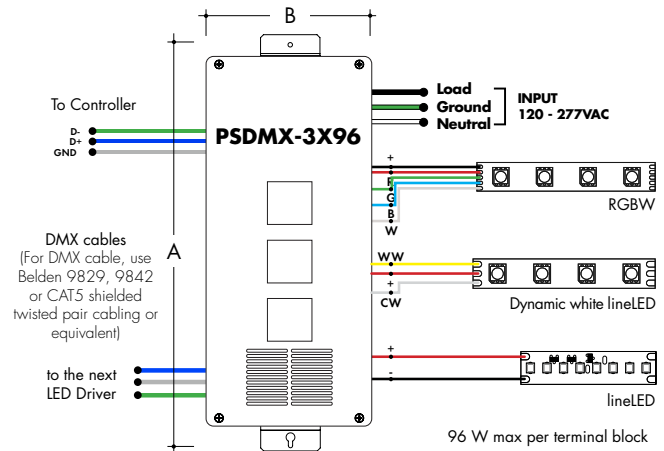
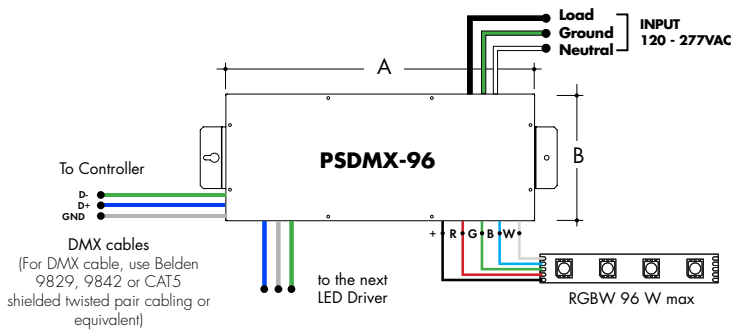

**For use with Tunable White**

**Customizable Dim to Warm or Variable White via 0 - 10V**  
(for tunable white or warm dimming control of Dynamic option)

MODEL	POWER	OUTPUT	CONTROL
PS010VD-0-10 LED Driver	96-96 Watt	24-24 VDC	WW-Standard One Channel - Dim To Warm Curve W2C-Standard Two Channel - Dim 1: Intensity; Dim 2: CCT W21 - Standard Two Channel - Dim 1: Warm Channel Intensity; Dim 2: Cool Channel Intensity W1X- Custom One Channel - Dim To Warm Curve W2X- Custom two Channel - Dim 1: Intensity; Dim 2: CCT

MODELS	96W	3X96
<b>Length</b>	14.40"	15.0"
<b>Width</b>	5.20"	6.61"
<b>Depth</b>	2.60"	4.56"

Requires a 0-10V controller to work properly

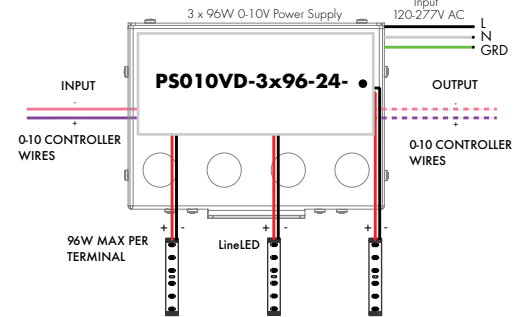
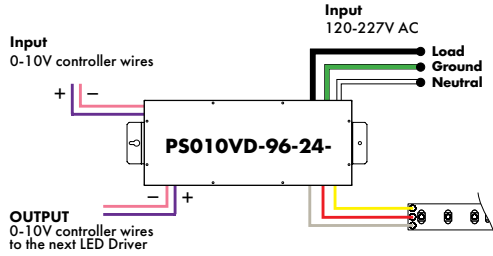

**For use with Tunable White**

**DALI DT8 LED Driver, 120VAC - 277VAC**

MODEL	POWER	OUTPUT
PSDALI-DT8-DALI-DT8 LED Driver	96-96 Watt	24-24 VDC

Requires a controller and a decoder to work properly

MODELS	96W
<b>A Length</b>	14.40"
<b>B Width</b>	5.20"
<b>Depth</b>	2.60"

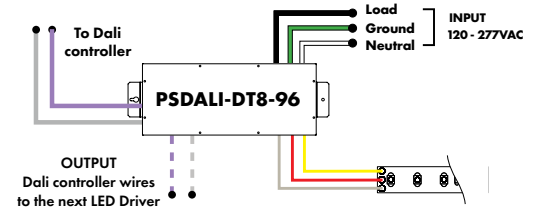

**For use with RGB/RGBW/Pixel**

**Non-Dimming Power Supply 120VAC - 277VAC**

MODEL	POWER	OUTPUT	DIMMING	LOCATION
PSV-PSV Series	96-96 Watt	24-24 VDC	ND-Non Dimming	D-Dry location

Requires a controller and a decoder to work properly

MODELS	96W
<b>A Length</b>	14.40"
<b>B Width</b>	5.20"
<b>Depth</b>	2.60"

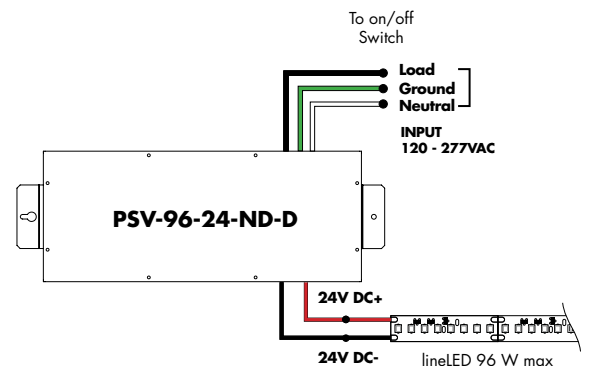

## Power Supplies

See fixture and power supply instructions & spec sheet for wiring information. Dimming possible in select models - view Luminii website for list of compatible dimmers.

## DMX-1Z-RGBW, DMX-3Z-RGBW

RGBW LED 1 or 3 Zone Controller



ORDERING CODE

MODEL	ZONES	COLOR
DMX - DMX Controller	3Z - Three Zone 1Z - One Zone	RGBW - Red, Green, Blue, & White

DMX /Wireless RGB-W wall-mount controller controls DMX lighting fixtures, wireless control of RGB-W lighting fixture or use both simultaneously. Fits in any standard US switch box. Includes all the outputs in the back of the controller.

Control brightness levels with a single touch, personalize and memorize 3 different scenes, and even create 3 variations of white.

### Features

- 2 in 1 in-Wall Controller: DMX Control or Wireless RGB-W
- 65,000 Color Options, Dimming and Speed Control
- Memory Function
- 50 Foot Wireless Range
- Easily Fits Standard US Switch Boxes
- Touch Sensitive Glass Surface
- Includes 10 Built in Programs, or Create and Play Your Own

### Operating Voltage

12 - 24V DC

### Color Parameters

- Brightness
- Saturation
- Primary colors
- Fading
- Color changing speed

## Touch DMX Controller

Touchscreen digital LED controller

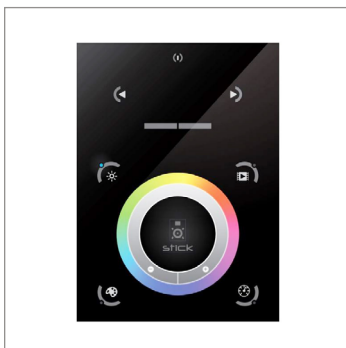

MODEL

**TSDMX-E**

TSDMX-E - Touchscreen DMX controller

Programmable advanced DMX512 lighting controller featuring a touch-screen interface. Operates as stand alone controller or integrated with most architectural lighting control systems. Can controller endless DMX512 enabled devices.

Mounts to standard single or dual gang wall box with the included power supply inside the junction box. Terminal block design for power and data connections.

### Features

- Sleek glass design which sits 0.43" from the wall
- Graphical color display to show selected environment
- Color/dimmer/speed palette
- Color temperature mixing
- Touch sensitive buttons. No mechanical parts
- Touch sensitive wheel allows for accurate color selection
- Multi-zone microSD memory
- Multi-room control with 500 scenes, 10 zones
- 1024 DMX channels. Control 340 RGB fixtures
- USB & Ethernet connectivity for programming and control

### Power Supply

7 VDC (included)

### Programmability

PC, Mac, Tablet, Smartphone

### Output Signal

DMX512 (1024 channels)

### Color Parameters

- Brightness
- Saturation
- Speed of color changing sequence
- Fading / dimming / brightness

## DMX Decoder

DMX signal to RGBW decoder (required to operate DMX controller)

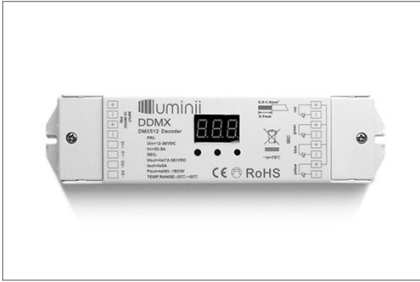

ORDERING CODE

MODEL

**DDMX-RGBW**

DDMX-RGBW - DMX decoder

Translates controller DMX512 programs for RGB and white LED strips.

Unique DMX address for the decoder can be set easily and displayed by the numeric display on the case. Changing and resetting the DMX address requires manual input.

Use power repeater to expand output.

**Operating Voltage**

12-36 VDC

**Power Capacity**

up to 96W at 24V

**Operating Temperature Range**

from -4°F to +122°F in case

## Smart Pixel Decoder

SPI signal to DMX signal decoder



Model

**SR-DMX-SPI**

SR-DMX-SPI - Smart Pixel Decoder

The SR-DMX-SPI is a smart LED pixel decoder that controls RGB/RGBW pixel LED strips with SPI signal. Designed with an OLED backlit panel, the pixel controller allows for easy configuration of most settings. Four push buttons are available for control of the LED functions.

\*For pixel only.

**Features**

- 2 in 1 in-Wall Controller: DMX Control or Wireless RGB-W
- SPI signal output for RGB/RGBW pixel light control
- DMX512 controllable and RF/WIFI remote controllable
- Capable of addressing up to 1020 RGB pixels & 765 RGB pixels
- OLED panel allows for easy configuration

**Operating Voltage**

12 - 36V DC

**Power capacity**

up to 96W at 24V

**Operating temperature range**

from -4°F to +122°F in case