



Features

- The Luminii Knife Edge system produces an elegant, seamless sharp-edged architectural feature with uniform lighting on adjacent surfaces.
- Accepts 5/8" thick drywall on its underside. architectural reveals, accent lighting and surface mount applications
- Create a soft diffused illumination, color tuning or an asymmetrical forward distribution by selecting the desired beam control offering.
- Integrated asymmetric light engine or soft perimeter glow
- Factory cut to length
- Factory built precision Inside and Outside Corners
- Painted Eggshell RAL 9010 with primer to accept field painting
- 5 Year Warranty



Warm Dimming

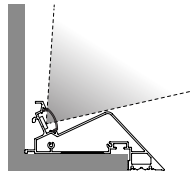
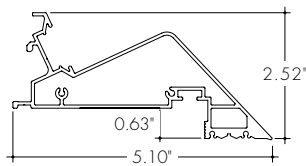

Technical Information

TYPE	Warm Dim
OUTPUT OPTIONS	WD68SO (19K-27K)
Lumens Output (all channels full on) <small>(with a Clear Lens)</small>	192 lm/ft
Average Power Consumption <small>(for a 4' section)</small>	5.4 W/ft
Efficacy	36 lm/W
Max Run Length <small>(in series)</small>	20 ft
Max Ambient Temperature*	50°C [122°F]
Control/Dimming Protocol	MLV, ELV, Inc.

*Max Ambient Temperature to maintain L70 of 50k+ hours. Exceeding Max Ambient Temperature may result in decreased life/output. Consult Technical Support for specific inquiries.

Warm Dim (WD68)

CCT	TM-30			
	CRI	R _f	R _g	R ₉
1900K	96	92	96	94
2400K	97	96	103	98
2700K	96	93	106	95

Ordering Code

MODEL	LENGTH ¹	OUTPUT	CCT	LEFT END	RIGHT END	POWER FEED
KE - Knife Edge	12"-84" 3" increments	WD68SO - Standard	19K27K - 1900K - 2700K	LE - With End Cap LN - Without End Cap LNJ - Without End Cap, with Jumper	RE - With End Cap RN - Without End Cap RNJ - Without End Cap, with Jumper	LB - Left Back RB - Right Back NPF - No Powerfeed ²

1 - Custom lengths and increments are available, please consult Inside Sales with specific request.
2 - Cant be paired with LE - RE option

Knife Edge Corner Options

KE-IC
Inner Corner

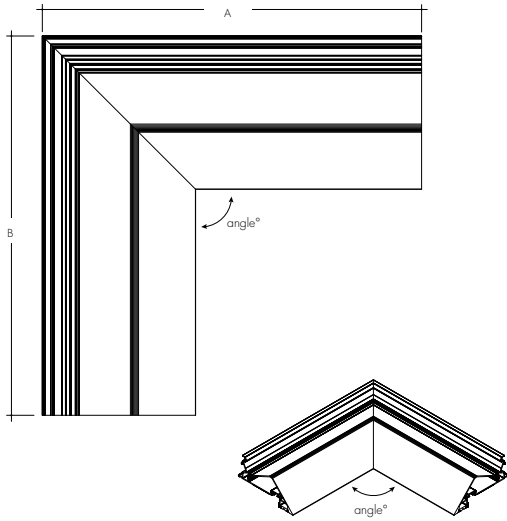

KE-OC
Outside Corner

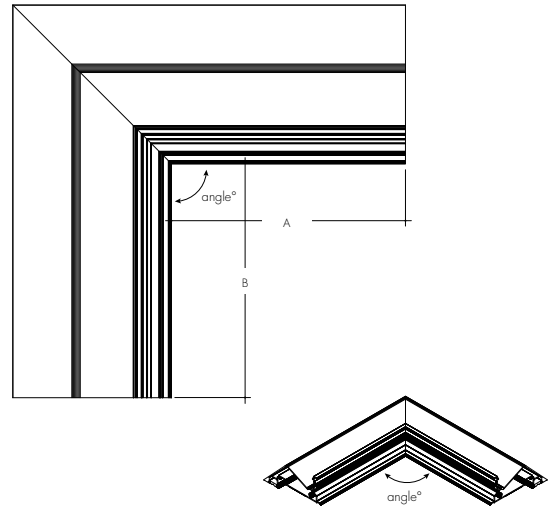

Warm Dimming	Actual Length		Total Wattage
	A	B	WD68SO
Inner (KE-IC)	13 4/16	13 4/16	10.2
Outer (KE-OC)	11 14/16	11 14/16	10.2

Ordering Code

MODEL	LENGTH ¹	MODEL	OUTPUT	CCT	LEFT END	RIGHT END	POWER FEED
KE - Knife Edge	IC - Inner Corner OC - Outer Corner	90 - 90° Corner C - Custom Angle Corner ¹	WD68SO - Standard	19K27K - 1900K - 2700K	LE - With End Cap LN - Without End Cap LNJ - Without End Cap, with Jumper	RE - With End Cap RN - Without End Cap RNJ - Without End Cap, with Jumper	LB - Left Back RB - Right Back NPF - No Powerfeed ²

1 - Custom Angle Corners are available, please consult Inside Sales with specific request.
2 - Cant be paired with LE - RE option

Product Dimensions

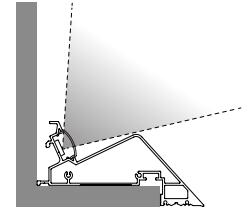
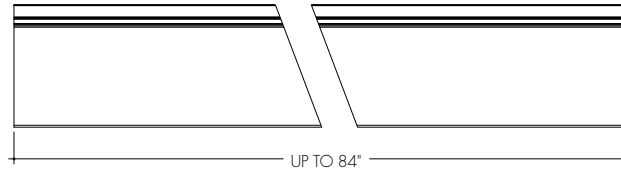
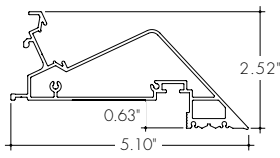

Powerfeeds and Connectors

Linking and Extension Cable Options

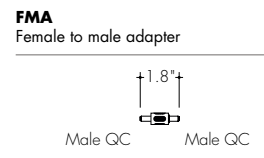
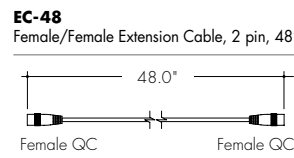
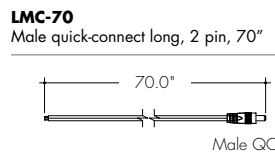
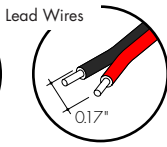
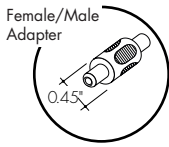
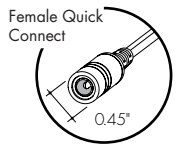

Powerfeeds Position/Type

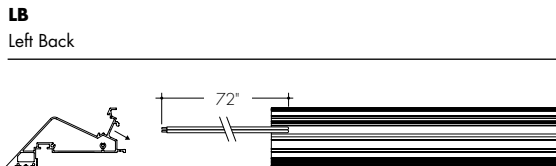
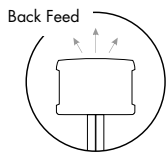

Light Transmission and Dotting

Output Options	Lens/Accessory	
	Clear Lens	Frosted Lens
WD68SO (19K)	CD	ND
WD68SO (27K)	CD	ND
Transmission Percentage	114%	100%

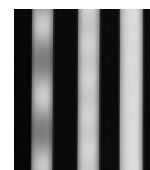

CD SD ND
 CD - Clear Dotting
 SD - Slight Dotting
 ND - No Dotting

Layout Example

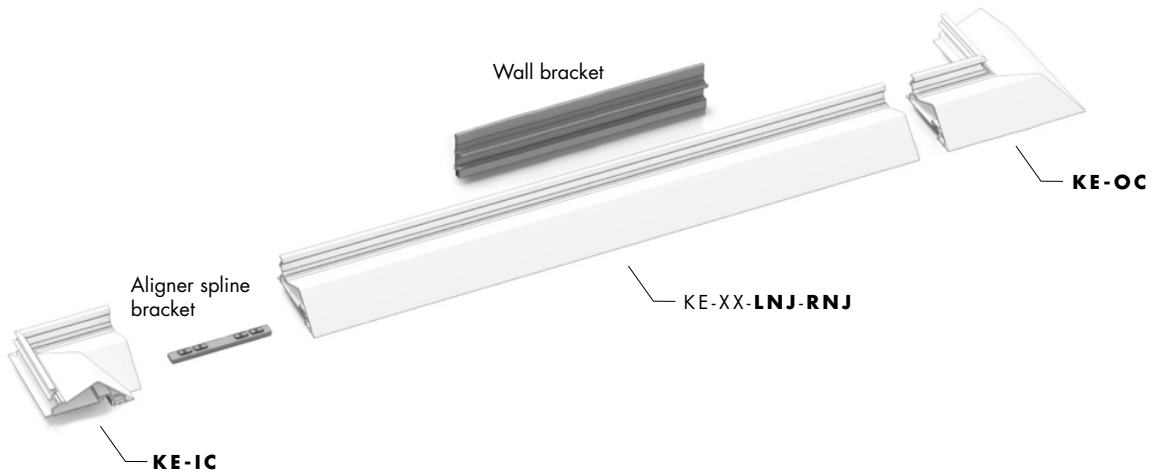
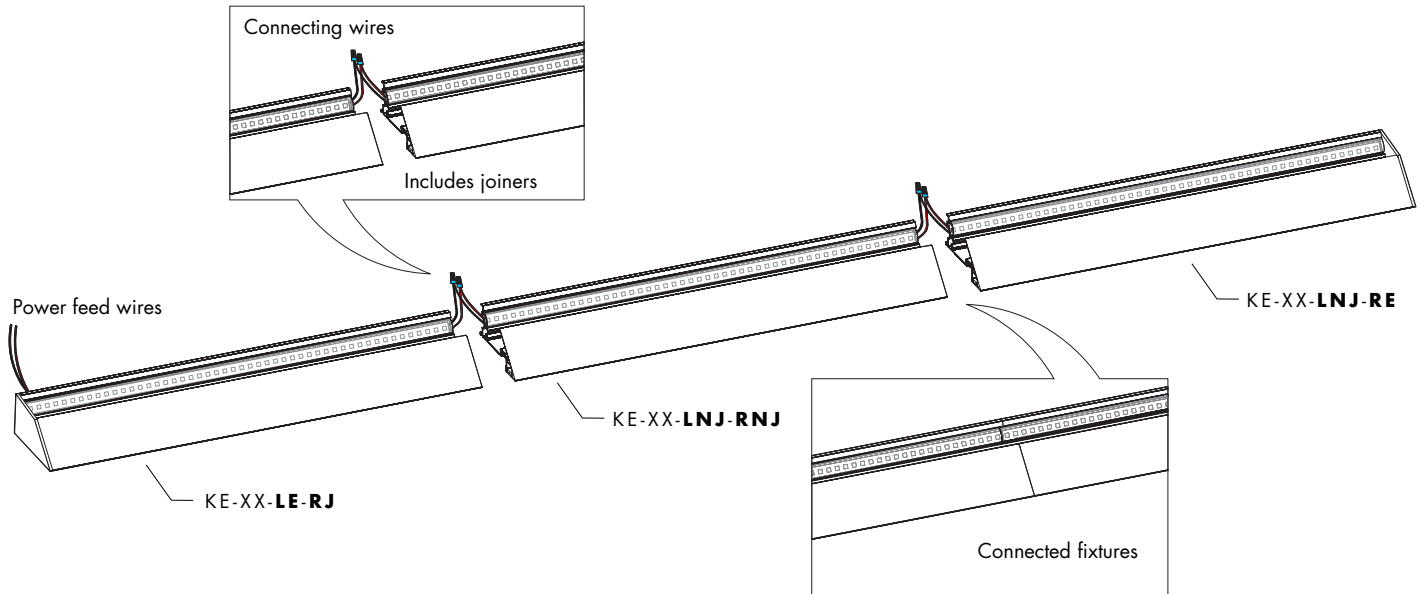

Power Consumption

Tested at Full Power with PDC Series power supplies.

*For Back Feed add 4/16" (1/4") to Actual Length. Standard Nominal Lengths offered provide minimal shadowing. For alternate lengths, please consult Inside Sales with specific request.

Warm Dim (WD68)

Nominal Length (in)	Side and End Feed Actual Length*	Watts	Nominal Length (in)	Side and End Feed Actual Length*	Watts	Nominal Length (in)	Side and End Feed Actual Length*	Watts
		SO			SO			SO
12	10 12/16	4.6	47	-	-	82	-	-
13	-	-	48	47 11/16	21.0	83	82 2/16	34.8
14	13 4/16	5.8	49	-	-	84	-	-
15	-	-	50	-	-			
16	15 11/16	6.9	51	50 2/16	22.0			
17	-	-	52	-	-			
18	-	-	53	52 10/16	23.0			
19	18 2/16	8.0	54	-	-			
20	-	-	55	-	-			
21	20 10/16	9.1	56	55 1/16	24.1			
22	-	-	57	-	-			
23	-	-	58	57 8/16	25.1			
24	23 1/16	10.2	59	-	-			
25	-	-	60	60	26.1			
26	25 9/16	11.3	61	-	-			
27	-	-	62	-	-			
28	28	12.3	63	62 7/16	27.1			
29	-	-	64	-	-			
30	-	-	65	64 14/16	28.0			
31	30 7/16	13.4	66	-	-			
32	-	-	67	-	-			
33	32 15/16	14.5	68	67 6/16	29.0			
34	-	-	69	-	-			
35	-	-	70	69 13/16	30.0			
36	35 6/16	15.6	71	-	-			
37	-	-	72	-	-			
38	37 13/16	16.7	73	72 5/16	30.9			
39	-	-	74	-	-			
40	-	-	75	74 12/16	32.0			
41	40 5/16	17.8	76	-	-			
42	-	-	77	-	-			
43	42 12/16	18.9	78	77 3/16	33.1			
44	-	-	79	-	-			
45	-	-	80	79 11/16	33.9			
46	45 3/16	20.0	81	-	-			

Voltage Drop Calculator

The below chart assumes nominal voltage of 24 Volts and a Voltage Drop Allowance of 3% through the wire

Wattage [W]	Maximum Wire Length From Power Supply to Start of Run [ft]						
	12 AWG	14 AWG	16 AWG	18 AWG	20 AWG	22 AWG	24 AWG
5	1088.2	684.4	430.3	270.6	170.2	107.1	67.3
10	544.1	342.2	215.1	135.3	85.1	53.5	33.7
15	362.7	228.1	143.4	90.2	56.7	35.7	22.4
20	272.0	171.1	107.6	67.7	42.6	26.8	16.8
25	217.6	136.9	86.1	54.1	34.0	21.4	13.5
30	181.4	114.1	71.7	45.1	28.4	17.8	11.2
35	155.5	97.8	61.5	38.7	24.3	15.3	9.6
40	136.0	85.5	53.8	33.8	21.3	13.4	8.4
45	120.9	76.0	47.8	30.1	18.9	11.9	7.5
50	108.8	68.4	43.0	27.1	17.0	10.7	6.7
55	98.9	62.2	39.1	24.6	15.5	9.7	6.1
60	90.7	57.0	35.9	22.6	14.2	8.9	5.6
65	83.7	52.6	33.1	20.8	13.1	8.2	5.2
70	77.7	48.9	30.7	19.3	12.2	7.6	4.8
75	72.5	45.6	28.7	18.0	11.3	7.1	4.5
80	68.0	42.8	26.9	16.9	10.6	6.7	4.2
85	64.0	40.3	25.3	15.9	10.0	6.3	4.0
90	60.5	38.0	23.9	15.0	9.5	5.9	3.7
96	56.7	35.6	22.4	14.1	8.9	5.6	3.5

Power Supplies

See Power Supply instructions and spec sheet for wiring information. For a complete list of compatible dimmers, see Compatible Dimming Chart on the Resources page.

Triac, MLV, ELV Compatible Dimmers

MODEL	POWER	OUTPUT
PDC - (IP20) Power Supply	96 - 96 Watts	24 - 24 VDC

MODELS	96W
Length	8.25"
Width	4.10"
Depth	1.56"

