

Features

Kurba 3 Side Emitting is a direct view, small profile, energy efficient and flexible LED strip suitable for wet locations capable of vertical bends up to 6" radius. Built with robust factory made power feeds or joiners, Kurba 3 Side Emitting mounts to a specifically designed aluminum extruded channel.

Output Options

- Tunable White allows individual control of CCT and output
- RGB options offer balanced output across the color gamut and a true white with RGBW
- Smart Pixel offerings allow for infinite color combinations with cascading and chasing effects

Average Life (L70)

50,000 hours

Approvals

24VDC Class 2 wet listed, IP67

Warranty

3 years

Finish Options (see page 2 for additional information)

Base White

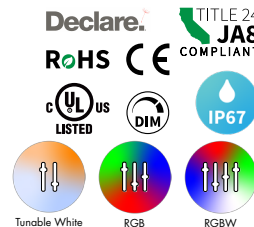

Technical Information

Output	TW4450	RGB2650	RGBW2650
Light Output at 3000K	258 lm/ft	195 lm/ft	316 lm/ft
Average Power Consumption at 4'	3.66 W/ft	3.66 W/ft	4.57 W/ft
Efficacy	70 lm/W	53 lm/W	69 lm/W
Ordering Increment	3.28"	3.28"	3.28"
Maximum Run Length (In Series)	26'	26'	19'
Operating Temperature Range	-40°F to 131°F	-40°F to 131°F	-40°F to 131°F
Control/Dimming Protocol	0-10V, DMX	DMX	DMX

Constraints

Vertical Bend Direction

Bend LED in these positions only to avoid damage

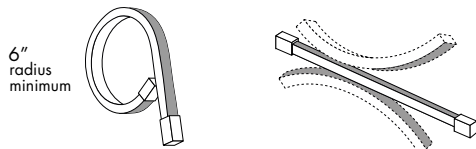

Vertical Prohibited Bends

Twisting or bending LED in these positions will cause damage

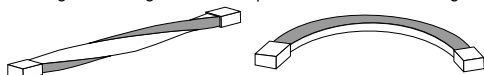

Do not make sharp bends near the endcap

Ordering Code

MODEL	RATING ¹	BEND DIRECTION	LENGTH	OUTPUT ¹	CCT	LENS ³	MOUNTING	FINISH	FEED POSITION LEFT	FEED POSITION RIGHT
KBL - Kurba Large	W - Wet	VB - Vertical Bending	SEE PCC CHART ON PAGES 5 - 7	TW4450 - Tunable White, Standard Output RGB2650 - RGB, Standard Output RGBW2650 - RGBW, Standard Output	22K57K - 2200K-5700K RGB - Red, Green, Blue RGB27K - RGB 2700K RGB30K - RGB 3000K RGB40K - RGB 4000K	3SF - 3-Side Emitting Silicone Frosted	NA - See Page 4 for orderable mounting accessories	WH - White	INJECTION MOLD IME - End Feed 1 IMB - Back Feed 1 IMSA - Side 1 Feed IMSB - Side 2 Feed NPF - No Power Feed ²	INJECTION MOLD IME - End Feed 1 IMB - Back Feed 1 IMSA - Side 1 Feed IMSB - Side 2 Feed NPF - No Power Feed ²

Feeds come with 90" wire leads

¹ - Title 24 JA8 compliant depending on Output, CCT, and lens selections. See Technical Information and Lens Transmission charts to calculate specific efficacies.
² - NPF-NPF for Feed Position 1&2 is not a valid configuration option

Powerfeeds and Connectors

Power Feed Position Options and Orientation

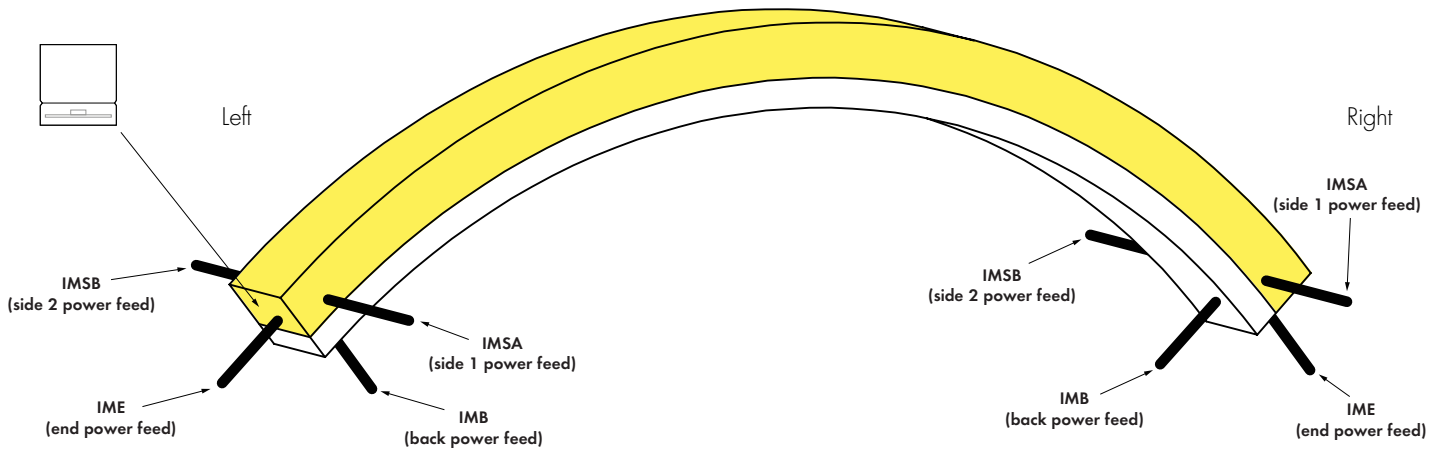

Linking and Extension Cable Options

END CONNECTOR

Injection-molded End Connector
-IME

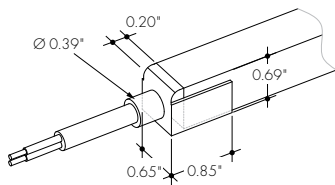

BACK CONNECTOR

Injection-molded Back Connector
-IMB

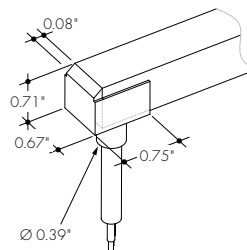

SIDE CONNECTOR

Injection-molded Side Connector
-IMSA and -IMSB

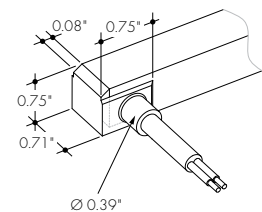

ENDCAP (NO CONNECTOR)

Injection-molded Cap (No Connector)
-NPF

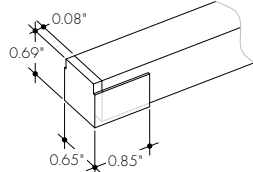

ANTI-WICKING FERRULE

Included on every power feed wire

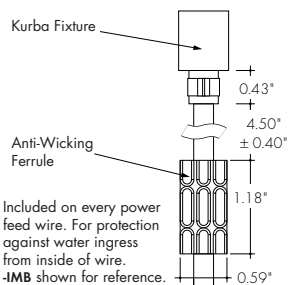

Included on every power feed wire. For protection against water ingress from inside of wire.
-IMB shown for reference.

Product Dimensions

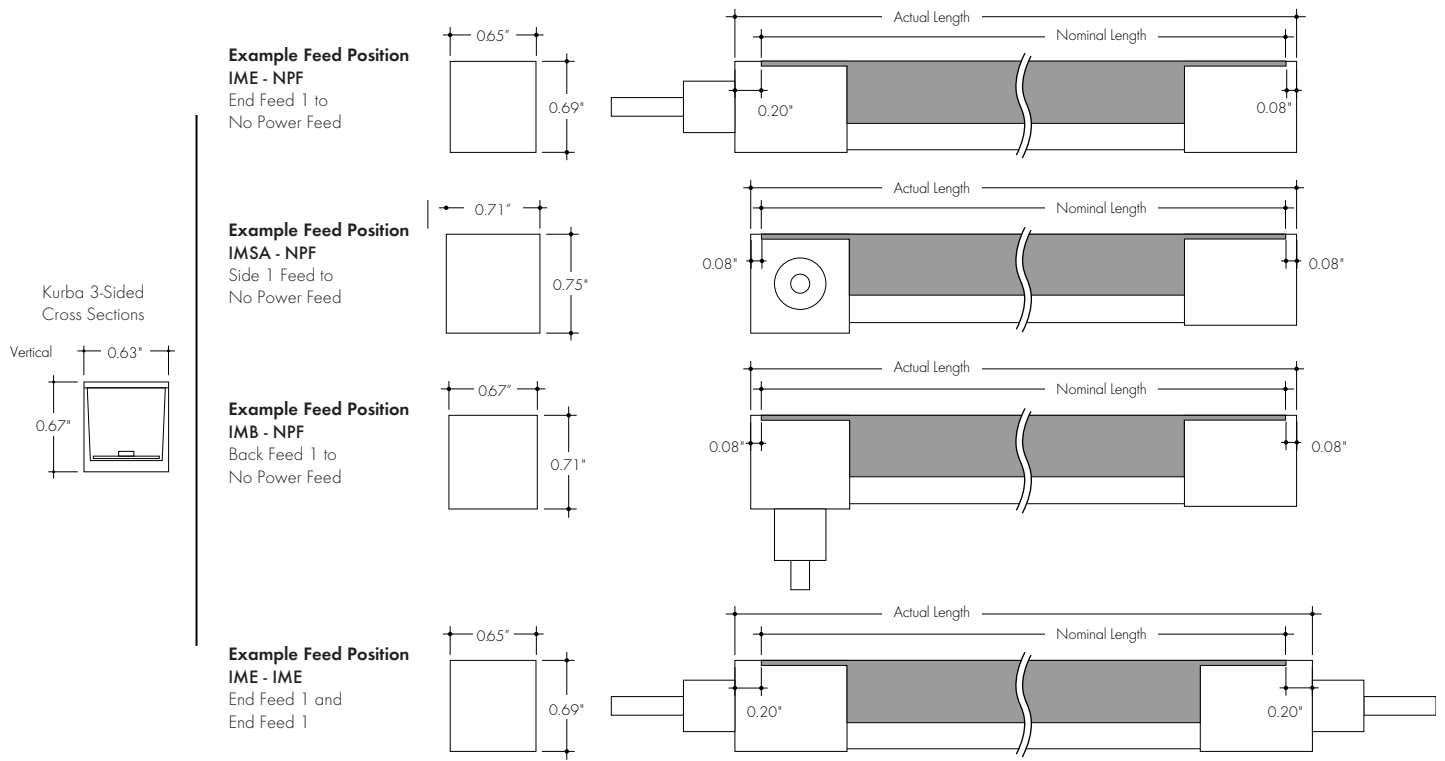

Finish Options

White
Base

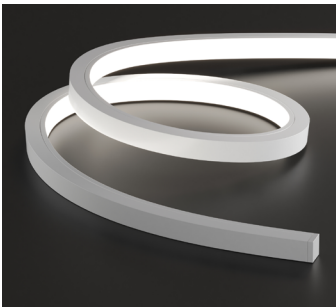

Kurba's base finish is a crisp white which brings a timeless, clean aesthetic that brightens and enhances any space

Light Transmission and Dotting

	Lens/Accessory
Output Options	Silicone Frosted/ White Finish
TW44SO	ND
RGB26SO	ND
RGBW26SO	ND
Transmission Percentage	100%



CD SD ND
CD - Clear Dotting
SD - Slight Dotting
ND - No Dotting

Mounting Accessories and Optional Connectors

MC-KBL-3SF-SAP-SM-0.8-SA

KBL 3-Side Emitting Mounting Channel, Serrated Aluminum Profile, Surface Mount, 0.8in, Silver Anodized

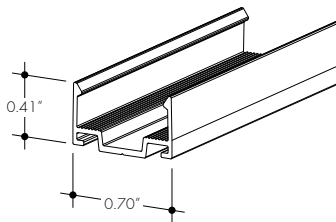

MC-KBL-3SF-SAP-SM-78-SA

KBL 3-Side Emitting Mounting Channel, Serrated Aluminum Profile, Surface Mount, 78in, Silver Anodized

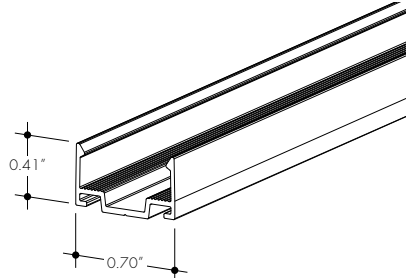

MC-KBL-3SF-BSAP-VB-SM-38-SA

KBL 3-Side Emitting Mounting Channel, Bendable Serrated Aluminum Profile, Vertical Bending, Surface Mount, 38in, Silver Anodized

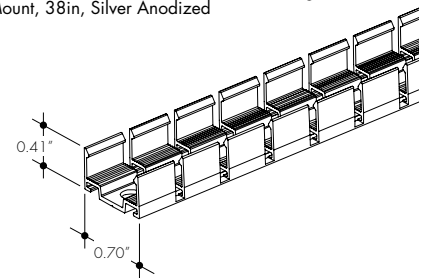

LVSP-WET

Splice box: wet rated, low voltage, gray

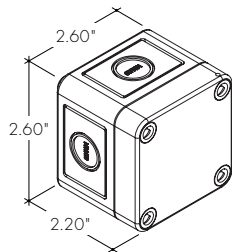

LVSP-WET-CM

Connector for splice box, low voltage for cable management, gray

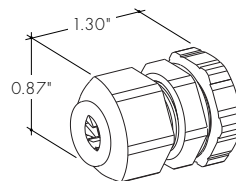

TW44SO | Power Consumption Per Fixture Length

Based on operation with PDCU series of power supplies. Use Actual Length for Order Code Entry.
 Tolerance for Actual Lengths less than 6 ft is +/- 0.2", Actual Lengths between 6 ft and 16 ft is +/- 0.3", and Actual Lengths greater than 16 ft is +/- 0.6"
 A - End Connector at both ends of Kurba (0.20" + 0.20" added to overall length)
 B - End Connector at one end of Kurba and No Connector or Back Connector or Side Connector at other end of Kurba (0.20" + 0.08" added to overall length)
 C - Any combination of No Connector, Back Connector, or Side Connector on each end of Kurba (0.08" + 0.08" added to overall length)

Nominal Length (in)	Actual Length (in)				Nominal Length (in)	Actual Length (in)				Nominal Length (in)	Actual Length (in)			
	W	A	B	C		W	A	B	C		W	A	B	C
7	2.1	7.0	6.8	6.7	125	38.1	125.1	124.9	124.8	243	74.1	243.2	243.1	242.9
10	3.1	10.2	10.1	10.0	128	39.1	128.3	128.2	128.1	246	75.1	246.5	246.3	246.2
(1 ft) 14	4.1	13.5	13.4	13.3	(11 ft) 132	40.1	131.6	131.5	131.4	250	76.1	249.7	249.6	249.5
17	5.1	16.8	16.7	16.6	135	41.1	134.9	134.8	134.7	(21 ft) 253	77.1	253.0	252.9	252.8
20	6.1	20.1	20.0	19.8	138	42.1	138.2	138.1	137.9	256	78.1	256.3	256.2	256.1
(2 ft) 23	7.1	23.4	23.2	23.1	141	43.1	141.5	141.4	141.2	260	79.1	259.6	259.5	259.3
27	8.1	26.6	26.5	26.4	(12 ft) 145	44.1	144.8	144.6	144.5	(22 ft) 263	80.1	262.9	262.7	262.6
30	9.1	29.9	29.8	29.7	148	45.1	148.0	147.9	147.8	266	81.1	266.1	266.0	265.9
33	10.1	33.2	33.1	33.0	151	46.1	151.3	151.2	151.1	269	82.1	269.4	269.3	269.2
(3 ft) 36	11.1	36.5	36.4	36.2	(13 ft) 155	47.1	154.6	154.5	154.4	273	83.1	272.7	272.6	272.5
40	12.1	39.8	39.6	39.5	158	48.1	157.9	157.8	157.6	(23 ft) 276	84.1	276.0	275.9	275.7
43	13.1	43.0	42.9	42.8	161	49.1	161.2	161.0	160.9	279	85.1	279.3	279.1	279.0
46	14.1	46.3	46.2	46.1	164	50.1	164.4	164.3	164.2	282	86.1	282.5	282.4	282.3
(4 ft) 50	15.1	49.6	49.5	49.4	(14 ft) 168	51.1	167.7	167.6	167.5	286	87.1	285.8	285.7	285.6
53	16.1	52.9	52.8	52.7	171	52.1	171.0	170.9	170.8	(24 ft) 289	88.1	289.1	289.0	288.9
56	17.1	56.2	56.1	55.9	174	53.1	174.3	174.2	174.0	292	89.1	292.4	292.3	292.1
(5 ft) 59	18.1	59.5	59.3	59.2	178	54.1	177.6	177.4	177.3	296	90.1	295.7	295.5	295.4
63	19.1	62.7	62.6	62.5	(15 ft) 181	55.1	180.8	180.7	180.6	(25 ft) 299	91.1	298.9	298.8	298.7
66	20.1	66.0	65.9	65.8	184	56.1	184.1	184.0	183.9	302	92.1	302.2	302.1	302.0
69	21.1	69.3	69.2	69.1	187	57.1	187.4	187.3	187.2	305	93.1	305.5	305.4	305.3
(6 ft) 73	22.1	72.6	72.5	72.3	(16 ft) 191	58.1	190.7	190.6	190.4	309	94.1	308.8	308.7	308.5
76	23.1	75.9	75.7	75.6	194	59.1	194.0	193.8	193.7	(26 ft) 312	95.1	312.1	311.9	311.8
79	24.1	79.1	79.0	78.9	197	60.1	197.2	197.1	197.0					
(7 ft) 82	25.1	82.4	82.3	82.2	200	61.1	200.5	200.4	200.3					
86	26.1	85.7	85.6	85.5	(17 ft) 204	62.1	203.8	203.7	203.6					
89	27.1	89.0	88.9	88.7	207	63.1	207.1	207.0	206.8					
92	28.1	92.3	92.1	92.0	210	64.1	210.4	210.2	210.1					
(8 ft) 96	29.1	95.5	95.4	95.3	214	65.1	213.6	213.5	213.4					
99	30.1	98.8	98.7	98.6	(18 ft) 217	66.1	216.9	216.8	216.7					
102	31.1	102.1	102.0	101.9	220	67.1	220.2	220.1	220.0					
105	32.1	105.4	105.3	105.1	223	68.1	223.5	223.4	223.2					
(9 ft) 109	33.1	108.7	108.5	108.4	(19 ft) 227	69.1	226.8	226.6	226.5					
112	34.1	111.9	111.8	111.7	230	70.1	230.0	229.9	229.8					
115	35.1	115.2	115.1	115.0	233	71.1	233.3	233.2	233.1					
(10 ft) 118	36.1	118.5	118.4	118.3	237	72.1	236.6	236.5	236.4					
122	37.1	121.8	121.7	121.5	(20 ft) 240	73.1	239.9	239.8	239.7					

Note: all values are rounded to the nearest 0.1 inch

Endcap (No Connector) -NPF

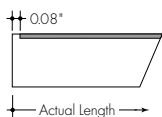

End Connector -IME

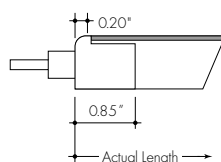

Back Connector -IMB

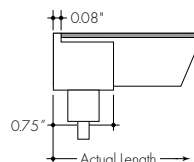

Side Connector -IMSA -IMSB

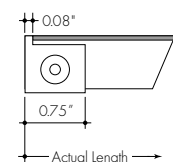

RGB26SO | Power Consumption Per Fixture Length

Based on operation with PDCU series of power supplies. Use Actual Length for Order Code Entry.
 Tolerance for Actual Lengths less than 6 ft is +/- 0.2", Actual Lengths between 6 ft and 16 ft is +/- 0.3", and Actual Lengths greater than 16 ft is +/- 0.6"
 A - End Connector at both ends of Kurba (0.20" + 0.20" added to overall length)
 B - End Connector at one end of Kurba and No Connector or Back Connector or Side Connector at other end of Kurba (0.20" + 0.08" added to overall length)
 C - Any combination of No Connector, Back Connector, or Side Connector on each end of Kurba (0.08" + 0.08" added to overall length)

Nominal Length (in)	Actual Length (in)				Nominal Length (in)	Actual Length (in)				Nominal Length (in)	Actual Length (in)			
	W	A	B	C		W	A	B	C		W	A	B	C
7	2.1	7.0	6.8	6.7	125	38.1	125.1	124.9	124.8	243	74.1	243.2	243.1	242.9
10	3.1	10.2	10.1	10.0	128	39.1	128.3	128.2	128.1	246	75.1	246.5	246.3	246.2
(1 ft) 14	4.1	13.5	13.4	13.3	(11 ft) 132	40.1	131.6	131.5	131.4	250	76.1	249.7	249.6	249.5
17	5.1	16.8	16.7	16.6	135	41.1	134.9	134.8	134.7	(21 ft) 253	77.1	253.0	252.9	252.8
20	6.1	20.1	20.0	19.8	138	42.1	138.2	138.1	137.9	256	78.1	256.3	256.2	256.1
(2 ft) 23	7.1	23.4	23.2	23.1	141	43.1	141.5	141.4	141.2	260	79.1	259.6	259.5	259.3
27	8.1	26.6	26.5	26.4	(12 ft) 145	44.1	144.8	144.6	144.5	(22 ft) 263	80.1	262.9	262.7	262.6
30	9.1	29.9	29.8	29.7	148	45.1	148.0	147.9	147.8	266	81.1	266.1	266.0	265.9
33	10.1	33.2	33.1	33.0	151	46.1	151.3	151.2	151.1	269	82.1	269.4	269.3	269.2
(3 ft) 36	11.1	36.5	36.4	36.2	(13 ft) 155	47.1	154.6	154.5	154.4	273	83.1	272.7	272.6	272.5
40	12.1	39.8	39.6	39.5	158	48.1	157.9	157.8	157.6	(23 ft) 276	84.1	276.0	275.9	275.7
43	13.1	43.0	42.9	42.8	161	49.1	161.2	161.0	160.9	279	85.1	279.3	279.1	279.0
46	14.1	46.3	46.2	46.1	164	50.1	164.4	164.3	164.2	282	86.1	282.5	282.4	282.3
(4 ft) 50	15.1	49.6	49.5	49.4	(14 ft) 168	51.1	167.7	167.6	167.5	286	87.1	285.8	285.7	285.6
53	16.1	52.9	52.8	52.7	171	52.1	171.0	170.9	170.8	(24 ft) 289	88.1	289.1	289.0	288.9
56	17.1	56.2	56.1	55.9	174	53.1	174.3	174.2	174.0	292	89.1	292.4	292.3	292.1
(5 ft) 59	18.1	59.5	59.3	59.2	178	54.1	177.6	177.4	177.3	296	90.1	295.7	295.5	295.4
63	19.1	62.7	62.6	62.5	(15 ft) 181	55.1	180.8	180.7	180.6	(25 ft) 299	91.1	298.9	298.8	298.7
66	20.1	66.0	65.9	65.8	184	56.1	184.1	184.0	183.9	302	92.1	302.2	302.1	302.0
69	21.1	69.3	69.2	69.1	187	57.1	187.4	187.3	187.2	305	93.1	305.5	305.4	305.3
(6 ft) 73	22.1	72.6	72.5	72.3	(16 ft) 191	58.1	190.7	190.6	190.4	309	94.1	308.8	308.7	308.5
76	23.1	75.9	75.7	75.6	194	59.1	194.0	193.8	193.7	(26 ft) 312	95.1	312.1	311.9	311.8
79	24.1	79.1	79.0	78.9	197	60.1	197.2	197.1	197.0					
(7 ft) 82	25.1	82.4	82.3	82.2	200	61.1	200.5	200.4	200.3					
86	26.1	85.7	85.6	85.5	(17 ft) 204	62.1	203.8	203.7	203.6					
89	27.1	89.0	88.9	88.7	207	63.1	207.1	207.0	206.8					
92	28.1	92.3	92.1	92.0	210	64.1	210.4	210.2	210.1					
(8 ft) 96	29.1	95.5	95.4	95.3	214	65.1	213.6	213.5	213.4					
99	30.1	98.8	98.7	98.6	(18 ft) 217	66.1	216.9	216.8	216.7					
102	31.1	102.1	102.0	101.9	220	67.1	220.2	220.1	220.0					
105	32.1	105.4	105.3	105.1	223	68.1	223.5	223.4	223.2					
(9 ft) 109	33.1	108.7	108.5	108.4	(19 ft) 227	69.1	226.8	226.6	226.5					
112	34.1	111.9	111.8	111.7	230	70.1	230.0	229.9	229.8					
115	35.1	115.2	115.1	115.0	233	71.1	233.3	233.2	233.1					
(10 ft) 118	36.1	118.5	118.4	118.3	237	72.1	236.6	236.5	236.4					
122	37.1	121.8	121.7	121.5	(20 ft) 240	73.1	239.9	239.8	239.7					

Note: all values are rounded to the nearest 0.1 inch

Endcap (No Connector) -NPF

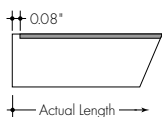

End Connector -IME

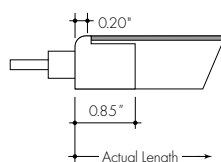

Back Connector -IMB

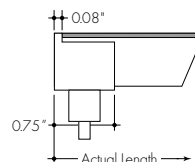

Side Connector -IMSA -IMSB

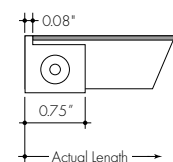

RGBW26SO | Power Consumption Per Fixture Length

Based on operation with PDCU series of power supplies. Use Actual Length for Order Code Entry.
 Tolerance for Actual Lengths less than 6 ft is +/- 0.2", Actual Lengths between 6 ft and 16 ft is +/- 0.3", and Actual Lengths greater than 16 ft is +/- 0.6"
 A - End Connector at both ends of Kurba (0.20" + 0.20" added to overall length)
 B - End Connector at one end of Kurba and No Connector or Back Connector or Side Connector at other end of Kurba (0.20" + 0.08" added to overall length)
 C - Any combination of No Connector, Back Connector, or Side Connector on each end of Kurba (0.08" + 0.08" added to overall length)

Nominal Length (in)	Actual Length (in)				Nominal Length (in)	Actual Length (in)			
	W	A	B	C		W	A	B	C
7	2.7	7.0	6.8	6.7	125	47.6	125.1	124.9	124.8
10	3.9	10.2	10.1	10.0	128	48.9	128.3	128.2	128.1
(1 ft) 14	5.1	13.5	13.4	13.3	(11 ft) 132	50.1	131.6	131.5	131.4
17	6.4	16.8	16.7	16.6	135	51.4	134.9	134.8	134.7
20	7.6	20.1	20.0	19.8	138	52.6	138.2	138.1	137.9
(2 ft) 23	8.9	23.4	23.2	23.1	141	53.9	141.5	141.4	141.2
27	10.1	26.6	26.5	26.4	(12 ft) 145	55.1	144.8	144.6	144.5
30	11.4	29.9	29.8	29.7	148	56.4	148.0	147.9	147.8
33	12.6	33.2	33.1	33.0	151	57.6	151.3	151.2	151.1
(3 ft) 36	13.9	36.5	36.4	36.2	(13 ft) 155	58.9	154.6	154.5	154.4
40	15.1	39.8	39.6	39.5	158	60.1	157.9	157.8	157.6
43	16.4	43.0	42.9	42.8	161	61.4	161.2	161.0	160.9
46	17.6	46.3	46.2	46.1	164	62.6	164.4	164.3	164.2
(4 ft) 50	18.9	49.6	49.5	49.4	(14 ft) 168	63.9	167.7	167.6	167.5
53	20.1	52.9	52.8	52.7	171	65.1	171.0	170.9	170.8
56	21.4	56.2	56.1	55.9	174	66.4	174.3	174.2	174.0
(5 ft) 59	22.6	59.5	59.3	59.2	178	67.6	177.6	177.4	177.3
63	23.9	62.7	62.6	62.5	(15 ft) 181	68.9	180.8	180.7	180.6
66	25.1	66.0	65.9	65.8	184	70.1	184.1	184.0	183.9
69	26.4	69.3	69.2	69.1	187	71.4	187.4	187.3	187.2
(6 ft) 73	27.6	72.6	72.5	72.3	(16 ft) 191	72.6	190.7	190.6	190.4
76	28.9	75.9	75.7	75.6	194	73.9	194.0	193.8	193.7
79	30.1	79.1	79.0	78.9	197	75.1	197.2	197.1	197.0
(7 ft) 82	31.4	82.4	82.3	82.2	200	76.4	200.5	200.4	200.3
86	32.6	85.7	85.6	85.5	(17 ft) 204	77.6	203.8	203.7	203.6
89	33.9	89.0	88.9	88.7	207	78.9	207.1	207.0	206.8
92	35.1	92.3	92.1	92.0	210	80.1	210.4	210.2	210.1
(8 ft) 96	36.4	95.5	95.4	95.3	214	81.4	213.6	213.5	213.4
99	37.6	98.8	98.7	98.6	(18 ft) 217	82.6	216.9	216.8	216.7
102	38.9	102.1	102.0	101.9	220	83.9	220.2	220.1	220.0
105	40.1	105.4	105.3	105.1	223	85.1	223.5	223.4	223.2
(9 ft) 109	41.4	108.7	108.5	108.4	(19 ft) 227	86.4	226.8	226.6	226.5
112	42.6	111.9	111.8	111.7					
115	43.9	115.2	115.1	115.0					
(10 ft) 118	45.1	118.5	118.4	118.3					
122	46.4	121.8	121.7	121.5					

Note: all values are rounded to the nearest 0.1 inch

Endcap (No Connector) -NPF

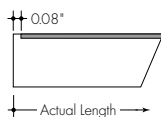

End Connector -IME

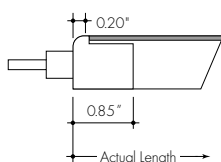

Back Connector -IMB

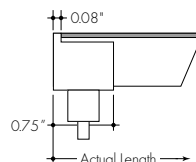

Side Connector -IMSA -IMSB

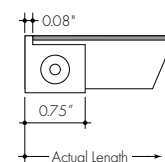

Power Supplies

See fixture and power supply instructions & spec sheet for wiring information. Dimming possible in select models - view Luminii website for list of compatible dimmers.

For use with Warm Dim

Universal Power Supply 1% 120VAC - 277VAC

MODEL	POWER	OUTPUT
PDCU-D - IP20 Dry Series	30 - 30 W 60 - 60 W 96 - 96 W 3X96 - 3X96 W	24 - 24 VDC
PDCU-W - IP66 Wet Series	96 - 96 W 3X96 - 3X96 W	

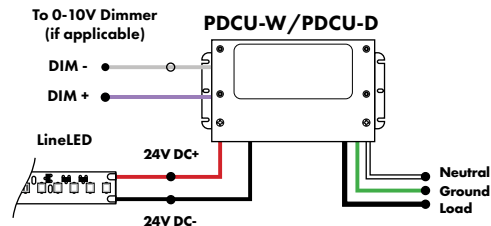

0-10V dims down to 1%, MLV/ELV/TRIAC dims down to 1%.
For a complete list of compatible dimmers, see [Compatible Dimming Chart](#) on the Resources page.

MODELS	PDCU-W 96W	PDCU-W 3X96W	PDCU-D 30W	PDCU-D 60W	PDCU-D 96W	PDCU-D 3X96W
Length	8.66"	11.85"	6.10"	7.93"	8.25"	9.57"
Width	3.73"	4.32"	3.35"	3.35"	4.10"	5.94"
Depth	1.61"	1.81"	1.33"	1.32"	1.56"	1.13"

For use with RGB/RGBW, RGB42/RGBW36 or with Tunable White

DMX 0% Dimming Power Supplies 120VAC - 277VAC

MODEL	POWER	OUTPUT
PSDMX-DMX Power Supply dims down to 0%	96 - 96 Watt 3X96 - 3 X 96 Watt	24-24 VDC

MODELS	96W	3X96
A Length	14.40"	15.75"
B Width	5.20"	6.62"
Depth	2.60"	4.95"

Features eldoLED's LINEARdrive configurable dimmable drivers.
DDMX-RGBW DMX Decoder not required when purchasing this power supply.

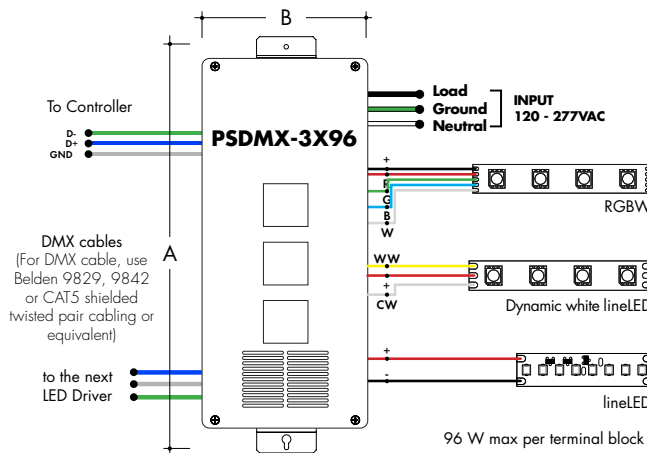
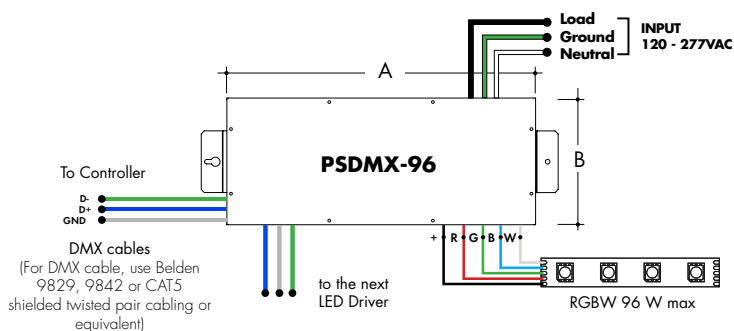

For use with Tunable White

Customizable Dim to Warm or Variable White via 0 - 10V
(for tunable white or warm dimming control of Dynamic option)

MODEL	POWER	OUTPUT	CONTROL
PS010VD-0-10 LED Driver	96-96 Watt	24-24 VDC	WW-Standard One Channel - Dim To Warm Curve W2C-Standard Two Channel - Dim 1: Intensity; Dim 2: CCT W21 - Standard Two Channel - Dim 1: Warm Channel Intensity; Dim 2: Cool Channel Intensity W1X-___Custom One Channel - Dim To Warm Curve W2X-___Custom two Channel - Dim 1: Intensity; Dim 2: CCT

MODELS	96W	3X96
Length	14.40"	15.0"
Width	5.20"	6.61"
Depth	2.60"	4.56"

Requires a 0-10V controller to work properly

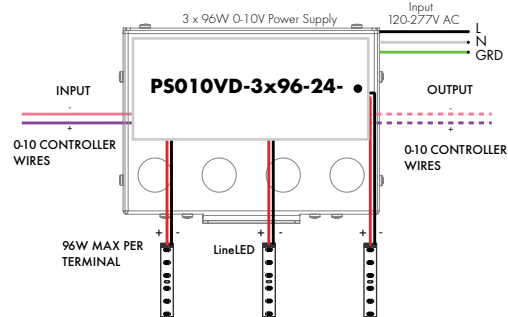
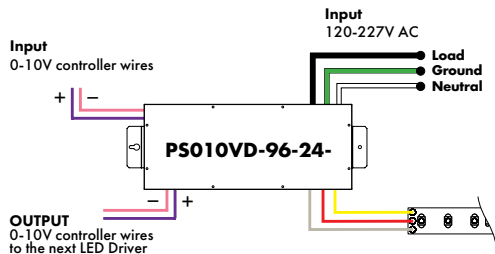

For use with Tunable White

DALI DT8 LED Driver, 120VAC - 277VAC

MODEL	POWER	OUTPUT
PSDALI-DT8-DALI-DT8 LED Driver	96-96 Watt	24-24 VDC

Requires a controller and a decoder to work properly

MODELS	96W
A Length	14.40"
B Width	5.20"
Depth	2.60"

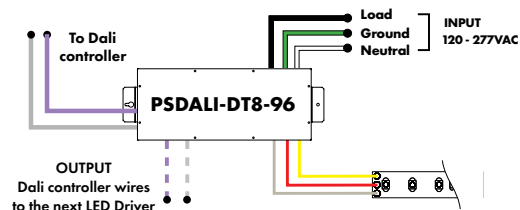

For use with RGB/RGBW/Pixel

Non-Dimming Power Supply 120VAC - 277VAC

MODEL	POWER	OUTPUT	DIMMING	LOCATION
PSV-PSV Series	96-96 Watt	24-24 VDC	ND-Non Dimming	D-Dry location

Requires a controller and a decoder to work properly

MODELS	96W
A Length	14.40"
B Width	5.20"
Depth	2.60"

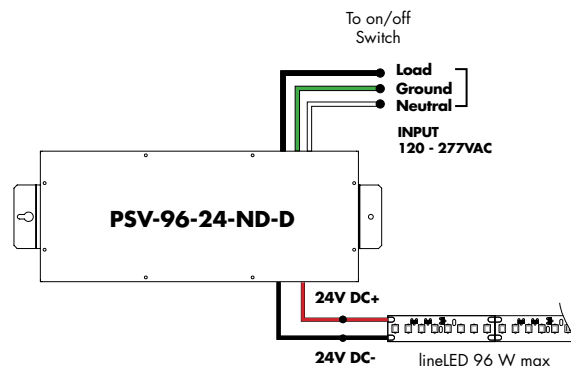

Power Supplies

See fixture and power supply instructions & spec sheet for wiring information. Dimming possible in select models - view Luminii website for list of compatible dimmers.

DMX-1Z-RGBW, DMX-3Z-RGBW

RGBW LED 1 or 3 Zone Controller

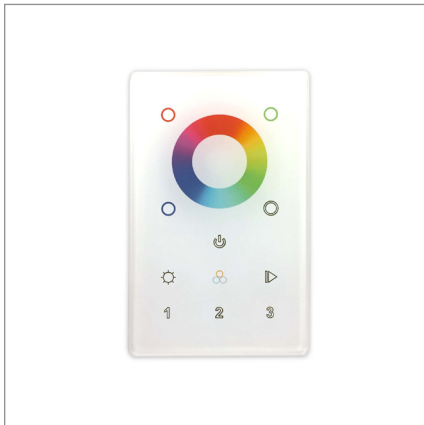

ORDERING CODE

MODEL	ZONES	COLOR
DMX - DMX Controller	3Z - Three Zone 1Z - One Zone	RGBW - Red, Green, Blue, & White

DMX /Wireless RGB-W wall-mount controller controls DMX lighting fixtures, wireless control of RGB-W lighting fixture or use both simultaneously. Fits in any standard US switch box. Includes all the outputs in the back of the controller.

Control brightness levels with a single touch, personalize and memorize 3 different scenes, and even create 3 variations of white.

Features

- 2 in 1 in-Wall Controller: DMX Control or Wireless RGB-W
- 65,000 Color Options, Dimming and Speed Control
- Memory Function
- 50 Foot Wireless Range
- Easily Fits Standard US Switch Boxes
- Touch Sensitive Glass Surface
- Includes 10 Built in Programs, or Create and Play Your Own

Operating Voltage

12 - 24V DC

Color Parameters

- Brightness
- Saturation
- Primary colors
- Fading
- Color changing speed

Touch DMX Controller

Touchscreen digital LED controller

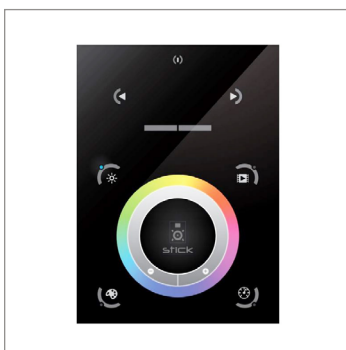

MODEL

TSDMX-E

TSDMX-E - Touchscreen DMX controller

Programmable advanced DMX512 lighting controller featuring a touch-screen interface. Operates as stand alone controller or integrated with most architectural lighting control systems. Can controller endless DMX512 enabled devices.

Mounts to standard single or dual gang wall box with the included power supply inside the junction box. Terminal block design for power and data connections.

Features

- Sleek glass design which sits 0.43" from the wall
- Graphical color display to show selected environment
- Color/dimmer/speed palette
- Color temperature mixing
- Touch sensitive buttons. No mechanical parts
- Touch sensitive wheel allows for accurate color selection
- Multi-zone microSD memory
- Multi-room control with 500 scenes, 10 zones
- 1024 DMX channels. Control 340 RGB fixtures
- USB & Ethernet connectivity for programming and control

Power Supply

7 VDC (included)

Programmability

PC, Mac, Tablet, Smartphone

Output Signal

DMX512 (1024 channels)

Color Parameters

- Brightness
- Saturation
- Speed of color changing sequence
- Fading / dimming / brightness

DMX Decoder

DMX signal to RGBW decoder (required to operate DMX controller)

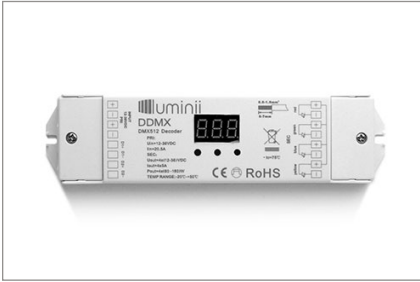

ORDERING CODE

MODEL

DDMX-RGBW

DDMX-RGBW - DMX decoder

Translates controller DMX512 programs for RGB and white LED strips.

Unique DMX address for the decoder can be set easily and displayed by the numeric display on the case. Changing and resetting the DMX address requires manual input.

Use power repeater to expand output.

Operating Voltage

12-36 VDC

Power Capacity

up to 96W at 24V

Operating Temperature Range

from -4°F to +122°F in case

Smart Pixel Decoder

SPI signal to DMX signal decoder



Model

SR-DMX-SPI

SR-DMX-SPI - Smart Pixel Decoder

The SR-DMX-SPI is a smart LED pixel decoder that controls RGB/RGBW pixel LED strips with SPI signal. Designed with an OLED backlit panel, the pixel controller allows for easy configuration of most settings. Four push buttons are available for control of the LED functions.

*For pixel only.

Features

- 2 in 1 in-Wall Controller: DMX Control or Wireless RGB-W
- SPI signal output for RGB/RGBW pixel light control
- DMX512 controllable and RF/WIFI remote controllable
- Capable of addressing up to 1020 RGB pixels & 765 RGB pixels
- OLED panel allows for easy configuration

Operating Voltage

12 - 36V DC

Power capacity

up to 96W at 24V

Operating temperature range

from -4°F to +122°F in case