

Bara - Installation Instructions

Models BAR-XX

Please read all instructions prior to installation and keep for future reference!

1. PRODUCT TO BE INSTALLED BY A QUALIFIED ELECTRICIAN.
2. USE ONLY WITH CLASS 2 POWER UNIT.
3. 24 VOLTS DC.
4. SUITABLE FOR DAMP LOCATIONS.
5. SURFACE MOUNT ONLY
6. APPROVED FOR CLOSET/STORAGE SPACE INSTALLATION PER NEC 410.16(A)(3) AND 410.16(C)(5) ON OUTPUTS 5.7W/FT OR LESS
7. INHERENTLY PROTECTED



REVO.8
08212024

1 / 9



7777 Merrimac Ave
Niles, IL 60714
T 224.333.6033
F 224.757.7557
info@luminii.com
www.luminii.com

Bara w/ magnetic mounting

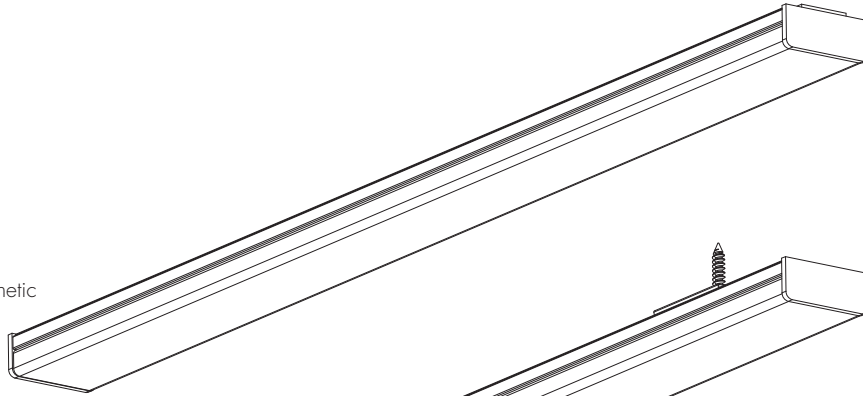

Bara w/ fixed mounting clip or drywall clip



Bara w/ 9/16" Lay-in Grid Clip



Bara w/ 15/16" Lay-in Grid Clip

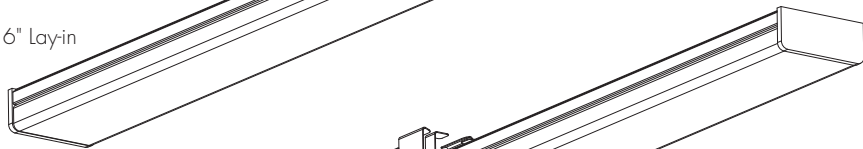

Bara w/ 9/16" Tegral Grid Clip



Bara w/ 9/16" Slot Tee Grid Clip

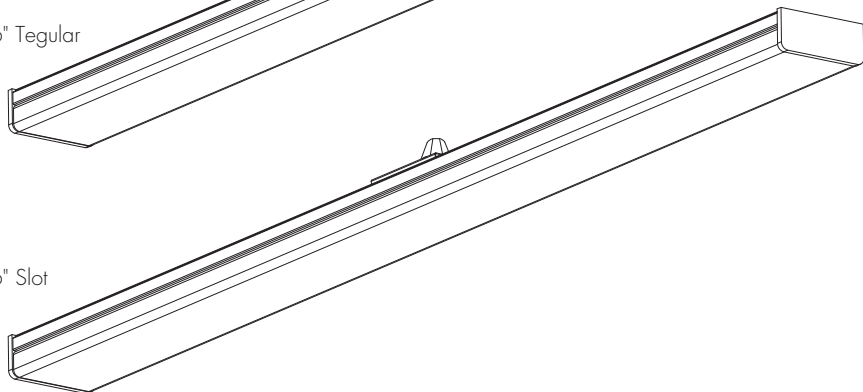

Bara - Installation Instructions

Models BAR-XX



7777 Merrimac Ave
Niles, IL 60714
T 224.333.6033
F 224.757.7557
info@luminii.com
www.luminii.com

REVO.8
08212024

2 / 9

Please read all instructions prior to installation and keep for future reference!

1. PRODUCT TO BE INSTALLED BY A QUALIFIED ELECTRICIAN.
2. USE ONLY WITH CLASS 2 POWER UNIT.
3. 24 VOLTS DC.
4. SUITABLE FOR DAMP LOCATIONS.
5. SURFACE MOUNT ONLY
6. APPROVED FOR CLOSET/STORAGE SPACE INSTALLATION PER NEC 410.16(A)(3) AND 410.16(C)(5) ON OUTPUTS 5.7W/FT OR LESS
7. INHERENTLY PROTECTED

Magnetic Installation

Note: Prior to installation all 24VDC wires must be present near fixture. Refer to the power supply installation instructions for additional information.
Note: More than one person is recommended for this installation.

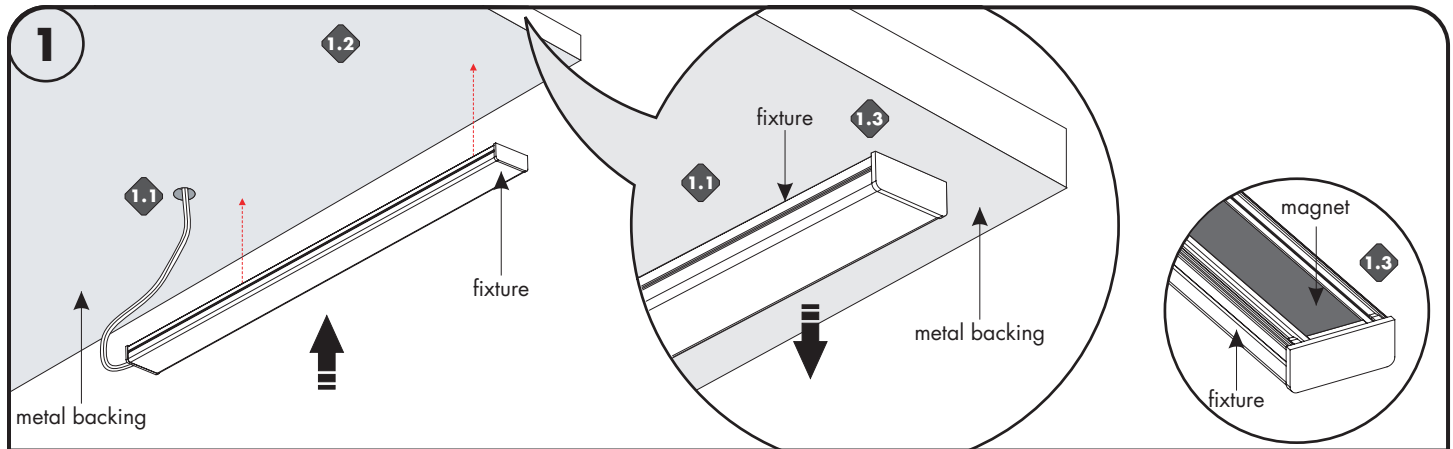

- 1.1 If necessary make any pass through holes for wire lead/connector to the surface, depending on the power feed option.
- 1.2 Clean the surface area thoroughly from any debris. Must be made of steel or a ferrous metal
- 1.3 Snap the fixture onto the metal surface. If necessary fixture can easily be removed by pulling off the surface and repositioning correctly.

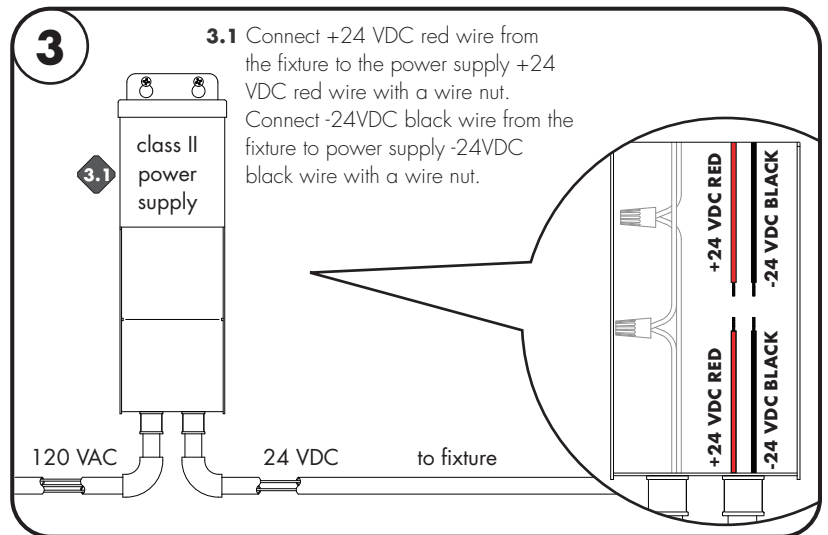
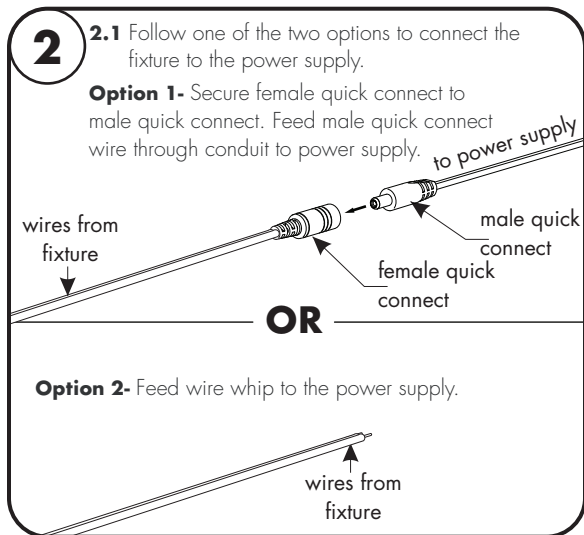

Bara - Installation Instructions

Models BAR-XX



7777 Merrimac Ave
Niles, IL 60714
T 224.333.6033
F 224.757.7557
info@luminii.com
www.luminii.com

REVO.8
08212024

3 / 9

Please read all instructions prior to installation and keep for future reference!

1. PRODUCT TO BE INSTALLED BY A QUALIFIED ELECTRICIAN.
2. USE ONLY WITH CLASS 2 POWER UNIT.
3. 24 VOLTS DC.
4. SUITABLE FOR DAMP LOCATIONS.
5. SURFACE MOUNT ONLY.
6. APPROVED FOR CLOSET/STORAGE SPACE INSTALLATION PER NEC 410.16(A)(3) AND 410.16(C)(5) ON OUTPUTS 5.7W/FT OR LESS.
7. INHERENTLY PROTECTED.

Fixed Mounting Clip Installation - Drywall

Note: Prior to installation all 24VDC wires must be present near fixture. Refer to the power supply installation instructions for additional information.
Note: More than one person is recommended for this installation.

<p>1</p> <p>back of fixture</p> <p>1.1</p> <p>4" every 30" 4"</p>	<p>1.2</p>	
<p>1.1 Determine the location of where the fixture(s) will be installed. Lay the fixture(s) on the surface, and make any necessary reference marks for the fixed mounting clips. Make marks 4" from each end of the fixture(s) and also every 30" in between.</p>	<p>1.2 Drill holes using a 0.180" Ø drill bit.</p>	
<p>1.3</p>	<p>1.4</p> <p>fixed clip</p> <p>#6 screw</p>	<p>1.5</p> <p>fixed clip</p> <p>1.5.1</p> <p>fixture</p> <p>1.5.2</p> <p>Snap</p> <p>Note: DO NOT snap two sides at the same time</p>
<p>1.3 Insert plastic drywall anchors, hammering flush to drywall surface.</p>	<p>1.4 Place bracket over drywall anchor and fasten to drywall using a #6 SS screw, 0.75" long.</p>	<p>1.5 Clip on the light fixtures</p> <ul style="list-style-type: none"> 1. Align light fixture to one side of the clips, make sure the fixture is held. 2. Snap on the other side.

2

Follow one of the two options to connect the fixture to the power supply.

Option 1- Secure female quick connect to male quick connect. Feed male quick connect wire through conduit to power supply.

wires from fixture

to power supply

male quick connect

female quick connect

OR

Option 2- Feed wire whip to the power supply.

wires from fixture

3

Connect +24 VDC red wire from the fixture to the power supply +24 VDC red wire with a wire nut. Connect -24VDC black wire from the fixture to power supply -24VDC black wire with a wire nut.

class II power supply

120 VAC

24 VDC to fixture

+24 VDC RED

-24 VDC BLACK

+24 VDC RED

-24 VDC BLACK

Bara - Installation Instructions

Models BAR-XX



7777 Merrimac Ave
Niles, IL 60714
T 224.333.6033
F 224.757.7557
info@luminii.com
www.luminii.com

REVO.8
08212024

4 / 9

Please read all instructions prior to installation and keep for future reference!

1. PRODUCT TO BE INSTALLED BY A QUALIFIED ELECTRICIAN.
2. USE ONLY WITH CLASS 2 POWER UNIT.
3. 24 VOLTS DC.
4. SUITABLE FOR DAMP LOCATIONS.
5. SURFACE MOUNT ONLY
6. APPROVED FOR CLOSET/STORAGE SPACE INSTALLATION PER NEC 410.16(A)(3) AND 410.16(C)(5) ON OUTPUTS 5.7W/FT OR LESS
7. INHERENTLY PROTECTED

Fixed Mounting Clip Installation - Millwork

Note: Prior to installation all 24VDC wires must be present near fixture. Refer to the power supply installation instructions for additional information.
Note: More than one person is recommended for this installation.

1 back of fixture

1.1 Determine the location of where the fixture(s) will be installed. Lay the fixture(s) on the surface, and make any necessary reference marks for the fixed mounting clips. Make marks 4" from each end of the fixture(s) and also every 30" in between.

1.2 Lay the fixed clip onto the reference mark points. Drill a 0.1" starter hole. Lay down the clips and secure with the screw.

1.3 Clip on the light fixtures

- .1 Align light fixture to one side of the clips, make sure the fixture is held.
- .2 Snap on the other side.

fixed clip

#4 size screw

1.3.1

1.3.2

Snap

Note: DO NOT snap two sides at the same time

2 Follow one of the two options to connect the fixture to the power supply.

Option 1- Secure female quick connect to male quick connect. Feed male quick connect wire through conduit to power supply.

wires from fixture

to power supply

male quick connect

female quick connect

OR

Option 2- Feed wire whip to the power supply.

wires from fixture

3

Connect +24 VDC red wire from the fixture to the power supply +24 VDC red wire with a wire nut. Connect -24VDC black wire from the fixture to power supply -24VDC black wire with a wire nut.

class II power supply

120 VAC

24 VDC to fixture

+24 VDC RED

-24 VDC BLACK

+24 VDC RED

-24 VDC BLACK

Bara - Installation Instructions

Models BAR-XX



7777 Merrimac Ave
Niles, IL 60714
T 224.333.6033
F 224.757.7557
info@luminii.com
www.luminii.com

REVO.8
08212024

5 / 9

Please read all instructions prior to installation and keep for future reference!

1. PRODUCT TO BE INSTALLED BY A QUALIFIED ELECTRICIAN.
2. USE ONLY WITH CLASS 2 POWER UNIT.
3. 24 VOLTS DC.
4. SUITABLE FOR DAMP LOCATIONS.
5. SURFACE MOUNT ONLY.
6. APPROVED FOR CLOSET/STORAGE SPACE INSTALLATION PER NEC 410.16(A)(3) AND 410.16(C)(5) ON OUTPUTS 5.7W/FT OR LESS.
7. INHERENTLY PROTECTED

Lay-in Grid Clip Installation

Note: Prior to installation all 24VDC wires must be present near fixture. Refer to the power supply installation instructions for additional information.

Note: More than one person is recommended for this installation.

1 **1.1**

back of fixture

lead wire (off centered)

4" every 24" 4"

1.3

Lay-in grid clip

1.2

Lay-in grid clip

grid track

1.3.1

clip

fixture

1.3.2

Snap

1.1 Prior to installing the fixture on the grid, reference the back of the fixture to take into consideration end caps & power feed. In addition take into account the lead wires they are slightly off centered.

1.2 Then align & rotate to secure each t-bar clip to the track. Install a t-bar clip 4" from each end of the fixture and also one every 24" in between the fixture.

1.3 Clip on the light fixtures

- .1 Align light fixture to one side of the clips, make sure the fixture is held.
- .2 Snap on the other side.

Note: DO NOT snap two sides at the same time

Optional

female quick connect

male quick connect

T-Bar

bara fixture

notch

mounting surface

front view

male quick connect

female quick connect

bara fixture

If necessary, use metal shears to cut a notch on T-bar/Tile for fixture lead ensuring sharp bends in wire management are avoided to prevent the wire leads from stripping and causing a short.

2 Follow one of the two options to connect the fixture to the power supply.

Option 1- Secure female quick connect to male quick connect. Feed male quick connect wire through conduit to power supply.

wires from fixture

male quick connect

female quick connect

to power supply

OR

Option 2- Feed wire whip to the power supply.

wires from fixture

3

class II power supply

120 VAC

24 VDC to fixture

Connect +24 VDC red wire from the fixture to the power supply +24 VDC red wire with a wire nut.
Connect -24VDC black wire from the fixture to power supply -24 VDC black wire with a wire nut.

+24 VDC RED

-24 VDC BLACK

+24 VDC RED

-24 VDC BLACK

Bara - Installation Instructions

Models BAR-XX



7777 Merrimac Ave
Niles, IL 60714
T 224.333.6033
F 224.757.7557
info@luminii.com
www.luminii.com

REVO.8
08212024

6 / 9

Please read all instructions prior to installation and keep for future reference!

1. PRODUCT TO BE INSTALLED BY A QUALIFIED ELECTRICIAN.
2. USE ONLY WITH CLASS 2 POWER UNIT.
3. 24 VOLTS DC.
4. SUITABLE FOR DAMP LOCATIONS.
5. SURFACE MOUNT ONLY.
6. APPROVED FOR CLOSET/STORAGE SPACE INSTALLATION PER NEC 410.16(A)(3) AND 410.16(C)(5) ON OUTPUTS 5.7W/FT OR LESS.
7. INHERENTLY PROTECTED

Tegular Grid Clip Installation

Note: Prior to installation all 24VDC wires must be present near fixture. Refer to the power supply installation instructions for additional information.
Note: More than one person is recommended for this installation.

1

back of fixture

lead wire (centered)

4" every 30" 4"

1.3

tegular grid clip

1.2

tegular grid

tegular grid clip

Snap

1.3.1

clip

fixture

1.3.2

Snap

1.1 Prior to installing the fixture on the grid, reference the back of the fixture to take into consideration end caps & power feed. In addition take into account the lead wires they are slightly off centered.

1.2 Then align & insert one side of tegular grid clip to the track, snap on the other side. Install a clip 4" from each end of Clip on the fixture and also one every 30" in between the fixture.

1.3 .1 Align light fixture to one side of the clips, make sure the fixture is held.

.2 Snap on the other side.

Note: DO NOT snap two sides at the same time

Optional

female quick connect

male quick connect

tegular grid

notch

bara fixture

mounting surface

front view

male quick connect

female quick connect

bara fixture

If necessary, use metal shears to cut a notch on tegular grid for fixture lead ensuring sharp bends in wire management are avoided to prevent the wire leads from stripping and causing a short.

2 Follow one of the two options to connect the fixture to the power supply.

Option 1- Secure female quick connect to male quick connect. Feed male quick connect wire through conduit to power supply.

wires from fixture

male quick connect

female quick connect

to power supply

OR

Option 2- Feed wire whip to the power supply.

wires from fixture

3

class II power supply

120 VAC

24 VDC to fixture

Connect +24 VDC red wire from the fixture to the power supply +24 VDC red wire with a wire nut.
Connect -24VDC black wire from the fixture to power supply -24VDC black wire with a wire nut.

+24 VDC RED

-24 VDC BLACK

+24 VDC RED

-24 VDC BLACK

Bara - Installation Instructions

Models BAR-XX



7777 Merrimac Ave
Niles, IL 60714
T 224.333.6033
F 224.757.7557
info@luminii.com
www.luminii.com

REVO.8
08212024

7 / 9

Please read all instructions prior to installation and keep for future reference!

1. PRODUCT TO BE INSTALLED BY A QUALIFIED ELECTRICIAN.
2. USE ONLY WITH CLASS 2 POWER UNIT.
3. 24 VOLTS DC.
4. SUITABLE FOR DAMP LOCATIONS.
5. SURFACE MOUNT ONLY
6. APPROVED FOR CLOSET/STORAGE SPACE INSTALLATION PER NEC 410.16(A)(3) AND 410.16(C)(5) ON OUTPUTS 5.7W/FT OR LESS
7. INHERENTLY PROTECTED

Slot Tee Grid Clip Installation

Note: Prior to installation all 24VDC wires must be present near fixture. Refer to the power supply installation instructions for additional information.
Note: More than one person is recommended for this installation.

1

1.1 back of fixture

lead wire (centered)

4" every 30" 4"

1.2 slot tee grid clip

slot tee grid clip

1.3

clip

fixture

1.3.1

1.3.2

Snap

1.1 Prior to installing the fixture on the grid, reference the back of the fixture to take into consideration end caps & power feed. In addition take into account the lead wires they are slightly off centered.

1.2 Then align & insert top of slot tee grid clip into the trak. Use screwdriver to secure the clip.

Install a clip 4" from each end of Clip on the fixture and also one every 30" in between the fixture.

1.3 .1 Align light fixture to one side of the clips, make sure the fixture is held.

.2 Snap on the other side.

Note: DO NOT snap two sides at the same time

Optional

lead wire

slot tee grid

hole

bara fixture

mounting surface

front view

lead wire

bara fixture

If necessary, drill a hole with grid for fixture lead ensuring sharp bends in wire management are be avoided to prevent the wire leads from stripping and causing a short.

2 Follow one of the two options to connect the fixture to the power supply.

Option 1- Secure female quick connect to male quick connect. Feed male quick connect wire through conduit to power supply.

wires from fixture

female quick connect

male quick connect

to power supply

OR

Option 2- Feed wire whip to the power supply.

wires from fixture

3

class II power supply

120 VAC

24 VDC to fixture

Connect +24 VDC red wire from the fixture to the power supply +24 VDC red wire with a wire nut.

Connect -24VDC black wire from the fixture to power supply -24 VDC black wire with a wire nut.

+24 VDC RED

-24 VDC BLACK

+24 VDC RED

-24 VDC BLACK

Bara - Installation Instructions

Models BAR-XX

Please read all instructions prior to installation and keep for future reference!

1. PRODUCT TO BE INSTALLED BY A QUALIFIED ELECTRICIAN.
2. USE ONLY WITH CLASS 2 POWER UNIT.
3. 24 VOLTS DC.
4. SUITABLE FOR DAMP LOCATIONS.
5. SURFACE MOUNT ONLY
6. APPROVED FOR CLOSET/STORAGE SPACE INSTALLATION PER NEC 410.16(A)(3) AND 410.16(C)(5) ON OUTPUTS 5.7W/FT OR LESS
7. INHERENTLY PROTECTED



REVO.8
08212024

8 / 9



7777 Merrimac Ave
Niles, IL 60714
T 224.333.6033
F 224.757.7557
info@luminii.com
www.luminii.com

Multiple Fixture Installation

Note: Prior to installation all 24VDC wires must be present near fixture. Refer to the power supply installation instructions for additional information.
Note: More than one person is recommended for this installation.

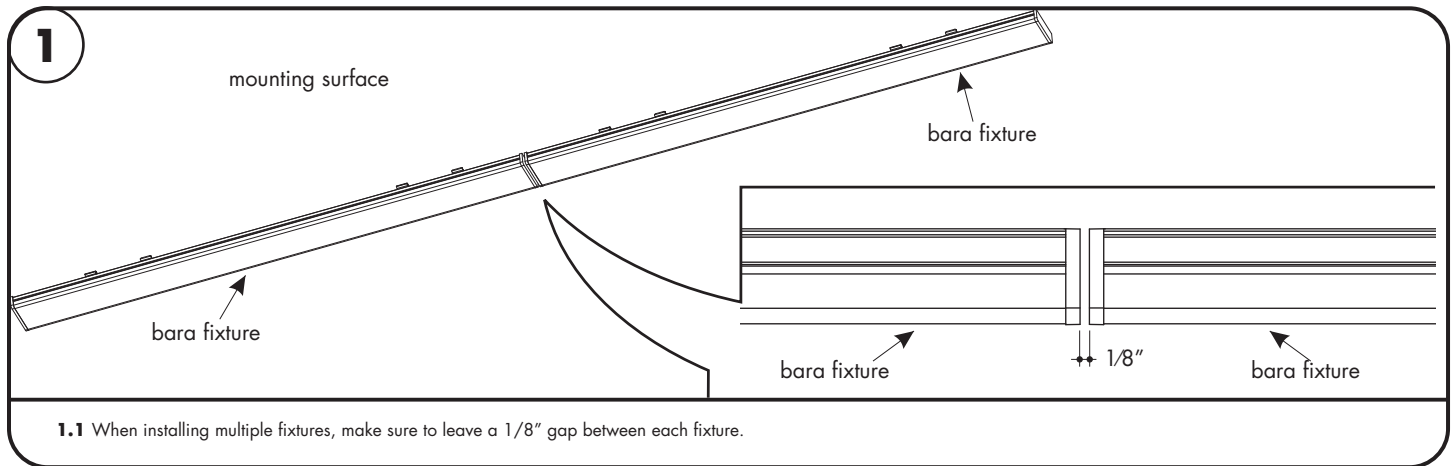

Bara - Installation Instructions

Models BAR-XX



7777 Merrimac Ave
Niles, IL 60714
T 224.333.6033
F 224.757.7557
info@luminii.com
www.luminii.com

Please read all instructions prior to installation and keep for future reference!

1. PRODUCT TO BE INSTALLED BY A QUALIFIED ELECTRICIAN.
2. USE ONLY WITH CLASS 2 POWER UNIT.
3. 24 VOLTS DC.
4. SUITABLE FOR DAMP LOCATIONS.
5. SURFACE MOUNT ONLY
6. APPROVED FOR CLOSET/STORAGE SPACE INSTALLATION PER NEC 410.16(A)(3) AND 410.16(C)(5) ON OUTPUTS 5.7W/FT OR LESS
7. INHERENTLY PROTECTED

REVO.8
08212024

9 / 9

power supplies at the end of the run

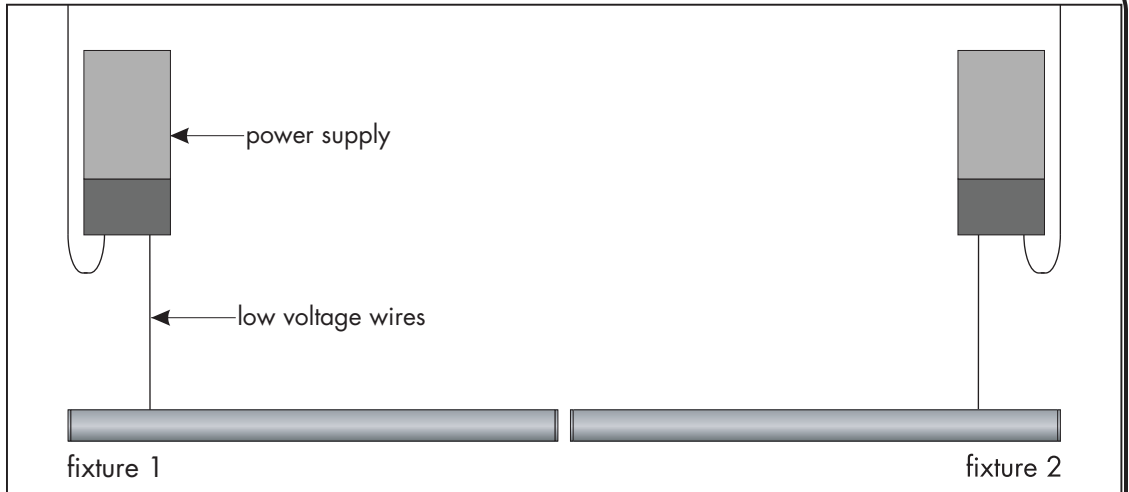

power supplies in the middle of the run

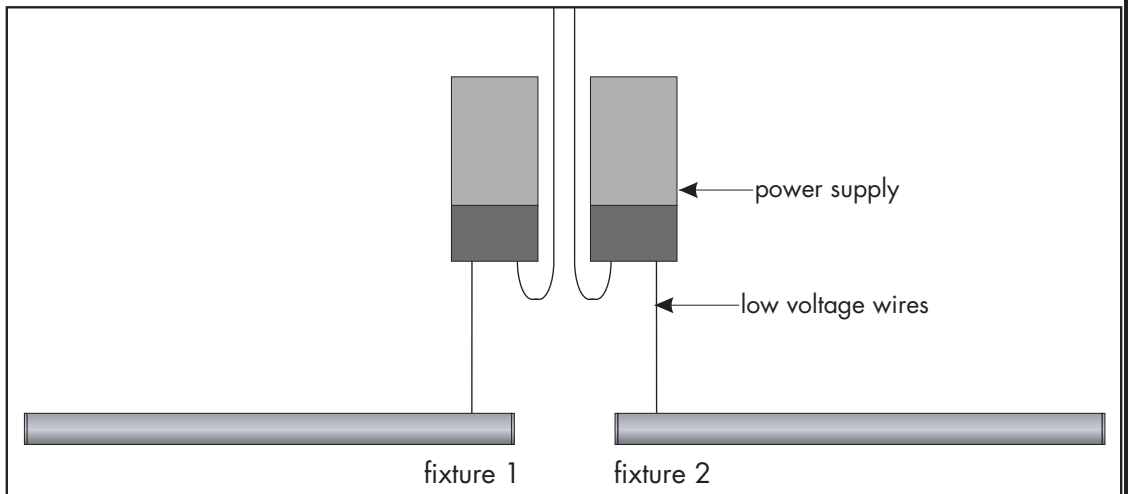

consecutive layout, NOT RECOMMENDED

