

Features

- 24VDC Class 2 fixtures made to order up to 144". Fixtures can be linked up to 16' depending on output
- Available with plenum rated wire leads or with integral junction box for splice connection.
- Separate lens orderable up to 200' for continuous run options.
- Dot free even illumination with frosted lens
- Class two listed for damp locations
- Proprietary strong bond solder method handles up to 50 lbs of pull force on wire leads and connectors
- DW68 Dynamic White allows individual control of CCT and output
- WD68 Warm Dim follows the incandescent dimming curve and is compatible with MLV, ELV, and Incandescent dimmers
- RGB options offer balanced output across the color gamut and a true white with RGBW
- 5 year warranty

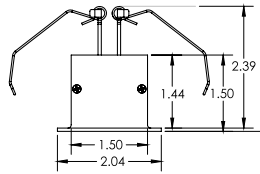
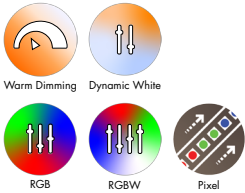

Finish Options (see page 2 for additional information)

- | | | |
|--|--------------------------------------|--|
| <input type="checkbox"/> Silver Anodized | <input type="checkbox"/> White | <input type="checkbox"/> Aged Brass |
| <input type="checkbox"/> Black | <input type="checkbox"/> Matte Black | <input type="checkbox"/> Polished Gold |
| <input type="checkbox"/> Bronze | <input type="checkbox"/> Warm Nickel | <input type="checkbox"/> Chrome |



Technical Information

TYPE	Warm Dim	Dynamic White		RGBW		RGB		Pixel	
OUTPUT OPTIONS	2x WD68SO (19K-27K)	2x DW68SO (27K-65K)	2x DW68HO (27K-65K)	2x RGBW36SO	2x RGBW36HO	2x RGB42SO	2x RGB42HO	2x RGBWX18SO	2x RGBX18SO
Lumens Output (all channels full on) (with a Frosted Lens)	522 lm/ft	633 lm/ft	586 lm/ft	318 lm/ft	526 lm/ft	315 lm/ft	463 lm/ft	384 lm/ft	253 lm/ft
Average Power Consumption (for a 4' section)	10.8 W/ft	9.2 W/ft	11.2 W/ft	8 W/ft	15.2 W/ft	9 W/ft	16.6 W/ft	11.4 W/ft	9 W/ft
Efficacy	48 lm/W	69 lm/W	52 lm/W	40 lm/W	35 lm/W	35 lm/W	28 lm/W	34 lm/W	28 lm/W
Max Run Length (in series)	10 ft	16 ft	16 ft	13 ft	7 ft	14 ft	7 ft	10 ft	15 ft
Max Ambient Temperature*	50°C [122°F]	50°C [122°F]		50°C [122°F]	50°C [122°F]	50°C [122°F]	50°C [122°F]	50°C [122°F]	
Control/Dimming Protocol	MLV, ELV, Inc.	0-10V, DMX		DMX				SPI Protocol UCS 2904	SPI Protocol UCS 2903

*Max Ambient Temperature to maintain L70 of 50k+ hours. Exceeding Max Ambient Temperature may result in decreased life/output. Consult Technical Support for specific inquiries.

Warm Dim (WD68)					Dynamic White (DW68)					RGBW (3000K)					Dominant Wavelength		
CCT		TM-30			CCT		TM-30			Tape		TM-30			Color	RGB/RGBW	
CRI	R _f	R _g	R ₉	CRI	R _f	R _g	R ₉	CRI	R _f	R _g	R ₉	CRI	R _f	R _g	R ₉		
1900K	96	92	96	94	2700K	98	96	101	91	RGBW36	95	93	106	84	Red	620nm	
2400K	97	96	103	98	2900K	98	96	102	94	RGBWX18	93	91	99	64	Green	525nm	
2700K	96	93	106	95	3500K	97	94	105	97	DW68			Blue	467nm			
CCT		Multiplier			CCT		Multiplier			CCT		Multiplier					
19K - 35K		1.00			27K - 65K		1.00			19K - 35K		0.78					

Ordering Code

MODEL	LENGTH ¹	OUTPUT ²	CCT	LENS ³	FINISH ⁴	LEFT END	RIGHT END	POSITION TYPE	POWER FEED
KR - Kilo Recessed	12"-144" 3" increments	WD68SO - Standard	19K27K - 1900K - 2700K	F - Frosted C - Clear N - No Lens	SA - Silver Anodized BK - Black BZ - Bronze WH - White MBK - Matte Black WN - Warm Nickel AB - Aged Brass PG - Polished Gold ⁵ CH - Chrome ⁵	LE - With End Cap no Hole LN - Without End Cap	RE - With End Cap no Hole RN - Without End Cap	B - Back JB - Integrated junction box	1 - 72" wire leads
	12"-144" 3" increments	DW68SO - Standard DW68HO - High	19K35K - 1900K - 3500K 27K65K - 2700K - 6500K						
	12"-144" 2" increments	RGBW36SO - Standard RGBW36HO - High RGB42SO - Standard RGB42HO - High	CLR - Color						
	12"-144" 4" increments	RGBWX18SO - Standard RGBX18SO - Standard	PXSPI - Smart Pixel Control						

1 - Custom lengths and increments are available, please consult Inside Sales with specific request.
2 - Warm Dim and Dynamic White options can be used to comply with Title 24 JAB at max brightness depending on lens selection, see multiplier charts to calculate specific efficacy.

3 - Continuous Lens may be ordered separately for multi-fixture runs to create an even, seamless appearance.
4 - Non SA finishes have extended lead times. Custom RALs are available, please consult Inside Sales for specific request.
5 - Polished Gold finishes have a maximum fixture length of 48", and Chrome finishes have a maximum fixture length of 72".

Kilo Recessed Corner Options

K-FC
Flat Corner

K-IC
Inner Corner

K-OC
Outside Corner

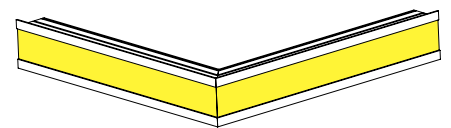
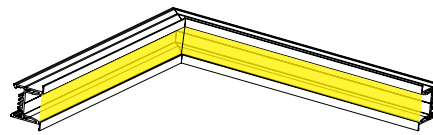
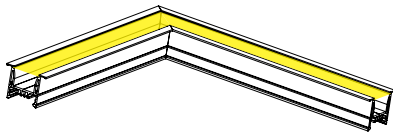
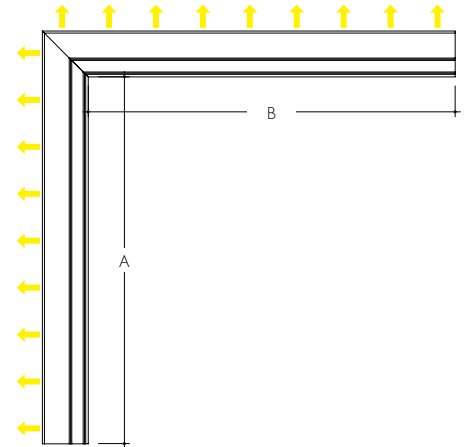
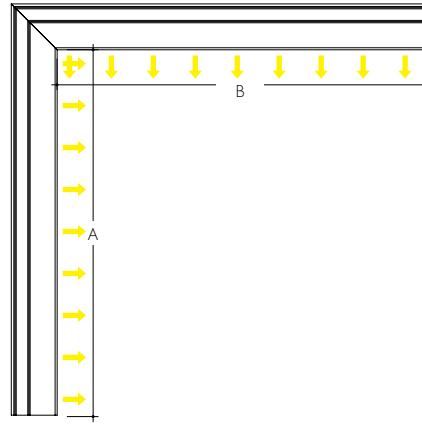
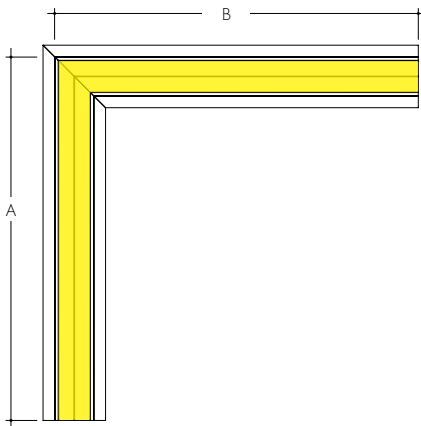

Dimensions measured for the length of recessed needed

Dimensions measured for the length of the outer (longer) length of the recessed needed

Dimensions measured for the length of recessed needed

Dynamic White Corner Type	Actual Length		Total Wattage	
	A	B	DW68SO	DW68HO
Flat (KR-FC)	10 5/16	11 8/16	17.2	21.7
Outer (KR-OC)	10 14/16	10 14/16	17.2	21.7
Inner (KR-IC)	9 1/16	9 1/16	17.2	21.7

Warm Dimming Corner Type	Actual Length		Total Wattage
	A	B	WD68SO
Flat (KR-FC)	10 5/16	11 8/16	20.3
Outer (KR-OC)	10 14/16	10 14/16	20.3
Inner (KR-IC)	9 1/16	9 1/16	20.3

RGB/RGBW/PIXEL Corner Type	Actual Length		Total Wattage				Actual Length		Total Wattage	
	A	B	RGBW36SO	RGBW36HO	RGB42SO	RGB42HO	A	B	RGBX18SO	RGBWX18SO
Flat (KR-FC)	12 7/16	13 8/16	13.8	26.3	16.0	29.9	12 7/16	13 8/16	18.3	14.6
Outer (KR-OC)	12 13/16	12 13/16	13.8	26.3	16.0	29.9	12 13/16	12 13/16	18.3	14.6
Inner (KR-IC)	11 1/16	11 1/16	13.8	26.3	16.0	29.9	11 1/16	11 1/16	18.3	14.6

Ordering Code

MODEL	CORNER	ANGLE	OUTPUT ²	CCT	LENS ³	FINISH ⁴	LEFT END	RIGHT END	POSITION TYPE	POWER FEED
KR - Kilo Recessed	IC - Inner Corner OC - Outer Corner FC - Flat Corner	90° - 90° Corner C - Custom Angle Corner ¹	WD68SO - Standard DW68SO - Standard DW68HO - High	19K27K - 1900K - 2700K 19K35K - 1900K - 3500K 27K65K - 2700K - 6500K	F - Frosted C - Clear N - No Lens	SA - Silver Anodized BK - Black BZ - Bronze WH - White MBK - Matte Black WN - Warm Nickel AB - Aged Brass PG - Polished Gold ⁵ CH - Chrome ⁵	LE - With End Cap no Hole LN - Without End Cap	RE - With End Cap no Hole RN - Without End Cap	B - Back JB - Integrated junction box	1 - 72" wire leads
			RGBW36SO - Standard RGBW36HO - High RGB42SO - Standard RGB42HO - High	CLR - Color						
			RGBWX18SO - Standard RGBX18SO - Standard	PXSPI - Smart Pixel Control						

1 - Custom lengths and increments are available, please consult Inside Sales with specific request.
2 - Warm Dim and Dynamic White options can be used to comply with Title 24 JA8 at max brightness depending on lens selection, see multiplier charts to calculate specific efficacy.

3 - Continuous Lens may be ordered separately for multifixture runs to create an even, seamless appearance.
4 - Non SA finishes have extended lead times. Custom RALs are available, please consult Inside Sales for specific request.
5 - Polished Gold finishes have a maximum fixture length of 48", and Chrome finishes have a maximum fixture length of 72".

Product Dimensions

KR-XX-B

Kilo Back Fed

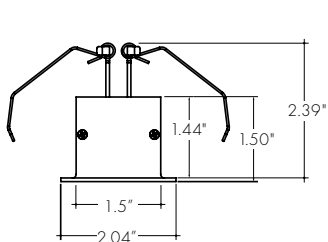

KR-XX-JB

Kilo Junction Box

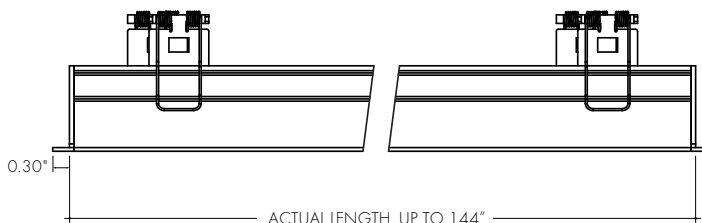
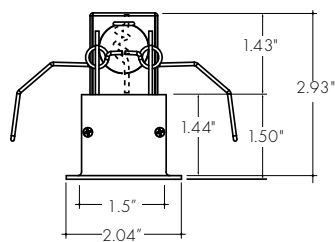

Finish Options

- Finish options are available in a wide variety, allowing for complete customization of style and aesthetic.
- Non Silver Anodized finishes may have extended lead times.
- Polished Gold finishes have a maximum fixture length of 48", and Chrome finishes have a maximum fixture length of 72".
- Custom RALs are available, please consult Inside Sales with specific request.

Silver Anodized



Silver Anodized is a soft silver with a clear finish.

Black



Black is a true deep black with a glossy finish.

Bronze



Bronze is a rich, dark brown with a satin finish.

White



White is a polar bright white and field paintable.

Matte Black



Matte Black is a dark, pitch-black with a soft flat finish.

Warm Nickel



Warm Nickel is a soft, silvery smoke with warm tones and a satin finish.

Aged Brass



Aged Brass is a deep brown shade with slightly golden undertones.

Polished Gold



Polished Gold is bright and radiant for a brilliant finish.

Chrome



Chrome is a highly reflective silver polish.

Powerfeeds and Connectors

Linking and Extension Cable Options

For use with Warm Dim (WD68):

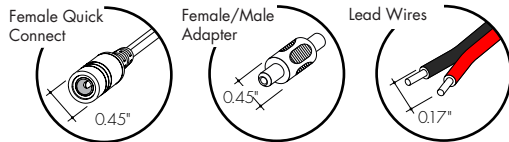

LMC-70
Male quick-connect long, 2 pin, 70"

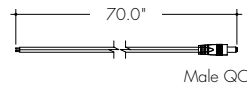

EC-48
Female/Female Extension Cable, 2 pin, 48"

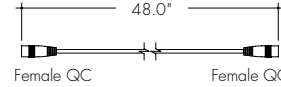

FMA
Female to male adapter

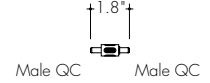

For use with Dynamic White (DW68), RGB Pixel (RGBX18) and RGBW Pixel (RGBWX18):

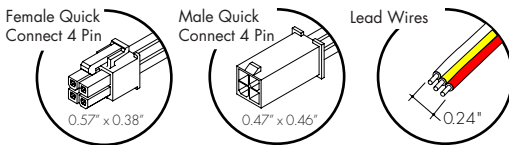

MOLEX-CON-LEAD-M-3-48
Molex Male Connector Cable, 3 pin, 48"

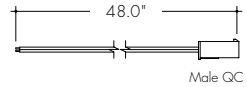

MOLEX-JC-F-M-3-48
Female/Male Jumper Cable, 3 pin, 48"

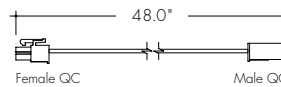

MOLEX-JC-M-M-3-4
Female to Male Adapter, 3 pin, 4"

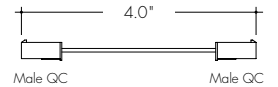

For use with RGB (RGB42):

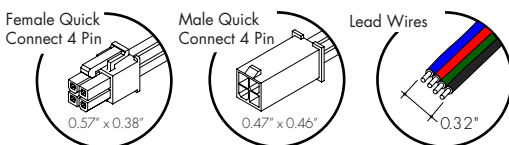

MOLEX-CON-LEAD-M-4-48
Molex Male Connector Cable, 4 pin, 48"

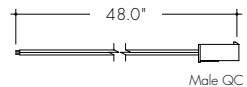

MOLEX-JC-F-M-4-48
Female/Male Jumper Cable, 4 pin, 48"

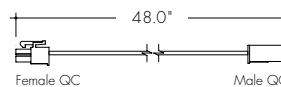

MOLEX-JC-M-M-4-4
Female to Male Adapter, 4 pin, 4"

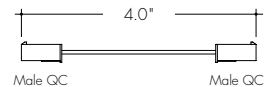

For use with RGBW (RGBW36):

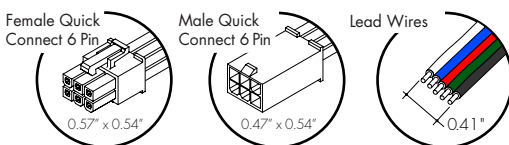

MOLEX-CON-LEAD-M-5-48
Molex Male Connector Cable, 5 pin, 48"

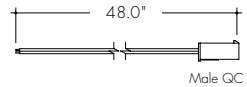

MOLEX-JC-F-M-5-48
Female/Male Jumper Cable, 5 pin, 48"

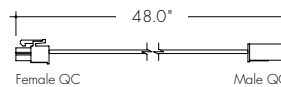

MOLEX-JC-M-M-5-4
Female to Male Adapter, 5 pin, 4"

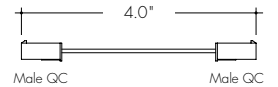

Powerfeed options for Straight Fixtures

KR-XX-B1

Wire leads, plenum rated CL3R cable on Straight Fixture



KR-XX-JB-1

One integrated junction box centered on Straight fixture

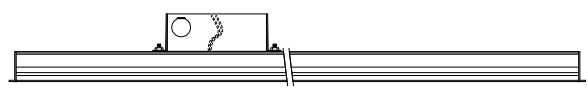

Powerfeed options for Corner Fixtures

KR-IC-XX-B1

Wire leads, plenum rated CL3R cable on Straight Fixture

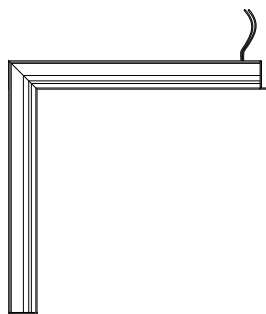

KR-IC-XX-JB-1

One integrated junction box centered on Straight fixture

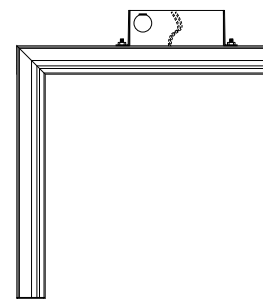

Accessories

Continuous Lens (Field Cuttable)

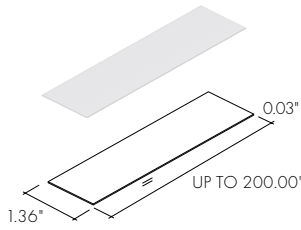

KILOC-FF - Kilo Channel Continuous Frosted Lens
KILOC-CC - Kilo Channel Continuous Clear Lens

XX - Order in 10' increments up to 200'

Lens Option / Light Transmission

Output Options	Lens/Accessory	
	Clear Lens	Frosted Lens
WD68SO - 24K-27K	CD	ND
WD68SO - 19K	CD	ND
RGBW36SO	CD	ND
RGBW36HO	CD	ND
RGB42SO	CD	ND
RGB42HO	CD	ND
Transmission Percentage	114%	100%

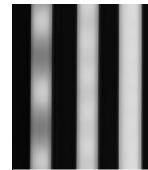

CD SD ND
CD - Clear Dotting
SD - Slight Dotting
ND - No Dotting

Sample Layout of Power Feed

KR-XX-B1

Kilo Recessed with back feed

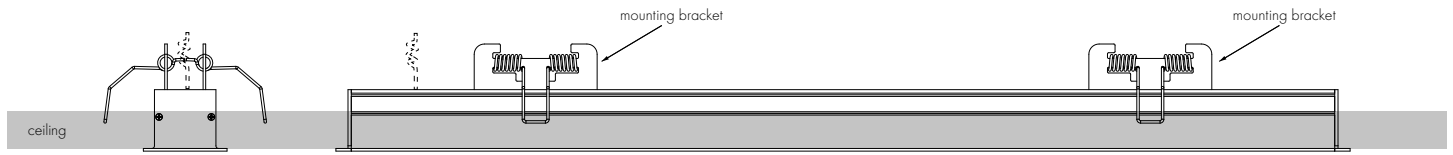

KR-XX-JB-1

Kilo Recessed with Junction Box

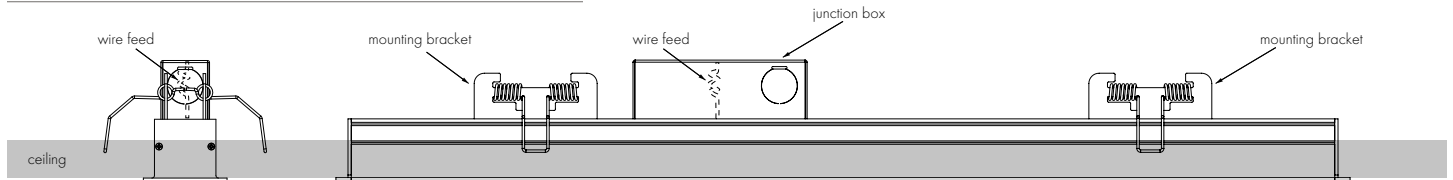

KR-XX-LE-RN-JB-1

Kilo Recessed with left endcap, without right endcap, with Junction Box

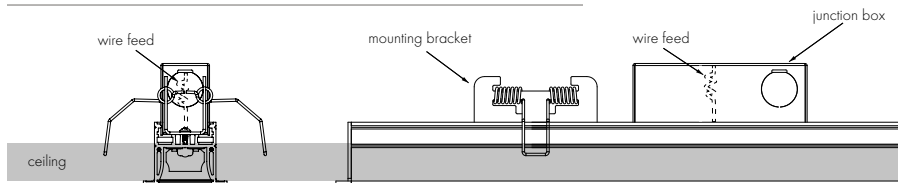

KR-XX-JB-1

Kilo Recessed without left endcap, with right endcap

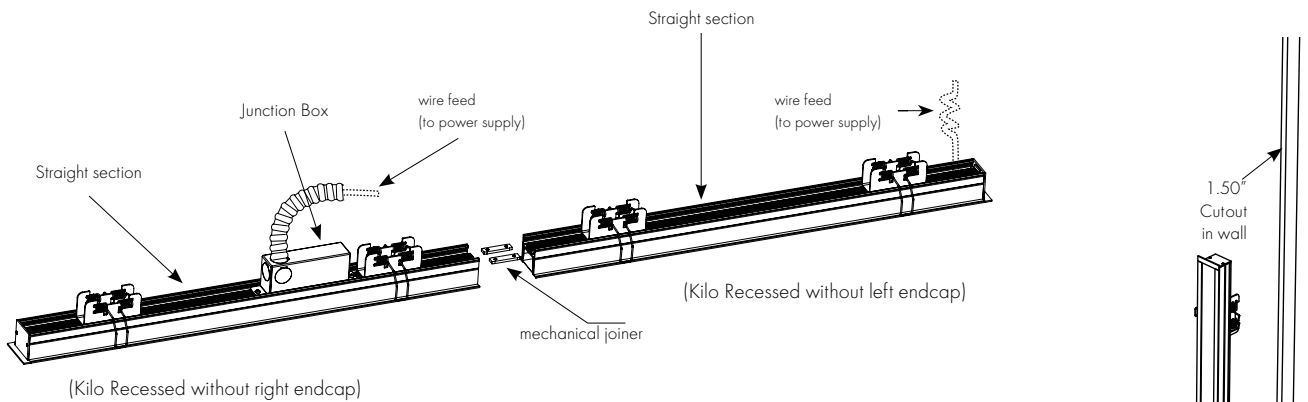
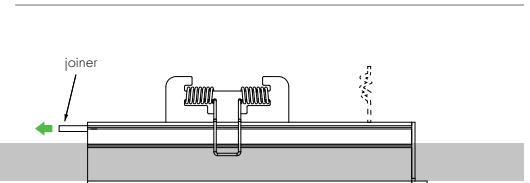

NOTE: Kilo Recessed sections are not joined electrically. Each Kilo Recessed section requires its own home run to the power supply.

Layout Example

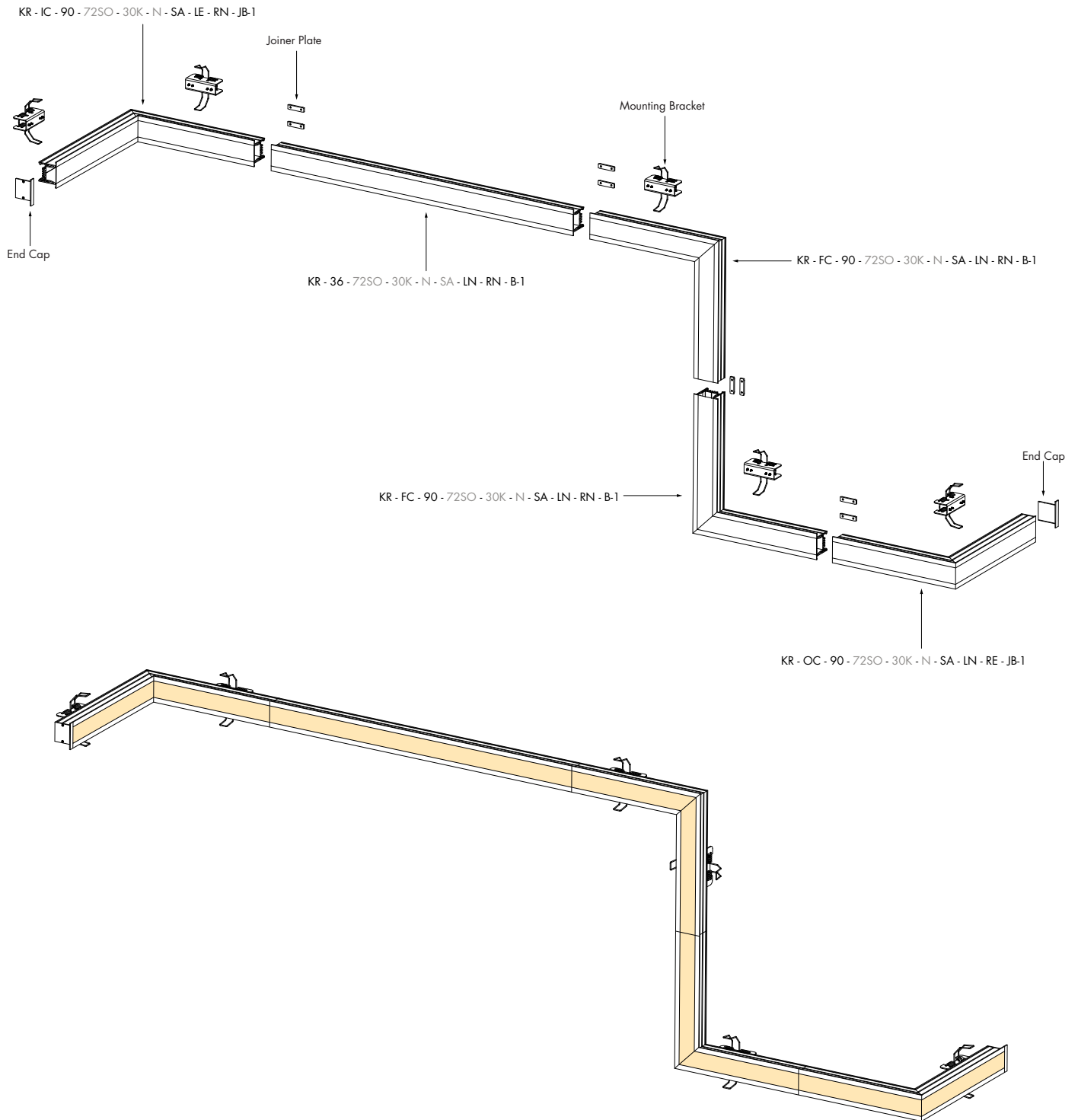

NOTE: Kilo Recessed sections are not joined electrically. Each Kilo Recessed section requires its own home run to the power supply.

Power Consumption

Tested at Full Power with PDC Series power supplies.

Standard Nominal Lengths offered provide minimal shadowing. For alternate lengths, please consult Inside Sales with specific request.

Warm Dim (2x WD68)

Nominal Length (in)	Actual Length	Watts	Nominal Length (in)	Actual Length	Watts	Nominal Length (in)	Actual Length	Watts	Nominal Length (in)	Actual Length	Watts
		SO			SO			SO			SO
12	10 1/16	8.2	47	-	-	82	-	-	117	-	-
13	-	-	48	-	-	83	-	-	118	-	-
14	-	-	49	-	-	84	83 15/16	59.5	119	118 6/16	82.4
15	-	-	50	49 7/16	36.0	85	-	-	120	-	-
16	15	10.2	51	-	-	86	-	-	121	-	-
17	-	-	52	-	-	87	-	-	122	-	-
18	-	-	53	-	-	88	-	-	123	-	-
19	-	-	54	-	-	89	88 13/16	63.6	124	123 5/16	85.3
20	19 15/16	13.6	55	54 6/16	40.4	90	-	-	125	-	-
21	-	-	56	-	-	91	-	-	126	-	-
22	-	-	57	-	-	92	-	-	127	-	-
23	-	-	58	-	-	93	-	-	128	-	-
24	-	-	59	-	-	94	93 12/16	67.7	129	128 3/16	87.6
25	24 14/16	17.2	60	59 5/16	44.8	95	-	-	130	-	-
26	-	-	61	-	-	96	-	-	131	-	-
27	-	-	62	-	-	97	-	-	132	-	-
28	-	-	63	-	-	98	-	-	133	-	-
29	-	-	64	-	-	99	98 11/16	70.3	134	133 2/16	90.1
30	29 12/16	22.0	65	64 4/16	47.9	100	-	-	135	-	-
31	-	-	66	-	-	101	-	-	136	-	-
32	-	-	67	-	-	102	-	-	137	-	-
33	-	-	68	-	-	103	-	-	138	-	-
34	-	-	69	-	-	104	103 10/16	72.7	139	138 1/16	93.5
35	34 11/16	25.8	70	69 2/16	50.6	105	-	-	140	-	-
36	-	-	71	-	-	106	-	-	141	-	-
37	-	-	72	-	-	107	-	-	142	-	-
38	-	-	73	-	-	108	-	-	143	142 15/16	-
39	-	-	74	-	-	109	108 8/16	75.1	144	-	-
40	39 10/16	29.5	75	74 1/16	53.5	110	-	-			
41	-	-	76	-	-	111	-	-			
42	-	-	77	-	-	112	-	-			
43	-	-	78	-	-	113	-	-			
44	-	-	79	79	56.5	114	113 7/16	78.8			
45	44 9/16	32.6	80	-	-	115	-	-			
46	-	-	81	-	-	116	-	-			

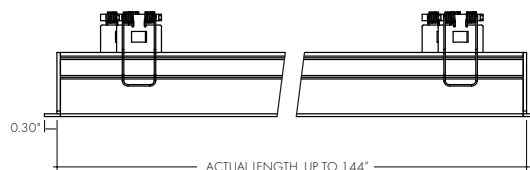

Power Consumption

Tested at Full Power with PDC Series power supplies.

Standard Nominal Lengths offered provide minimal shadowing. For alternate lengths, please consult Inside Sales with specific request.

Dynamic White (2x DW68)

Nominal Length (in)	Actual Length	Watts	Nominal Length (in)	Actual Length	Watts	Nominal Length (in)	Actual Length	Watts	Nominal Length (in)	Actual Length	Watts
		SO			SO			SO			SO
12	9 5/16	9.4	47	-	-	82	-	-	117	116 3/16	75.9
13	12 2/16	9.4	48	-	-	83	82 7/16	56.6	118	-	-
14	-	-	49	48 11/16	34.7	84	-	-	119	119	78.1
15	14 15/16	10.7	50	-	-	85	-	-	120	-	-
16	-	-	51	-	-	86	85 4/16	58.1	121	-	-
17	-	-	52	51 8/16	36.5	87	-	-	122	121 13/16	80.1
18	17 12/16	12.7	53	-	-	88	-	-	123	-	-
19	-	-	54	-	-	89	88 1/16	59.7	124	-	-
20	-	-	55	54 5/16	37.7	90	-	-	125	124 10/16	81.6
21	20 9/16	14.8	56	-	-	91	90 14/16	61.2	126	-	-
22	-	-	57	-	-	92	-	-	127	-	-
23	-	-	58	57 2/16	39.5	93	-	-	128	127 7/16	83.1
24	23 6/16	16.8	59	-	-	94	93 11/16	62.7	129	-	-
25	-	-	60	59 15/16	41.3	95	-	-	130	-	-
26	-	-	61	-	-	96	-	-	131	130 4/16	84.2
27	26 3/16	18.1	62	-	-	97	96 8/16	64.3	132	-	-
28	-	-	63	62 12/16	43.1	98	-	-	133	-	-
29	29	20.1	64	-	-	99	-	-	134	133 1/16	85.7
30	-	-	65	-	-	100	99 5/16	65.9	135	-	-
31	-	-	66	65 9/16	44.9	101	-	-	136	135 14/16	87.3
32	31 13/16	22.1	67	-	-	102	-	-	137	-	-
33	-	-	68	-	-	103	102 2/16	67.0	138	-	-
34	-	-	69	68 6/16	46.6	104	-	-	139	138 11/16	88.9
35	34 10/16	24.1	70	-	-	105	104 15/16	68.6	140	-	-
36	-	-	71	-	-	106	-	-	141	-	-
37	-	-	72	71 3/16	47.8	107	-	-	142	141 8/16	90.5
38	37 7/16	26.2	73	-	-	108	107 12/16	70.2	143	-	-
39	-	-	74	74	49.7	109	-	-	144	-	-
40	-	-	75	-	-	110	-	-	-	-	-
41	40 4/16	27.7	76	-	-	111	110 9/16	72.2	-	-	-
42	-	-	77	76 13/16	52.0	112	-	-	-	-	-
43	-	-	78	-	-	113	-	-	-	-	-
44	43 1/16	30.1	79	-	-	114	113 6/16	74.4	-	-	-
45	-	-	80	79 10/16	54.3	115	-	-	-	-	-
46	45 14/16	32.4	81	-	-	116	-	-	-	-	-

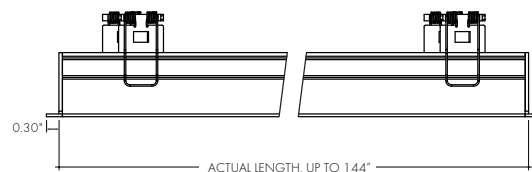

Power Consumption

Tested at Full Power with PDC Series power supplies.

Standard Nominal Lengths offered provide minimal shadowing. For alternate lengths, please consult Inside Sales with specific request.

RGB & RGBW (2x RGB42 & 2xRGBW36)

Nominal Length (in)	Actual Length	Watts				Nominal Length (in)	Actual Length	Watts				Nominal Length (in)	Actual Length	Watts				Nominal Length (in)	Actual Length	Watts			
		RGBW36		RGB42				RGBW36		RGB42				RGBW36		RGB42							
		SO	HO	SO	HO			SO	HO	SO	HO			SO	HO	SO	HO			SO	HO	SO	HO
12	10 11/16	7.9	14.6	8.8	17.3	47	46 2/16	28.9	55.1	33.5	62.6	82	81 9/16	52.2	-	58.8	-	117	-	-	-	-	
13	12 11/16	7.9	14.6	8.8	17.3	48	-	-	-	-	-	83	-	-	-	-	-	118	117	74.2	-	82.5	-
14	-	-	-	-	-	49	48 2/16	30.3	57.6	35.1	65.4	84	83 9/16	53.5	-	60.0	-	119	119	75.7	-	83.8	-
15	14 10/16	9.0	17.0	10.3	19.9	50	-	-	-	-	-	85	-	-	-	-	-	120	-	-	-	-	-
16	-	-	-	-	-	51	50 1/16	31.6	60.0	36.5	68.0	86	85 8/16	54.8	-	61.4	-	121	120 15/16	77.2	-	85.1	-
17	16 10/16	10.1	19.4	11.8	22.6	52	-	-	-	-	-	87	-	-	-	-	-	122	-	-	-	-	-
18	-	-	-	-	-	53	52 1/16	32.8	62.4	37.9	70.3	88	87 8/16	56.0	-	62.9	-	123	122 15/16	78.3	-	86.4	-
19	18 9/16	11.3	21.8	13.3	25.2	54	-	-	-	-	-	89	-	-	-	-	-	124	-	-	-	-	-
20	-	-	-	-	-	55	54	34.0	64.7	39.3	72.6	90	89 7/16	57.3	-	64.3	-	125	124 14/16	79.4	-	87.6	-
21	20 9/16	12.4	24.2	14.8	27.8	56	56	35.3	67.1	40.7	75.0	91	-	-	-	-	-	126	-	-	-	-	-
22	-	-	-	-	-	57	-	-	-	-	-	92	91 7/16	58.5	-	65.8	-	127	126 14/16	80.6	-	88.8	-
23	22 8/16	13.5	26.6	16.3	30.5	58	57 15/16	36.5	69.4	42.0	77.3	93	-	-	-	-	-	128	-	-	-	-	-
24	-	-	-	-	-	59	-	-	-	-	-	94	93 6/16	59.7	-	67.3	-	129	128 13/16	81.7	-	90.1	-
25	24 8/16	14.6	29.0	17.8	33.1	60	59 15/16	37.7	71.7	43.4	79.7	95	-	-	-	-	-	130	-	-	-	-	-
26	-	-	-	-	-	61	-	-	-	-	-	96	95 6/16	60.3	-	68.0	-	131	130 13/16	82.8	-	91.3	-
27	26 7/16	15.9	31.4	19.3	35.9	62	61 14/16	39.0	74.2	44.9	82.2	97	-	-	-	-	-	132	-	-	-	-	-
28	-	-	-	-	-	63	-	-	-	-	-	98	97 5/16	61.6	-	69.5	-	133	132 12/16	83.9	-	92.5	-
29	28 7/16	17.3	33.9	20.8	38.7	64	63 14/16	40.3	76.8	46.4	84.8	99	-	-	-	-	-	134	-	-	-	-	-
30	-	-	-	-	-	65	-	-	-	-	-	100	99 5/16	62.6	-	70.8	-	135	134 12/16	85.1	-	93.5	-
31	30 6/16	18.6	36.4	22.2	41.5	66	65 13/16	41.6	79.4	47.9	87.5	101	-	-	-	-	-	136	-	-	-	-	-
32	-	-	-	-	-	67	-	-	-	-	-	102	101 4/16	63.7	-	72.1	-	137	136 11/16	86.3	-	94.6	-
33	32 6/16	19.3	37.6	23.0	42.9	68	67 13/16	43.0	81.9	49.5	90.2	103	-	-	-	-	-	138	-	-	-	-	-
34	-	-	-	-	-	69	-	-	-	-	-	104	103 4/16	64.8	-	73.4	-	139	138 11/16	87.5	-	95.6	-
35	34 5/16	20.7	40.1	24.4	45.7	70	69 12/16	44.3	84.5	51.0	92.8	105	-	-	-	-	-	140	-	-	-	-	-
36	-	-	-	-	-	71	-	-	-	-	-	106	105 3/16	65.9	-	74.6	-	141	140 10/16	88.7	-	-	-
37	36 5/16	22.0	42.5	25.9	48.5	72	71 12/16	45.6	87.1	52.5	95.5	107	-	-	-	-	-	142	-	-	-	-	-
38	-	-	-	-	-	73	-	-	-	-	-	108	107 3/16	67.0	-	75.9	-	143	142 10/16	89.9	-	-	-
39	38 4/16	23.4	45.0	27.4	51.3	74	73 11/16	46.9	89.6	53.9	-	109	-	-	-	-	-	144	-	-	-	-	-
40	-	-	-	-	-	75	-	-	-	-	-	110	109 2/16	68.0	-	77.2	-	-	-	-	-	-	-
41	40 4/16	24.8	47.5	28.9	54.1	76	75 11/16	48.2	92.0	55.1	-	111	-	-	-	-	-	-	-	-	-	-	-
42	-	-	-	-	-	77	-	-	-	-	-	112	111 2/16	69.6	-	78.5	-	-	-	-	-	-	-
43	42 3/16	26.1	50.0	30.5	56.9	78	77 10/16	49.6	94.4	56.4	-	113	-	-	-	-	-	-	-	-	-	-	-
44	-	-	-	-	-	79	-	-	-	-	-	114	113 1/16	71.1	-	79.9	-	-	-	-	-	-	-
45	44 3/16	27.5	52.6	32.0	59.7	80	79 10/16	50.9	-	57.6	-	115	-	-	-	-	-	-	-	-	-	-	-
46	-	-	-	-	-	81	-	-	-	-	-	116	115 1/16	72.6	-	81.2	-	-	-	-	-	-	-

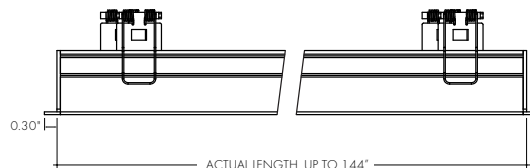

Power Consumption

Tested at Full Power with PDC Series power supplies.

Standard Nominal Lengths offered provide minimal shadowing. For alternate lengths, please consult Inside Sales with specific request.

PIXEL (2x RGBX18 & 2x RGBWX18)

Nominal Length (in)	Actual Length	Watts		Nominal Length (in)	Actual Length	Watts		Nominal Length (in)	Actual Length	Watts		Nominal Length (in)	Actual Length	Watts	
		RGBX18	RGBWX18			RGBX18	RGBWX18			RGBX18	RGBWX18			RGBX18	RGBWX18
		SO	SO			SO	SO			SO	SO			SO	SO
12	8 12/16	9.2	11.3	47	-	-	-	82	-	-	-	117	-	-	-
13	12 11/16	9.2	11.3	48	-	-	-	83	-	-	-	118	-	-	-
14	-	-	-	49	48 2/16	34.9	43.9	84	83 9/16	59.5	74.1	119	119	81.8	-
15	-	-	-	50	-	-	-	85	-	-	-	120	-	-	-
16	-	-	-	51	-	-	-	86	-	-	-	121	-	-	-
17	16 10/16	12.2	15.1	52	-	-	-	87	-	-	-	122	-	-	-
18	-	-	-	53	52 1/16	37.7	47.4	88	87 8/16	62.2	77.4	123	122 15/16	84.2	-
19	-	-	-	54	-	-	-	89	-	-	-	124	-	-	-
20	-	-	-	55	-	-	-	90	-	-	-	125	-	-	-
21	20 9/16	15.2	18.8	56	56	40.5	50.8	91	-	-	-	126	-	-	-
22	-	-	-	57	-	-	-	92	91 7/16	64.8	80.7	127	126 14/16	86.6	-
23	-	-	-	58	-	-	-	93	-	-	-	128	-	-	-
24	-	-	-	59	-	-	-	94	-	-	-	129	-	-	-
25	24 8/16	18.2	22.6	60	59 15/16	43.3	54.2	95	-	-	-	130	-	-	-
26	-	-	-	61	-	-	-	96	95 6/16	66.7	83.2	131	130 13/16	89.0	-
27	-	-	-	62	-	-	-	97	-	-	-	132	-	-	-
28	-	-	-	63	-	-	-	98	-	-	-	133	-	-	-
29	28 7/16	21.1	26.4	64	63 14/16	46.1	57.6	99	-	-	-	134	-	-	-
30	-	-	-	65	-	-	-	100	99 5/16	69.3	86.4	135	134 12/16	91.4	-
31	-	-	-	66	-	-	-	101	-	-	-	136	-	-	-
32	-	-	-	67	-	-	-	102	-	-	-	137	-	-	-
33	32 6/16	23.3	29.2	68	67 13/16	48.8	61.1	103	-	-	-	138	-	-	-
34	-	-	-	69	-	-	-	104	103 4/16	71.8	89.7	139	138 11/16	93.7	-
35	-	-	-	70	-	-	-	105	-	-	-	140	-	-	-
36	-	-	-	71	-	-	-	106	-	-	-	141	-	-	-
37	36 5/16	26.3	33.0	72	71 12/16	51.5	64.5	107	-	-	-	142	-	-	-
38	-	-	-	73	-	-	-	108	107 3/16	74.3	92.9	143	142 10/16	-	-
39	-	-	-	74	-	-	-	109	-	-	-	144	-	-	-
40	-	-	-	75	-	-	-	110	-	-	-	-	-	-	-
41	40 4/16	29.2	36.6	76	75 11/16	54.2	67.8	111	-	-	-	-	-	-	-
42	-	-	-	77	-	-	-	112	111 2/16	76.8	-	-	-	-	-
43	-	-	-	78	-	-	-	113	-	-	-	-	-	-	-
44	-	-	-	79	-	-	-	114	-	-	-	-	-	-	-
45	44 3/16	32.0	40.3	80	79 10/16	56.9	70.9	115	-	-	-	-	-	-	-
46	-	-	-	81	-	-	-	116	115 1/16	79.3	-	-	-	-	-

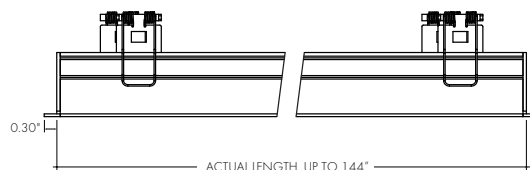

Power Supplies

See fixture and power supply instructions & spec sheet for wiring information. Dimming possible in select models - view Luminii website for list of compatible dimmers.

For use with Warm Dim, WD68

Triac, MLV, & ELV Compatible Dimmers

MODEL	POWER	OUTPUT
PDC - (IP20) Power Supply	96 - 96 Watts	24 - 24 VDC

MODELS	96W
Length	8.25"
Width	4.10"
Depth	1.56"

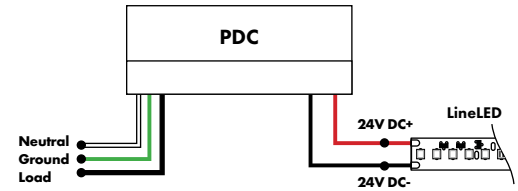

For use with Dynamic White, DW68

0-10V Warm Dimming 0% Power Supply 120VAC - 277VAC (for warm dimming of Dynamic White option)

MODEL	POWER	OUTPUT
PS010WD - 0-10 Warm dim LED Power Supply	96 - 96 Watt	24 - 24 VDC

Requires a 0-10V controller to work properly

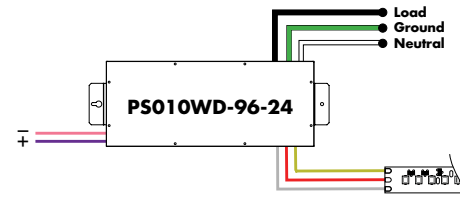

0-10V Tunable White 0% Dimming Power Supply 120VAC - 277VAC (for tunable white control of Dynamic White option)

MODEL	POWER	OUTPUT
PS010TW - 0-10 Tunable White LED Driver	96 - 96 Watt	24 - 24 VDC

Requires two 0-10V controllers to work properly

MODELS	PS010TW
A Length	14.40"
B Width	2.60"
C Depth	5.20"

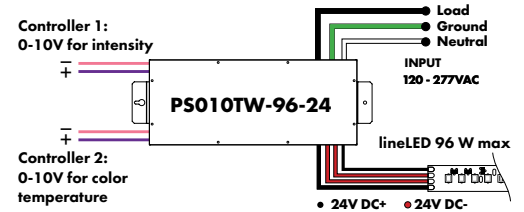

Customizable Dim to Warm or Variable White via 0 - 10V (for tunable white or warm dimming control of Dynamic option)

MODEL	POWER	OUTPUT	CONTROL
PS010V-0-10 LED Driver	96-96 Watt	24-24 VDC	WW- Standard One Channel - Dim To Warm Curve W2C- Standard Two Channel - Dim 1: Intensity; Dim 2: CCT W21- Standard Two Channel - Dim 1: Warm Channel Intensity; Dim 2: Cool Channel Intensity W1X- ___ Custom One Channel - Dim To Warm Curve W2X- ___ Custom two Channel - Dim 1: Intensity; Dim 2: CCT

Requires a 0-10V controller to work properly

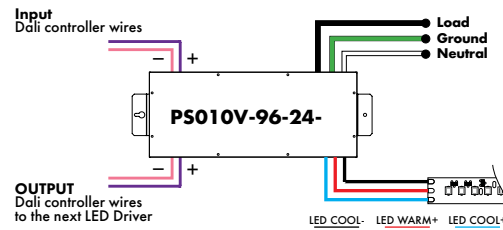

For use with RGB/RGBW/Pixel, RGB42/RGBW36/RGBX18/RGBWX18

Non-Dimming Power Supply 120VAC - 277VAC

MODEL	POWER	OUTPUT	DIMMING	LOCATION
PSV - PSV Series	96 - 96 Watt	24 - 24 VDC	ND - Non Dimming	D - Dry location

Requires a controller and a decoder to work properly

MODELS	96W
A Length	14.40"
B Width	5.20"
Depth	2.60"

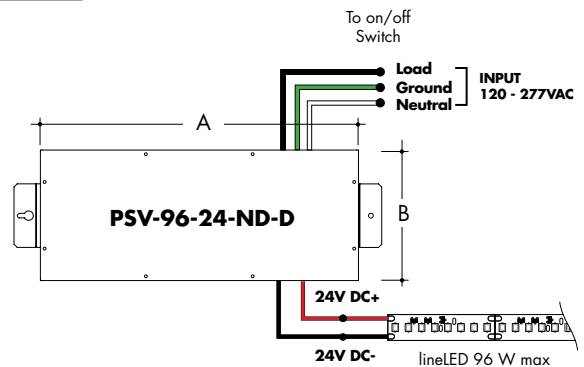

Power Supplies

See fixture and power supply instructions & spec sheet for wiring information. Dimming possible in select models - view Luminii website for list of compatible dimmers.

For use with RGB/RGBW, RGB42/RGBW36 or with Dynamic White, DW68

DMX 0% Dimming Power Supplies 120VAC - 277VAC

MODEL	POWER	OUTPUT
PSDMX-DMX Power Supply dims down to 0%	96 - 96 Watt 3X96 - 3 X 96 Watt	24-24 VDC

Features eldoLED's LINEARdrive configurable dimmable drivers.

DDMX-RGBW DMX Decoder not required when purchasing this power supply.

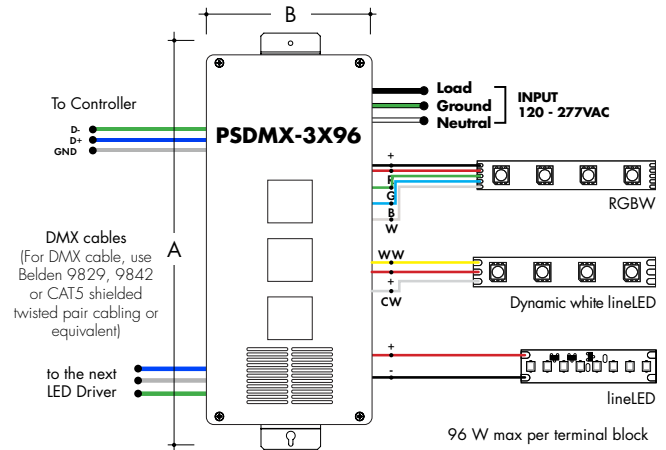
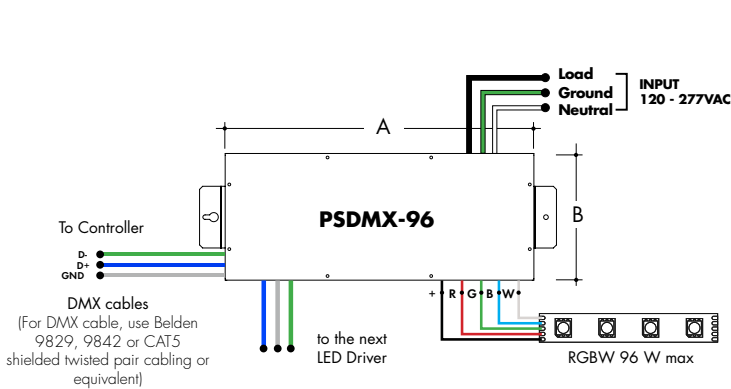

MODELS	96W	3X96
A Length	14.40"	15.75"
B Width	5.20"	6.62"
Depth	2.60"	4.95"

DMX-1Z-RGBW, DMX-3Z-RGBW

RGBW LED 1 or 3 Zone Controller

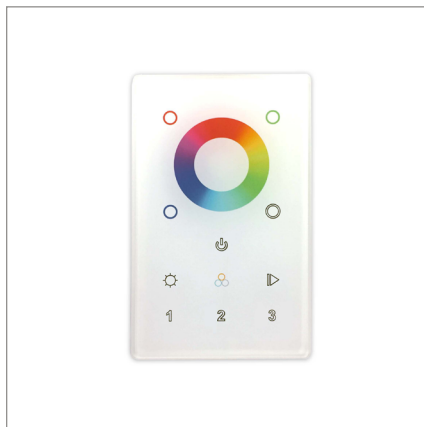

DMX /Wireless RGB-W wall-mount controller controls DMX lighting fixtures, wireless control of RGB-W lighting fixture or use both simultaneously. Fits in any standard US switch box. Includes all the outputs in the back of the controller.

Control brightness levels with a single touch, personalize and memorize 3 different scenes, and even create 3 variations of white.

Features

- 2 in 1 in-Wall Controller: DMX Control or Wireless RGB-W
- 65,000 Color Options, Dimming and Speed Control
- Memory Function
- 50 Foot Wireless Range
- Easily Fits Standard US Switch Boxes
- Touch Sensitive Glass Surface
- Includes 10 Built in Programs, or Create and Play Your Own

Operating Voltage

12 - 24V DC

Color Parameters

- Brightness
- Saturation
- Primary colors
- Fading
- Color changing speed

ORDERING CODE

MODEL	ZONES	COLOR
DMX - DMX Controller	3Z - Three Zone 1Z - One Zone	RGBW - Red, Green, Blue, & White

Touch DMX Controller

Touchscreen digital LED controller

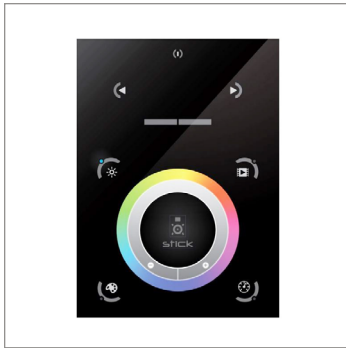

MODEL

TSDMX-E

TSDMX-E - Touchscreen DMX controller

Programmable advanced DMX512 lighting controller featuring a touch-screen interface. Operates as stand alone controller or integrated with most architectural lighting control systems. Can controller endless DMX512 enabled devices.

Mounts to standard single or dual gang wall box with the included power supply inside the junction box. Terminal block design for power and data connections.

Features

- Sleek glass design which sits 0.43" from the wall
- Graphical color display to show selected environment
- Color/dimmer/speed palette
- Color temperature mixing
- Touch sensitive buttons. No mechanical parts
- Touch sensitive wheel allows for accurate color selection
- Multi-zone microSD memory
- Multi-room control with 500 scenes, 10 zones
- 1024 DMX channels. Control 340 RGB fixtures
- USB & Ethernet connectivity for programming and control

Power Supply

7 VDC (included)

Programmability

PC, Mac, Tablet, Smartphone

Output Signal

DMX512 (1024 channels)

Color Parameters

- Brightness
- Saturation
- Speed of color changing sequence
- Fading / dimming / brightness

DMX Decoder

DMX signal to RGBW decoder (required to operate DMX controller)

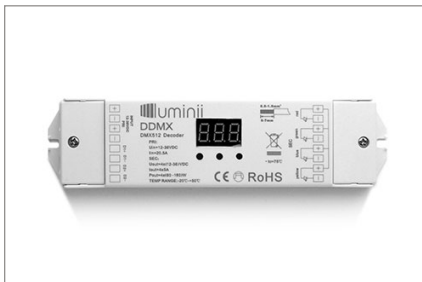

ORDERING CODE

MODEL

DDMX-RGBW

DDMX-RGBW - DMX decoder

Translates controller DMX512 programs for RGB and white LED strips.

Unique DMX address for the decoder can be set easily and displayed by the numeric display on the case. Changing and resetting the DMX address requires manual input.

Use power repeater to expand output.

Operating Voltage

12-36 VDC

Power Capacity

up to 96W at 24V

Operating Temperature Range

from -4°F to +122°F in case

Smart Pixel Decoder

SPI signal to DMX signal decoder



Model

SR-DMX-SPI

SR-DMX-SPI - Smart Pixel Decoder

The SR-DMX-SPI is a smart LED pixel decoder that controls RGB/RGBW pixel LED strips with SPI signal. Designed with an OLED backlit panel, the pixel controller allows for easy configuration of most settings. Four push buttons are available for control of the LED functions.

*For pixel only.

Features

- 2 in 1 in-Wall Controller: DMX Control or Wireless RGB-W
- SPI signal output for RGB/RGBW pixel light control
- DMX512 controllable and RF/WIFI remote controllable
- Capable of addressing up to 1020 RGB pixels & 765 RGB pixels
- OLED panel allows for easy configuration

Operating Voltage

12 - 36V DC

Power capacity

up to 96W at 24V

Operating temperature range

from -4°F to +122°F in case