



**Features**

Basics Contractor-Grade recessed extrusions compatible with Basics LED strips.

**Finish**  
Silver anodized

**Mounting**  
Multiple mounting clip options ordered separately

**Diffuser Lens**  
Acrylic, snap-in-place, UV resistant

**Product Dimensions**

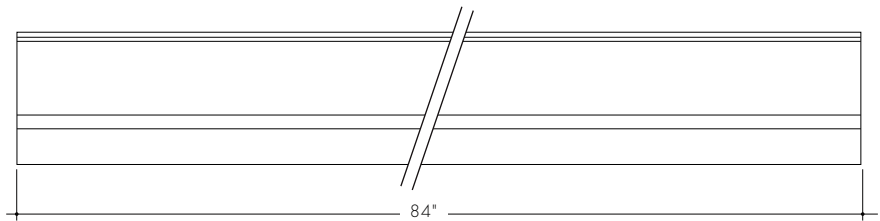
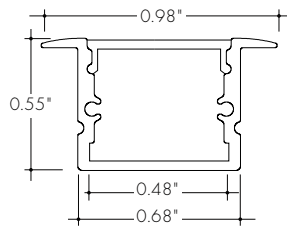

**INCLUDED MOUNTING ACCESSORIES**

EXTRUSION LENGTH	MOUNTING SCREWS	END CAP (PAIR)
84"	6	1

Each pair of endcaps includes 1x H0 (no wire feed hole) and 1x H1 (with hole) where applicable. Additional endcaps and mounting clips are available for purchase.

**Accessories**

All Channels come with a specified set of Mounting Clips and End Caps, see Ordering Code for details. Order additional Mounting Clips and End Caps as necessary.

**EC-BRC-H0-SA**  
Silver Anodized End Cap

**EC-BRC-H1-SA**  
Silver Anodized End Cap with powerfeed opening

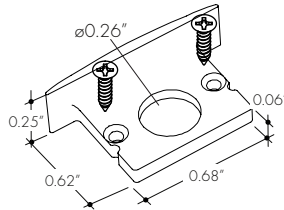
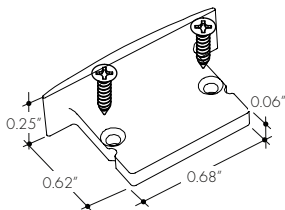

**Ordering code**

MODEL	LENGTH	LENS	MOUNTING <sup>2</sup>	FINISH
BRC - Basics Recessed Channel <sup>1</sup>	84 - 84"	C - Clear HF - Half Frosted F - Frosted	DS - Direct to Surface Screw Mount	SA - Silver Anodized

1 - End Caps are included with channel, one of H0 (no hole) and one of H1 (with hole). Order additional End Caps as necessary.  
2 - Mount Basics Recessed Channel directly to stud using flat head screws (by others), every 16 inches.